



# ENGINE DRIVEN GRASS COLLECTION SYSTEM

Model# 54131502 & 54131503



**ZXD**

61" & 72" DECK

MODEL YEAR:

**2023-NEWER**



## OPERATOR'S MANUAL

ASSEMBLY • OPERATION • MAINTENANCE

# GRASS COLLECTION SYSTEM

## TABLE OF CONTENTS

SECTION	PAGE	SECTION	PAGE
Safety	2	Engine Mount Arm Assembly & Installation	16
Safety Alert Symbols	3	Engine Drive Assembly Installation	17
I INTRODUCTION AND DESCRIPTION	4	Blower Cone Installation	17
Introduction	4	Deck Baffle Installation	18
Description	4	Boot Kit Installation	19
Overall Parts List	5-6	Lower Mount Tube Installation	20
II OPERATING INSTRUCTIONS	7	Upper Frame Assembly Installation	21
General Safety	7	Top Assy To Upper Frame Assy Installation	22
Operation & Tips On Mowing	7	Inlet Installation	22
Unloading The Collection System	7	Hinge Kit Assy Installation	23
III MAINTENANCE	7-8	Even Bag Fill Adjustment	23
Maintenance Checklist	7-8	Bag Assy	24
IV PARTS AND SERVICE	8	Bag Assy Installation	24
Parts And Service Information	8	Length of Hose Adjustment	25
Torque Specifications	9	Upper Hose Installation	25
V INSTALLATION FOR USE	10	Lower Hose to Blower Cone Installation	25
Battery Box Removal	10	Lower Hose to Boot Installation	25
Lower Frame Plate Installation	10-11	Throttle Kit Assy & Installation	26-27
Rear Main Frame Plate Installation	11	Impeller Blade Removal/Replacement	28
Exhaust Diverter Installation	12	Weight Kit Installation	29
Upper Main Frame Plate Installation	13	Exploded Views	30-33
Upper Frame Mount Installation	14	Safety Decals	34
Frame Gusset Installation	14	Troubleshooting	35
Battery Box Reinstallation	15	VI WARRANTY	36

## SAFETY

1. Read the operator's manual carefully and familiarize yourself with the proper use of your attachment. Do not allow anyone who is not acquainted with the Safety Instructions to use your attachment.
2. Know the controls and how to stop them quickly. **READ THE OPERATOR'S MANUAL!**
3. Do not allow children to operate the machine. Do not allow adults to operate it without proper instruction.
4. Be especially watchful of children and pets entering into the area while operating.
5. Keep your eyes and mind on your machine while mowing or operating your attachment. Don't let others distract you.
6. Do not attempt to operate your machine when not in the driver's seat.
7. Always shut off blades and engine when emptying the container.
8. Stop machine, shut off deck attachment, set parking brake, shut off engine and remove ignition key before removing clogs, removing or replacing hose, boot, blower cone, or performing any maintenance.
9. Mow across the face of slopes (not more than 10 degrees); never up and down the face.
10. It is recommended that the container be emptied when half full while operating on slopes. Start mowing on slopes when the container is empty.
11. Inspect your lawn and remove any foreign objects before mowing. Never deliberately run the mower across any foreign object.
12. Wear hearing protection.
13. Wear eye protection to prevent debris from getting into your eyes.

# SAFETY

**WARNING!** **NEVER** operate the mower unless the discharge guard and either the deflector assembly or the vacuum collector adapter are fastened securely in place.

**WARNING!** Do not work around the mower deck boot or the blower area until you are certain that the mower blades and the blower impeller have stopped rotating.

**WARNING!** To avoid serious injury, perform maintenance on the vacuum collector; **ONLY AFTER STOPPING THE MOWER'S ENGINE AND WAITING FOR ALL MOVING PARTS TO COME TO A COMPLETE STOP.** Set the parking brake. Always remove the ignition key before beginning maintenance.

**WARNING!** For your own personal safety, **ALWAYS** mow **ACROSS** the face of slopes and **NEVER UP** and **DOWN** the face. **NEVER** attempt to mow excessively steep slopes, and use caution when turning on any slope.

## Safety Alert Symbol



This Safety Alert Symbol means: **“ATTENTION! BECOME ALERT! YOUR SAFETY IS INVOLVED!”**

This symbol is used to call attention to safety precautions that should be followed by the operator to avoid accidents. When you see this symbol, carefully read the message that follows and heed its advice. Failure to comply with safety precautions could result in death or serious bodily injury.

## Safety Signs

The signal words **DANGER**, **WARNING**, and **CAUTION** are used on the equipment safety signs. These words are intended to alert the viewer to the existence and the degree of hazard seriousness.



White letters on **RED**

This signal word indicates a potentially hazardous situation which, if not avoided, will result in death or serious injury.



Black letters on **ORANGE**

This signal word indicates a potentially hazardous situation which, if not avoided, could result in death or serious injury.

It may also be used to alert against unsafe practices.



Black letters on **YELLOW**

This signal word indicates a potentially hazardous situation which, if not avoided, will result in minor or moderate injury.

It may also be used to alert against unsafe practices.



# Section I - INTRODUCTION AND DESCRIPTION

## Introduction

We are pleased to have you as a PECO customer. Your collection system has been designed to give you a low maintenance, simple, and effective way to collect the grass clippings from your mower. The manuals are provided to give you the necessary instructions to properly mount, operate and maintain the collection system on your mower. Please read this manual thoroughly. Understand what each control is for and how to use it. Observe all safety decal precautions on the machine and noted throughout the manual.

**NOTE:** All references made to right, left, front, rear, top or bottom are as viewed from the normal operator's position on the mower.

## Description

The grass collection system is designed for turf maintenance where there is a need to collect the grass clippings as the mower cuts the turf. It is also used for picking up leaves in pre-season and post-season clean-up. The engine/blower/blade assembly, is mounted on the right side of the unit. The blower draws grass clippings from the discharge area of the cutting deck back to the collection bags at the rear portion of the mower frame. The operator can engage the engine/blower/blade assembly by starting the engine. Once the bags are full with clippings, they can be easily released for dumping.







# Unit Model #: 54131502

Mower:	Kioti	Owner's Manual: Q0607
Mower Type:	ZXD	
Deck Size:	61"	
Deck Type:		
Revision #:	0	
Vac Type:	P3B	
Drive Type:	B&S 6.5hp	
Fits Year(s):	2023-Newer	

☐ **A2463 Vac Kit**

- (1) HB0683 Vac Kit HW Bag
- (1) J0060 6" Hose Clamps
- (1) V0025 6" & 7" Inlet
- (1) A1157 Top Assy.
- (1) A2068 Upper Frame Assy.
- (3) B0227 Bag Ring
- (3) G0013 4 Cu. Ft. Collection Bags w/out Labels
- (2) B0752 Lwr. Mnt. Tubes (25")

☐ **A2461 Mount Kit**

- (1) B2319 Frame Strap
- (2) B2242 Frame Gusset
- (1) B2312 Rt Frame Plate/Lower
- (1) B2311 Lt Frame Plate/Lower
- (1) B2313 Lt Upper Frame Mount
- (1) B2310 Rear Frame Bracket
- (1) B2314 Rt Upper Frame Mount
- (1) B2321 Hinge Plate
- (1) B3727 Outer Engine Mount Tube
- (1) A0274 Engine Mnt Arm Assy
- (1) E6009 8" Blower Cone
- (1) HB0887 Mount Kit HW Bag
- (1) A643 6.5HP B&S Assy w/ 4-Blade Impeller w/ Clips

☐ **A2460 Weight Kit**

- (4) Y0025 28 lbs Weight
- (1) HB0888 Weight Kit HW Bag
- (1) B2322 Weight Bracket

☐ **A2459 Boot Kit**

- (1) HB0688 Boot Kit HW Bag
- (1) E0032 8" Boot Assy
- (1) B0333 Boot Rod
- (1) B2316 Boot Plate

☐ **A2465 Baffle Kit**

- (1) HB0890 Baffle Kit HW Bag
- (1) B2324 Deck Baffle

☐ **A0619 Throttle Kit**

- (1) A0666 Throttle Mnt Plate Assy
- (1) HB0249 Throttle Kit HW Bag
- (1) A0060 70" Throttle Cable Kit



# Unit Model #: 54131503

Mower: Kioti

Owner's Manual: Q0607

Mower Type: ZXD

Deck Size: 72"

Vac Type: P3B

Deck Type:

Drive Type: B&amp;S 6.5hp

Revision #: 0

Fits Year(s): 2023-Newer

## ☐ A2463 Vac Kit

(1) HB0683

Vac Kit  
HW Bag

(1) J0060

6" Hose  
Clamps

(1) V0025

6" & 7"  
Inlet

(1) A2068

Upper  
Frame Assy.

(3) B0227

Bag Ring

(3) G0013

4 Cu. Ft.  
Collection Bags  
w/out Labels

(1) F0060-44

6" x 44"  
Upper Hose

(2) B0752

Lwr. Mnt.  
Tubes (25")

## ☐ A2461 Mount Kit

(1) B2319

Frame Strap

(2) B2242

Frame Gusset

(1) B2312

Rt Frame  
Plate/  
Lower

(2) J0080

8" Hose  
Clamps

(1) B2313

Lt Upper  
Frame Mount

(1) F0080-42

8" x 42"  
Lower Hose

(1) B2314

Rt Upper  
Frame Mount

(1) B3727

Outer Engine  
Mount Tube

(1) A0274

Engine Mnt  
Arm Assy

## ☐ A2460 Weight Kit

(4) Y0025

28 lbs  
Weight

(1) HB0888

Weight Kit  
HW Bag

(1) B2322

Weight Bracket

## ☐ A2459 Boot Kit

(1) E0023

8" Boot Assy

(1) HB0688

Boot Kit  
HW Bag

(1) B0333

Boot Rod

(1) B2316

Boot Plate

## ☐ A0619 Throttle Kit

(1) A0666

Throttle Mnt  
Plate Assy

(1) HB0249

Throttle Kit  
HW Bag

(1) A0060

70" Throttle  
Cable Kit

(1) HB0887

Mount Kit  
HW Bag

(1) E6009

8" Blower  
Cone

(1) A643

6.5HP B&S  
Assy w/ 4-Blade  
Impeller w/ Clips

## ☐ A2466 Baffle Kit

(1) HB0890

Baffle Kit  
HW Bag

(1) B2325

Deck Baffle



## SECTION III

# OPERATING INSTRUCTIONS

### General Safety

Only qualified people familiar with this operator's manual and the mower's operator's manual should operate this machine.

### Operation & Tips On Mowing

- A. Perform BEFORE EACH USE the maintenance list referenced in Section IV.
- B. Start the engine/blower/blade assembly.
- B. Start mower.
- C. With the mower at high idle speed, engage the mower deck.
- D. Proceed to operate the control levers of the mower.

**NOTE:** If the collection system does not appear to be collecting the grass clippings, disengage the deck and Drive assembly, then, engage the parking brake and turn the mower off. Check upper and lower hoses for any clogs.

To obtain the maximum effectiveness from your collection system, the tips listed below should be followed:

- \* Watch your speed- Normal conditions will allow a speed of up to approximately 4 mph, but thick, heavy damp conditions will require reduced ground speed.
- \* Mow with sharp blades- A sharp blade cuts cleaner.
- \* Wet grass and leaves will decrease effectiveness and will increase horsepower requirements.
- \* Mow at higher cutting heights- Remove and mulch no more than 2" of grass length with each mowing. (Experts recommend not cutting off more than 1/3 of the grass blade length at any given time.)
- \* Mow twice, at different height settings, (high, then low), if grass is extra tall.
- \* Remember that horsepower requirements will vary with the mowing conditions such as type and height of turf grass, moisture content, amount of leaves, whether the terrain is flat or hilly, etc.

### Unloading The Collection System

**NOTE:** Collection system blower will have an audible change in tone when the collection system is full.

- A. Stop the forward movement of the mower, engage the parking brake.
- B. Disengage the mower deck.
- C. Set the throttle of the Engine Drive down to idle.
- D. Once the parking brake has been engaged, then and only then, walk behind the mower and check the collection bags by first unhooking the rubber strap with S-hook that secures the plastic top, then lift the plastic hood. Load in bags should not exceed the height of the installed bag.
- E. To remove the bags from the frame, slide bags out and turn bags over to deposit clippings.
- F. Slide empty bags back onto the frame and secure plastic top with the rubber strap with S-hook.

**NOTE:** Do not allow collection bags to become over-filled as potential damage may occur to your equipment. Also, be sure to clean the hood screen as needed.

### Maintenance Checklist

Before each use:

1. Check blades and spindles to be sure that no foreign objects, such as wire or steel strapping bands, are wrapped around them.
2. Inspect blades for wear. Replace if necessary. If it is necessary to sharpen the blades, remove the blades from the spindles before sharpening. DO NOT sharpen blades while still attached to the mower.
3. Make sure all shields are in place and in good condition. Repair or replace any missing or damaged shields.
4. Listen for abnormal sounds, which might indicate loose parts, damaged bearings, or other damage. Correct any deficiency before continuing operation.
5. Check for wear or deterioration of the upper or lower hoses. If there are any portions of the hose that have been torn or worn through, replace immediately.



After Each Use:

1. Clean all debris from machine especially from the container, underneath the belt shields, and safety decals. Replace any missing or illegible decals.
2. Inspect the unit for worn or damaged components. Repair or replace before the next use. Any replacement component installed during repair shall include the component's current safety decal specified by the manufacturers to be affixed to the component.
3. Under normal usage, the bag material is subject to deterioration and wear and should therefore be frequently checked for necessary replacement. Any replacement bag should be checked to ensure compliance with the original manufacturer's recommendations or specifications.

## SECTION IV - PARTS & SERVICE

### Parts And Service Information

Collection system owners should record the name and telephone number of their Service Center. Your Service Center will be happy to supply replacement parts, accessories, and do any service or repairs to your collection system.

If for any reason your Service Center is unable to service your collection system or supply replacement parts, contact New PECO, Inc. and include the following information on the chart below.

### DOCUMENT THE FOLLOWING INFORMATION FOR FUTURE REFERENCE

**Unit Model Number:** \_\_\_\_\_

**Unit Engine Size:** \_\_\_\_\_

**Unit Serial Number:** \_\_\_\_\_

**Date of purchase:** \_\_\_\_/\_\_\_\_/\_\_\_\_

**Dealer/Distributor Name:** \_\_\_\_\_

**Address:** \_\_\_\_\_ **State:** \_\_\_\_\_ **Zip:** \_\_\_\_\_

**Phone Number:** \_\_\_\_\_

**New PECO, Inc.**  
**10 Walden Dr | Arden, North Carolina 28704**  
**Phone: 1-800-438-5823 | 828-684-1234**  
**Fax: 828-684-0858**  
**Email: [peco@lawnvac.com](mailto:peco@lawnvac.com)**  
**Website: [www.lawnvac.com](http://www.lawnvac.com)**



# TORQUE SPECIFICATIONS

Proper torque for American fasteners used on PECO equipment.  
Recommended Torque in Foot Pounds (Newton Meters).\*

## AMERICAN Bolt Head Markings



SAE Grade 2  
(No Dashes)

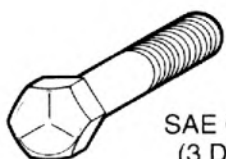

SAE Grade 5  
(3 Dashes)

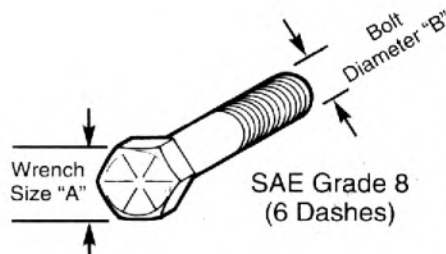

SAE Grade 8  
(6 Dashes)

WRENCH SIZE (IN.) "A"	BOLT DIAMETER (IN.) "B" AND THREAD SIZE	SAE GRADE 2	SAE GRADE 5	SAE GRADE 8
7/16	1/4 - 20 UNC	6 (7)	8 (11)	12 (16)
7/16	1/4 - 28 UNF	6 (8)	10 (13)	14 (18)
1/2	5/16 - 18 UNC	11 (15)	17 (23)	25 (33)
1/2	5/16 - 24 UNF	13 (17)	19 (26)	27 (37)
9/16	3/8 - 16 UNC	20 (27)	31 (42)	44 (60)
9/16	3/8 - 24 UNF	23 (31)	35 (47)	49 (66)
5/8	7/16 - 14 UNC	32 (43)	49 (66)	70 (95)
5/8	7/16 - 20 UNF	36 (49)	55 (75)	78 (106)
3/4	1/2 - 13 UNC	49 (66)	76 (103)	106 (144)
3/4	1/2 - 20 UNF	55 (75)	85 (115)	120 (163)
7/8	9/16 - 12 UNC	70 (95)	109 (148)	153 (207)
7/8	9/16 - 18 UNF	79 (107)	122 (165)	172 (233)
15/16	5/8 - 11 UNC	97 (131)	150 (203)	212 (287)
15/16	5/8 - 18 UNF	110 (149)	170 (230)	240 (325)
1-1/8	3/4 - 10 UNC	144 (195)	266 (360)	376 (509)
1-1/8	3/4 - 16 UNF	192 (260)	297 (402)	420 (569)
1-5/16	7/8 - 9 UNC	166 (225)	430 (583)	606 (821)
1-5/16	7/8 - 14 UNF	184 (249)	474 (642)	668 (905)
1-1/2	1 - 8 UNC	250 (339)	644 (873)	909 (1232)
1-1/2	1 - 12 UNF	274 (371)	705 (955)	995 (1348)
1-1/2	1 - 14 UNF	280 (379)	721 (977)	1019 (1381)
1-11/16	1-1/8 - 7 UNC	354 (480)	795 (1077)	1288 (1745)
1-11/16	1-1/8 - 12 UNF	397 (538)	890 (1206)	1444 (1957)
1-7/8	1-1/4 - 7 UNC	500 (678)	1120 (1518)	1817 (2462)
1-7/8	1-1/4 - 12 UNF	553 (749)	1241 (1682)	2013 (2728)
2-1/16	1-3/8 - 6 UNC	655 (887)	1470 (1992)	2382 (3228)
2-1/16	1-3/8 - 12 UNF	746 (1011)	1672 (2266)	2712 (3675)
2-1/4	1-1/2 - 6 UNC	870 (1179)	1950 (2642)	3161 (4283)
2-1/4	1-1/2 - 12 UNF	979 (1327)	2194 (2973)	3557 (4820)

## METRIC

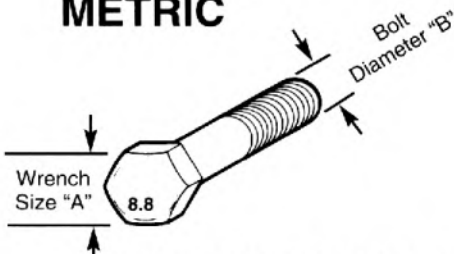

Numbers appearing on bolt heads  
indicate ASTM class.

Proper torque for metric fasteners used on PECO equipment.  
Recommended Torque in Foot Pounds (Newton Meters).\*

WRENCH SIZE (mm) "A"	BOLT DIA. (mm) "B"	ASTM 4.6	ASTM 8.8	ASTM 9.8	ASTM 10.9
8	5	1.8 (2.4)		5.1 (6.9)	6.5 (8.8)
10	6	3 (4)		8.7 (12)	11.1 (15)
13	8	7.3 (10)		21.1 (29)	27 (37)
16	10	14.5 (20)		42 (57)	53 (72)
18	12	25 (34)	74 (100)	73 (99)	93 (126)
21	14	40 (54)	118 (160)	116 (157)	148 (201)
24	16	62 (84)	167 (226)	181 (245)	230 (312)
30	20	122 (165)	325 (440)		449 (608)
33	22		443 (600)		611 (828)
36	24	211 (286)	563 (763)		778 (1054)
41	27		821 (1112)		1138 (1542)
46	30	418 (566)	1119 (1516)		1547 (2096)

\*Use 75% of the specified torque value for plated fasteners. Use 85% of the specified torque values for lubricated fasteners.

## Section V - INSTALLATION FOR USE

### Battery Box Removal and Lower Frame Plate Installation

First, remove and set aside the (3) fasteners holding the Battery Box Cover in place to expose the battery. Refer to Figure A.

Next loosen the battery hold tie-down hardware and disconnect the battery terminals. Remove and set aside the battery. Refer to Figure B.

Then, remove the (4) fasteners securing the Battery Box Mount Base. Refer to Figure C.

Finally, secure the Left Lower Frame Plate and Battery Box Mount Base by using (4) M8-1.25 x 25mm (Item #K0109). Refer to Figure D.

Leave hardware relatively loose until after the installation on page 14.

Note: Some parts and part features have been hidden from view for visual clarity.

Figure A



Figure B



Figure C



Figure D





## Lower Frame Bracket Installation

First, align the bolt holes of the Right Lower Frame Plate (Item #1) to the lower right bolt holes of the Mower Chassis. Then, secure the Right Lower Frame Plate by using (4) 5/16"-18 x 1" HHCS (Item #2) and (4) 5/16"-18 Ny-Flange Lock Nuts (Item #3). Refer to Figure B.

Leave hardware relatively loose until after the installation on page 14.

Note: Some parts and part features have been hidden from view for visual clarity.

Figure A

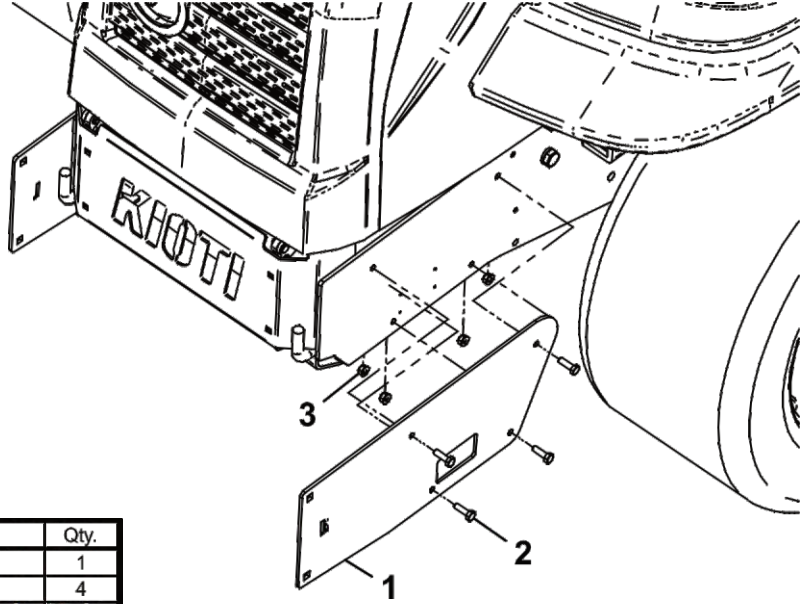

Item #	Part #	Desc.	Qty.
1	B2312	Right Lower Frame Plate	1
2	K1154	HHCS 5/16"-18 x 1"	4
3	K2516	Ny-Flange Lock Nut 5/16"-18	4

## Lower Frame Bracket Installation

First, align the Rear Main Frame Plate (Item #1) between the previously installed Lower Frame Plates. Then, secure by using (4) 3/8"-16 x 1" Carriage Bolts (Item #3) and (4) 3/8"-16 Ny-Flange Lock Nuts (Item #2). Refer to Figure B.

Leave hardware relatively loose until after the installation on page 14.

Note: Some parts and part features have been hidden from view for visual clarity.

Figure B

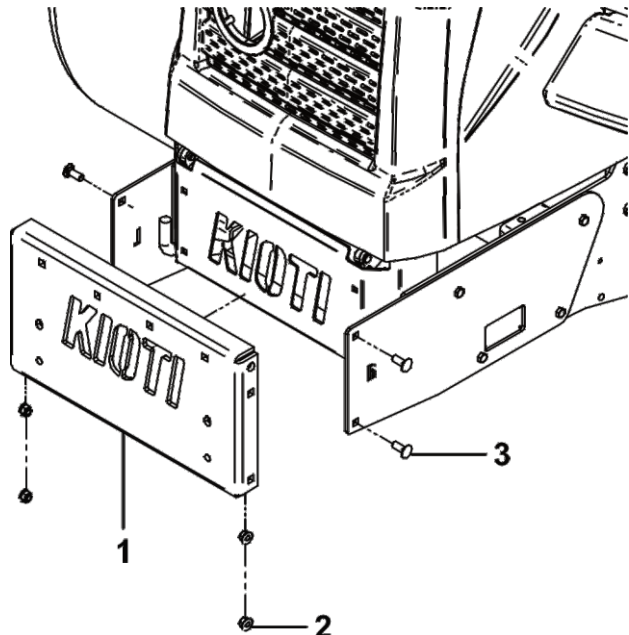

Item #	Part #	Desc.	Qty.
1	B2310	Rear Main Frame Plate	1
2	K2038	Ny-Flange Lock Nut 3/8"-16	4
3	K1182	Carriage Bolt 3/8"-16 x 1" / Zinc / GR5	4

# Exhaust Diverter Install

An Exhaust Diverter will need to be installed on your mower to prevent the exhaust from damaging the Collection System.

Attach (1) Exhaust Diverter (Item #1) to the engine exhaust pipe and secure the Exhaust Diverter using (1) Clamp Kit (Item #2). Refer to Figures below.

Position the diverter so that the exhaust blows to the left and down at approximately a 45 degree angle.

Figure A

Item #	Part #	Desc.	Qty.
1	J0299	Exhaust Diverter / Kioti ZXD	1
2	X1046	1-3/8" Exhaust Clamp Kit	1

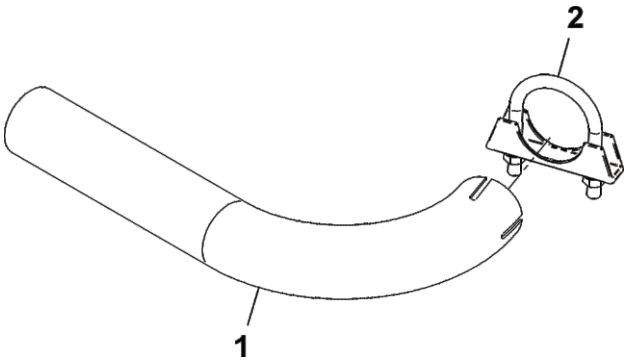

Figure B





## Upper Main Frame Plate

Position the Hinge Plate (Item #2) over the Upper Main Frame Plate (Item #1) aligning the bolt holes of both parts.

Secure by using (11) 3/8"-16 x 1" Carriage Bolts (Item #3) and (11) 3/8"-16 Ny-Flange Lock Nuts (Item #4).

Next, assemble (5) Vibro-Insulators (Item #5) to the Hinge Plate using (5) 5/16"-18 Flange Nuts (Item #6). See Figure A.

Leave hardware relatively loose until after the installation on page 14.

Note: Some parts and part features have been hidden from view for visual clarity.

Figure A

Item #	Part #	Desc.	Qty.
1	B2317	Upper Main Frame Plate	1
2	B2321	Hinge Plate	1
3	K1182	Carriage Bolt 3/8"-16 x 1" / Zinc / GR5	11
4	K2038	Ny-Flange Lock Nut 3/8"-16	11
5	K1491	Vibro-Insulator / 1" Dia. 3/8" Thk. w/ 5/16"-18 Stud	5
6	K1178	Flange Nut 5/16"-18	5

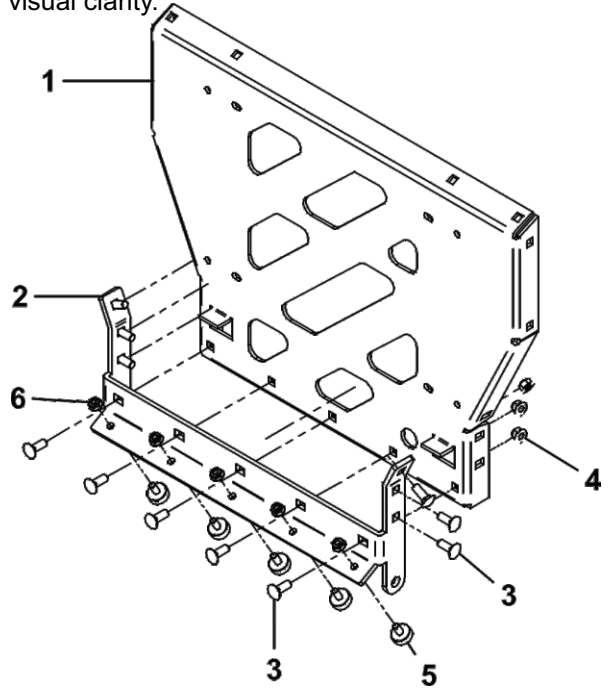

Position the Hinge Plate (Item #1) above the Rear Main Frame Plate (Item #5) aligning the bolt holes of both parts. Secure by using (2) 1/2"-13 x 1 1/2" HHCS (Item #3), (2) 1/2"-13 Ny-Flange Lock Nuts (Item #4) and (2) 1/2" Flat Washers ensuring washer is between the Hinge Plate and Rear Main Frame Plate. See Figure B.

Leave hardware relatively loose until after the installation on page 14.

Note: Some parts and part features have been hidden from view for visual clarity.

Figure B

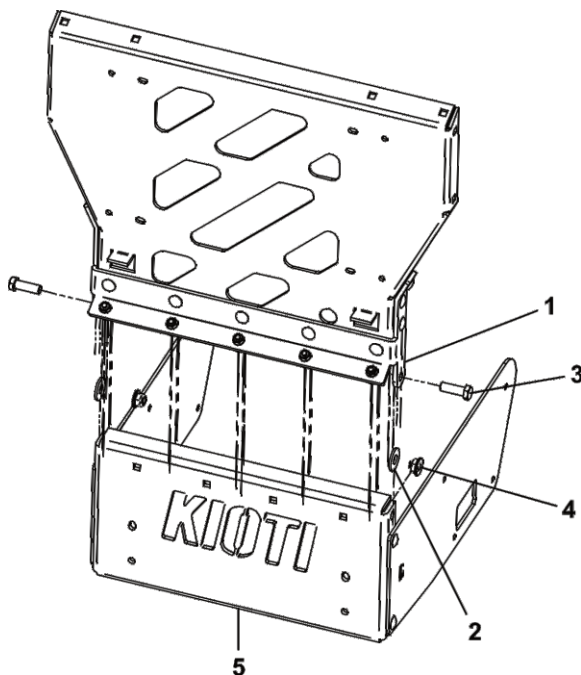

Item #	Part #	Desc.	Qty.
1	B2321	Hinge Plate	1
2	K0055	Flat Washer 1/2" / 1.383 OD x .560 ID x .120 T	2
3	K1233	1/2"-13 x 1-1/2" HHCS	2
4	K2012	1/2"-13 Ny-Flange Lock Nut	2
5	B2310	Rear Main Frame Plate	1

## Upper Frame Bracket Installation

First, align the upper square carriage bolt holes of the Upper Main Frame Plate (Item #2) to the matching holes of the Left Upper Frame Mount (Item #1) and secure using (2) 3/8"-16 x 1" Carriage Bolts (Item #4) and (2) 3/8"-16 Ny-Flange Lock Nuts (Item #5). Refer to Figure A.

Next, align the Clevis pin hole of the Left Upper Frame Mount on the outside of the mower's ROPS. Secure with (1) Clevis Pin w/ Handle (Item #6), (1) 5/8" Flat Washer (Item #7), and (1) Hair Pin Clip (Item #8). Repeat the procedures for the Right Upper Frame Mount (Item #3) on the opposite side.

Leave hardware relatively loose until the next step.

Note: Some parts and part features have been hidden from view for visual clarity.

Figure A

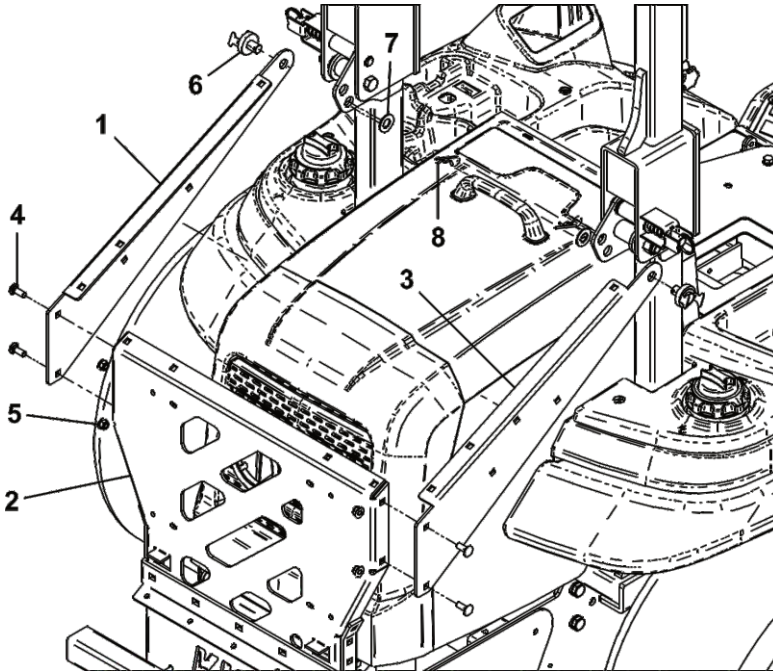

Item #	Part #	Desc.	Qty.
1	B2313	Left Upper Frame Mount	1
2	B2317	Upper Main Frame Plate	1
3	B2314	Right Upper Frame Mount	1
4	K1182	Carriage Bolt 3/8"-16 x 1" / Zinc / GR5	4
5	K2038	Ny-Flange Lock Nut 3/8"-16	4
6	A2468	5/8" Clevis Pin w/ Handle	2
7	K0058	5/8" Flat Washer	2
8	K0086	Hair Pin Clip .125 OD x 2.50	2

Position the Frame Gussets (Item #5) above the Upper Main Frame Plate (Item #2) aligning the bolt holes of both parts. Secure by using (4) 3/8"-16 x 1" Carriage Bolts (Item #6) and (4) 3/8"-16 Ny-Flange Lock Nuts (Item #7) on each side. See Figure below.

Next align the Frame Strap (Item #4) under each Upper Frame Mount and secure with (2) 3/8"-16 x 1" Carriage Bolts (Item #6) and (2) 3/8"-16 Ny-Flange Lock Nuts (Item #7).

Tighten all hardware at this time.

Note: Some parts and part features have been hidden from view for visual clarity.

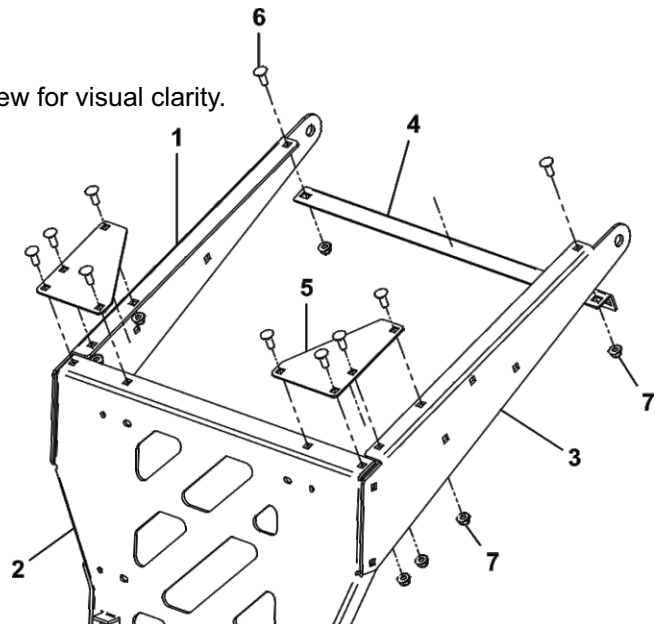

Item #	Part #	Desc.	Qty.
1	B2313	Left Upper Frame Mount	1
2	B2317	Upper Main Frame Plate	1
3	B2314	Right Upper Frame Mount	1
4	B2319	Frame Strap / Kioti ZXD	1
5	B2242	Frame Gusset / Top	2
6	K1182	Carriage Bolt 3/8"-16 x 1" / Zinc / GR5	10
7	K2038	Ny-Flange Lock Nut 3/8"-16	10



## Battery Box Reinstallation

First, with all hardware tightened reinstall the battery and secure with the battery hold tie-down. Next reconnect both battery terminals.

Finally reinstall the battery box cover and secure using (3) previously removed bolts.

Refer to Figures below.

Figure B



Figure A



Engine Mount Arm Assembly & Installation

Position the Outer Engine Mount Tube (Item #1) against the Rear Main Frame Plate aligning the Outer Tube between the two sets of mount holes as shown in Figure A. Secure the Outer Engine Mount Tube, relatively loose, by using (2) 3/8"-16 x 2-1/8" U-Bolts (Item #2) and (4) 3/8"-16 Ny-Flange Lock Nuts (Item #3). Once secured, adjust the Outer Engine Mount Tube positioning by moving it to the right until the right edge protrudes no more than 12" from the side of the Right Lower Frame Plate. Once adjusted, tighten all hardware.

Note: Some parts and part features have been hidden from view for visual clarity.

Figure A

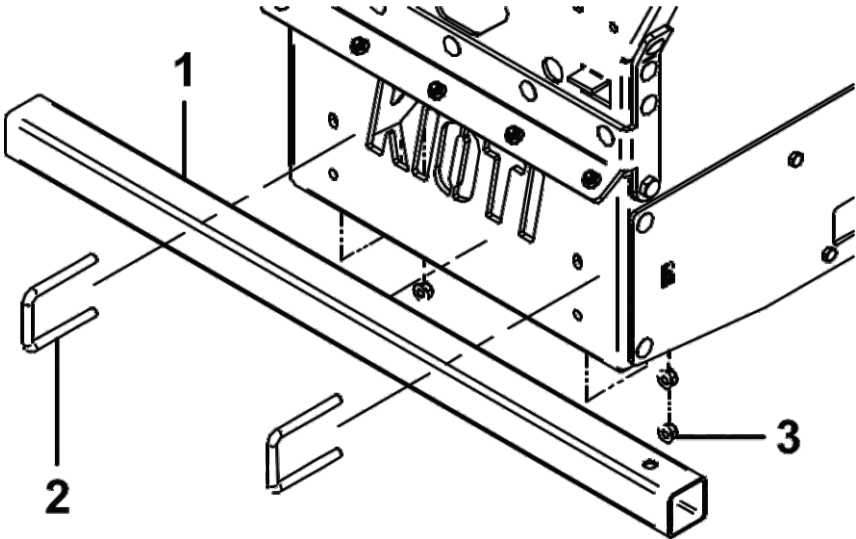

Item #	Part #	Desc.	Qty.
1	B3727	Outer Engine Mount Tube	1
2	K1460	U-Bolt 3/8-16 X 2-1/8 X 3-3/8	2
3	K2038	Ny-Flange Lock Nut 3/8"-16	4

Insert the Engine Mount Arm Assembly (Item #1) into the Outer Engine Mount Tube (Item #2) and position the mounting pin hole between the two parts. Secure the Engine Mount Arm Assy by using (1) Detent Pin (Item #3). Refer to Figure B below.

Figure B

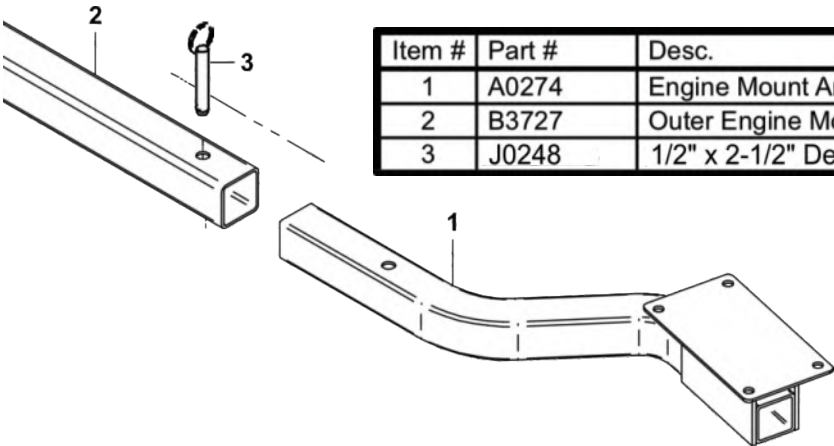

Item #	Part #	Desc.	Qty.
1	A0274	Engine Mount Arm Assy.	1
2	B3727	Outer Engine Mount Tube	1
3	J0248	1/2" x 2-1/2" Detent Pin	1

## Engine Drive Assembly Installation

### Engine Driven Unit Instructions

First, place (2) Rubber Shock Absorbers (Item #3) on top of the Engine Mount Arm Assembly (Item #2) aligning the bolt holes of the Rubber Shock Absorbers to those on the Engine Mount Arm Assy.

Next, position and place the 6.5HP Engine Assembly (Item #1) on top of the Shock Absorbers aligning the bolt holes of all the components.

Finally, secure the Engine by using (4) 5/16"-18 x 2" HHCS (Item #4) and (4) 5/16"-18 Nyloc Nuts (Item #5). Refer to Figure A.

Note: Some parts and part features have been hidden from view for visual clarity.

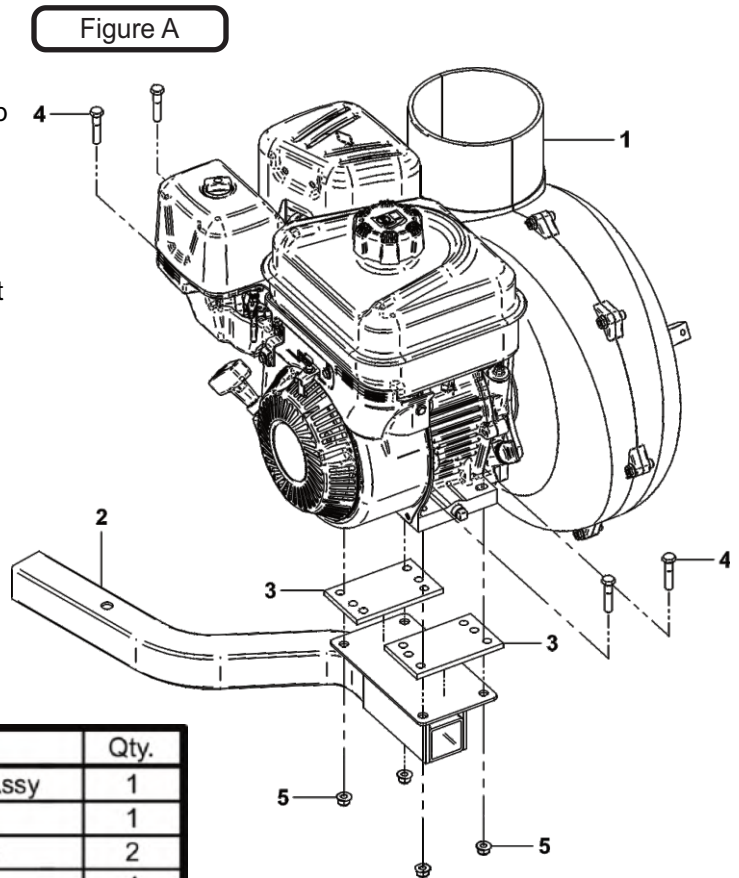

Item #	Part #	Desc.	Qty.
1	A643	BR6.5V Engine/Blower/Blade Assy	1
2	A0274	Engine Mount Arm Assy.	1
3	V1090	RUBBER SHOCK ABSORBER	2
4	K1159	5/16"-18 x 2" All Thread HHCS	4
5	K1180	5/16"-18 Nyloc Nut	4

## Blower Cone Installation

Thread (1) 5/16"-18 Jam Nut P#(K0120) onto each end of (2) 5/16"-18 x 2-1/2" HHCS P#(K0125) as shown in Figure B.

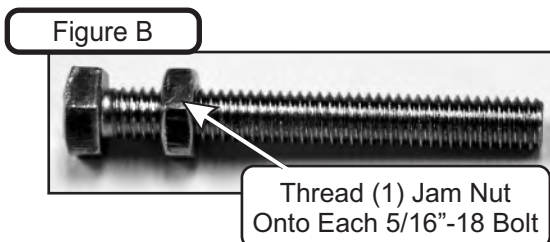

Now partially thread (1) bolt into each of the two threaded bosses located on the Blower Housing. Place 8" Blower Cone P#(E6009) so the two tabs line up with the bolts and tighten completely as shown in Figure C.

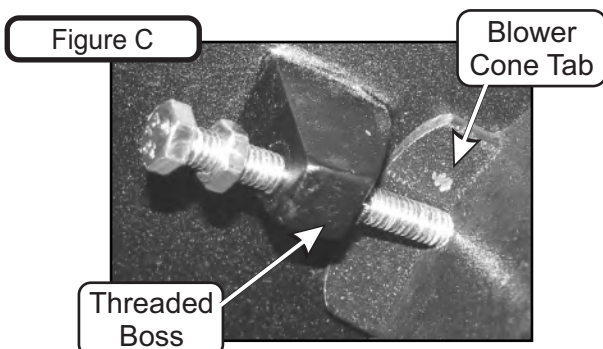

Once the (2) bolts are tight, tighten the Jam Nuts against the threaded boss as shown in Figure D.

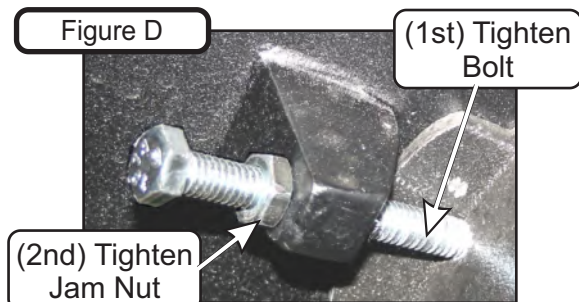

Refer to Figure E for proper Blower Cone installation reference.

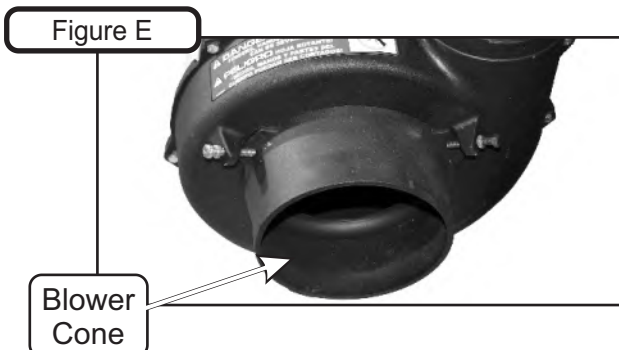



Deck Baffle Installation

Your unit will need to install a Deck Baffle (Item #1) to prevent any build up of grass clippings or to prevent any discharge / blowout from the front of your Aluminum Boot.

With your mower deck lifted, position the Deck Baffle (Item #1) under the Deck with the side edge of the baffle relatively flushed to the side of the deck.

Align the bolt holes of the Deck Baffle with the bolt holes on the deck and secure the Deck Baffle using (2) 5/16"-18 x 3/4" Carriage Bolts (Item #2) and (2) 5/16"-18 Ny-Flange Lock Nuts (Item #3). Refer to Figure A and Figure B.

The instructions above is also applicable for the installation of the 72" Deck Baffle Part#(B2325).

Note: Some parts and part features have been hidden form view for visual clarity.

Figure A

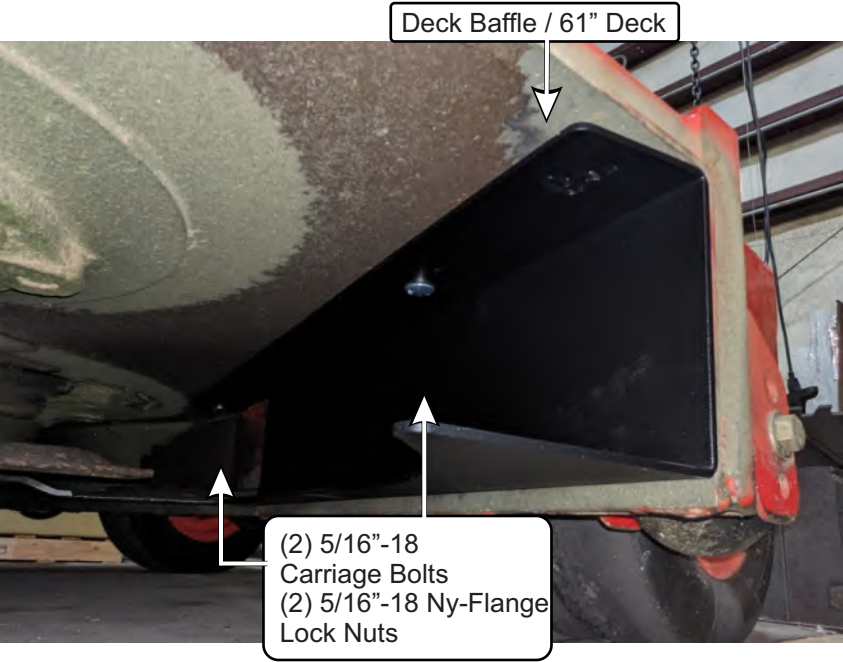
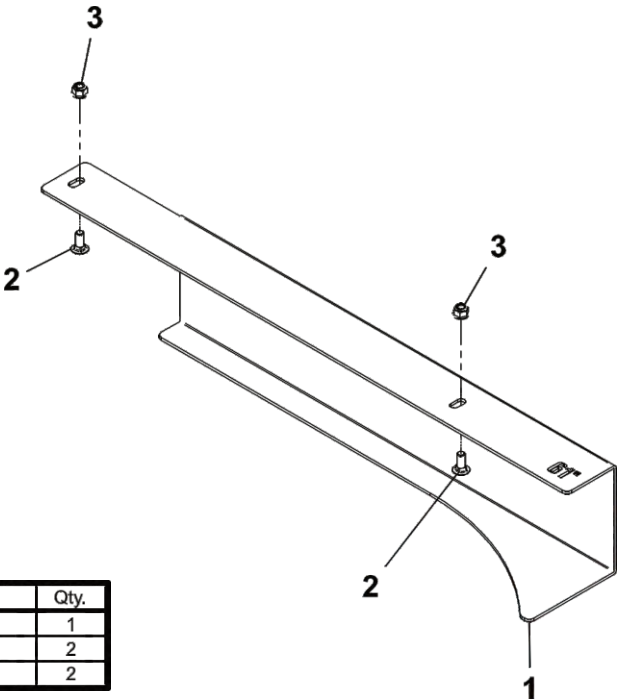

Figure B



Item #	Part #	Desc.	Qty.
1	B2324/B2325	Kioti ZXD Deck Baffle	1
2	K1142	5/16"-18 x 3/4" Carriage Bolt	2
3	K2516	Ny-Flange Lock Nut 5/16"-18	2

Boot Kit Installation

First, remove the mower's deck discharge chute deflector fasteners and set the discharge chute deflector aside. Then, secure the Boot Plate (Item #1) to the Aluminum Boot (Item #2) using (2) 3/8"-16 x 1" Carriage Bolts (Item #3) and (2) 3/8"-16 Ny-Flange Lock Nuts (Item #4), see Figure B. Leave the hardware loose until the boot plate has been attached to the mower deck.

Next, align the Boot Plate and deck as shown in Figure A. Insert (1) Boot Rod (Item #5) through the Boot Plate and deck mount tabs. Secure the Boot Rod using (1) Hair Pin Clip (Item #6). See Figure A and Figure B.

Finally, with the Carriage Bolts still loose, adjust the position of the boot so that there is no gap between the mower deck and the boot. Once adjusted, tighten all hardware at this time.

Note: 61" Model shown.



Figure B

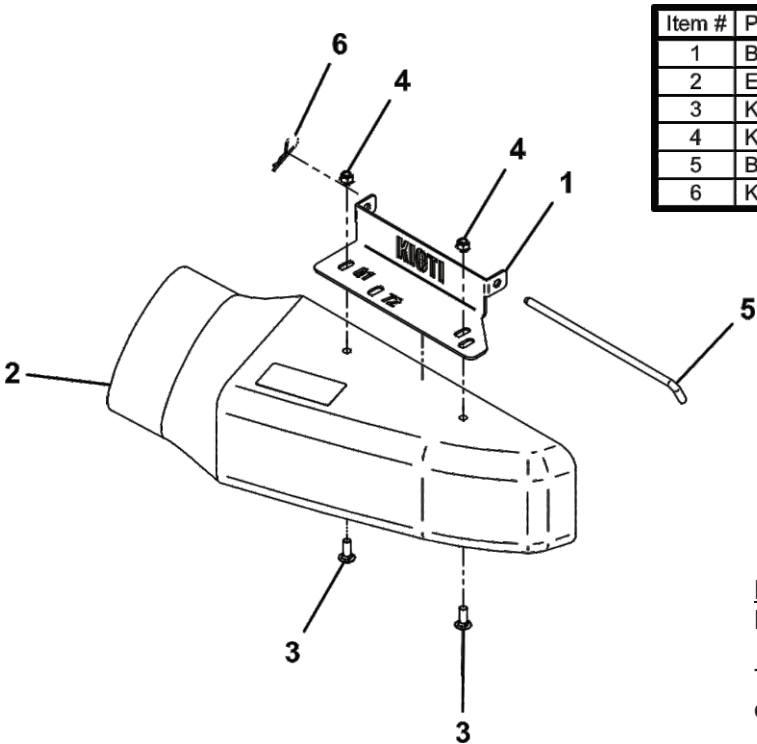

Item #	Part #	Desc.	Qty.
1	B2316	Boot Plate	1
2	E0032A/ E0023	Aluminum Boot	1
3	K1182	Carriage Bolt 3/8"-16 x 1" / Zinc / GR5	2
4	K2038	Ny-Flange Lock Nut 3/8"-16	2
5	B0333	Boot Rod	1
6	K0099	Hair Pin Clip 3/32"	1

Note: Insert the Carriage Bolts from the inside of the Boot so the threads are on the top of the Boot.

This will prevent grass clippings from collecting on the threads.

## Lower Mount Tube Installation

Secure the (2) Lower Mount Tubes (Item #1) to the Upper Main Frame Plate using (2) 5/16"-18 U-Bolts (Item #2) and (4) 5/16"-18 Ny-Flange Lock Nuts (Item #5) PER TUBE.

Note: Some parts and part features have been hidden from view for visual clarity.

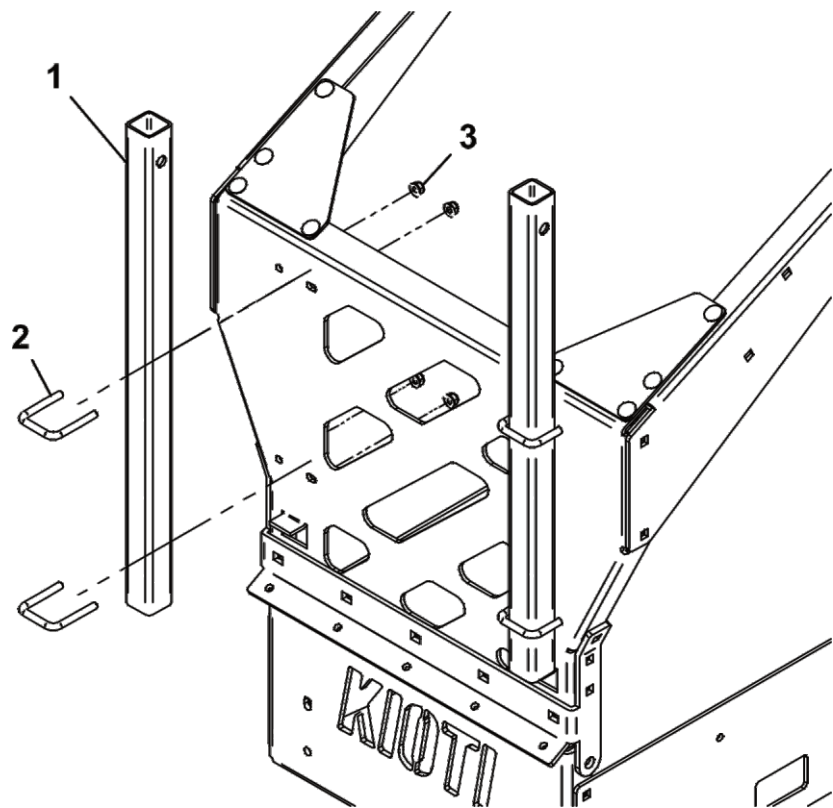

Item #	Part #	Desc.	Qty.
1	B0752	Lower Mount Tube / 25"	2
2	K1098	U-Bolt / 5/16"-18 x 2-3/8" x 1-3/4"	4
3	K2516	Ny-Flange Lock Nut 5/16"-18	4



# Upper Frame Assembly Installation

Position the Upper Frame Assembly (Item #1) above the Lower Mount Tubes as shown in Figure A.

Slide the Upper Frame Assembly down onto the Lower Mount Tubes and secure using (2) Clevis Pins (Item #2) and (2) Rue Ring Cotter Pin Clips (Item #3). Refer to Figure B.

Note: Some parts and part features have been hidden from view for visual clarity.

Figure A

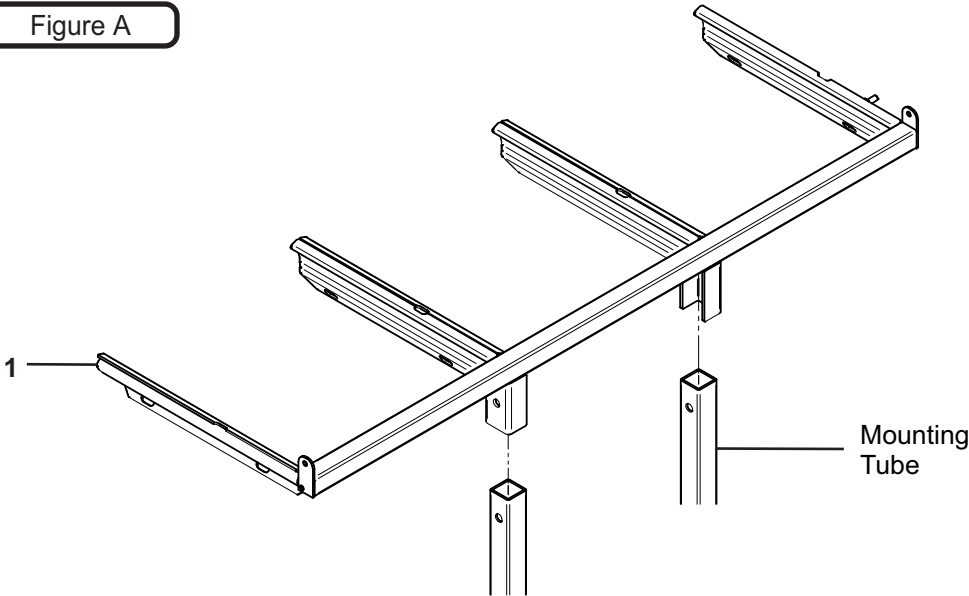

Item #	Part #	Desc.	Qty.
1	A2068	Upper Frame Assy P3B Gen G2	1
2	K0133	Clevis Pin 1/2" x 2-1/2"	2
3	K1437	Rue Ring Cotter Pin	2

Figure B

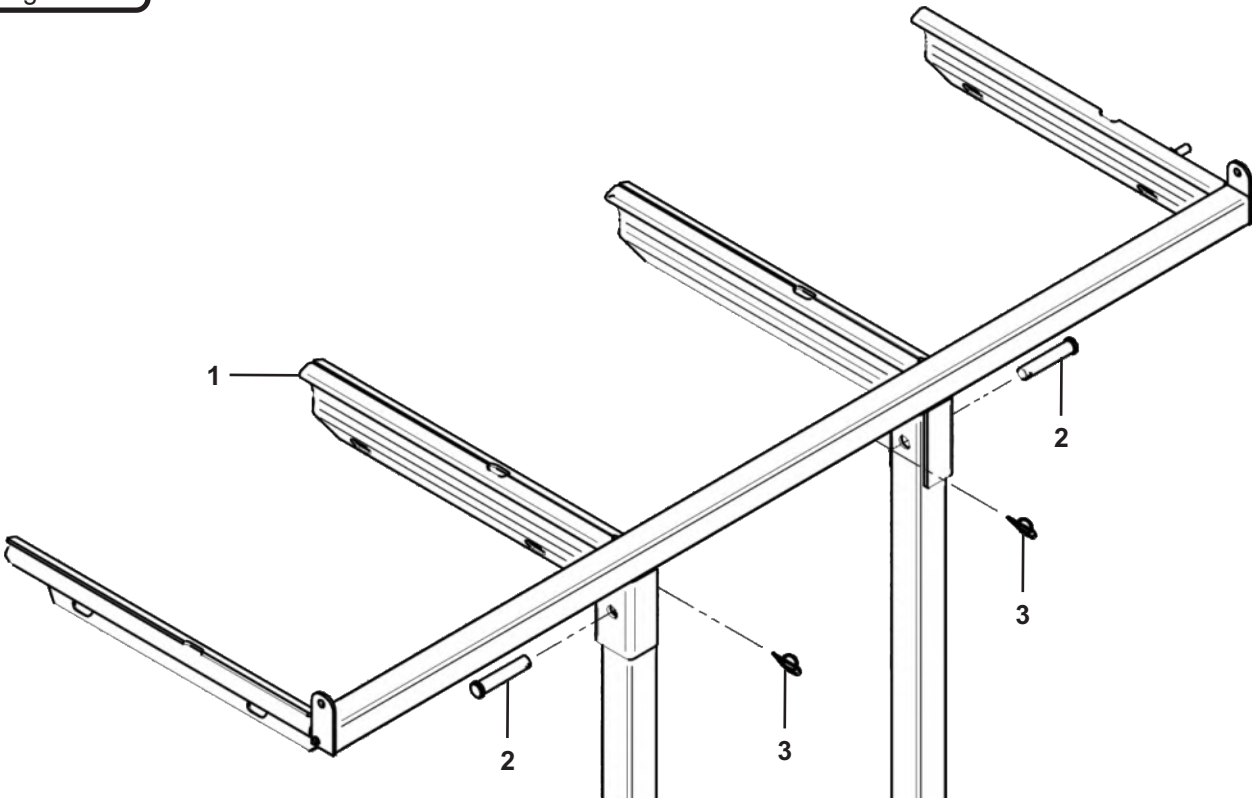

## Top Assembly To Upper Frame Assembly Installation

Align the Top Assembly Pivot Holes to the Upper Frame Assembly. See Figure A below. Before fastening, pull Rubber Dust Guard outward to seal against Upper Frame Assembly (towards the mower's operator seat). Fasten the Top Assembly to the Upper Frame Assembly using (2) 5/16"-18 x 2-1/2" HHCS P#(K0125) and (2) 5/16"-18 Ny-Flange Locknuts P#(K2516). Leave the Ny-Flange Locknuts slightly loose to allow the Top Assembly to open and close easily.

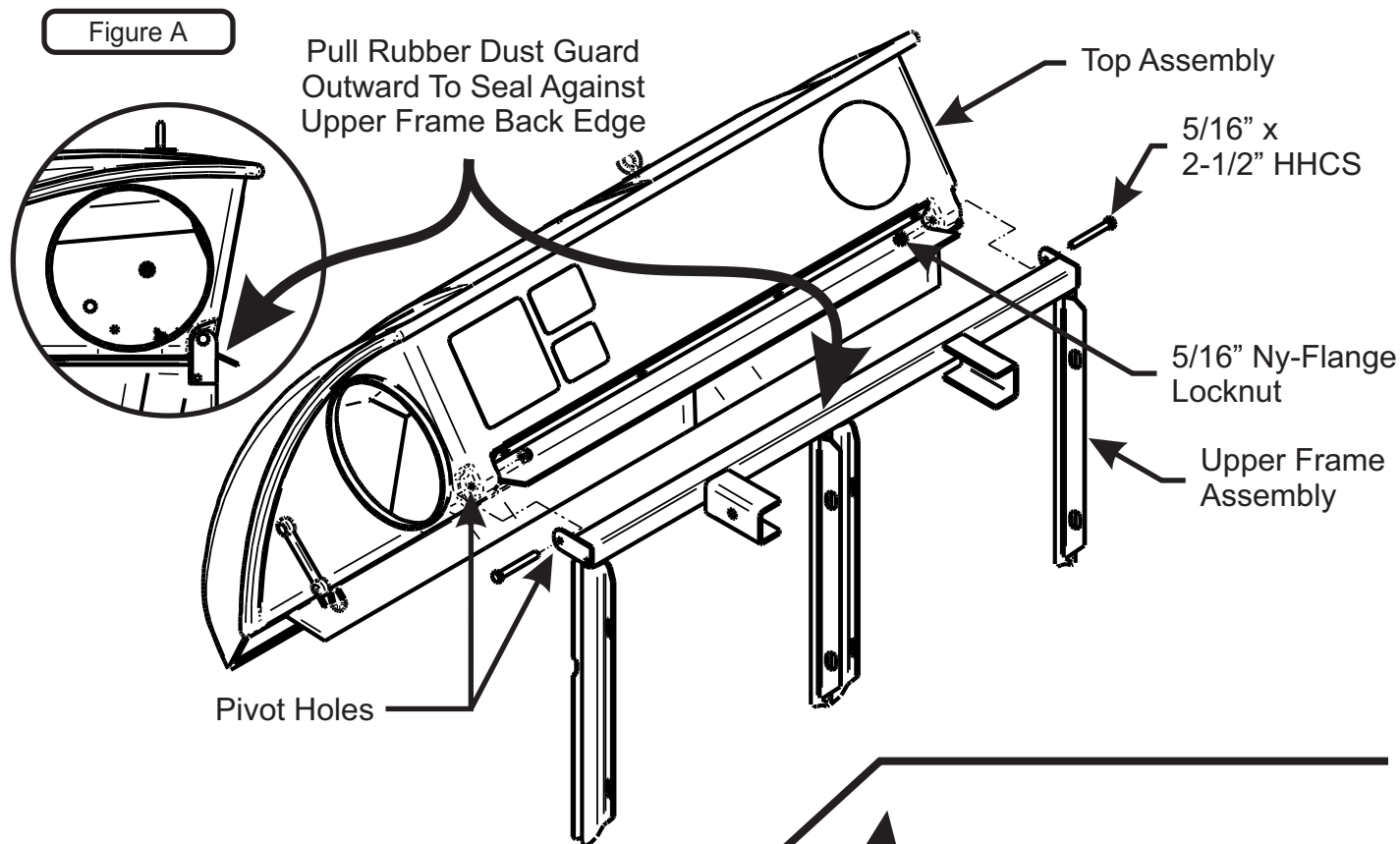

## Inlet Installation

Position the Top Assembly on its side with the Inlet Hole facing up. See Figure B. 1: Insert the Inlet from inside the Top Assembly, up through the Inlet Hole, until the Inlet Retaining Lip meets the Inlet Hole. 2: Position the Inlet as shown in Figure B, then pull the Inlet until a portion of the Inlet Retaining Lip protrudes from the Inlet hole. 3: Next, lift the Inlet as shown in Figure B until all of the Inlet Retaining Lip protrudes from the Inlet Hole. Once installed, the Inlet should pivot freely about the Inlet Hole.

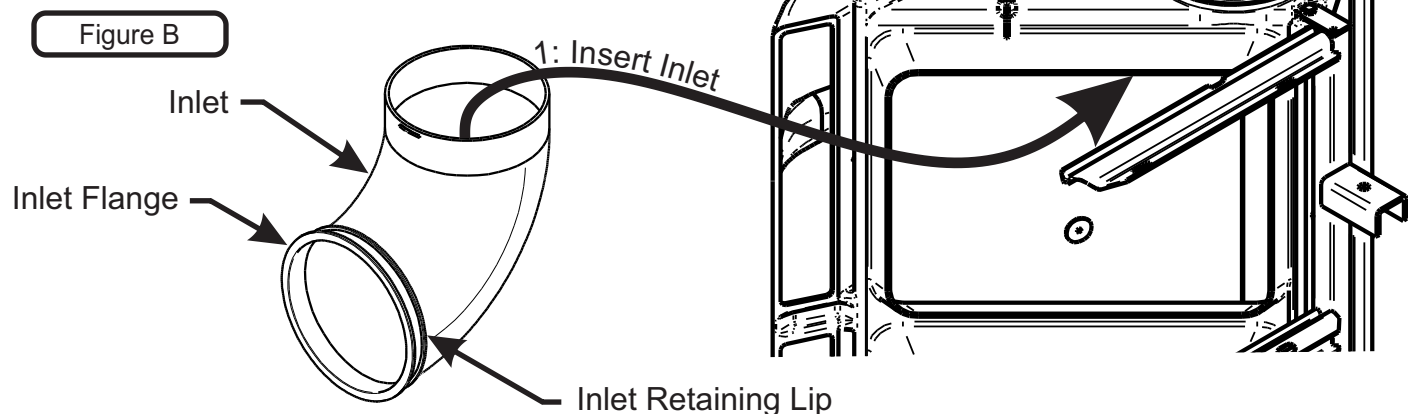

## Hinge Kit Assembly Installation

Assemble the Hinge Kit using (1) Latch Plate P#(B0884), (1) 5/16"-18 x 1-1/4" HHCS P#(K1156), (1) 5/16"-18 Ny-Flange Lock Nut P#(K2516), (3) 5/16" Flat Washers P#(K0042), (1) Latch Spacer P#(S0006), (2) Extra Heavy 5/16" Fender Washers P#(K0505) and (1) 5/16"-18 Lock Nut P#(K0506). Leave the nuts loose enough to allow fluid movement of the top when opening and closing. When opened, the top should rest in the Latch Plate Slot.

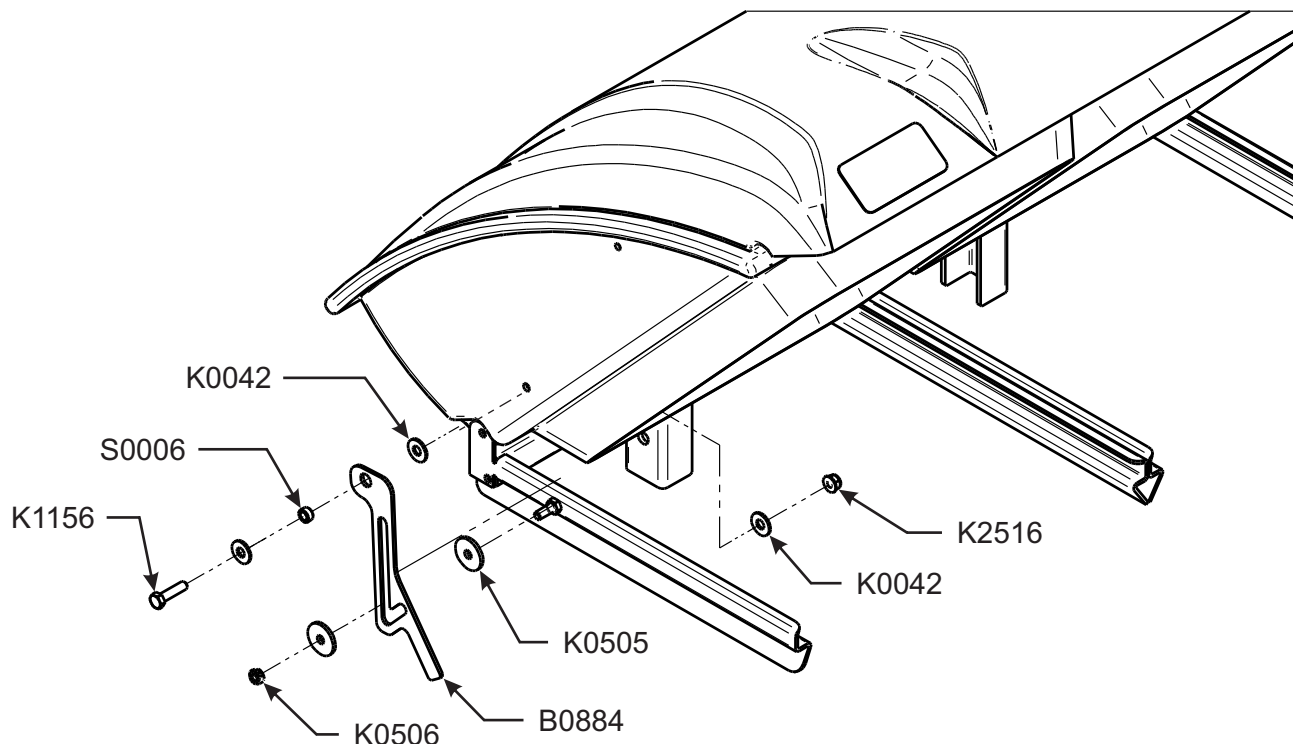

## Even Bag Fill Adjustment

Flap can be adjusted Up/Down depending on mowing conditions. Adjust flap up to allow more dense material to reach left bag. Adjust flap down to allow less dense material to reach the right bag. Once adjusted properly, both bags should fill evenly, but may require further adjusting when mowing conditions change.

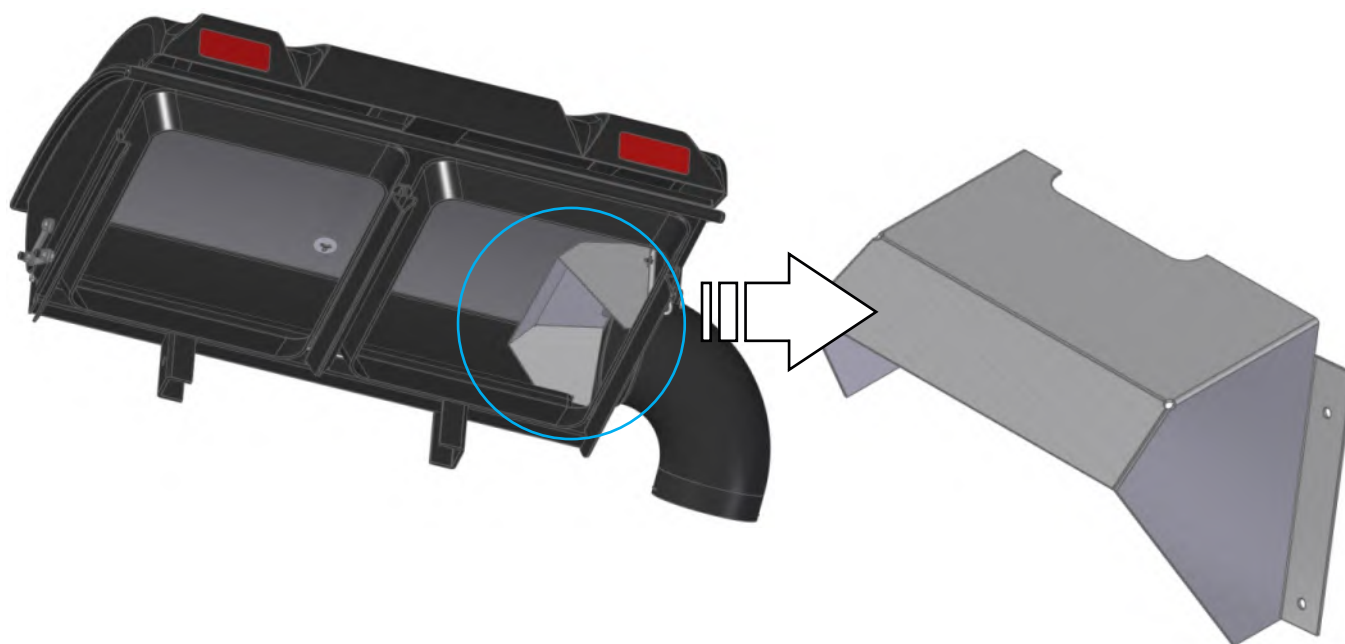



## Bag Assembly

First, take one of the Bag Ring Split Ends and insert it through the Bag Seam Opening. Next, rotate the Bag around the Bag Ring (1) full turn (360 degrees) until the Bag Ring Split Ends and the Bag Seam Opening are positioned on the same side. Then, connect the Bag Ring Split Ends using (1) End Connector. Last, rotate the Bag Ring and the End Connector Assembly (1/2") turn (180 degrees) to position the Connector opposite of the Bag Seam Opening. Note Final End Connector Location below in Figure A. Repeat for each Bag.

Figure A

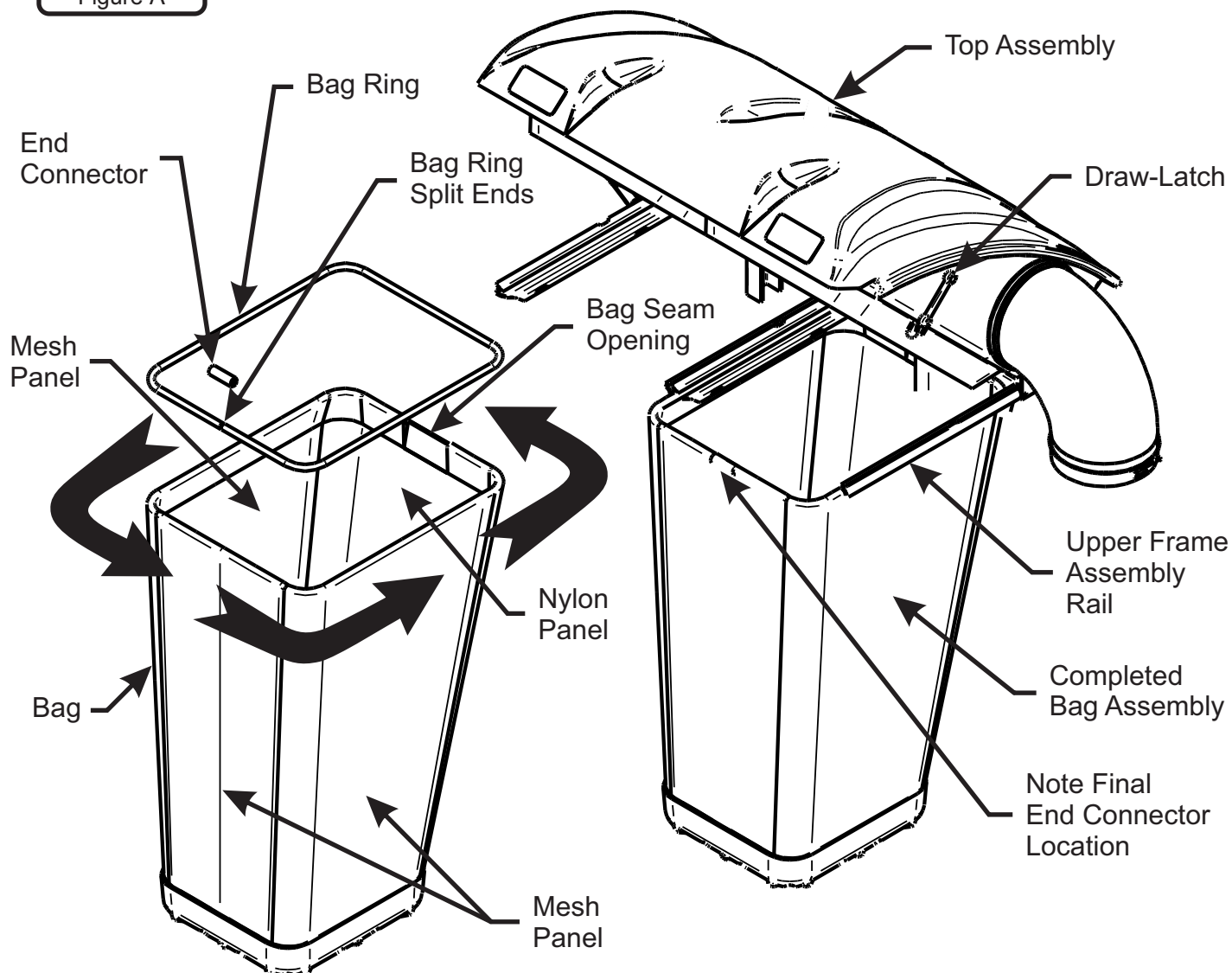

## Bag Assembly Installation

Slide the Completed Bag Assembly into the Upper Frame Assembly Rails and close the Top Assembly. Fasten the Draw-Latch on either side to hold the bagger closed.

## Length Of Hose Adjustment

The hoses in the following steps must be cut to fit your machine. Do not cut the hoses until you have tried to fit them on your machine. Remember that the hoses need to be long enough to allow for the opening and closing of the collection system as well as allowing ample clamping surface between each component.

## Upper Hose Installation

Slide a Hose Clamp P#(J0060) over one end of the 6" Upper Hose. Secure this end of the 6" Upper Hose to the Blower Outlet. See Figure below for details. Secure opposite end of the 6" Upper Hose to the Inlet. Make sure both ends are securely fastened by tightening the Hose Clamp and rotating the Inlet Snap Fastener towards the hose to lock in place.

## Lower Hose To Blower Cone Installation

Slide a Hose Clamp P#(J0080) over both ends of the Lower Hose. Secure one end of the Lower Hose to the Blower Cone and fasten by tightening the Hose Clamp.

## Lower Hose To Boot Installation

Take the unattached end of the Lower Hose and secure it to the circular end of the Boot and fasten by tightening the Hose Clamp.

Tip: Before securing Hose Clamp fully, rotate Lower Hose counter-clockwise (away from yourself) approximately 1" to aid in retaining Boot to mower deck.

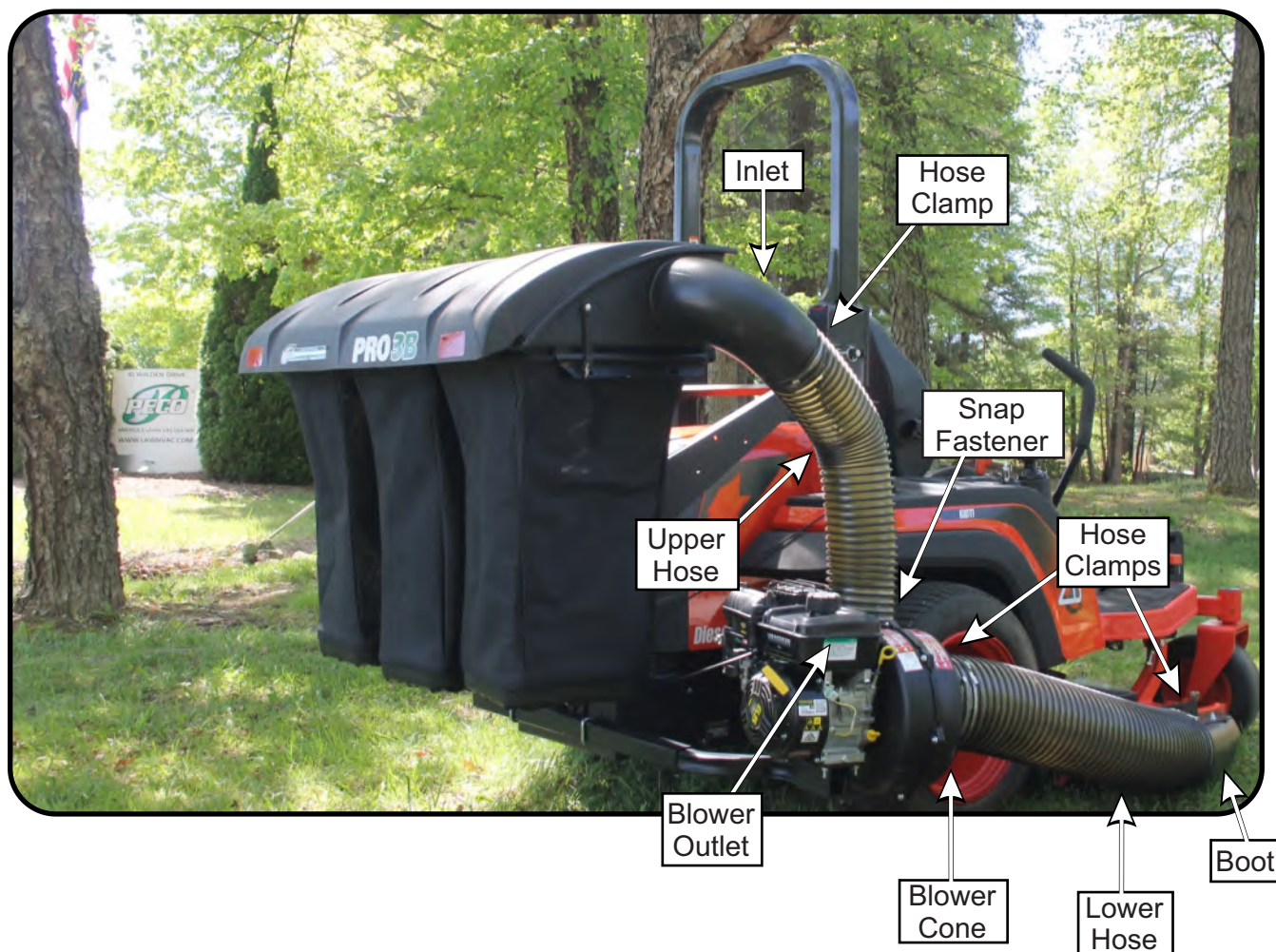

# Throttle Kit Installation

## Engine Driven Unit Instructions

The Throttle Kit is installed on the right side ROPS above of the Right Frame Bracket / Upper, see Figure B.

Place the 3/8"-16 U-Bolt (Item #3) onto the right side ROPS with the threads facing out away from the side of the mower. Next slide on the Throttle Mount Plate Assembly (Item #1) with the rivets also facing outward away from the side of the mower. Secure the Throttle Mount Plate Assy to the ROPS by using (2) 3/8"-16 Ny-Flange Lock Nuts (Item #4). Refer to Figure A.

With the Throttle Cable Kit facing back towards the Mower's rear, place the Throttle Base Plate over the rivets, slide the Throttle Cable Kit to the right, moving the smaller end of the slot over the rivets. When positioned correctly, the Throttle Spring Plate will snap into place, see Figure A.

To remove the Throttle Cable Kit, lift the Throttle Spring Plate and slide the Throttle Kit to the left.

Note: Some parts and part features have been hidden from view for visual clarity.

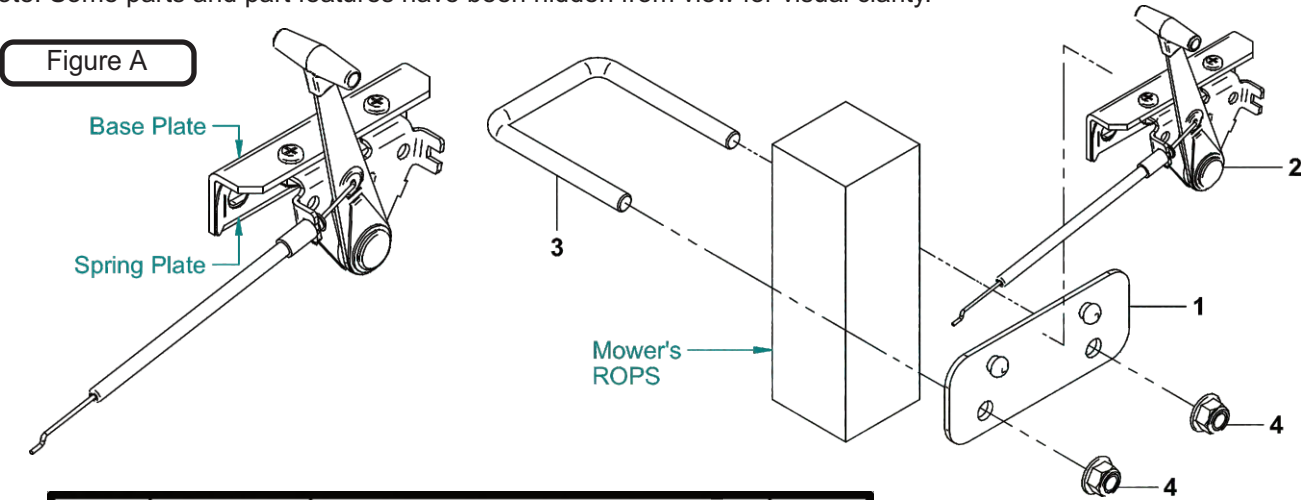

Item #	Part #	Desc.	Qty.
1	A0666	THROTTLE MNT. PL. ASSY.	1
2	A0060	70" THROTTLE CABLE KIT	1
3	K0136	U-Bolt / 3/8"-16 x 2.562" x 3.50"	1
4	K2038	Ny-Flange Lock Nut 3/8"-16	2

Figure B

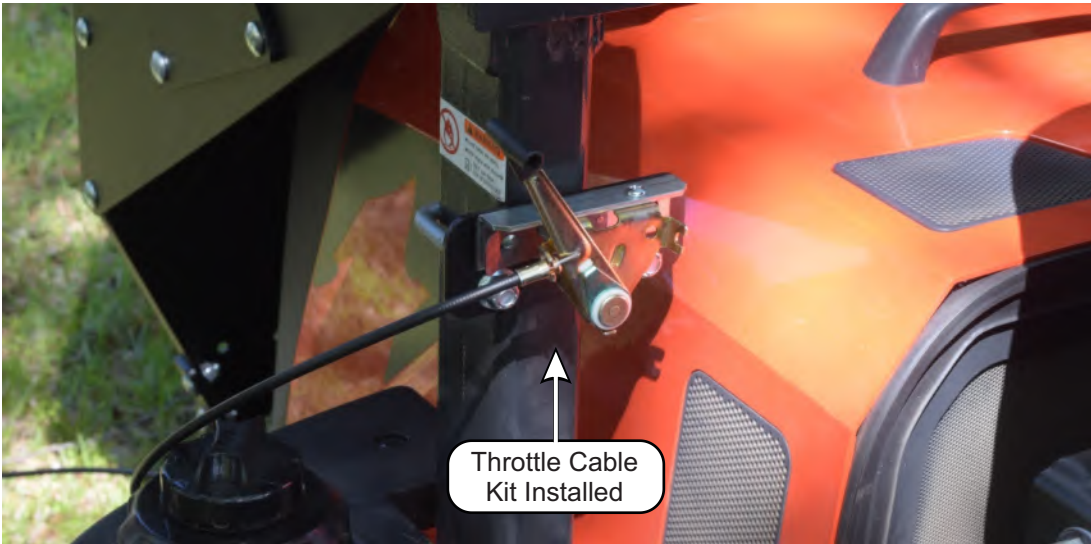



## **Throttle Kit Installation (Continued)**

With your Throttle Kit installed, you'll need to route the cable of the Throttle Kit back towards the rear of the Mower. Refer to Figure C below.

Finally, place the Throttle control lever into the "STOP" position. Rotate the Engine's throttle lever to the "STOP" position. Thread the wire end of the Throttle Cable into the Engine's throttle lever eyelet and tighten the screw. Fasten the throttle cable sleeve to the clamp on the Engine throttle. See Figure C.

Rotate the throttle control lever into the "fast" position to check for proper installation. Make sure the Cable does not interfere with any mower or unit components.

Figure C

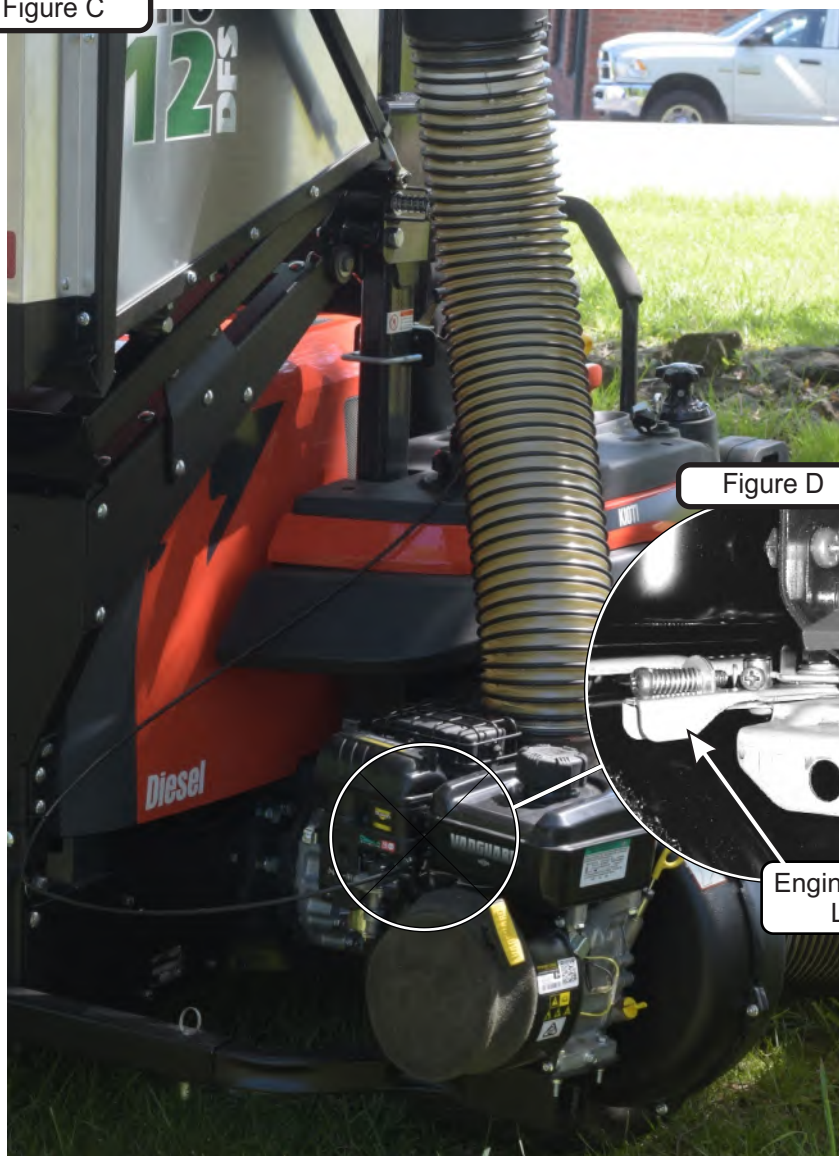

Figure D

Engine Throttle  
Cable Clamp

Engine Throttle  
Lever

## Impeller Blade Removal/Replacement

**To Remove:** First, remove the 5/16"-24 x 1-1/2" HHCS P#(K1465) **(#1)**, Double Indented Washer P#(K0284) **(#2)**, (2) 5/16" Flat Washers P#(K0042) **(#4)** and Spacer Bushing P#(S0159) **(#5)** from the Taper-Lock Bushing P#(S0157) **(#6)**.

Next, remove the (2) 1/4"-20 x 1" HHCS **(#3)** and place them into the threaded holes of the Taper-Lock Bushing **(#6)**. Gradually thread each bolt evenly into the Taper-Lock Bushing forcing the blade to break-away from the Taper-Lock Bushing. If the Impeller will not move, carefully hit the base of the Impeller, between each vein, with a hammer, then try again.

**To Replace:** First, place the Impeller Blade over the engine shaft. Slide the Taper-Lock Bushing **(#6)** onto the engine shaft and into the Impeller Blade, aligning the **non-threaded** holes of the Taper-Lock Bushing to the threaded holes of the Impeller Blade.

Then, fasten the Impeller Blade by using (2) 1/4"-20 x 1" HHCS **(#3)**, (1) Spacer Bushing **(#5)**, (1) Double Indented Washer **(#2)**, and (1) 5/16"-24 x 1-1/2" HHCS **(#1)**. Torque bolts to their proper specifications as listed in the Torque Chart on the back of this Manual.

Finally, rotate the Impeller Blade to ensure that the blade is clear of contact on all sides of the Blower Housing. If there is interference, remove the Taper-Lock Bushing, reposition the Impeller Blade further from the Blower Housing, re-tighten the hardware, and then check for clearance.

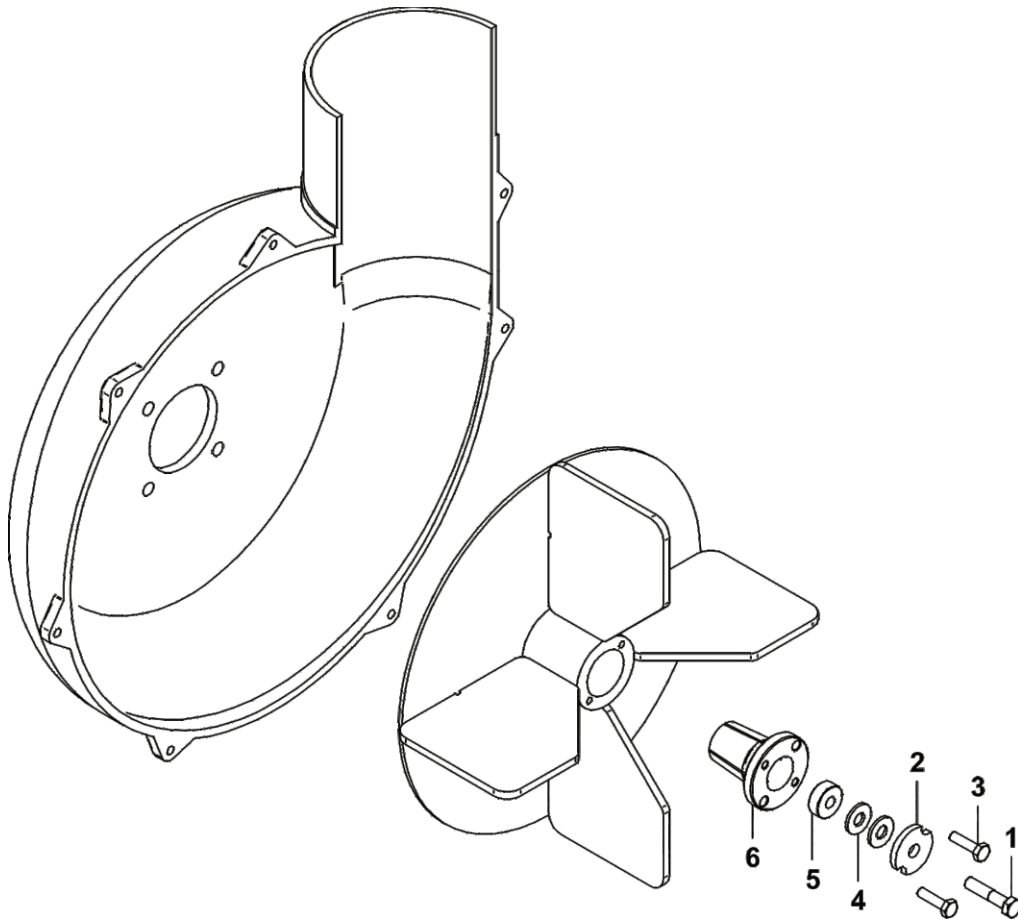

Item #	Part #	Desc.	Qty.
1	K1465	HHCS 5/16"-24 x 1-1/2" GR8	1
2	K0284	Double Indented Washer 3/8" / 1.375 OD x .380 ID x .179 T	1
3	K1225	HHCS 1/4"-20 X 1" GR8	2
4	K0042	Flat Washer 5/16" / .875 OD x .380 ID x .075 T	2
5	S0159	Spacer Bushing .938 OD x .325 ID x .375 T	1
6	S0157	Taperlock Bushing 7/8"	1

# Weight Kit Installation

To install the (4) Weights, first position the (2) 3/8"-16 U-Bolts (Item #1) over the front caster arm & secure to the Weight Bracket (Item #4) using (2) 3/8"-16 Ny-Flange Lock Nuts (Item #3).

Next align the mount hole of the Weights w/ the hole on the Weight Bracket tab. Fasten the Weights to the Weight Bracket by using (2) Hitch Pins (Item #7), (2) 1/2" Flat Washer (Item #6) & (2) Hair Pin Clip (Item #2). See Figures below.

Note: Some parts and part features have been hidden from view for visual clarity.

Figure A



Item #	Part #	Desc.	Qty.
1	K0136	U-Bolt / 3/8"-16 x 2.562" x 3.50"	2
2	K0086	Hair Pin Clip .125 OD x 2.50	2
3	K2038	Ny-Flange Lock Nut 3/8"-16	4
4	B2322	Weight Bracket / Kioti ZXD	1
5	Y0025	28 lb. Suitcase Weight	4
6	K0055	Flat Washer 1/2" / 1.383 OD x .560 ID x .120 T	2
7	A0312	Hitch Pin Weldment	2

Figure B

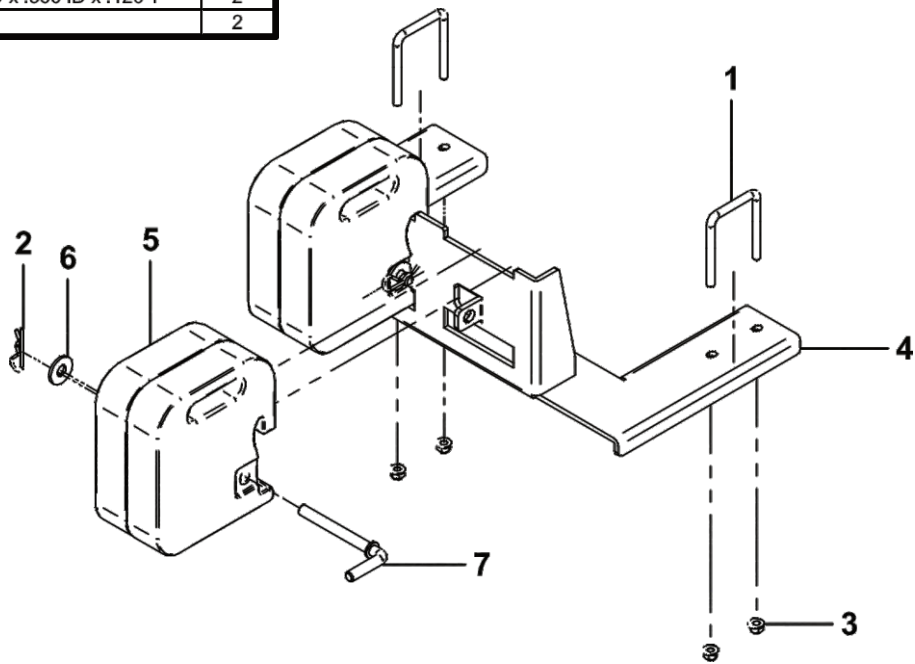



**A639 Briggs & Stratton 6.5HP Vanguard Engine Drive Assembly**

Item #	Part #	Desc.	Qty.
1	E4052B	Blower Hsg Back	1
2	A0645	4-Blade Impeller Weldment	1
3	B1933_01	Spacer / Blower Housing	2
4	K0374	5/16"-24 x 1-1/2" HHCS GR5	4
5	K0044	I/T Tooth Lock Washer 5/16"	4
6	S4302	Taper-Lock Bushing / 1" Shaft	1
7	K1225	HHCS 1/4"-20 X 1" GR8	2
9	K0284	Double Indented Washer 3/8" / 1.375 OD x .380 ID x .179 T	1
10	S3242	Spacer Bushing / .750 ID x .380 ID x .830 L	1
11	K1138	HHCS 3/8"-24 x 1-1/2" GR8	1

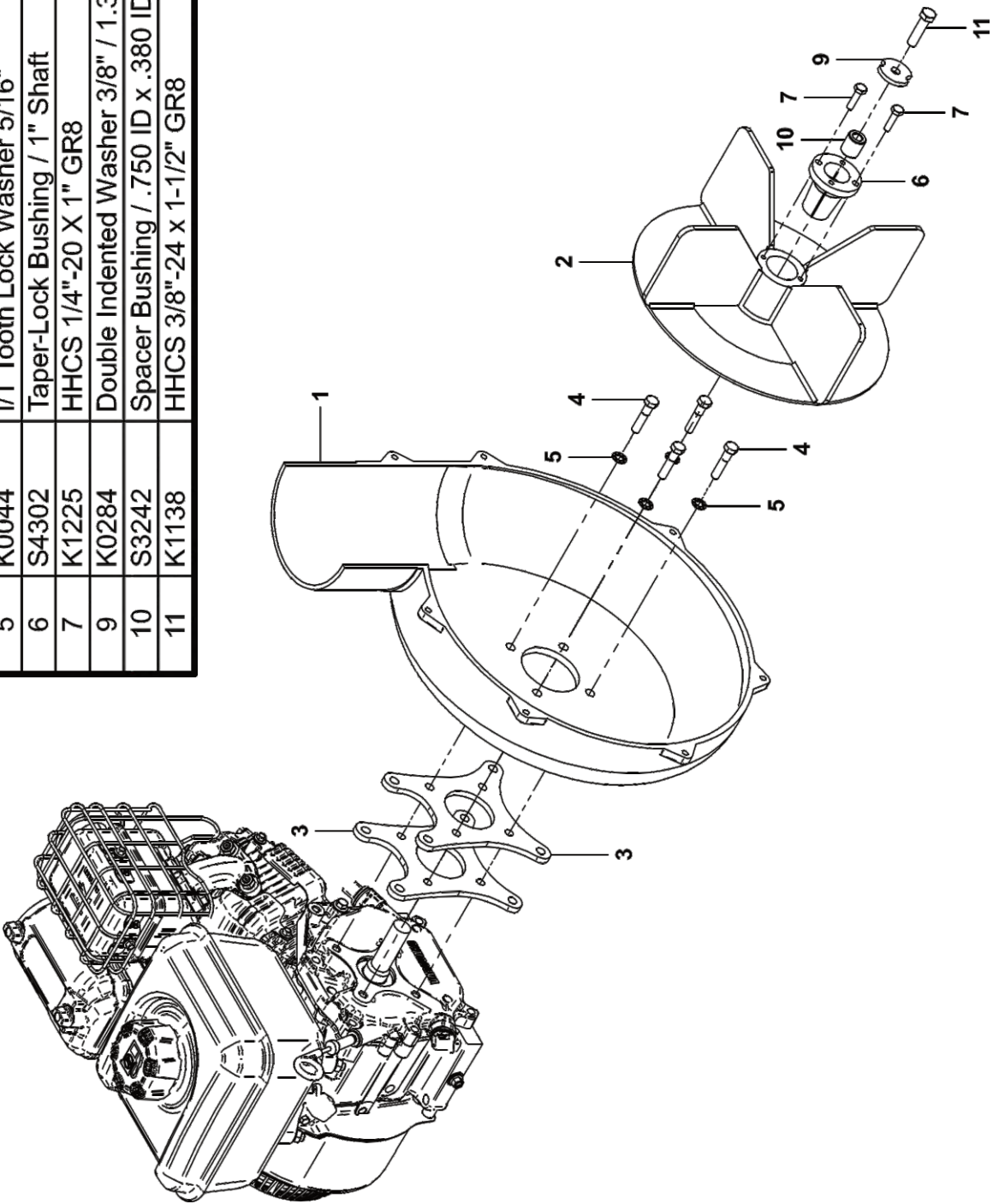

**A1158 Top Assembly w/ PECO Logo**  
**Exploded Parts View**

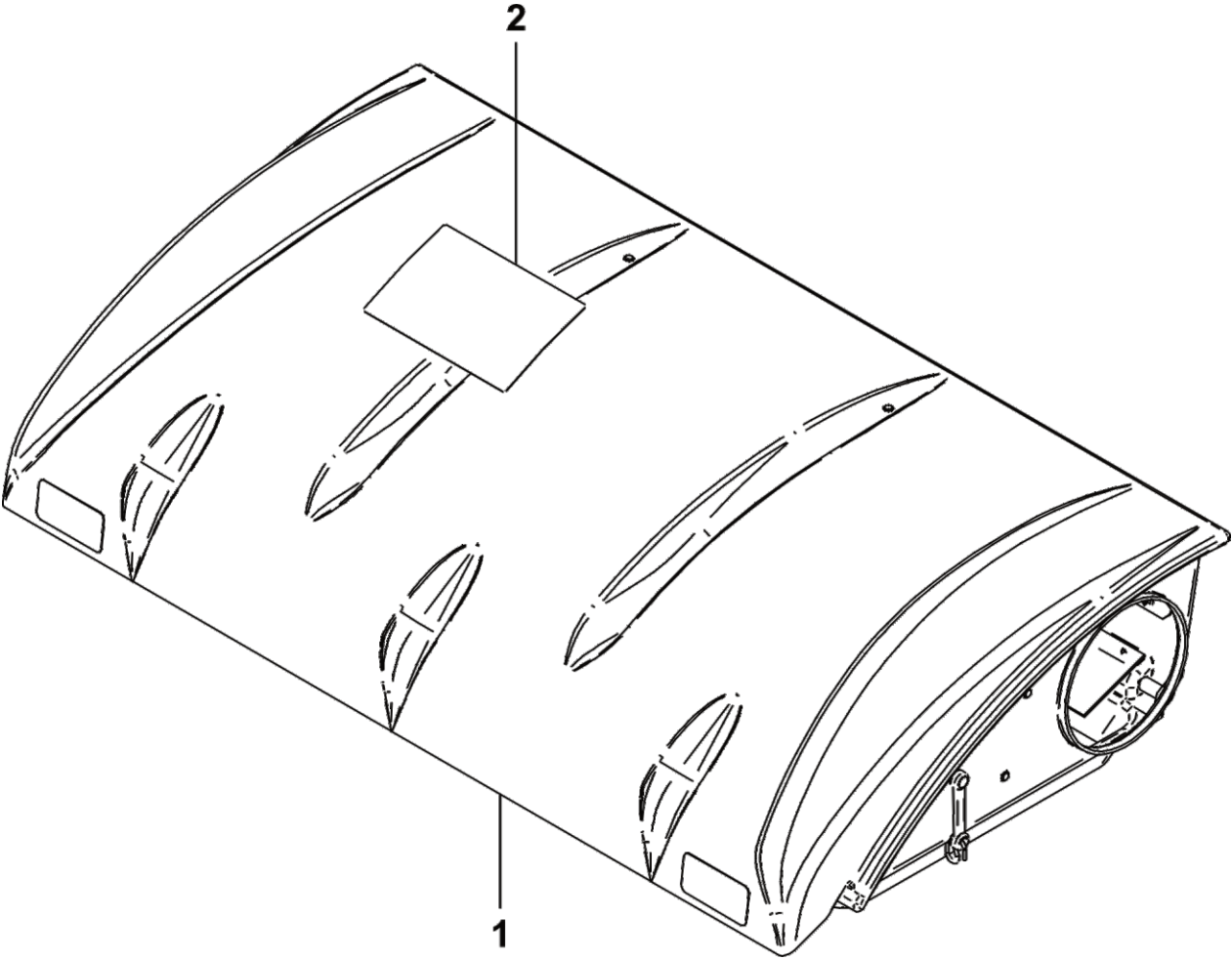

Item #	Part #	Desc.	Qty.
1	A1157	Top Assy / P3B / Standard Model	1
2	R1070	PECO Logo Decal	1

## **A1157 Top Assembly w/ Dual Latch**

### **Exploded Parts View**

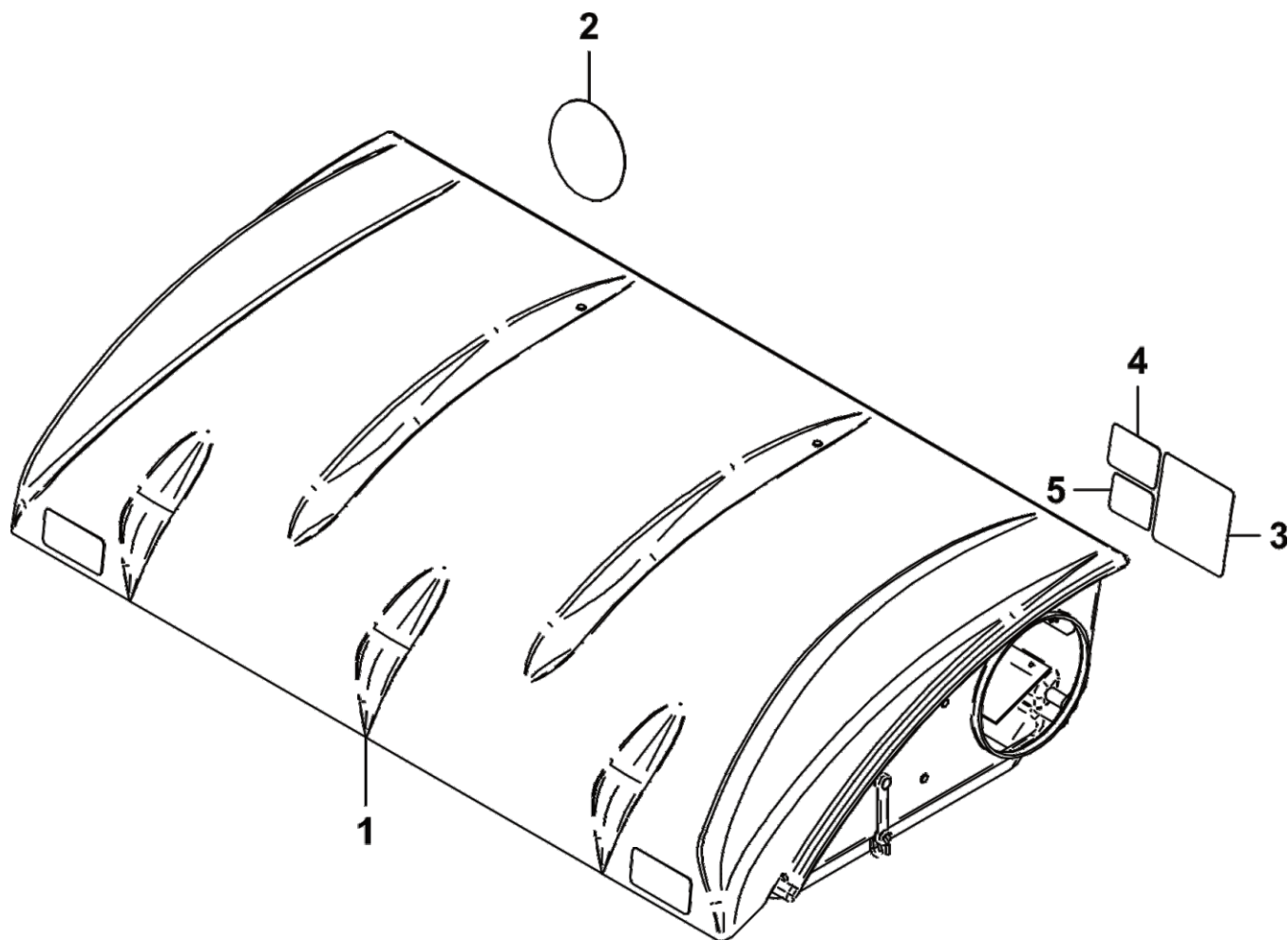

Item #	Part #	Desc.	Qty.
1	A2223	Top Assy. / P3B / Base Model	1
2	R0022	Decal / Built In The USA / Lg	1
3	R1069	Decal / Warning - Turn Off Blower	1
4	R1054	Decal / Important Check Hoses	1
5	R1051	Decal / Warning - Use Hearing Protection	1



## A2223 Top Assembly Base Model

### Exploded Parts View

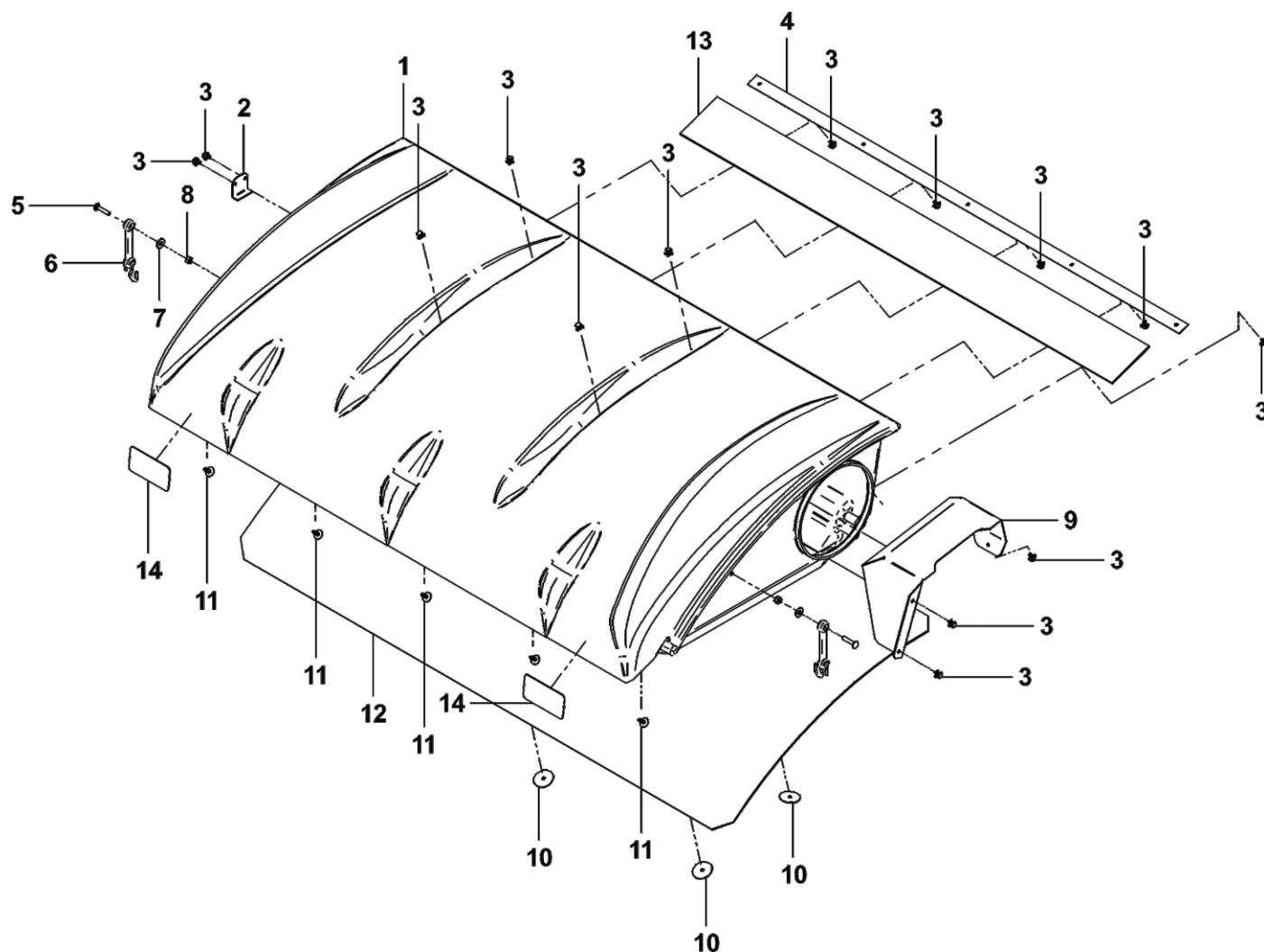

Item #	Part #	Desc.	Qty.
1	V0022	Pro 3 Bagger Top	1
2	B0676	Hinge Stop Pl.	1
3	K0114	Black Plastic Rivet	14
4	C0069	Dust Guard Brace	1
5	K1030	1/4"-20 x 1-1/4" Carriage Bolt	2
6	J4009	Short Rubber Strap w/ S-Hook	2
7	K0037	Flat Washer / 1/4" (.75 OD x .312 ID x .060 T)	2
8	K1128	1/4"-20 Nyloc Nut	2
9	C0026	Grass Deflector	1
10	K0062	Fender Washer / .230 ID x 1.500 OD / Zinc	3
11	K1265	Black Panel Retainer	5
12	V1120	Black Plastic Screen	1
13	V1118	Dust Guard	1
14	R1057	Decal / 2" x 4" Red Reflector	2

## SAFETY DECALS

To promote safe operation, New PECO, Inc. supplies safety decals on all products manufactured. Damage can occur to safety decals either through shipment, use or reconditioning. Contact your local Service Center for replacement decals.



Part# R1070  
PECO Logo



Part# R0022  
Designed & Built  
In The USA



Part #: R2007  
Danger - Never Use Hands



Part #: R2008  
Danger - Rotating Blades

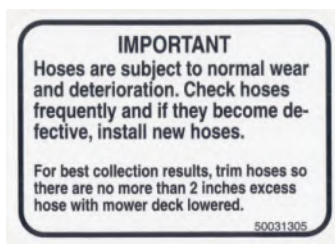

Part #: R1054  
Important - Hose Wear

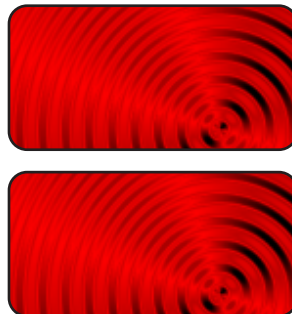

Part #: R1057 - (2)  
Red Reflectors



Part #: R1069  
Warning - Turn Off Blower



Part # R0024  
Danger - Keep Hands  
Clear



Part #: R1051  
Warning - Hearing Protection



Part # R0025  
Danger - Rotating  
Blades

# Troubleshooting Collection System Performance

2017 (v1.0)

<b>Problem</b>	<b>Possible Cause</b>	<b>Corrective Action</b>
Abnormal Vibration	<ul style="list-style-type: none"> <li>• Cutting blades are bent or unbalanced</li> <li>• Loose blower pulley or pulley assembly</li> <li>• Impeller blade out of balance</li> </ul>	<ul style="list-style-type: none"> <li>• Install new cutting blade</li> <li>• Tighten the pulley</li> <li>• Contact dealer to replace</li> </ul>
Reduced collection system performance	<ul style="list-style-type: none"> <li>• Low engine speed</li> <li>• Plugged screen</li> <li>• Loose belt</li> <li>• Full collection bags</li> </ul>	<ul style="list-style-type: none"> <li>• Always operate collection system at full throttle</li> <li>• Remove debris, leaves, or grass clippings from the screen</li> <li>• Replace/tighten belt</li> <li>• Empty the collection bags</li> </ul>
Blower and hoses plugging too frequently	<ul style="list-style-type: none"> <li>• Collection bags are too full</li> <li>• Low engine speed</li> <li>• Grass is too wet</li> <li>• Grass is too long</li> <li>• Ground speed is too fast</li> <li>• Worn belt</li> <li>• Loose belt</li> </ul>	<ul style="list-style-type: none"> <li>• Dump more frequently</li> <li>• Always operate collection system at full throttle</li> <li>• Cut grass when it is dry</li> <li>• Cut the grass several times</li> <li>• Drive slower at full throttle</li> <li>• Replace belt</li> <li>• Adjust the pulley and tighten belts</li> </ul>
Debris blowout	<ul style="list-style-type: none"> <li>• Collection bags are too full</li> <li>• Plug/clog in the collection system</li> <li>• Ground speed is too fast</li> </ul>	<ul style="list-style-type: none"> <li>• Dump more frequently</li> <li>• Clean the collection system</li> <li>• Drive more slowly at full throttle</li> </ul>
Impeller doesn't rotate freely	<ul style="list-style-type: none"> <li>• Plug in the blower housing</li> <li>• Worn impeller blade</li> <li>• Shaft bearings bad/failing</li> </ul>	<ul style="list-style-type: none"> <li>• Clean the blower housing</li> <li>• Contact dealer to replace</li> <li>• Contact dealer to replace</li> </ul>



## PECO LIMITED WARRANTY FOR NEW PRODUCTS

New PECO, Inc. extends the following warranties to the ORIGINAL PURCHASER of each New PECO, Inc. consumer product purchased from one of our Dealers or directly from New PECO, Inc., subject to the following limitations:

### A. ITEMS COVERED UNDER WARRANTY

1. **PRODUCT WARRANTY** – Any part or parts which are deemed defective in material or workmanship, as delivered to the original purchaser, will either be repaired or replaced, as New PECO, Inc. elects, without charge for parts or labor, if the defect appears within 12 months from the date of purchase of the product to the Original Purchaser.
2. **PARTS REPLACED DURING WARRANTY** – Any New PECO, Inc. part which is furnished in performance of this warranty and is defective in material or workmanship as delivered to the purchaser will be repaired or replaced, as New PECO, Inc. elects, before the expiration of the original warranty period.

### B. WARRANTY DISTINCTIONS

1. **RESIDENTIAL** - Products put to a personal use around a single household or residence are considered Residential. Products designated as “Residential” are warrantied for 12 months from the date of purchase of the product, to the ORIGINAL PURCHASER with proof of purchase, when used for or in residential applications.
2. **COMMERCIAL** – Products put to any business use (agricultural, commercial or industrial) or used at multiple locations are considered Commercial. Products designated as “Commercial” are warrantied for 12 months from the date of purchase of the product, to the ORIGINAL PURCHASER with proof of purchase, when used for or in commercial applications. Products designated as “Residential” are warrantied for 90 days from the date of purchase of the product, to the ORIGINAL PURCHASER with proof of purchase, when used for or in Commercial applications.
3. **RENTAL** – Products used for Rental or Lease Purposes are warrantied for 45 days from date of purchase of the product, to the ORIGINAL PURCHASER with proof of purchase, when used for or in a rental business.

### C. ITEMS NOT COVERED BY NEW PECO WARRANTY

1. **ENGINES & BATTERIES:** Engines and Batteries attached to New PECO, Inc. products are covered under their respective separate manufacturer warranties and those companies must be contacted directly to file a warranty claim. Briggs & Stratton: [https://www.briggsandstratton.com/na/en\\_us/support/warranty.html](https://www.briggsandstratton.com/na/en_us/support/warranty.html)
2. **UNAPPROVED ALTERATION OR MODIFICATION:** All obligations of New PECO, Inc. under this warranty shall be terminated if products are altered or modified in any way not approved by New PECO, Inc.
3. **ACCIDENTS & NORMAL MAINTENANCE:** This warranty covers ONLY manufacturers defective material and workmanship. It does not cover depreciation or damage caused by normal wear & tear, accident, improper maintenance, misuse or abuse of products. New PECO, Inc. products must be operated and maintained in accordance with the instructions furnished in the manuals. The cost of normal maintenance and normal replacement of service items such as belts, cutting blades, hoses, bags, etc., which are not defective shall be paid for by the purchaser.
4. **NO SERVICE CENTER WARRANTY:** The selling Service Center/Dealer makes no warranty on his own on any item warranted by New PECO, Inc. unless he delivers to purchaser a separate written warranty certificate specifically warranting the item. The Service Center or Dealer has no authority to make any representation or promise on behalf of New PECO, Inc. or to modify the terms of the original warranty in any way.
5. **NO REPRESENTATIONS ADDITIONAL WARRANTIES, DISCLAIMER:** Neither New PECO, Inc. nor any company affiliated with New PECO, Inc. makes any warranties, representations or promises as to the quality of performance of its products other than those set forth herein. Except as described above, New PECO, Inc. makes no other warranties **AND SPECIFICALLY DISCLAIMS ANY AND ALL IMPLIED WARRANTIES OF FITNESS AND MERCHANTABILITY.**
6. **REMEDIED EXCLUSIVE:** The only remedies the purchaser has in connection with the breach or performance of any warranty on New PECO, Inc. consumer products are set forth above. In no event will New PECO, Inc. be liable for special incidental or consequential damages.

Warranty service is available through your local authorized service dealer or distributor. If you do not know the dealer or distributor in your area, search by your zip code on [www.lawnvac.com](http://www.lawnvac.com) or contact our Sales Department at New PECO, Inc. 800-438-5823 or email [Sales@lawnvac.com](mailto:Sales@lawnvac.com).

## Notes



**New PECO, Inc.**  
**10 Walden Dr | Arden, North Carolina 28704**  
**Phone: 1-800-438-5823 | 828-684-1234**  
**Fax: 828-684-0858**  
**Email: [peco@lawnvac.com](mailto:peco@lawnvac.com)**  
**Website: [www.lawnvac.com](http://www.lawnvac.com)**