



# PTO DRIVEN - GRASS COLLECTION SYSTEM

Model# 28120901

MODEL YEAR:  
2015-NEWER

## Kubota Kommander

48" & 54" DECKS



## OPERATOR'S MANUAL

• ASSEMBLY •

## Preparation of Mower

Please refer to the Operation and Maintenance Manual Page 9 for detailed instructions on PTO pulley installation.

### Mount Plate and Mount Tube Assembly

Item #	Part #	Desc.	Qty.
1	B0939	Lower Mount Tube / 27"	2
2	B0902	Rear Mount Plate	1
3	B0905	Right Frame Plate	1
4	B0904	Right PTO Mount Plate	1
5	B0903	Left PTO Mount Plate	1
6	K1182	3/8"-16 x 1" Carriage Bolt	4
7	K2038	3/8"-16 Ny-Flange Lock Nut	10
8	K1098	U-Bolt / 5/16"-18 x 2" x 2-1/2"	6
9	K2516	5/16"-18 Ny-Flange Lock Nut	11
10	K0407	U-BOLT	3
11	V0050	Grommet 7/8" ID x 3/16" Panel	1

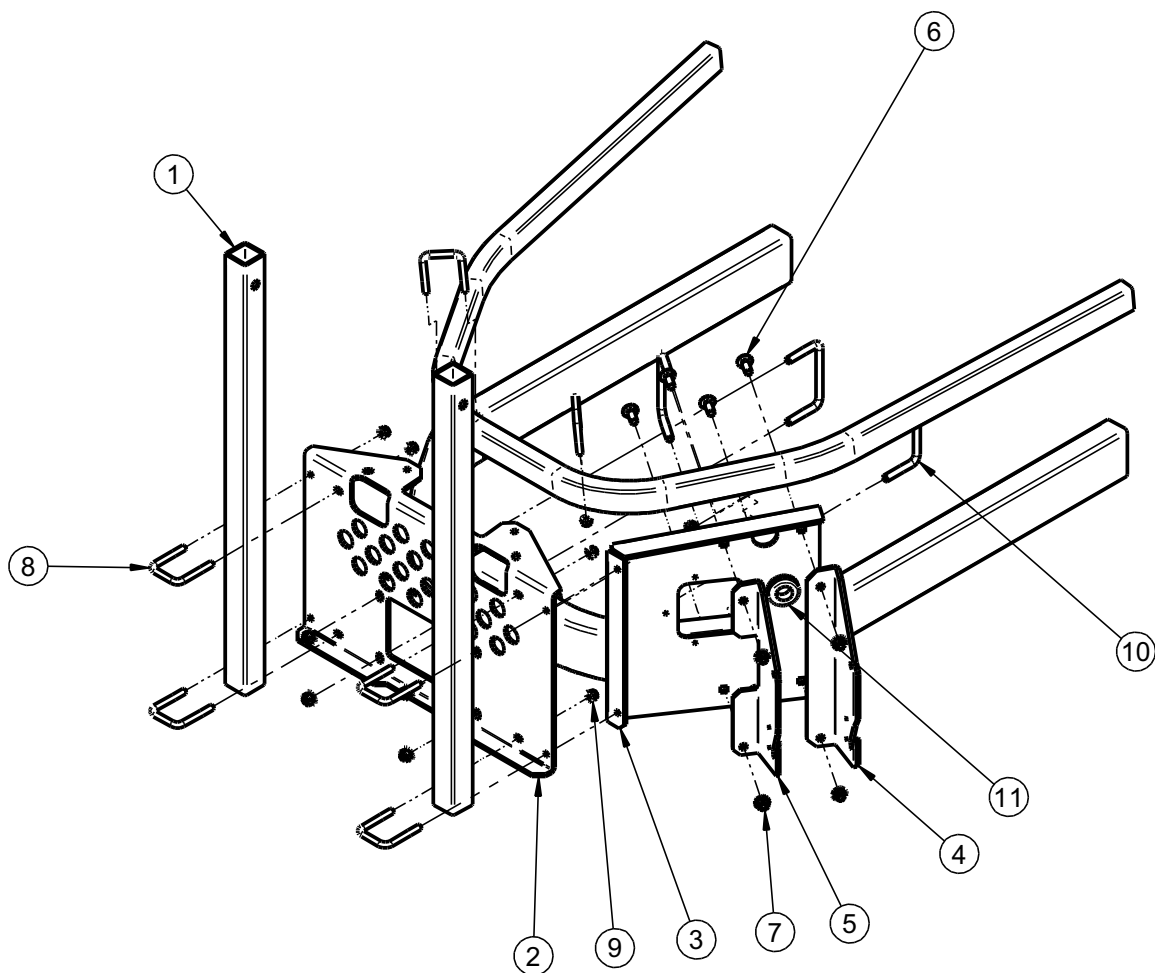

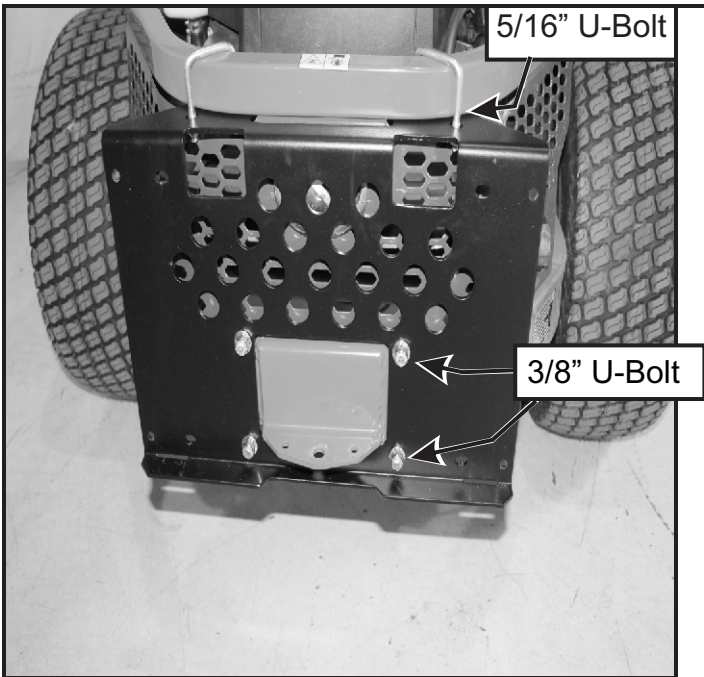

### **Rear Mount Plate Installation**

Attach Rear Mount Plate P#(B0902) to rear of mower using (2) 3/8-16 x 3-1/2" U-Bolts P#(K0407) and (4) 3/8"-16 Ny-Flange Locknuts P#(K2038). Next, attach to the top lip of the Mount Plate using (2) 5/16"-18 x 2" x 2-1/2" U-Bolts P#(K1098) and (4) 5/16"-18 Ny-Flange Locknuts P#(K2516).

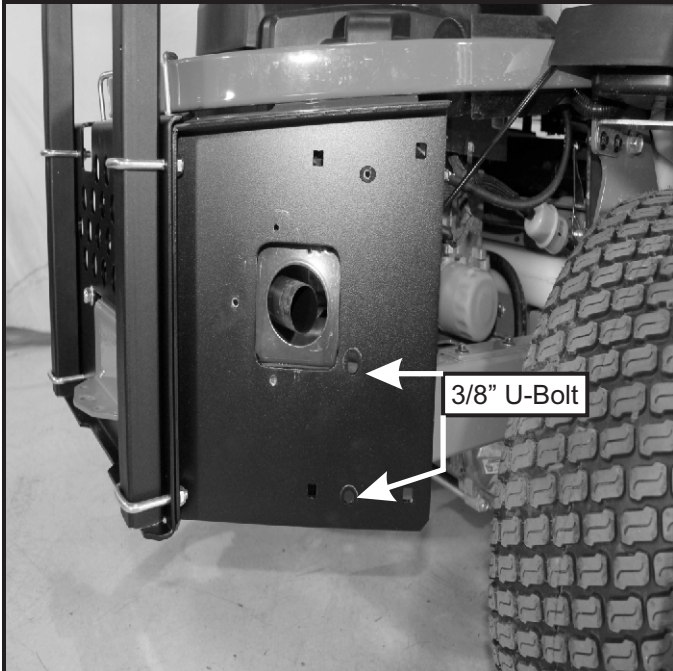

### **Right Frame Plate Installation**

Attach Right Frame Plate P#(B0905) to the right side of the mower using (1) 3/8"-16 x 3-1/2" x 2-1/8" U-Bolt P#(K0407) and (2) 3/8"-16 Ny-Flange Locknuts P#(K2038). Leave U-Bolt loose until completing Lower Frame Tube installation on next page.

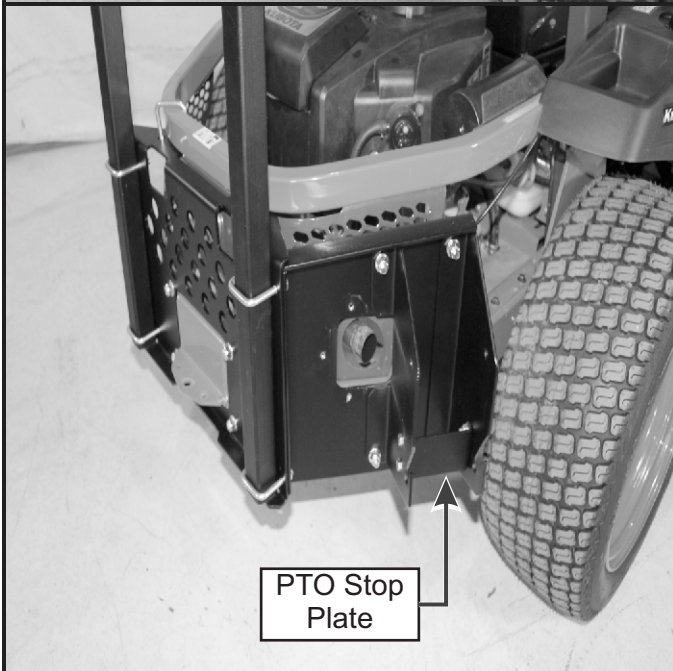

### **PTO Mount Plate Installation**

Attach the Left and Right PTO Mount Plates to the Right Frame Plate using (2) 3/8"-16 x 1" Carriage Bolts P#(K1182) and (2) 3/8"-16 Ny-Flange Locknuts P#(K2038) per Plate. Next, attach PTO Stop Plate P#(B0733) using (4) 1/4"-20 x 3/4" P#(K1222) and (4) 1/4"-20 Ny-Flange Locknuts P#(K2014).



## Lower Frame Tube Installation

Attach both Lower Frame Tubes P#(B0752) using (4) 5/16"-18 x 2.5" U-Bolts P#(K1098) and (8) 5/16"-18 Ny-Flange Locknuts P#(K2516). Tighten U-Bolt nuts from Right Frame Plate installation on previous page.

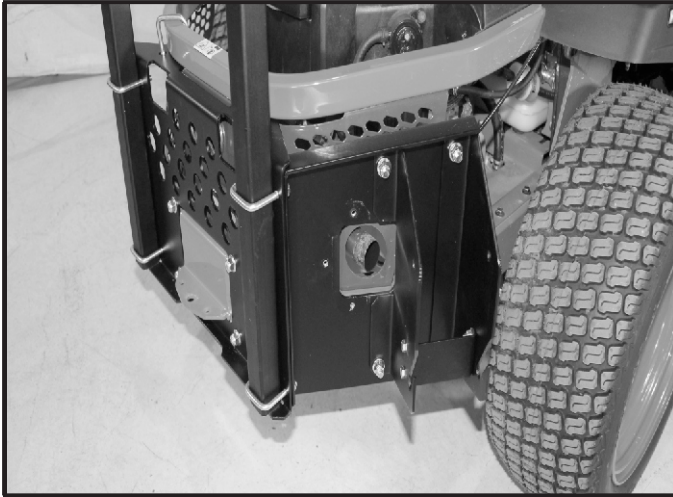

## PTO Assembly Installation

Insert the PTO Assembly P#(A1842) into the slots on the PTO Mount Plate assembly. Secure the PTO assembly with (1) Mount Pin P#(B0274) and (1) Hair Pin Clip P#(K0086).

In preparation for the belt installation, remove the Belt Guard from P#(A1842). Refer to maintenance manual for belt installation and adjustments.

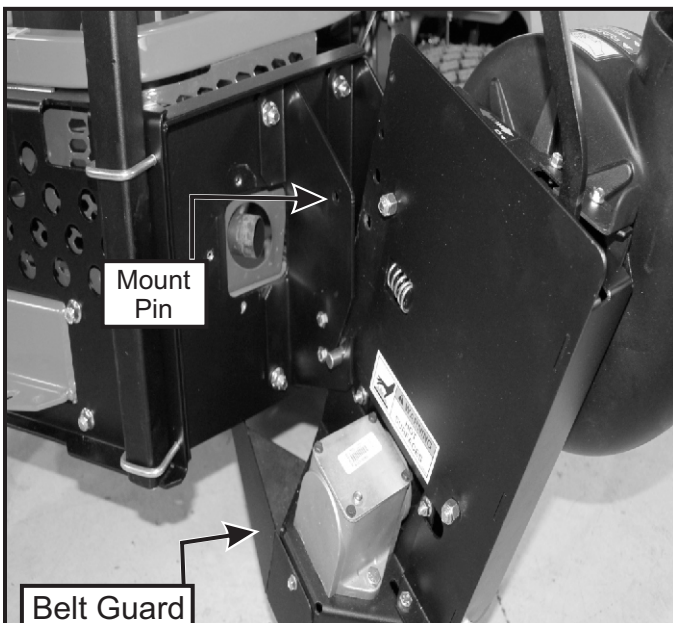

## Heat Guard Installation

Attach the Exhaust Guard P#(C0071) and the Exhaust Guard Cap P#(C0072) together using (1) 1/4"-20 x 1/2" HH Tapping Screw P#(K0353). Mount the assembly to the Right Frame Plate using (3) 1/4"-20 x 1/2" HH Tapping screws P#(K0353).

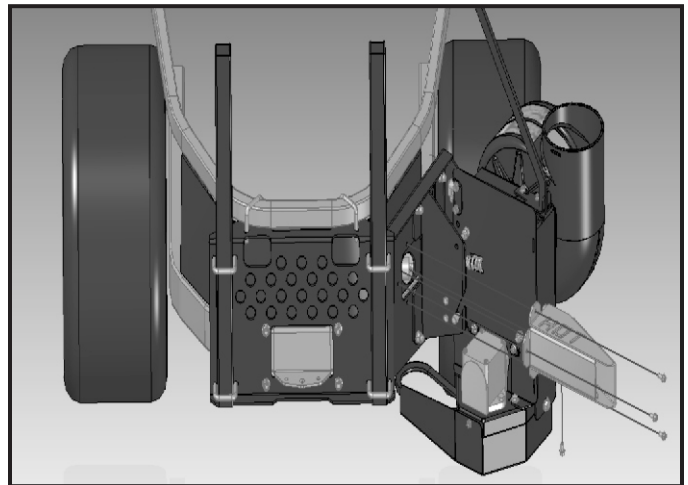

## Blower Cone Installation

Align the bolt holes of the Blower Cone (Item #1) to the bolt holes located on the Blower Housing of the PTO Assembly. Secure the Blower Cone to the Blower Housing by using (3) 1/4"-20 x 3/4" HHCS (Item #4), (3) 1/4" Lock Washers (Item #3), and (3) 1/4" Flat Washers (Item #2).

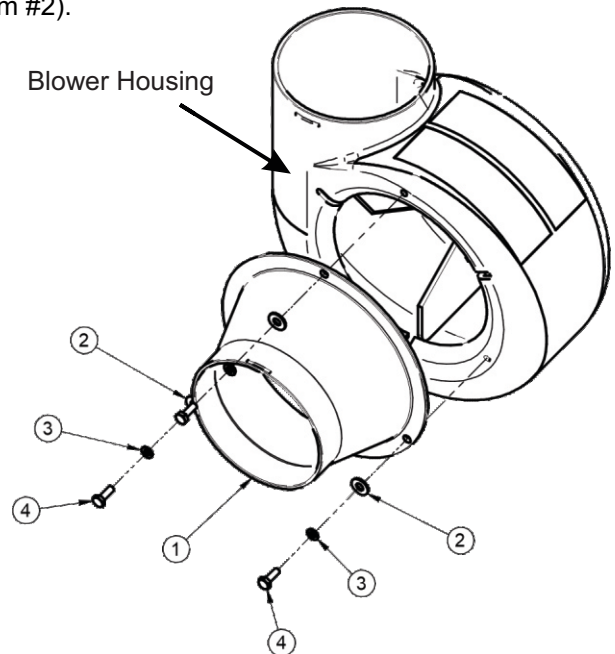

Item #	Part #	Desc.	Qty.
1	V0016	6" Plastic Blower Cone	1
2	K0037	Flat Washer / 1/4" (.75 OD x .312 ID x .060 T)	3
3	K0039	1/4" Lock Washer	3
4	K1222	1/4"-20 X 3/4" HHCS	3



## Top Assembly To Upper Frame Assembly Installation

Align the Top Assembly Pivot Holes to the Upper Frame Assembly. See Figure A below. Before fastening, pull Rubber Dust Guard outward to seal against Upper Frame Assembly (towards the mower's operator seat). Fasten the Top Assembly to the Upper Frame Assembly using (2) 5/16"-18 x 2-1/2" HHCS P#(K0125) and (2) 5/16"-18 Ny-Flange Locknuts P#(K2516). Leave the Ny-Flange Locknuts slightly loose to allow the Top Assembly to open and close easily.

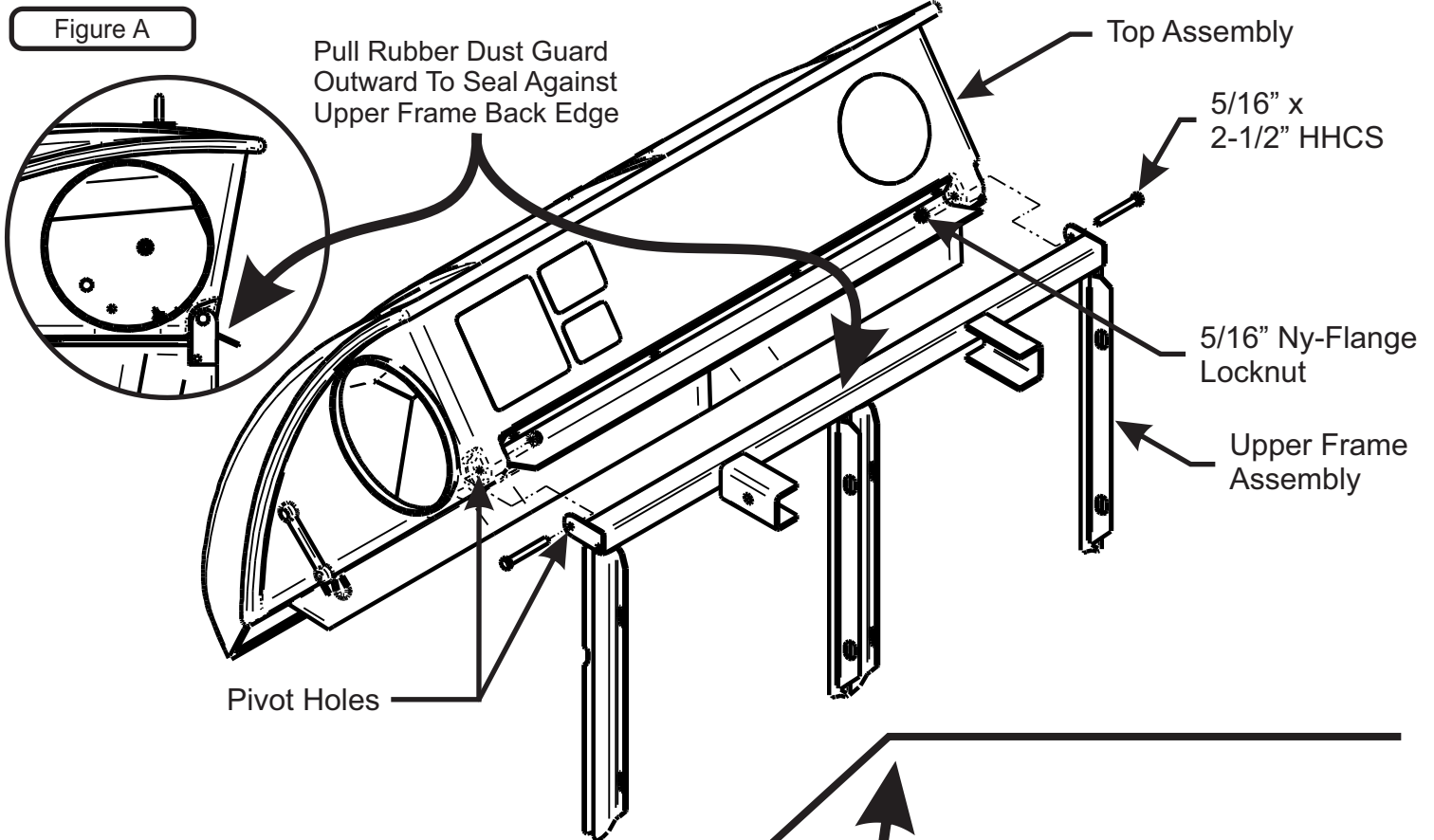

## Inlet Installation

Position the Top Assembly on its side with the Inlet Hole facing up. See Figure B. 1: Insert the Inlet from inside the Top Assembly, up through the Inlet Hole, until the Inlet Retaining Lip meets the Inlet Hole. 2: Position the Inlet as shown in Figure B, then pull the Inlet until a portion of the Inlet Retaining Lip protrudes from the Inlet hole. 3: Next, lift the Inlet as shown in Figure B until all of the Inlet Retaining Lip protrudes from the Inlet Hole. Once installed, the Inlet should pivot freely about the Inlet Hole.

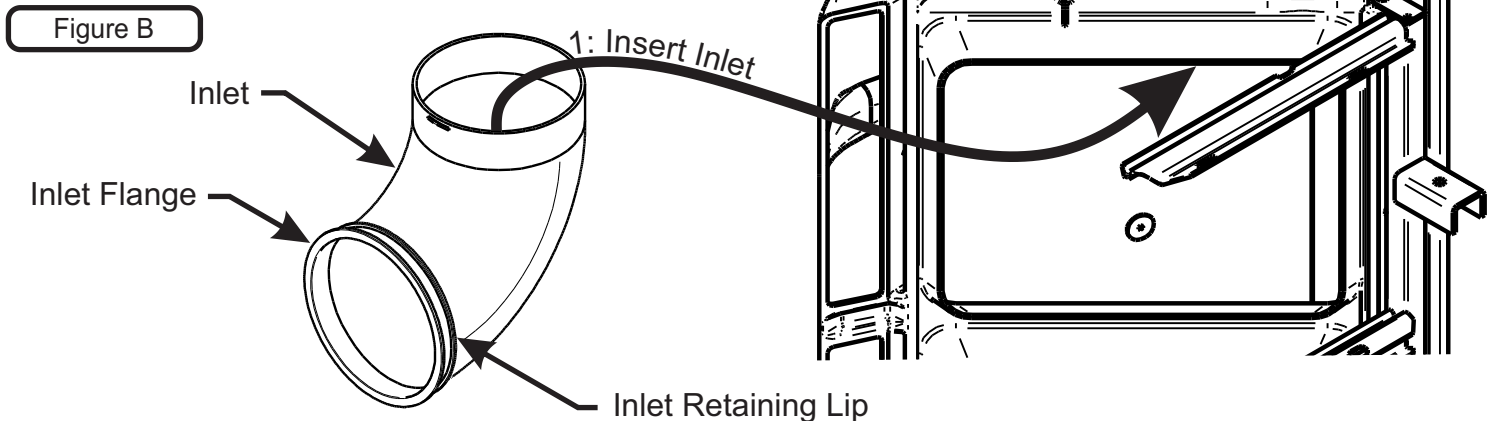

## Hinge Kit Assembly Installation

Assemble the Hinge Kit using (1) Latch Plate P#(B0884), (1) 5/16"-18 x 1-1/4" HHCS P#(K1156), (1) 5/16"-18 Ny-Flange Lock Nut P#(K2516), (3) 5/16" Flat Washers P#(K0042), (1) Latch Spacer P#(S0006), (2) Extra Heavy 5/16" Fender Washers P#(K0505) and (1) 5/16"-18 Lock Nut P#(K0506). Leave the nuts loose enough to allow fluid movement of the top when opening and closing. When opened, the top should rest in the Latch Plate Slot.

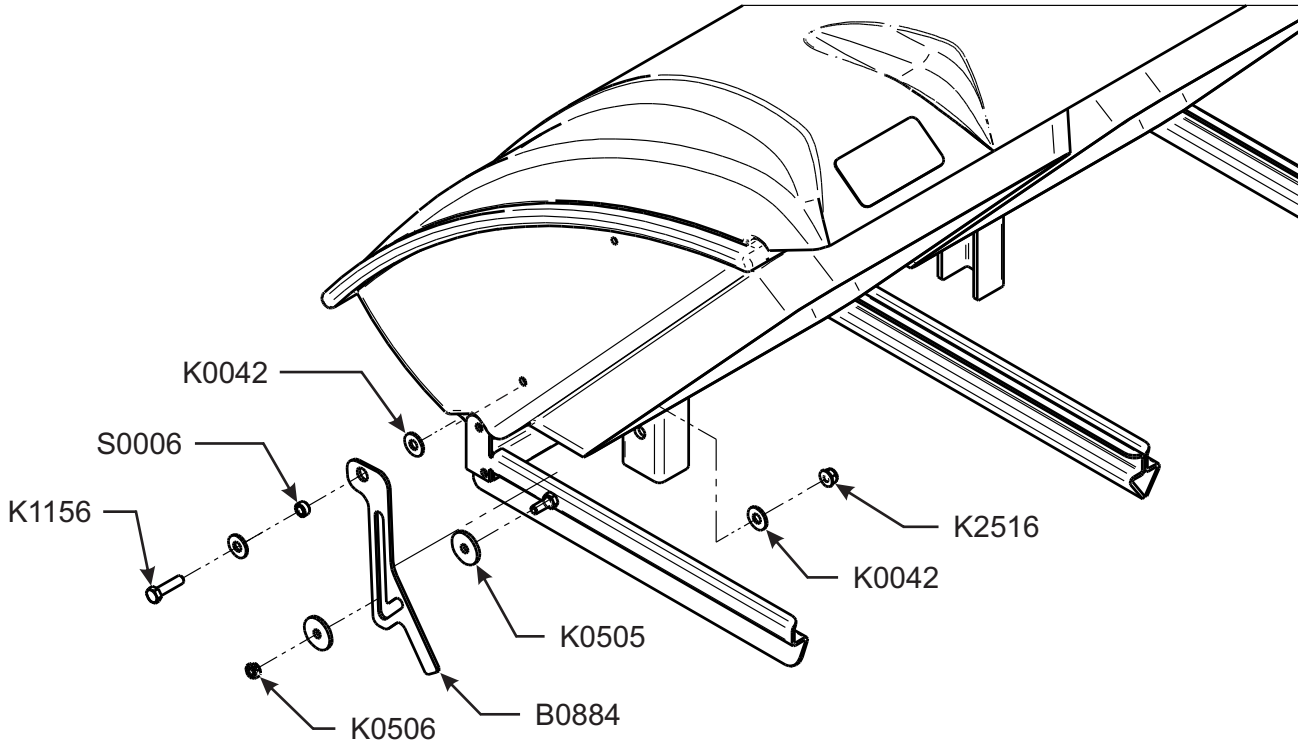

## Even Bag Fill Adjustment

Flap can be adjusted Up/Down depending on mowing conditions. Adjust flap up to allow more dense material to reach left bag. Adjust flap down to allow less dense material to reach the right bag. Once adjusted properly, both bags should fill evenly, but may require further adjusting when mowing conditions change.

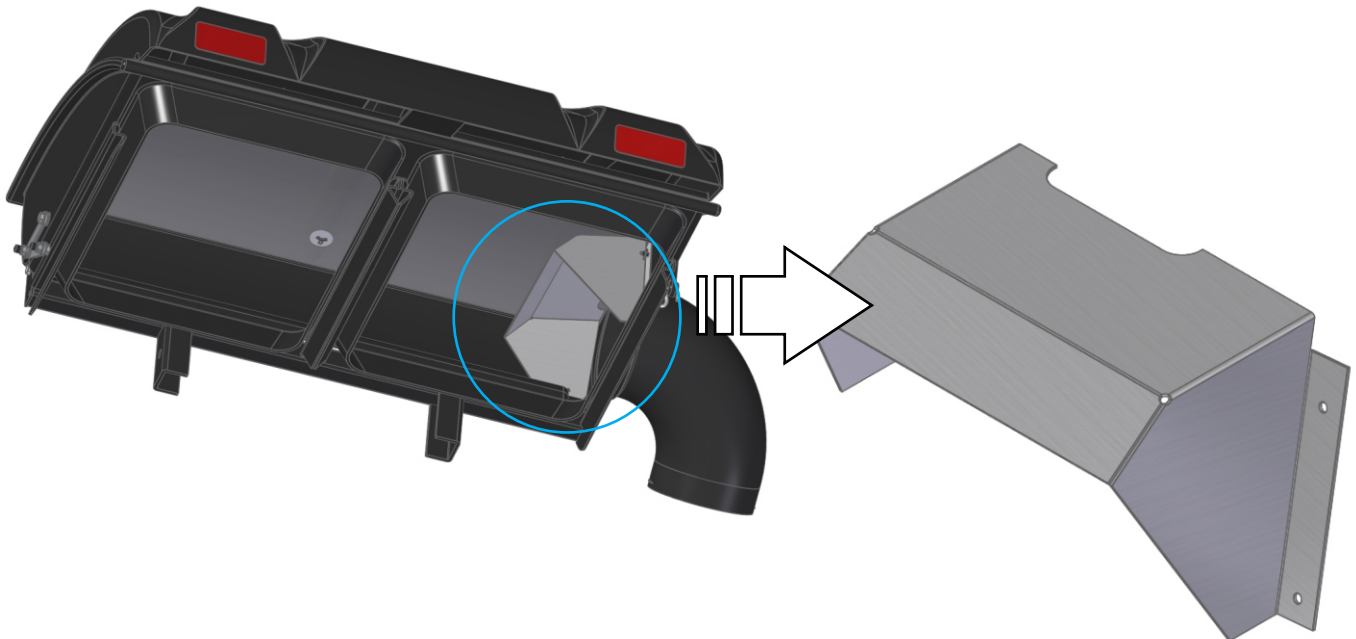

## **Bag Assembly**

First, take one of the Bag Ring Split Ends and insert it through the Bag Seam Opening. Next, rotate the Bag around the Bag Ring (1) full turn (360 degrees) until the Bag Ring Split Ends and the Bag Seam Opening are positioned on the same side. Then, connect the Bag Ring Split Ends using (1) End Connector. Last, rotate the Bag Ring and the End Connector Assembly (1/2") turn (180 degrees) to position the Connector opposite of the Bag Seam Opening. Note Final End Connector Location below in Figure A. Repeat for each Bag.

Figure A

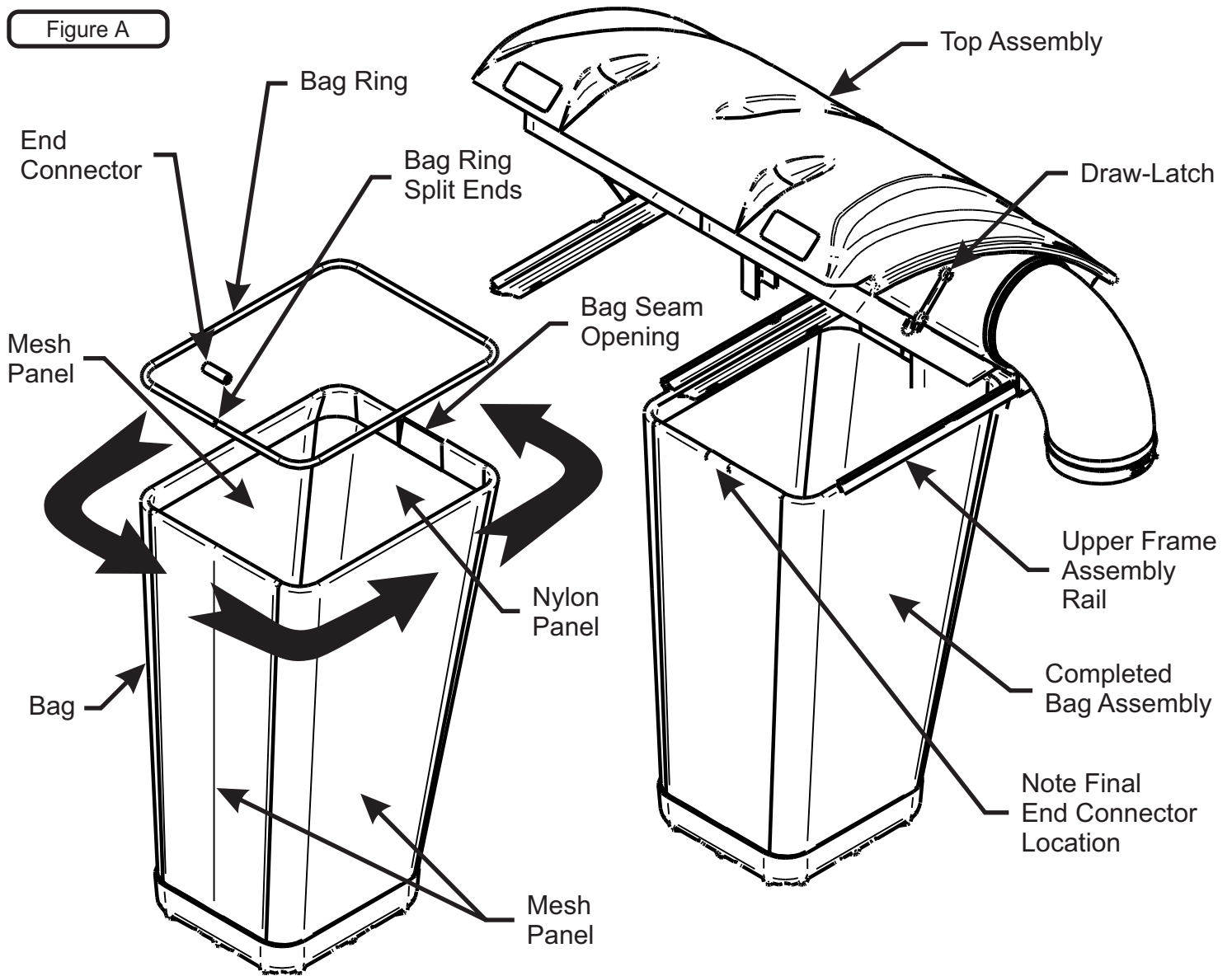

## **Bag Assembly Installation**

Slide the Completed Bag Assembly into the Upper Frame Assembly Rails and close the Top Assembly. Fasten the Draw-Latch on either side to hold the bagger closed.



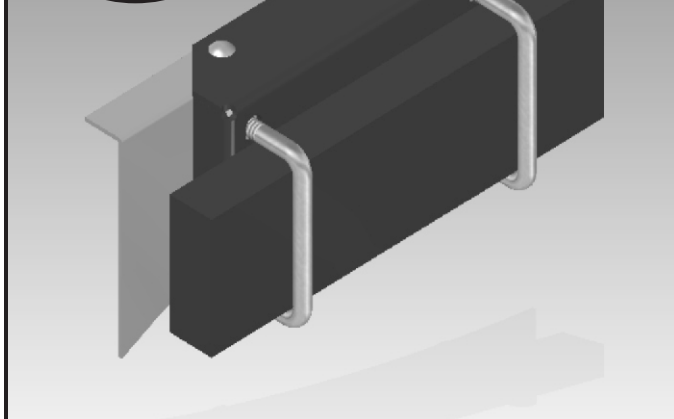

## **Installation of Boot**

Fasten Boot Plate P#(B0906) onto top of Boot and the Boot Plate Fastener P#(B0910) on the inside of Boot P#(V0048) using (3) P#(K1144) 5/16"-18 x 1" Carriage Bolts and (3) P#(K2516) 5/16"-18 Ny-Flange Locknuts. Align holes with the corresponding holes marked on the top plate. Lift mower's discharge chute and place boot on mower deck as shown.

## **Weight Kit Installation**

(See page 9 for reference) Place (2) U-Bolts P#(K0289) through the holes on the front side of Weight Bracket P#(B0941) and start (2) 1/2"-13 Ny-Flange Locknuts P#(K2012) on the backside of the Weight Bracket. Next, place Weight Bar P#(B0704) through U-Bolts and tighten firmly. Place Weight Bracket on front of footrest and secure using (2) 5/16"-18 x 1" Carriage Bolts P#(K1144) and (2) 5/16"-18 Ny-Flange Locknuts P#(K2012). (Note: On models with head lights, remove existing bolt and nut and discard. Be sure to bolt steel plate, holding the wire harness up, with new carriage bolts.)

## **Attach Hoses**

Refer to the operation and maintenance manual for hose sizing and attachment.

## ■ Front Baffle Installation (48" Mower Deck)



### CAUTION

To avoid personal injury:

- Disengage the PTO, stop the engine, remove the key, and wait for all moving parts to stop.
- Never operate the mower without a discharge cover or grass-catcher boot installed.

1. Remove the discharge cover by removing the cotter pin and sliding the pin out.

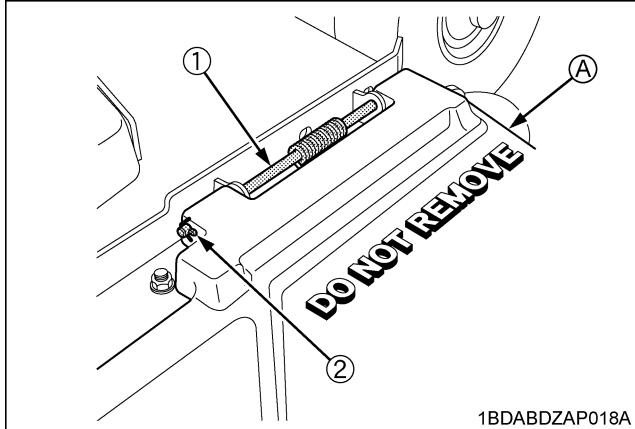

- (1) Discharge pin  
(2) Cotter pin

(A) Discharge cover

2. Acquire adequate access to the bottom of the mower deck by raising the mower deck to the "carry" position.
3. Install the Front Baffle Plate 2 using the (2) existing carriage bolts and Ny-flange locknuts. Fully tighten both fasteners.

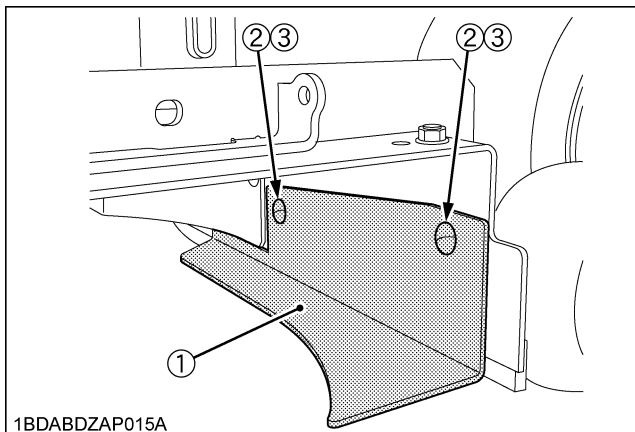

- (1) Front Baffle Plate 2 P#(B0929)  
(2) M8 x 16 square neck bolt  
(3) M8 Flange Lock Nut

4. The unused Front Baffle Plate may be discarded.

## ■ Front Baffle Installation (54" Mower Deck)



### CAUTION

To avoid personal injury:

- Disengage the PTO, stop the engine, remove the key, and wait for all moving parts to stop.
- Never operate the mower without a discharge cover or grass-catcher boot installed.

1. Remove the discharge cover by removing the cotter pin and sliding the pin out.

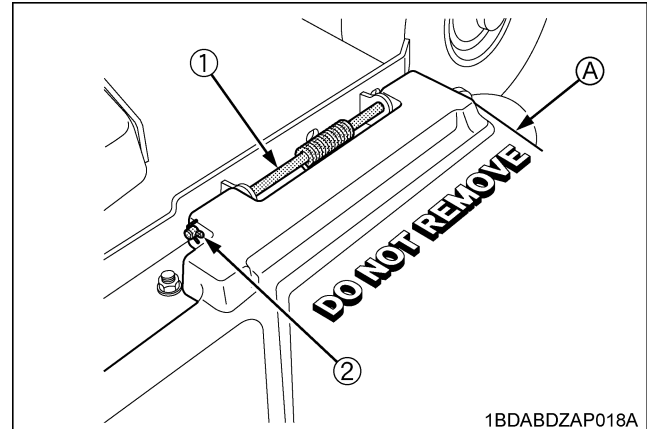

- (1) Discharge pin  
(2) Cotter pin

(A) Discharge cover

2. Fasten the 2 Front Baffle Plates together using (2) 5/16"-18 x 3/4" carriage bolts with (2) Ny-flange locknuts. Fully tighten both fasteners.

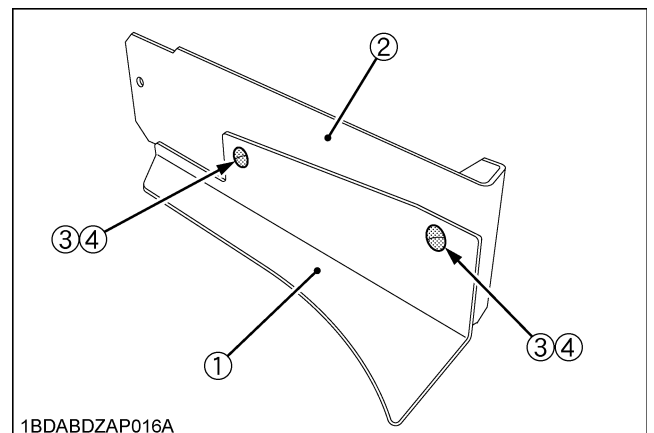

- (1) Front Baffle Plate 2 P#(B0929)  
(2) Front Baffle Plate P#(B0928)  
(3) Carriage Bolt 5/16"-18 x 3/4" P#(K1142)  
(4) Ny-Flange Lock Nut 5/16"-18 P#(K2516)

3. Acquire adequate access to the bottom of the mower deck by raising the mower deck to the "carry" position.
4. Install the front baffle assembly using the existing 2- M8 x 16 square neck bolts with 2 - M8 flange nuts. Fully tighten both fasteners.

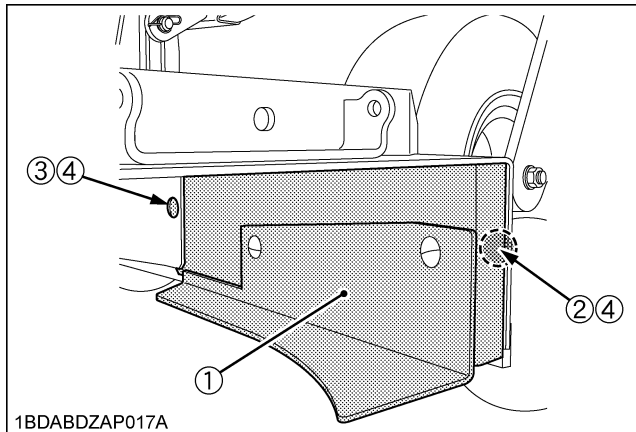

- (1) Front baffle assembly  
 (2) M8 x 16 square neck bolt <19>  
 (3) M8 x 20 square neck bolt <20>  
 (4) M8 flange nut <24>

### **Safety Interlock Installation**

Your PECO bagging system is equipped with a Safety Interlocking system designed to disengage the blower if the operator is not seated. The components to install the Safety Interlock are located in Hardware Bag P#(HB0649).

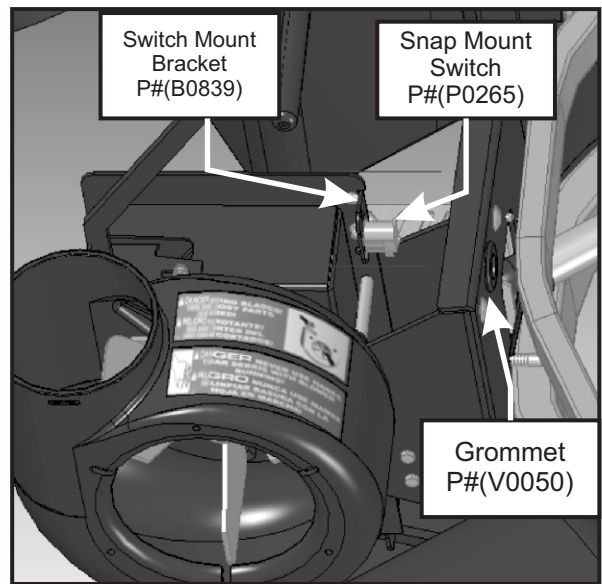

First, install Switch Mount Bracket P#(B0839) on the side of the PTO housing with Snap Mount Switch P#(P0265) inserted into slot using (2) 1/4"-20 x 5/8" Carriage Bolts P#(K1010) and (2) 1/4"-20 Ny-Flange locknuts P#(K2014). Next, insert Rubber Grommet P#(V0050) into hole located on the Right Mount Frame Plate.

Feed the Safety Interlock Harness P#(P0268) end with one connector through the grommet from the mower outward towards the PTO. Connect to switch. Next, carefully feed the harness around to the right side lap bar following the fuel line and through the rubber grommet used by the fuel line. Secure using the zip ties provided. Once through the fuel line grommet, feed the harness downward and to the right. Bring harness over the frame to avoid sagging.

Locate the safety switch that engages when the lap bar is in its outermost, neutral position. Unplug the connector from the bottom of the switch and plug the matching connector from the Harness to the switch. Then plug the two remaining ends together. Refer to the next page for further reference.

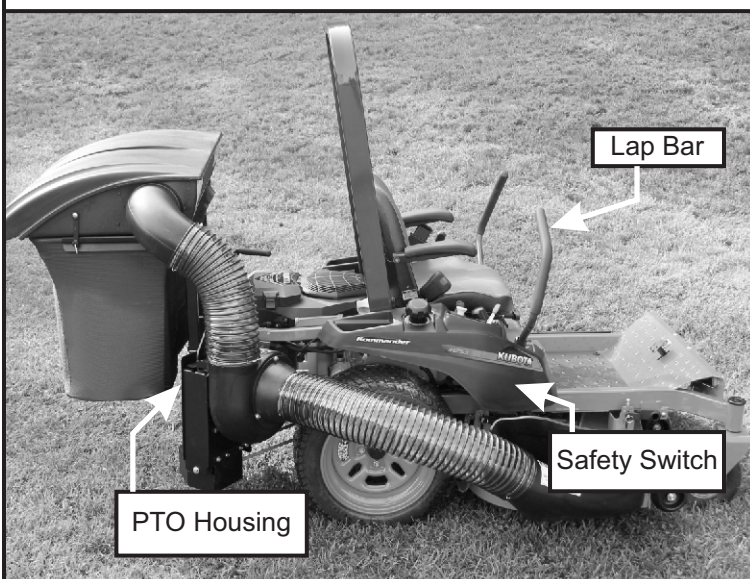



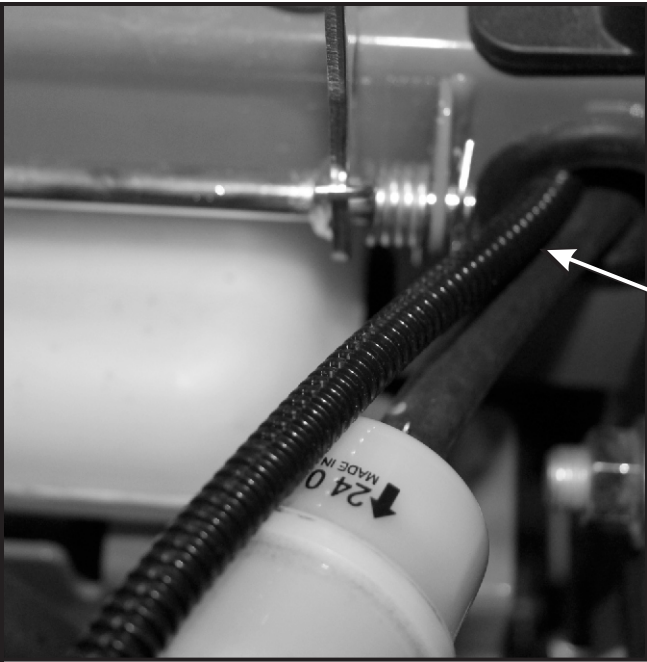

Fuel Line and Grommet

Wire Harness

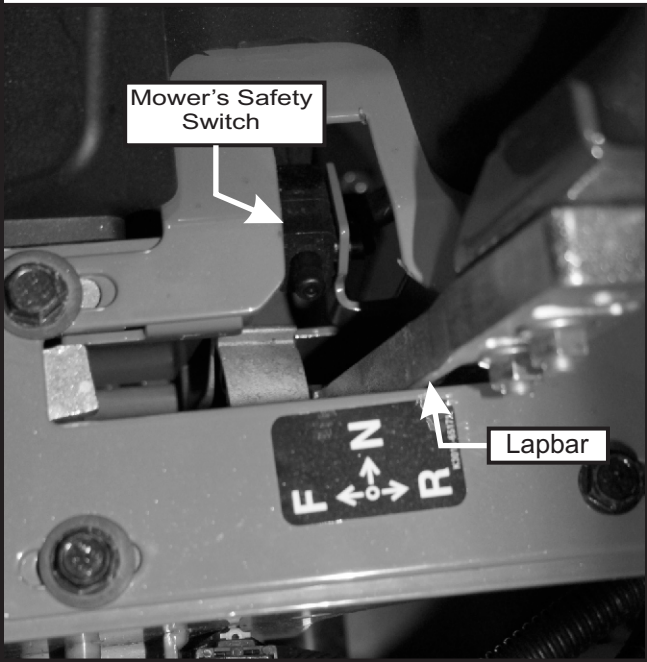

Mower's Safety Switch

Lapbar

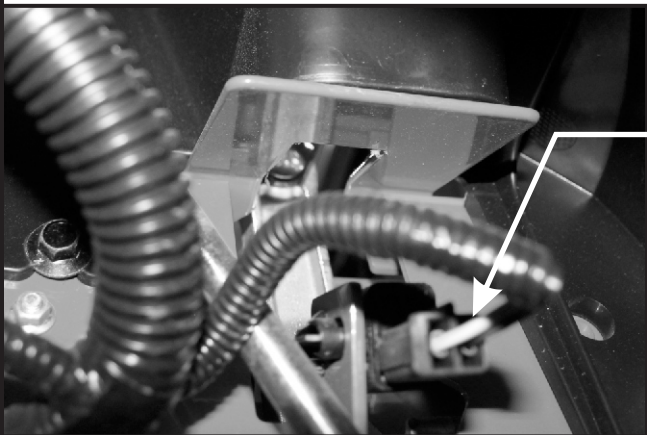

Disconnect Mower's Safety Switch here and connect Safety Interlock Harness Between.

# Weight Kit Installation

Item #	Part #	Desc.	Qty.
1	B0704	Large Weight Bar	1
2	K0289	1/2"-13 x 4-5/16" x 2-3/4" U-Bolt	2
3	K2012	1/2"-13 Ny-Flange Lock Nut	4
4	B0941	Weight Bracket	1
5	K1142	5/16"-18 x 3/4" CARRIAGE BOLT	2
6	K2516	5/16"-18 Ny-Flange Lock Nut	2

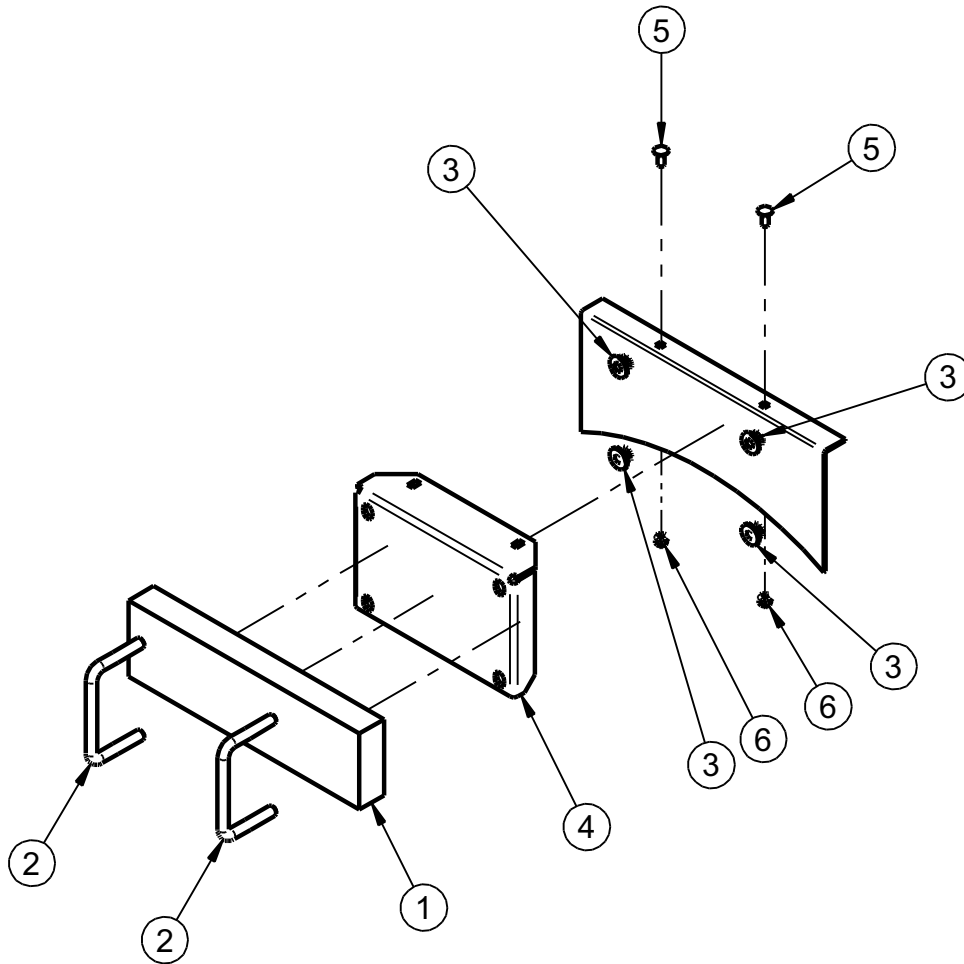

# Unit Model #: 28120901

Mower: Kubota

Owner's Manual: Q0493

Mower Type: Kommander

Engine Type: Kohler 21 & 25 HP, Kawasaki 21.5

Deck Size: 48" & 54"

HP & Briggs and Stratton 22 & 25 HP

Vac Type: 9 Cu. Ft. Pro 2+ Bagger

Drive Type: PTO-R Drive (3-Blade)

Revision: 2 - Updated Weight Kit - 1/12/2018

Fits Year[s]: 2015-Newer



## A1997 Vac Kit

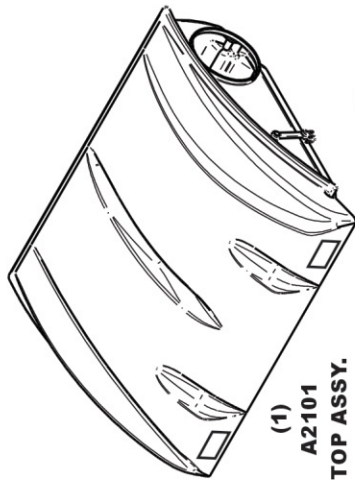

(1) A2101 TOP ASSY.



(1) V0025 6" & 7" PLASTIC INLET

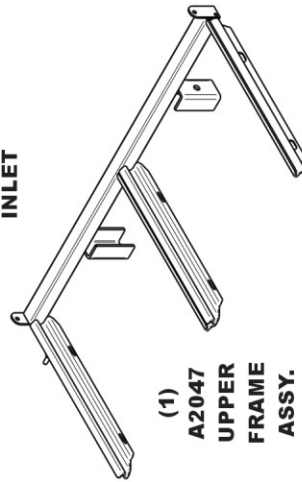

(1) A2047 UPPER FRAME ASSY.



(1) HB0622 HARDWARE BAG

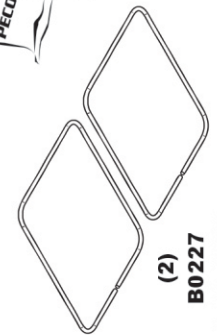

(2) B0227 BAG RING

## A2031 BAFFLE KIT



(1) HB0654 HARDWARE BAG

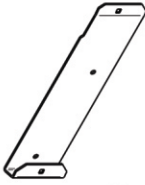

(1) B0928 FRONT BAFFLE PLATE



(1) B0929 FRONT BAFFLE PLATE 2

## A2024 Mount Kit

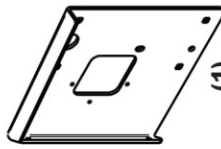

(1) B0905 RIGHT FRAME PLATE



(1) F0060 6" X 18" UPPER HOSE

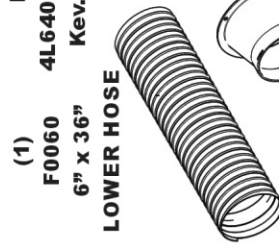

(1) F0060 6" X 36" LOWER HOSE

(1) M0251 4L640DVK (A62K) Kev. Cord Belt



(1) HB0647 ENGINE PULLEY HARDWARE BAG

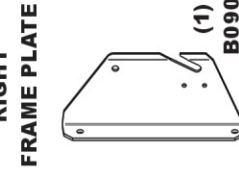

(1) B0904 RIGHT PTO MOUNT PLATE



(1) C0072 EXHAUST GUARD CAP



(1) C0071 EXHAUST GUARD

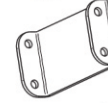

(1) B0733 PTO STOP PLATE



(1) V0016 BLOWER CONE 6"



(4) J0060 6" HOSE CLAMPS



(1) HB0649 SAFETY INTERLOCK HARDWARE BAG



(1) HB0646 HARDWARE BAG

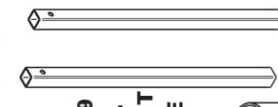

(2) B0939 MOUNT TUBE LWR.

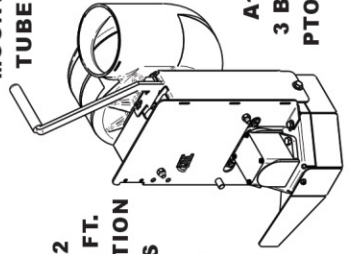

(2) G0002 3.3 CU. FT. COLLECTION BAGS

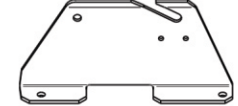

(1) B0902 REAR MOUNT PLATE

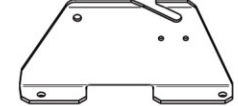

(1) B0903 LT. PTO MNT. PL.

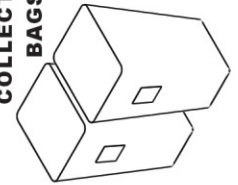

(1) A1842 3 BLADE PTO ASSY.

## A 2025 Boot Kit



(1) V0048 BOOT



(1) B0906 BOOT PLATE



(1) B0910 BOOT PLATE FASTENER



(1) HB0648 HARDWARE BAG

## A2030 Weight Kit



(1) HB0653 HARDWARE BAG

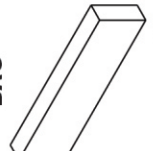

(1) B0704 14" WEIGHT BAR



(1) B0941 WEIGHT BRACKET





**New PECO, Inc.**  
**10 Walden Drive | Arden, North Carolina 28704**  
**Phone: 1-800-438-5823 | 828-684-1234**  
**Fax: 828-684-0858**  
**Email: [peco@lawnvac.com](mailto:peco@lawnvac.com)**  
**Website: [www.lawnvac.com](http://www.lawnvac.com)**