



Unit Model #: 28120901 (PC-K1209)

Mower: Kubota

Owner's Manual: Q0493

Mower Type: Kommander

Engine Type: Kohler 21 & 25 HP, Kawasaki 21.5

Deck Size: 48" & 54"

HP & Briggs and Stratton 22 & 25 HP

Vac Type: 9 Cu. Ft. Pro 2+ Bagger

Drive Type: PTO-R Drive (3-Blade)

Revision: 3 - Updated PTO-R (Oct 2022)

Fits Year(s): 2015-Newer

A1997 Vac Kit

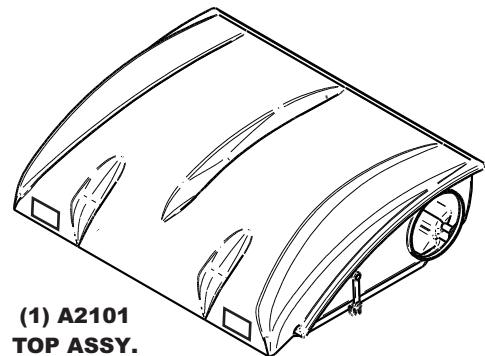

(1) A2101 TOP ASSY.

(1) V0025 6" & 7" PLASTIC INLET



(1) A2047 UPPER FRAME ASSY.

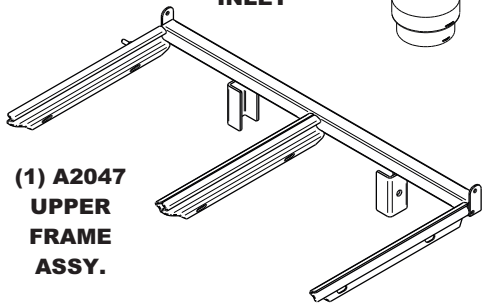

(1) HB0622 VAC KIT HW BAG



(2) B0227 BAG RING

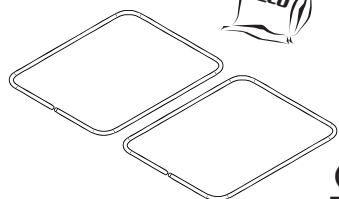

A2024 Mount Kit

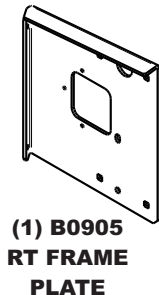

(1) B0905 RT FRAME PLATE

(1) F0060 6" x 18" UPPER HOSE



(1) F0060 6" x 36" LOWER HOSE

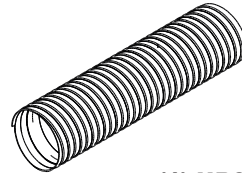

(1) M0251 4L640DWK (A62K) Kev. Cord Belt

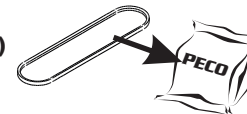

(1) HB0647 ENGINE PULLEY HARDWARE BAG

(1) HB0649 SAFETY INTERLOCK KIT



(1) HB0646 HARDWARE BAG



(1) V0016 BLOWER CONE 6"



(2) B0939 LWR. MOUNT TUBE

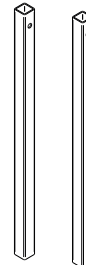

(1) C0072 EXHAUST GUARD CAP

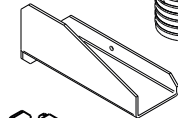

(1) C0071 EXHAUST GUARD

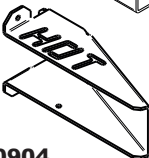

(1) B0733 PTO STOP PLATE

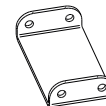

(4) J0060 6" HOSE CLAMPS



(1) A2194_01 3-BLADE PTO ASSY.

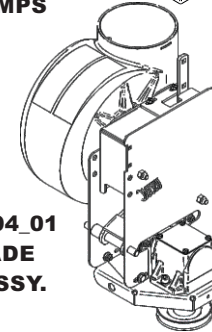

(1) B0903 LT. PTO MNT. PL.

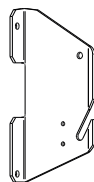

(2) G0002 3.3 CU. FT. COLLECTION BAGS

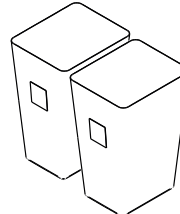

(1) B0902 REAR MNT PLATE

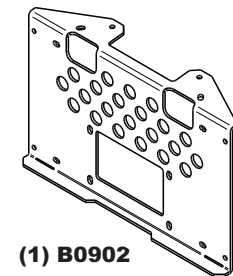

A1842_01 PTO-R Handle & Belt Guard

(1) HB0874 BELT GUARD HW BAG



(1) A1137_01 PTO-R HANDLE EXT KIT



(1) B0681 PULLEY GUARD / LARGE

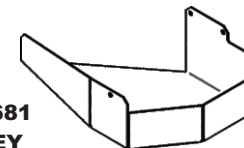

A2031 Baffle Kit

(1) B0928 FRNT BAFFLE PLATE

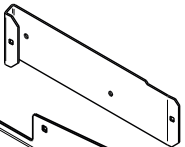

(1) B0929 FRNT BAFFLE PLATE 2

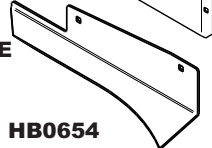

(1) HB0654 BAFFLE KIT HW BAG



A2025 Boot Kit

(1) V0048 BOOT

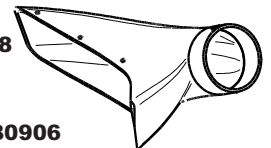

(1) B0906 BOOT PLATE



(1) B0910 BOOT PLATE FASTENER



(1) HB0648 BOOT KIT HW BAG



A2030 Weight Kit

(1) HB0653 WEIGHT KIT HW BAG



(1) B0941 WEIGHT BRACKET

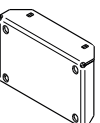

(1) B0704 14" WEIGHT BAR

