

MODEL#: 41721215

MOWER NAME: FERRIS

MOWER MODEL: IS 3100Z

MOWER DECK SIZE: 61"

VAC NAME: PRO 12

6.5HP BRIGGS AND STRATTON VANGUARD

MANUAL: QO406



FOR YEAR: 2010

REVISED: 10/22/2012

A1782 UNIT ASSEMBLY

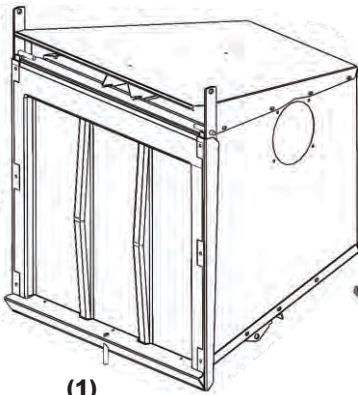

(1)
A0560
12 CU. FT. BOX
ASSEMBLY



(1)
V1152
7" INLET
RING



(1)
E0007
6" HOSE
RING



(1)
F0001
6" x 50"
UPPER
HOSE



(1)
F0007
8" x 36"
LOWER
HOSE

(2)
J0060
6" HOSE
CLAMPS

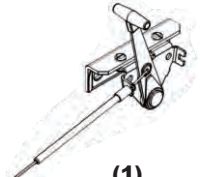

(1)
A0060
70" THROTTLE
KIT FOR
(5.5 & 6.5 HP)



(2)
B0193
DOOR LINKAGE

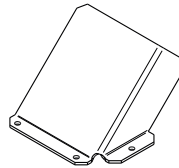

(1)
C0062
EXHAUST
DEFLECTOR

(2)
J0080
8" HOSE
CLAMPS



(1)
HB0419
HARDWARE

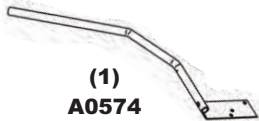

(1)
A0574
BOX HANDLE
ASSEMBLY

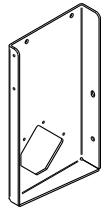

(1)
B0610
RT. LWR. MAIN
FRAME LEG

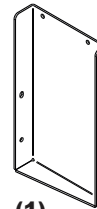

(1)
B0609
LT. LWR. MAIN
FRAME LEG

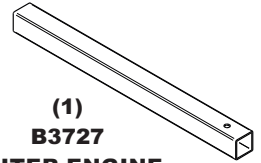

(1)
B3727
OUTER ENGINE
MOUNT TUBE

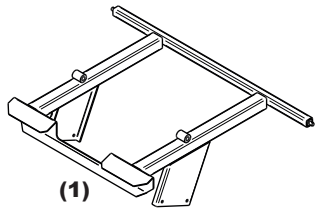

(1)
A1052
MAIN FRAME
ASSEMBLY

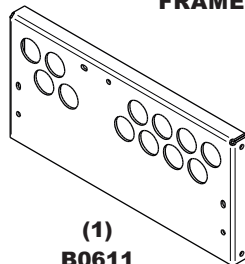

(1)
B0611
LOWER
STIFFENER

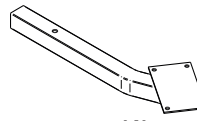

(1)
A0138
ENGINE MNT.
ARM ASSY.

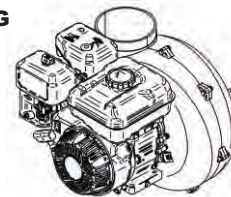

(1)
A639
ENGINE/
BLOWER/
BLADE ASSY.



(1)
E6009
8" BLOWER
CONE

A1784 - WEIGHT KIT

(1)
HB0421
HARDWARE
BAG

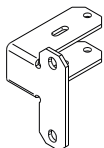

(2)
B0383
WEIGHT
BRACKET

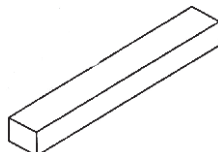
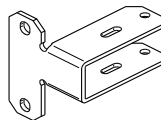

(1)
B2220
WEIGHT

A1785 - BOOT KIT

(1)
HB0422
HARDWARE
BAG

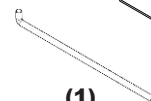

(1)
B0348
BOOT
ROD

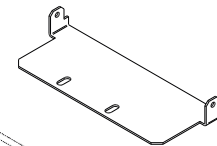

(1)
B0612
BOOT
PLATE

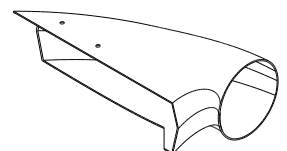

(1)
E2502
BOOT