

# MODEL#: 33031205

MOWER NAME: LESCO

MOWER MODEL: Z2

MOWER DECK SIZE: 48" 54" 60"

VAC NAME: 12 CUBIC FOOT PRO BAGGER

6.5 BRIGGS AND STRATTON VANGUARD

BOM328



FOR YEAR: 2007-2006

REVISED:

## A0901 UNIT ASSEMBLY

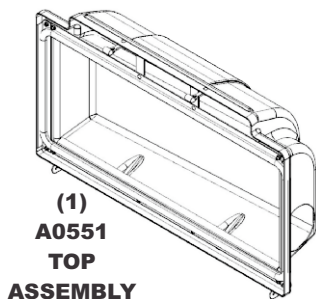

(1)  
A0551  
TOP  
ASSEMBLY



(1)  
V1054  
6" PLASTIC  
INLET



(1)  
7" x 35"  
LOWER  
HOSE

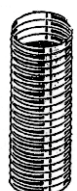

(1)  
6" x 21"  
UPPER  
HOSE



(4)  
J1000  
HOSE  
CLAMPS

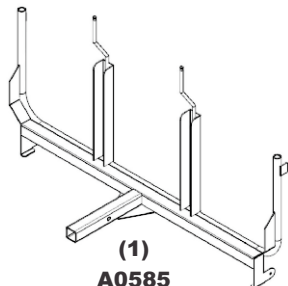

(1)  
A0585  
UPPER FRAME  
ASSEMBLY

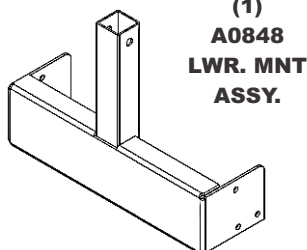

(1)  
A0848  
LWR. MNT.  
ASSY.

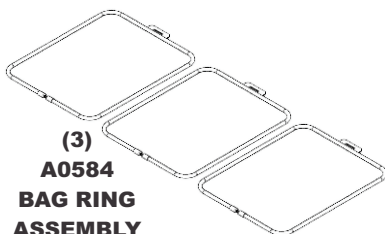

(3)  
A0584  
BAG RING  
ASSEMBLY

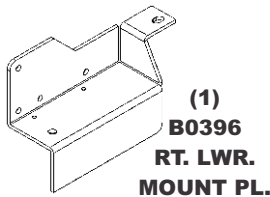

(1)  
B0396  
RT. LWR.  
MOUNT PL.

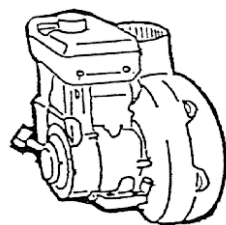

(1)  
A639  
ENGINE/  
BLOWER/  
BLADE ASSY.

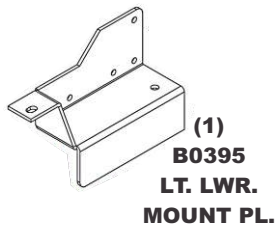

(1)  
B0395  
LT. LWR.  
MOUNT PL.



(1)  
E6004  
7" BLOWER  
CONE



(1)  
A0976  
ENGINE MNT.  
ARM ASSY.

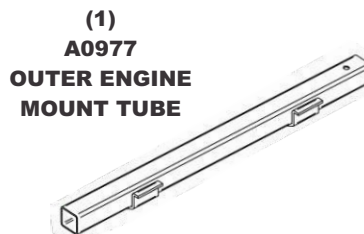

(1)  
A0977  
OUTER ENGINE  
MOUNT TUBE

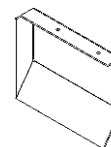

(1)  
C0058  
EXHAUST  
DEFLECTOR

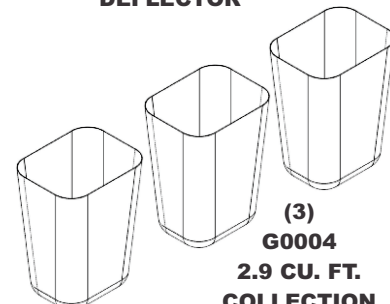

(3)  
G0004  
2.9 CU. FT.  
COLLECTION  
BAGS



(1)  
HB0345  
HARDWARE  
BAG



(1)  
HB0249  
HARDWARE  
BAG



(1)  
A0060  
70" THROTTLE  
KIT FOR  
(5.5 & 6.5HP)

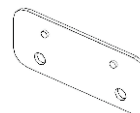

(1)  
A0666  
THROTTLE  
MNT. PL.  
ASSY.

## A0693 - WEIGHT KIT



(1)  
HB0319  
HARDWARE  
BAG

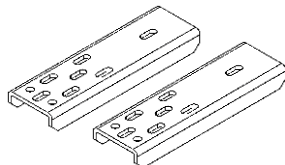

(2)  
B3750  
WEIGHT  
BRACKET

## A0690 - BOOT KIT



(1)  
HB0078  
HARDWARE  
BAG

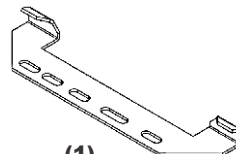

(1)  
B2555  
BOOT  
PLATE

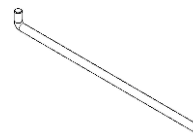

(1)  
B4331  
BOOT ROD

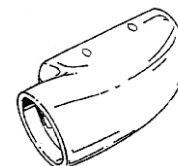

(1)  
E1031  
BOOT