



PTO GRASS COLLECTION SYSTEM

DESIGNED TO FIT:

***SNAPPER* PRO**™

S150XT

2012-2013



**MODEL #: 05721201
6.5HP BRIGGS & STRATTON
VANGUARD**

**MODEL #: 05721202
900 SERIES BRIGGS & STRATTON**

OPERATOR'S MANUAL

ASSEMBLY • OPERATION • MAINTENANCE

MANUAL PART#: Q0461

PECO GRASS COLLECTION SYSTEM

TABLE OF CONTENTS

SECTION	PAGE	SECTION	PAGE
Safety	2	2-16 Length Of Hose Adjustment	14
Safety Alert Symbols	3	2-17 Upper Hose Installation	14
Warranty	4	2-18 Lower Hose to Blower Cone Installation	14
I INTRODUCTION AND DESCRIPTION	5	2-19 Lower Hose to Boot Installation	14
1-1 Introduction	5	2-20 Impeller Blade Removal Replacement	15
1-2 Description	5	2-21 Weight Kit Installation	16
II INSTALLATION FOR USE	5	2-22 Throttle Cable Installation	17
2-1 Preparation Of Mower	5	Exploded Views and Parts List	18-20
2-2 Left and Right Frame Bracket Installation	6	III OPERATING INSTRUCTIONS	21
2-3 Rear Frame Bracket Installation	7	3-1 General Safety	21
2-4 Muffler Guard Bracket Installation	7	3-2 Operation & Tips On Mowing	21
2-5 Outer Engine Mount Tube Installation	8	3-3 Disengagement Of The Blower	21
2-6 Engine Mount Arm Assembly Installation	8	3-4 Unloading The Collection System	21
2-7 Engine/Blower/Blade Assembly Installation	9	IV MAINTENANCE	21
2-8 Left and Right Frame Leg Installation	10	4-1 Maintenance Checklist	21
2-9 Main Frame Assembly Installation	10	V PARTS AND SERVICE	22
2-10 Lift Handle Installation	11	5-1 Parts And Service Information	22
2-11 Aluminum Grass Container Installation	12	Safety Decals	23
2-12 Dump Mechanism Adjustment	12	Torque Specifications	24
2-13 Exhaust Diverter Installation	13		
2-14 Blower Cone Installation	13		
2-15 Boot To Mower Deck Installation	13		

Safety

- 1.** Read the operator's manual carefully and familiarize yourself with the proper use of your attachment. Do not allow anyone who is not acquainted with the Safety Instructions to use your attachment.
- 2.** Know the controls and how to stop quickly. **READ THE OPERATOR'S MANUAL!**
- 3.** Do not allow children to operate the vehicle. Do not allow adults to operate it without proper instruction.
- 4.** Be especially watchful of children and pets darting into the area while operating.
- 5.** Keep your eyes and mind on your unit while mowing or operating your attachment. Don't let others distract you.
- 6.** Do not attempt to operate your unit or mower when not in the driver's seat.
- 7.** Always stop unit when emptying the container.
- 8.** Stop unit, shut off deck attachment, set parking brake, shut off mower engine and remove spark plug wire before removing clogs, removing or replacing hose, boot, blower cone, or performing any maintenance.
- 9.** Mow up and down the face of slopes (not steeper than 10 degrees); never up and down the face of the slope.
- 10.** It is recommended that the container be kept only half full when negotiating any slopes. Start mowing on slopes when the container is empty.
- 11.** Inspect your lawn and remove any foreign objects before mowing. Never deliberately run the mower across any foreign object.
- 12.** Wear ear protection if the noise level is offensive.
- 13.** Wear eye protection to prevent debris from damaging your eyes.

SAFETY

WARNING! NEVER operate the mower unless the discharge guard and either the deflector assembly or the vacuum collector adapter are fastened securely in place.

WARNING! Do not work around the mower deck boot or the blower area until you are certain that the mower blades and the blower impeller have stopped rotating.

WARNING! To avoid serious injury, perform maintenance on the vacuum collector; **ONLY AFTER STOPPING THE MOWER'S ENGINE AND WAITING FOR ALL MOVING PARTS TO COME TO A COMPLETE STOP.** Set the parking brake. Always remove the ignition key before beginning maintenance.

WARNING! For your own personal safety, **ALWAYS** mow **ACROSS** the face of slopes and **NEVER UP and DOWN** the face. **NEVER** attempt to mow excessively steep slopes, and use caution when turning on any slope.

Safety Alert Symbol



This Safety Alert Symbol means: **“ATTENTION! BECOME ALERT! YOUR SAFETY IS INVOLVED!”**

This symbol is used to call attention to safety precautions that should be followed by the operator to avoid accidents. When you see this symbol, carefully read the message that follows and heed its advice. Failure to comply with safety precautions could result in death or serious bodily injury.

Safety Signs

The signal words **DANGER**, **WARNING**, and **CAUTION** are used on the equipment safety signs. These words are intended to alert the viewer to the existence and the degree of hazard seriousness.



White letters on **RED**

This signal word indicates a potentially hazardous situation which, if not avoided, will result in death or serious injury.



Black letters on **ORANGE**

This signal word indicates a potentially hazardous situation which, if not avoided, could result in death or serious injury.

It may also be used to alert against unsafe practices.



Black letters on **YELLOW**

This signal word indicates a potentially hazardous situation exist which, if not avoided, will result in minor or moderate injury.

It may also be used to alert against unsafe practices.

PECO LIMITED WARRANTY FOR NEW PRODUCTS

A. WHAT IS UNDER WARRANTY?

PECO extends the following warranties to the original purchaser of each new PECO consumer product subject to the following limitations.

1. PRODUCT WARRANTY: Any part of any consumer product, which is defective in material or workmanship as delivered to the purchaser will be repaired or replaced, as PECO elects, without charge for parts or labor, if the defect appears within 12 months from the date of delivery of the product to the original purchaser.

ALL DEFECTIVE PARTS MUST BE RETURNED TO PECO FOR INSPECTION TO DETERMINE VALIDITY OF WARRANTY CLAIMS. Freight and mailing will be borne by the customer.

2. PARTS REPLACED DURING WARRANTY: Any new PECO part which is furnished in performance of this warranty and is defective in material or workmanship as delivered to the purchaser will be repaired or replaced, as PECO elects, without charge if the defect appears within 90 days from the date of installation of such part or before the expiration of the original warranty period, whichever is later.

B. SECURING WARRANTY ADJUSTMENTS.

Call PECO for Return Authorization. Damaged or broken parts other than engines or batteries, must be returned to New PECO, Inc. 100 Airport Road, Arden, NC 28704 before any warranty adjustment can be authorized. At the time of requesting warranty adjustment, the purchaser must present evidence of the date of delivery of the product. The purchaser shall pay any charge for the product to and from Arden, NC.

C. ITEMS NOT COVERED BY PECO WARRANTY.

Engines and batteries attached to PECO products are covered under a separate warranty by the respective manufacturer.

D. UNAPPROVED ALTERATION OR MODIFICATION.

All obligations of New PECO, Inc. under this warranty shall be terminated if products are altered or modified in ways not approved by New PECO, Inc.

E. ACCIDENTS AND NORMAL MAINTENANCE.

The warranty covers only defective material and workmanship. It does not cover depreciation or damage caused by normal wear, accident, improper use or abuse of products. The cost of normal maintenance and normal replacement of service items such as belts, cutting blades, hoses, etc., which are not defective shall be paid for by the purchaser.

F. NO REPRESENTATIONS ADDITIONAL WARRANTIES, DISCLAIMER.

Neither New PECO, Inc. nor any company affiliated with it makes any warranties, representations or promises as to the quality of performance of its products other than those set forth herein. Except as described above, New PECO, Inc. makes no other warranties **AND SPECIFICALLY DISCLAIMS ANY AND ALL IMPLIED WARRANTIES OF FITNESS AND MERCHANTABILITY.**

G. ANY MACHINE USED FOR RENTAL PURPOSES ARE GUARANTEED FOR 45 DAYS FROM DATE OF ORIGINAL SALE ONLY.

H. REMEDIED EXCLUSIVE.

The only remedies the purchaser has in connection with the breach or performance of any warranty on New PECO, Inc. consumer products are set forth above. In no event will PECO be liable for special incidental or consequential damages.

1. NO SERVICE CENTER WARRANTY.

The selling Service Center makes no warranty on his own on any item warranted by New PECO, Inc. unless he delivers to purchaser a separate written warranty certificate specifically warranting the item. The dealer has no authority to make any representation or promise on behalf of PECO or to modify the terms of this warranty in any way.

Section I

Introduction and Description

1-1 Introduction

We are pleased to have you as a PECO customer. Your collection system has been designed to give you a low maintenance, simple, and effective way to collect the grass clippings from your mower. This manual is provided to give you the necessary instructions to properly mount and operate the collection system on your mower. Please read this manual thoroughly. Understand what each control is for and how to use it. Observe all safety decal precautions on the machine and noted throughout the manual.

NOTE: All references made to right, left, front, rear, top or bottom are as viewed from the normal operator's position on the mower.

1-2 Description

The grass collection system is designed for turf maintenance where there is a need to collect the grass clippings as the mower cuts the turf. It is also used for picking up leaves and in pre-season and post-season clean-up. The engine/blower/blade assembly is mounted on the right side of the mower. The blower draws grass clippings from the discharge area of the cutter deck back to the 12 cubic foot aluminum box at the rear portion of the mower frame. The operator can engage the blower on the right side of the unit by starting the external engine. Once the container is full of clippings, the operator can easily push and raise the lift handle, releasing the container's rear door and the container will pivot towards the ground.

Section II

Installation for Use

2-1 Preparation Of Mower

On units with the Donaldson air cleaner, loosen the hardware and rotate the air cleaner to the forward-most position. See Figure 2-1a.

Figure 2-1a

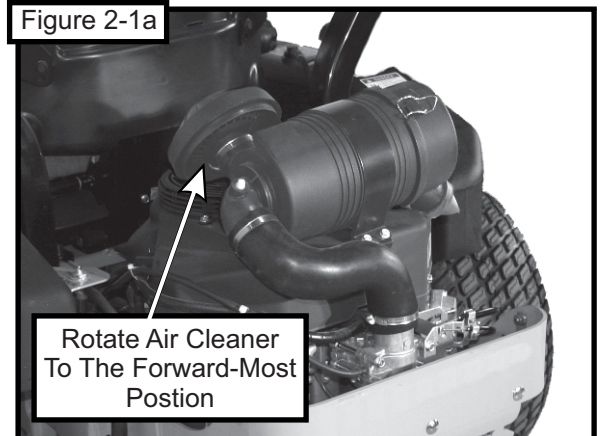

Remove the rear bumper and hardware from the mower frame. Refer to Figure 2-1b and page 6 of your Snapper Pro parts manual.

Figure 2-1b [Page 6 Snapper Pro Parts Manual](#)

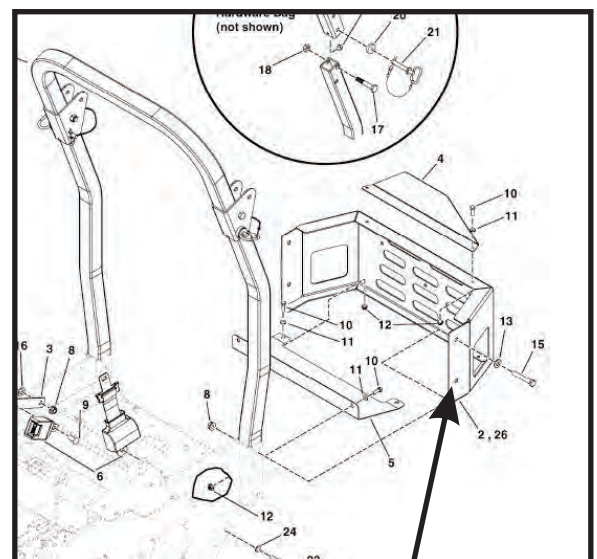

Remove
Rear Bumper
and Hardware

2-2 Left and Right Frame Bracket Installation

Secure the left frame bracket P#(B0801) and right frame bracket P#(B0802) to the rear frame of the mower where the rear bumper was removed. Use the existing hardware from the rear bumper as shown in Figure 2-2.

Figure 2-2

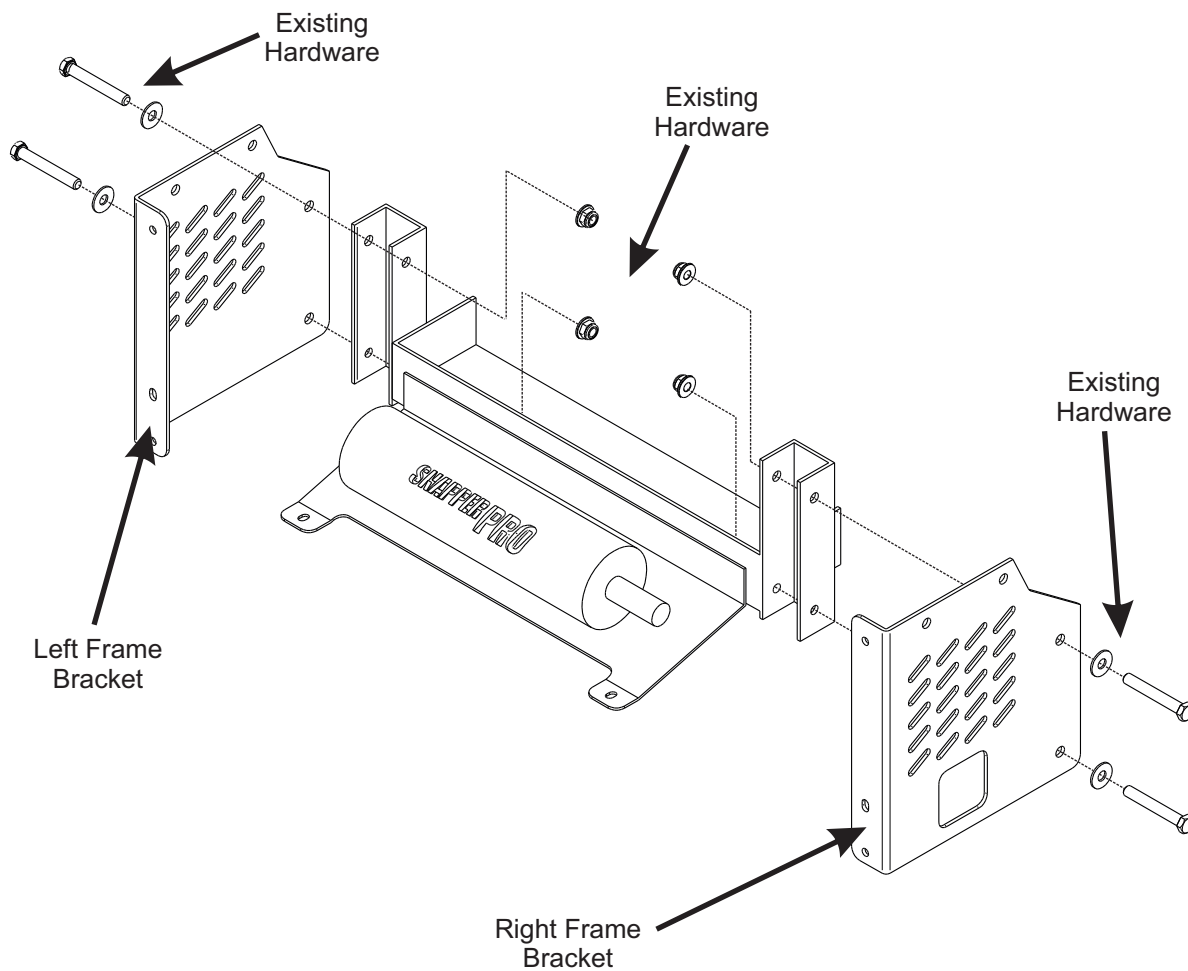

2-3 Rear Frame Bracket Installation

Attach the rear frame bracket P#(B0803) to the left and right frame bracket using (2) 3/8"-16 x 1" HHCS P#(K1191) and (2) 3/8"-16 nylon flange locknuts P#(K2038). Refer to Figure 2-4.

2-4 Muffler Guard Bracket Installation

Attach (2) muffler guard brackets P#(B0806) to the rear frame bracket using (1) 1/4"-20 x 3/4" HHCS P#(K1222) and (1) 1/4"-20 nylon flange locknut P#(K2014) PER BRACKET. Leave the hardware finger tight.

Secure both muffler guard brackets to the existing muffler guard, using (1) 1/4"-20 x 3/4" HHCS P#(K1222) and (1) 1/4"-20 nylon flange locknut P#(K2014) PER BRACKET. Tighten all hardware at this time. Refer to Figure 2-4.

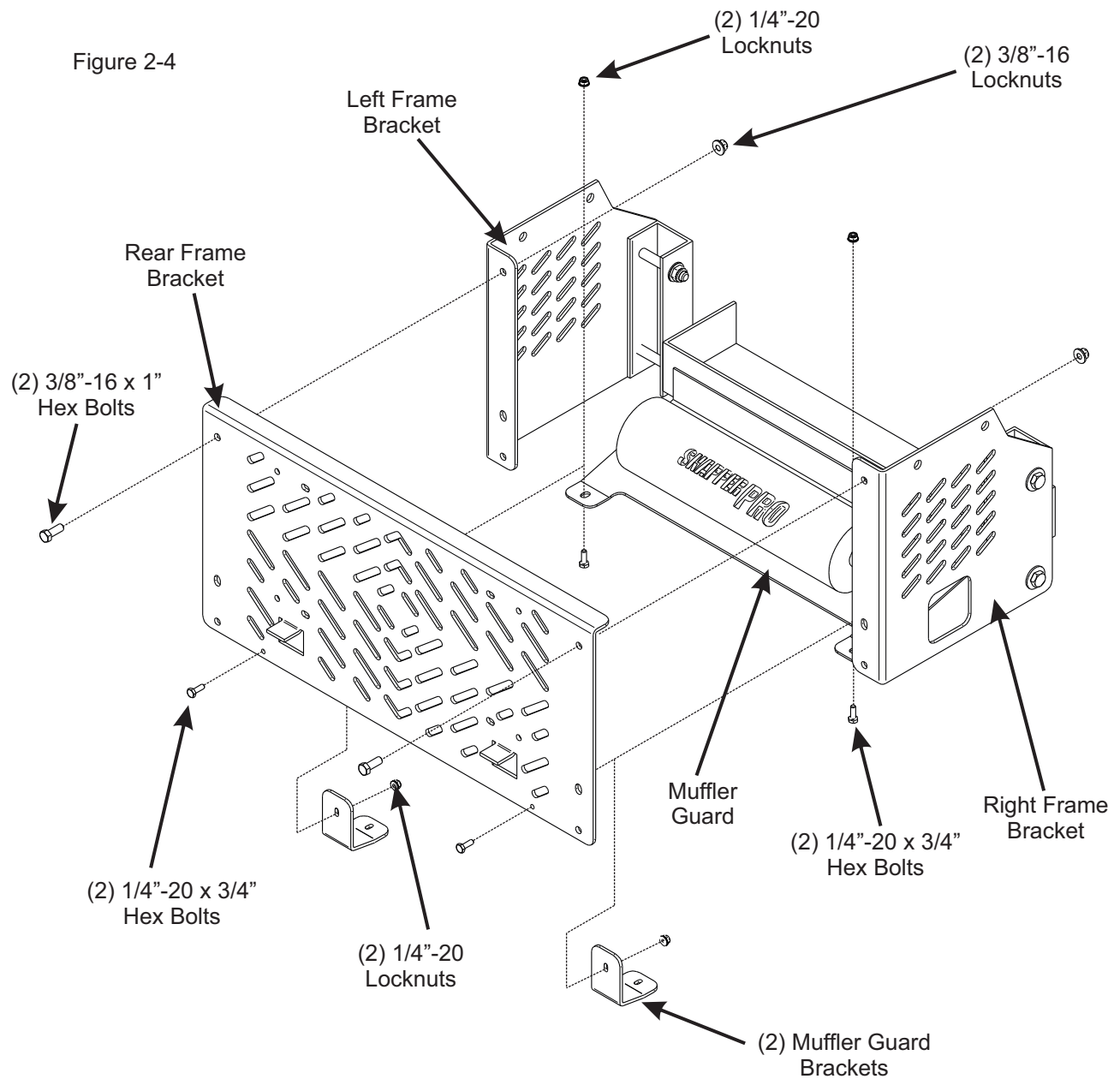

2-5 Outer Engine Mount Tube Installation

Secure the outer engine mount tube P#(B3727) to the rear frame bracket using (2) 3/8"-16 x 3" u-bolts P#(K1432) and (4) 3/8"-16 nylon flange locknuts P#(K2038). **Note:** Leave the hardware finger tight until the engine blower blade assembly has been installed. Refer to Figure 2-6.

2-6 Engine Mount Arm Assembly Installation

Insert the engine mount arm assembly P#(A0274) into the outer engine mount tube and secure with (1) detent pin P#(J0248). Refer to Figure 2-6.

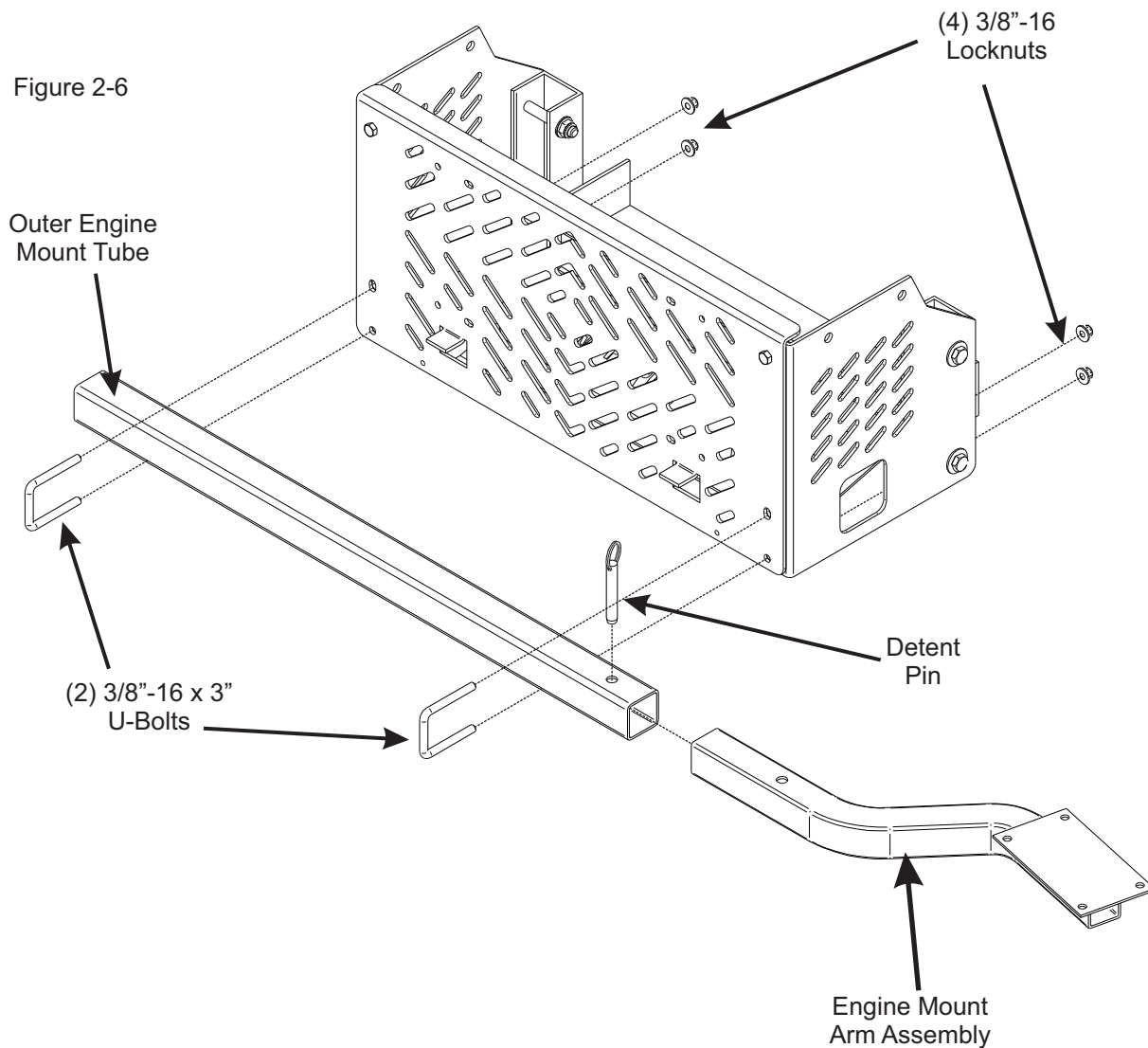

2-7 Engine/Blower/Blade Assembly Installation

Place the engine/blower/blade assembly on top of the engine mount arm assembly as shown in Figure 2-7a. Secure the assembly using (4) 5/16"-18 x 1-1/2" HHCS P#(K1157) and (4) 5/16"-18 nylon flange lock nuts P#(K2516) as shown in Figure 2-7b. Adjust the position of the outer engine mount tube so that the blower housing has at least 1" of clearance from the rear tire. Tighten the u-bolts on the outer engine mount tube at this time.

Figure 2-7a

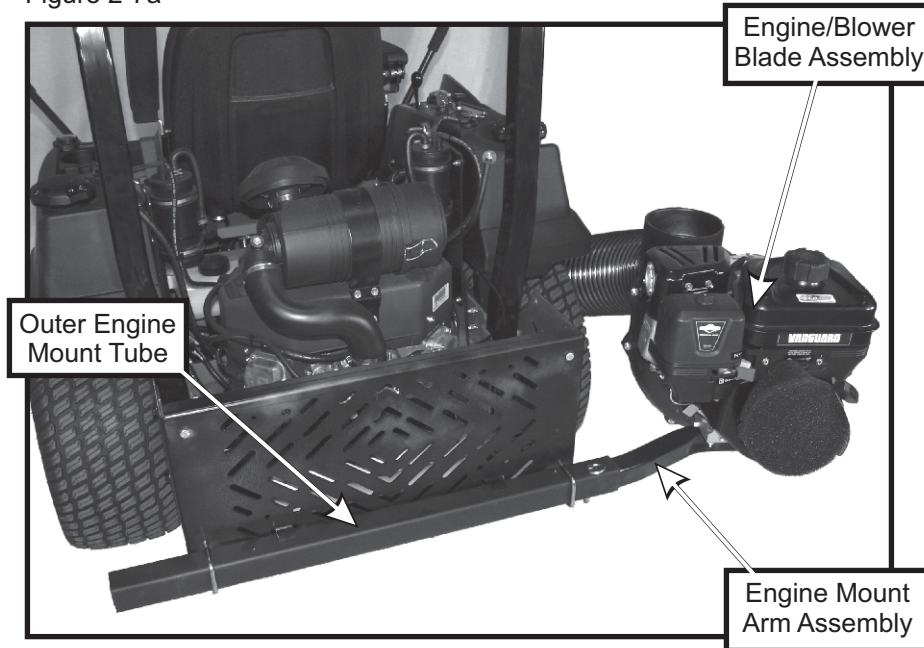
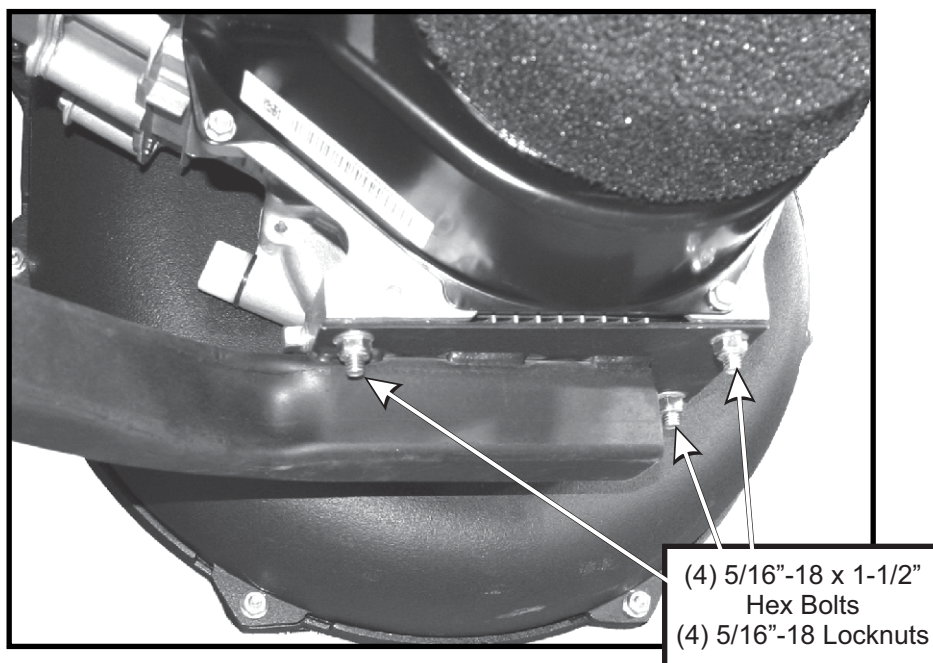

Figure 2-7b



2-8 Left and Right Frame Leg Installation

Attach the left frame leg P#(B0804) to the left frame bracket and the right frame leg P#(B0805) to the right frame bracket using (2) 1/2"-13 x 1" HHCS P#(K1231) and (2) 1/2"-13 nylon flange locknuts P#(K2012) PER BRACKET. Refer to Figure 2-8a and 2-8b.

Figure 2-8a

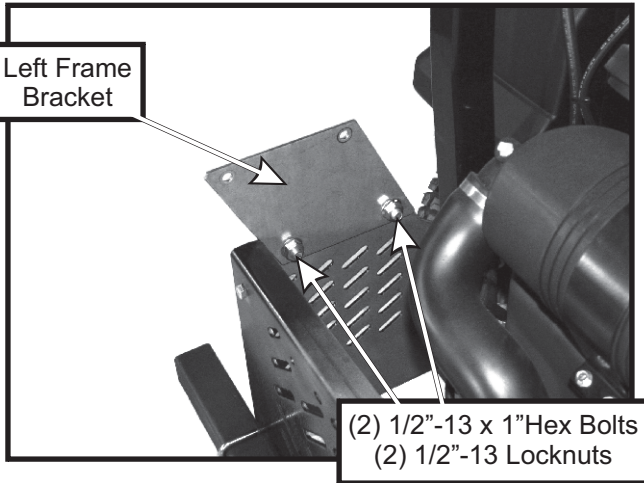
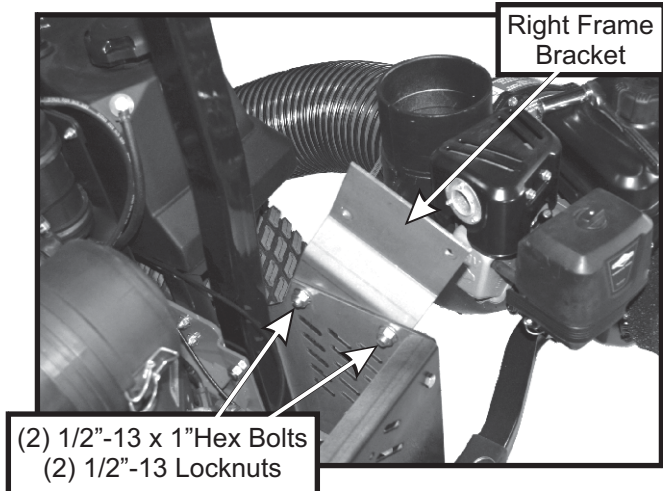
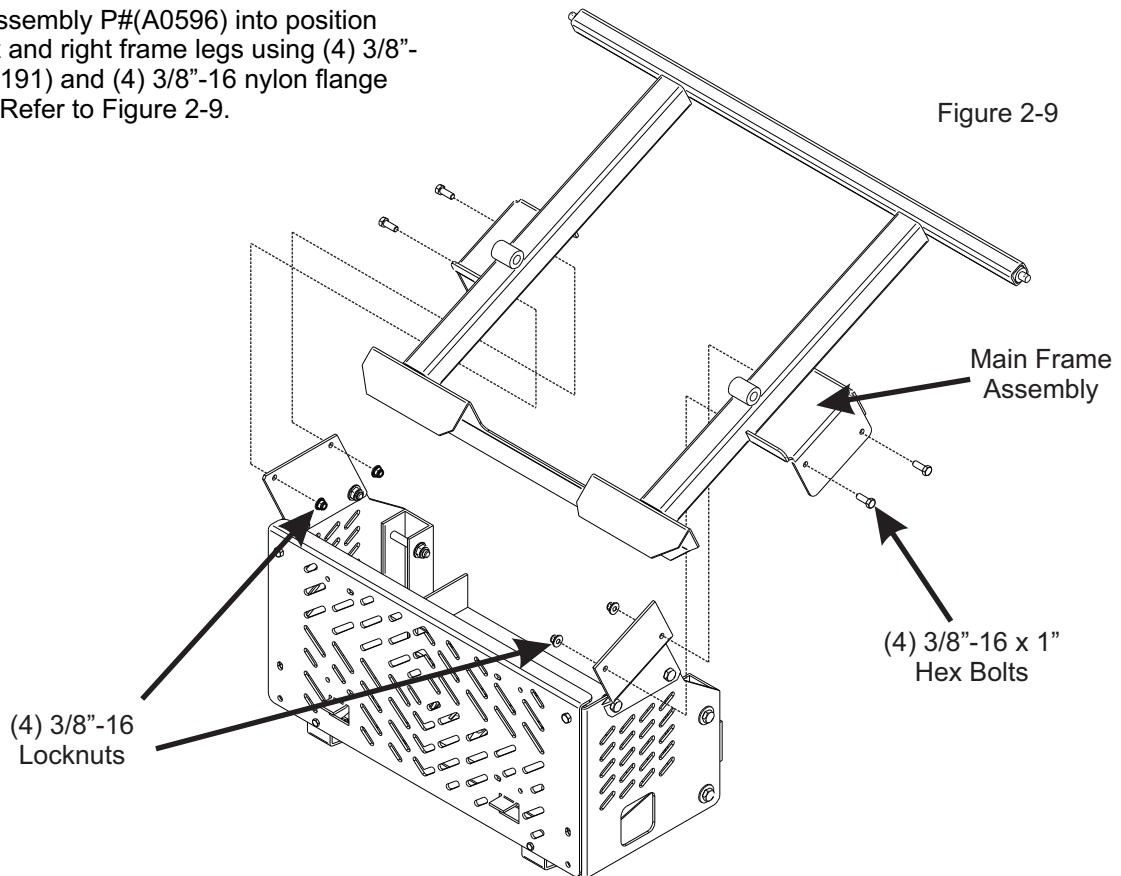

Figure 2-8b



2-9 Main Frame Assembly Installation

Lift the main frame assembly P#(A0596) into position and secure to the left and right frame legs using (4) 3/8"-16 x 1" HHCS P#(K1191) and (4) 3/8"-16 nylon flange locknuts P#(K2038). Refer to Figure 2-9.



2-10 Lift Handle Installation

NOTE: Before continuing the lift handle installation, have someone assist you in turning the grass container upside down. Insert (1) 3/8"-16 x 2" HHCS P#(K1208) into the lift handle P#(A0273), and secure with (1) 3/8"-16 flange nut P#(K1215). Thread the flange nut onto the bolt upside down, as shown in Figure 2-10a.

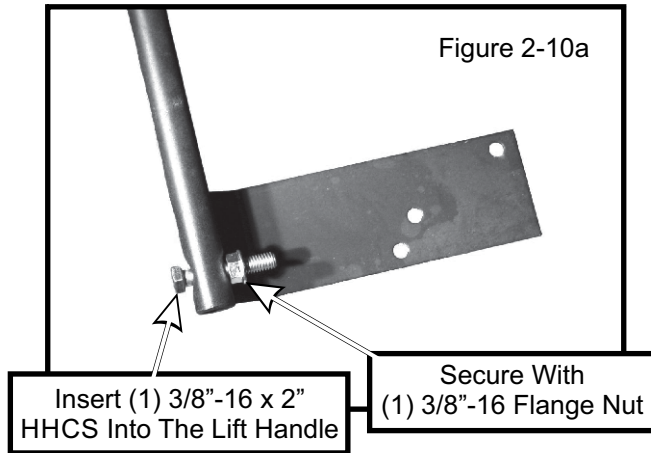

Slide the lift handle through the slot on the handle mount bracket. Insert the lift handle into the box frame as shown in Figure 2-10b, and secure using (1) 3/8"-16 flange nut P#(K1215) on the inside of the container as shown in Figure 2-10c.

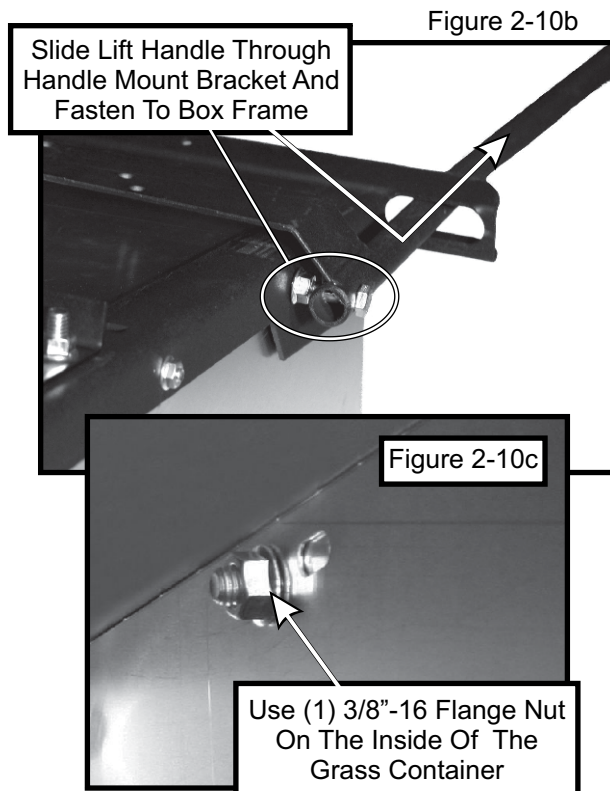

Fasten the ball joint P#(K1442) to the end of the latch rod P#(A0620). Tighten the ball joint to approximately half way down the threads on the latch rod. Attach the ball joint to the latch hook as shown in Figure 2-10d, using (1) 5/16"-24 hex nut P#(K1444) and (1) 5/16" lock washer P#(K0043).

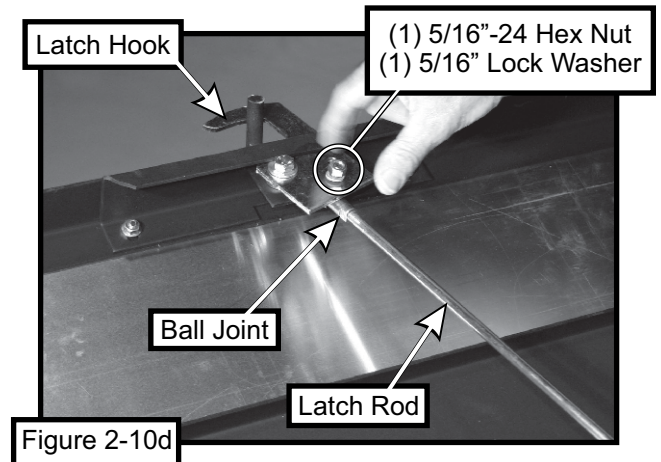

Attach the other end of the latch rod to the lift handle, as shown in Figure 2-10e. Attach on end of the spring P#(J0176) to the lift handle and the other end of the spring to the handle mount bracket as shown in Figure 2-10f. Adjust the ball joint up or down on the latch rod threads until the latch hook closes completely. After adjusting the latch hook, secure the latch rod to the lift handle using (1) cotter pin P#(K0094).

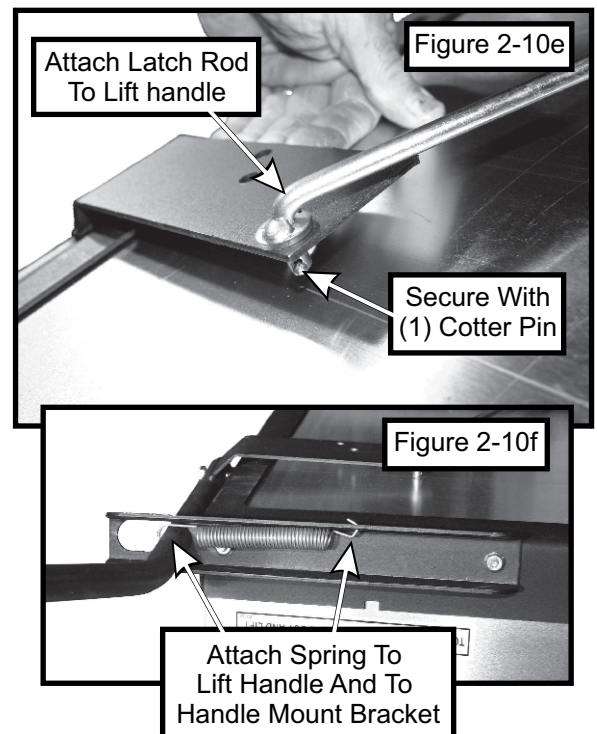

2-11 Aluminum Grass Container Installation

NOTE: It is recommended that (3) people assist in mounting the container. With three people available, two can lower the container onto the frame while the third person inserts the pivot pins P#(K0172) through the holes as shown in Figure 2-11a. Insert the pins from the outside to the inside. Secure with (1) 5/8" washer P#(K0058) and (1) 5/32" x 2-5/8" hair pin clip P#(K0088) per pivot pin (Figure 2-11b). Reattach the bottom ends of the door opening linkages to the main frame by using (1) Rue-Ring cotter pin P#(K1437) per side. To test the functionality of the dump mechanism, pull the lift handle away from the unit, and lift upward. The door of the container should open and the box should pivot clockwise towards the ground.

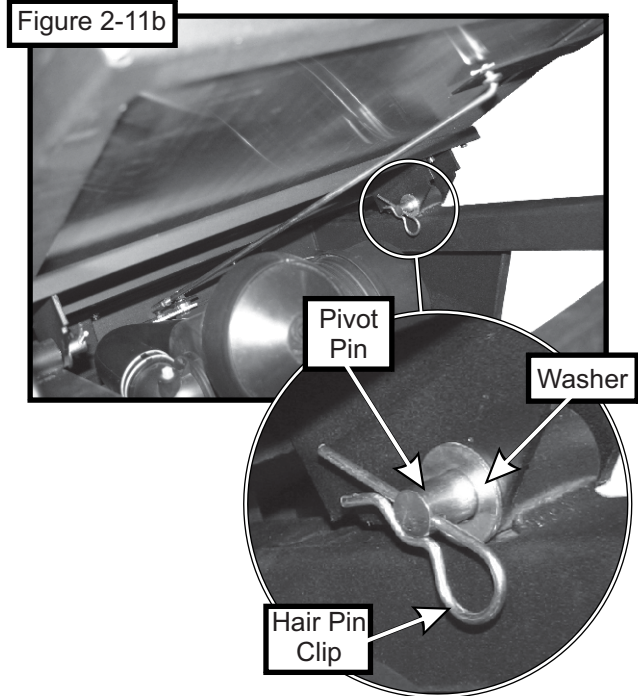
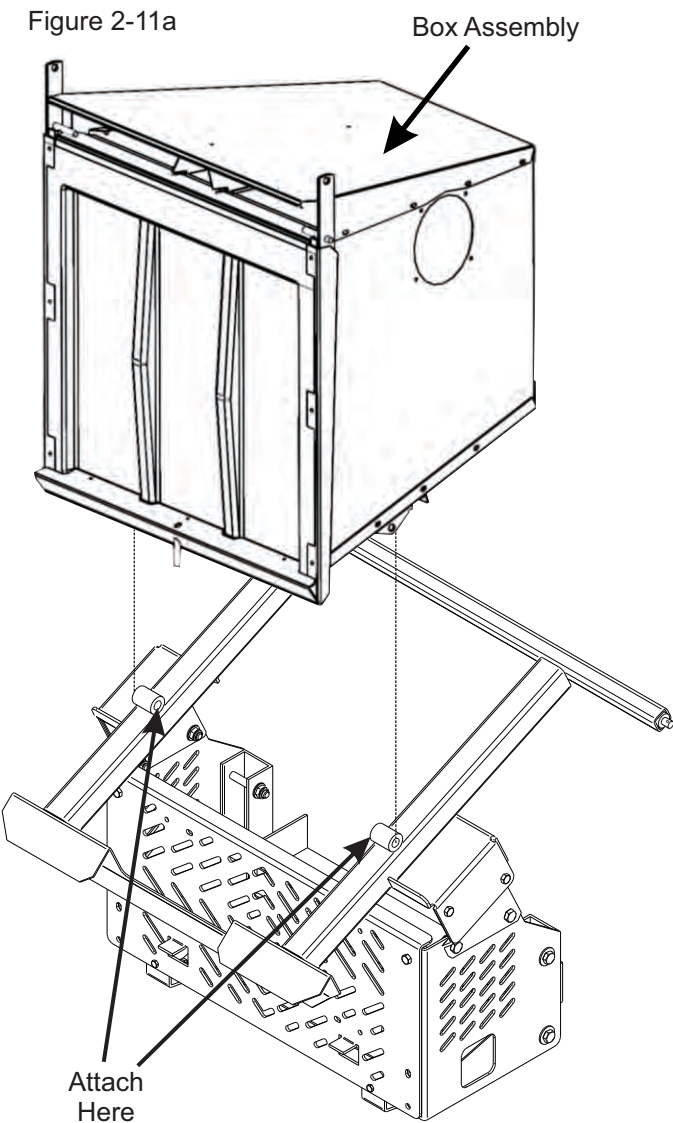

2-12 Dump Mechanism Adjustment

The linkage may be adjusted in two places, at the adjusting screw P#(K1435) and the latch assembly items. See page 20 for visual clarification. To change the door closure tightness, screw the adjusting screw (Figure 2-12) in or out. To adjust the latch, change the length of the latch rod by screwing the latch adjusting ball joint in or out. The latch hook pivot should be in the middle of the slot in the latch hook pivot plate. Slide the pivot back or forth and then re-tighten.

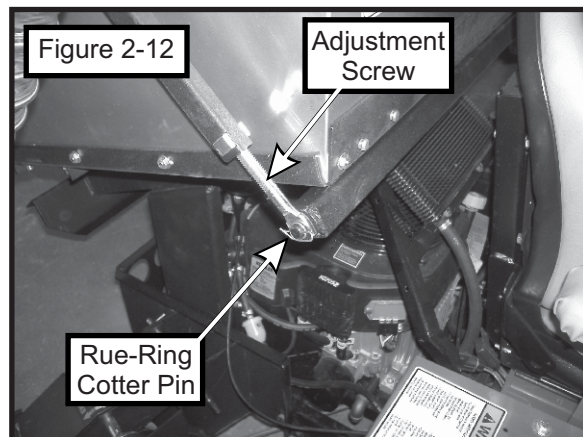

2-13 Exhaust Diverter Installation

To prevent the engine exhaust from damaging the engine/blower/blade assembly, insert (1) exhaust diverter P#(J0282) onto the end of the muffler exhaust tube. Position the diverter so that the exhaust blows to the rear of the mower, clearing the engine mount arm assembly. Secure the exhaust diverter with (1) exhaust clamp kit P#(X1064). Refer to Figure 2-13.

Figure 2-13

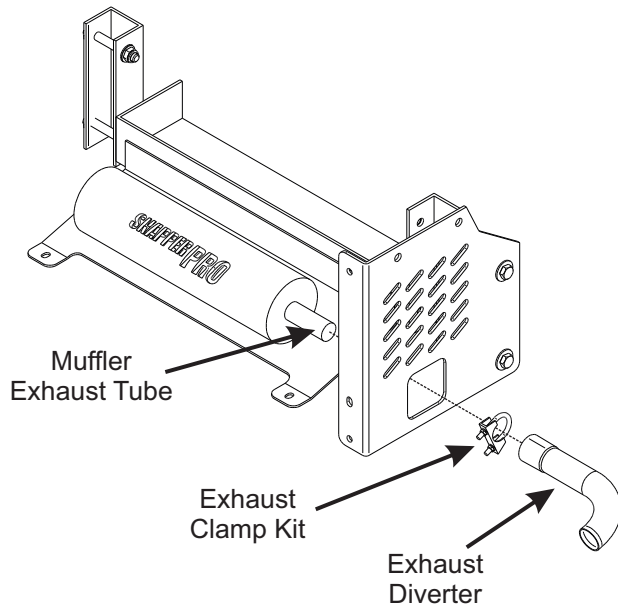

2-14 Blower Cone Installation

Thread (1) 5/16"-18 jam nut P#(K0120) onto each end of (2) 5/16"-18 x 2-1/2" HHCS P#(K0125). Now partially thread the bolts into each of the two tabs located on the blower housing. Place blower cone so the two tabs line up with the bolts then tighten completely (Figure 2-14).

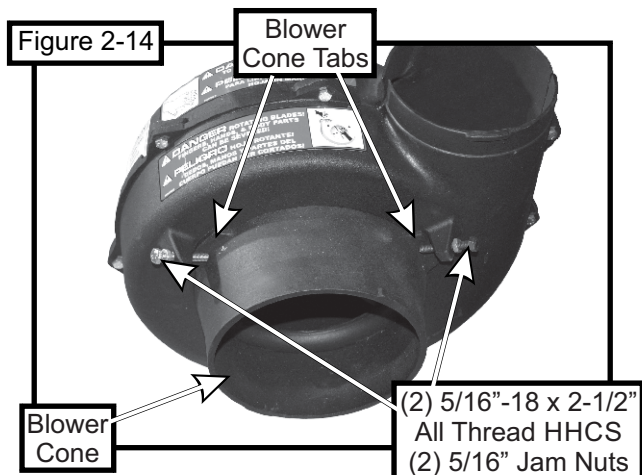

2-15 Boot To Mower Deck Installation

Lift the grass deflector on the discharge chute. Insert (1) boot rod P#(B0348) through the outside set of mounting holes on the deflector bracket, as shown in Figure 2-15a. Secure the boot rod with (1) hair pin clip P#(K0099).

Install the aluminum boot P#(E1902) with the top inside surface of the boot flush to the top surface of the mower deck. Secure the aluminum boot to the boot plate using (2) 3/8"-16 x 1" carriage bolts P#(K1182) and (2) 3/8"-16 nylon flange lock nuts P#(K2038). Insert the bolts from the inside of the boot so that the threads are on the outside of the boot. This will prevent any grass clippings from collecting on the threads. Refer to Figure 2-15b.

Figure 2-15a

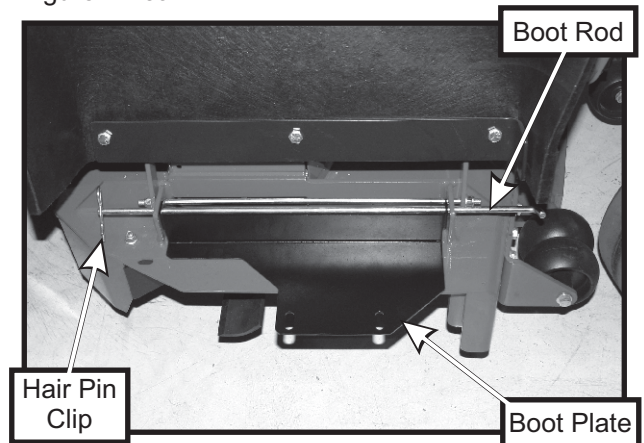
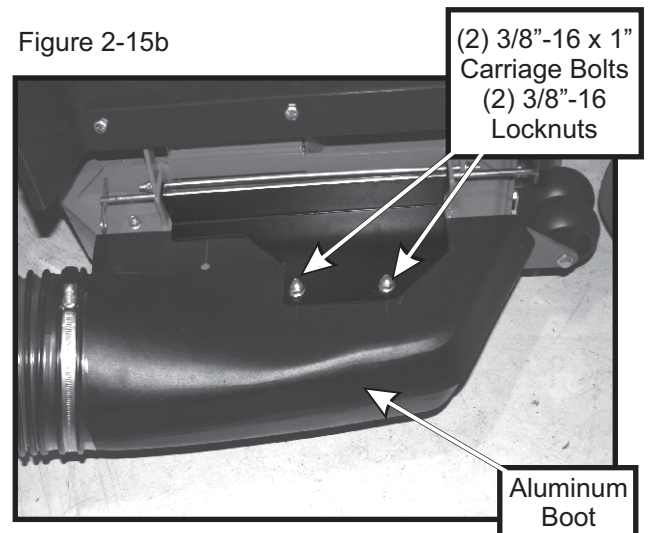

Figure 2-15b



2-16 Length Of Hose Adjustment

The hoses in steps 2-17 and 2-18 must be cut to fit your machine. Follow steps 2-17 and 2-18. Do not cut the hoses until you have tried to fit them on your machine. Remember that the hoses have to be long enough to adjust for the blower assembly's movement as well as allow for enough clamping surface between the inlet, blower assembly, and the deck boot.

2-17 Upper Hose Installation

Slide a pre-assembled hose clamp P#(J0060) onto both ends of the 6" upper hose (Figure 2-19). Then slide one end of the 6" hose onto the 6" hose ring P#(E0007). Make sure there is about a two-inch overlap between the hose end and the hose ring. Lift the locking pin on the 7" inlet ring P#(V1152) and insert the hose ring. Secure the hose ring with the locking pin. Proceed to slide the opposite end of the 6" hose onto the outlet of the blower assembly. See (Figure 2-19) for details. Make sure both ends of the hose are clearly attached to the inlet and the blower assembly inlet. Tighten the hose clamps.

2-18 Lower Hose To Blower Cone Installation

Slide a pre-assembled hose clamp P#(J1000) over both ends of the lower hose. Then proceed to slide the lower hose onto the blower cone. Tighten the hose clamp. The assembly should look like Figure 2-19.

2-19 Lower Hose To Boot Installation

Take the unattached end of the lower hose and slide it over the circular end of the boot. Use the lower hose clamp to secure the hose to the boot (Figure 2-19). Tip: Before securing clamp rotate hose counter-clockwise (away from yourself) approximately 1" to aid in retaining boot to mower deck.

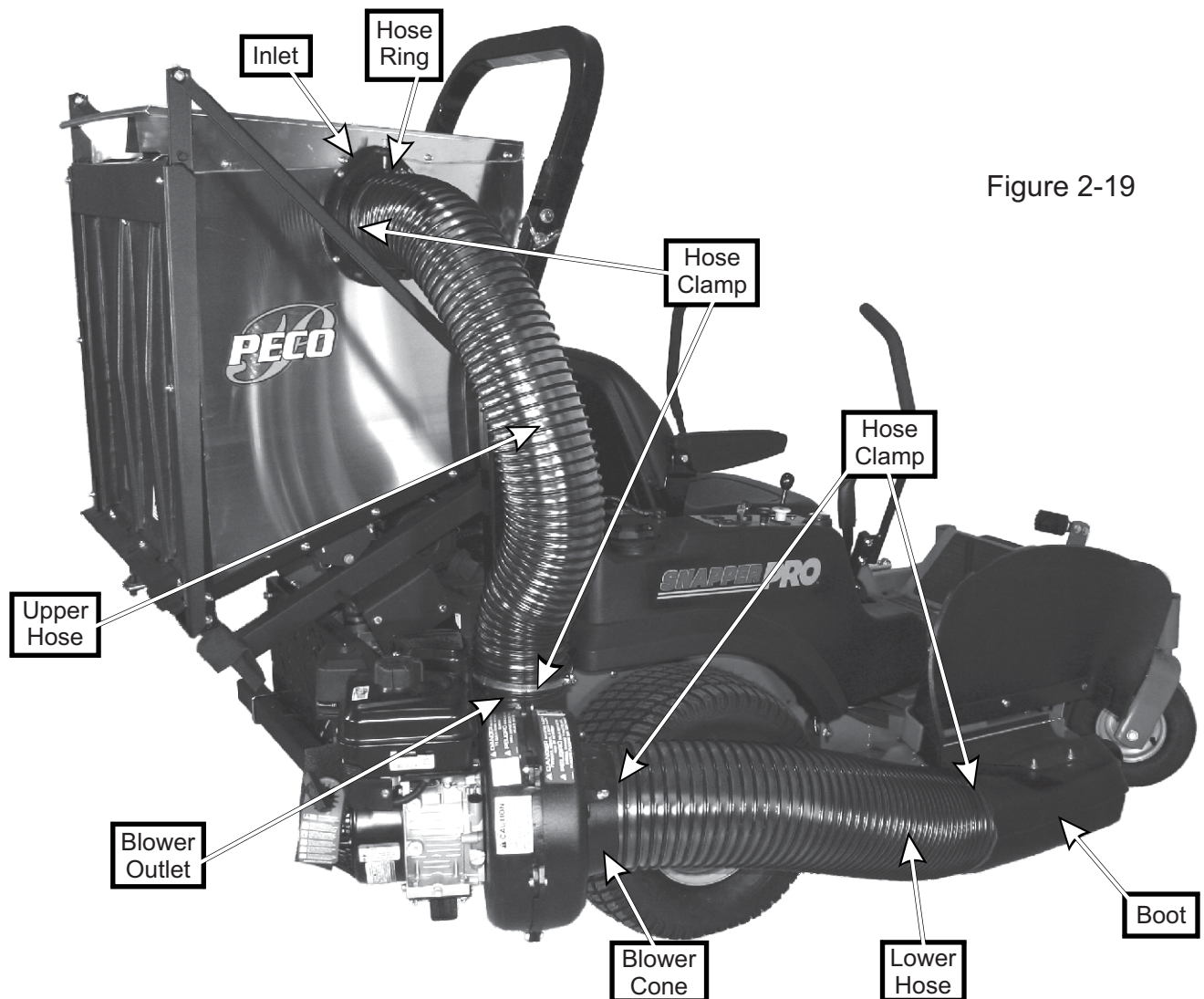

Figure 2-19

2-20 Impeller Blade Removal/Replacement

To gain impeller blade (#1) access, first remove the blower cone (#2) from the blower housing, located on the PTO assembly P#(A1821), by removing two blower cone bolts and nuts (#3). Next, remove the blower housing front (#4) by removing seven bolts and nuts (#5) around the outer housing edge. Refer to Figure 2-21.

To Remove: First, remove one 3/8"-16 x 1-1/2" HHCS P#(K1211) (#6), one taper-lock bushing washer P#(K0278) (#7) and one spacer bushing P#(S3242) (#8) from the taper-lock bushing (#9). See Figure 2-20. Next, remove two 1/4"-20 x 1" HHCS (#10) and place them into the threaded holes (#11) of the taper-lock bushing P#(S4302). Last, gradually thread each bolt evenly into the taper-lock bushing, forcing the blade to break-away from the taper-lock bushing.

Tips on removing impeller blade;

- 1 - Try carefully hitting the base of the impeller blade (#1), between each vein (#12), with a rubber mallet to loosen the taper-lock bushing hold.
- 2 - Spray break-free lubricant into the surrounding areas of the taper-lock bushing (#9) and repeat Tip 1.

To Replace: First, place the impeller blade (#1) over the drive shaft (#13). Next, slide the taper-lock bushing (#9) on to the drive shaft and into the impeller blade, aligning the **non-threaded** holes (#14) of the taper-lock bushing to the threaded holes of the impeller blade. Then, fasten by using two 1/4"-20 x 1" HHCS (#10), one spacer bushing (#8) one taper lock bushing washer (#7), and one 3/8"-16 x 1-1/2" HHCS (#6). Torque all bolts to the specifications located in the chart towards the back of this manual. Last, rotate the impeller blade to ensure that the blade is clear of contact on all sides of the blower housing.

Figure 2-20

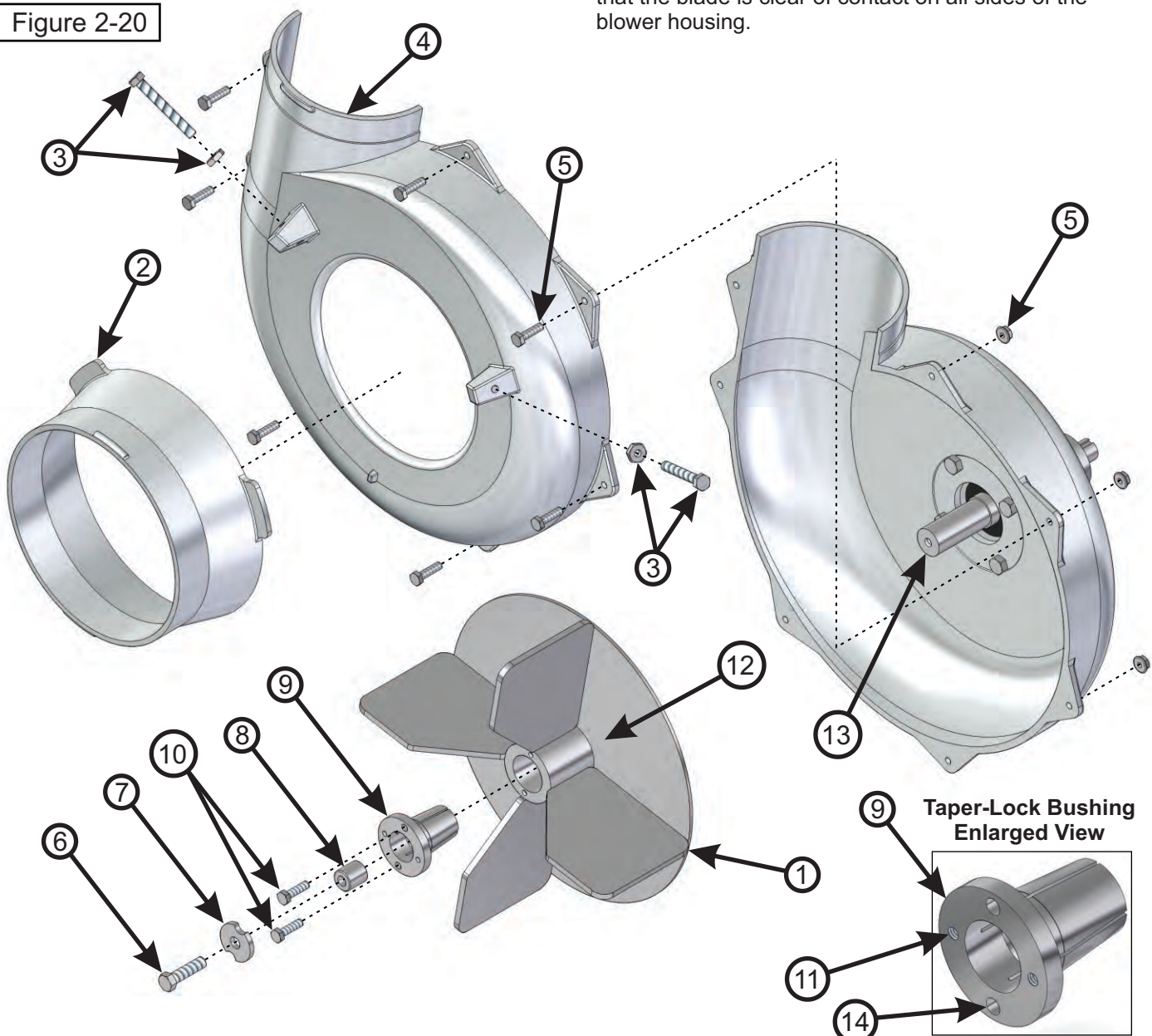

2-21 Weight Kit Installation

The collection system requires that a weight kit is installed to the front of the mower to counter-balance the weight of the collection system, when filled with debris.

NOTE: The weight bracket is secured to the caster mower frame, then the weight is added to the weight brackets. It is recommended that two people perform this procedure. If another person is not available, use a rolling hydraulic floor jack to keep the weight into position while you secure the weight to the weight bracket.

Attach the weight bracket P#(B0523) to the front frame of the mower using the existing holes. Secure the weight bracket using (2) 1/2"-13 x 1" HHCS P#(K1231) and (2) 1/2"-13 nylon flange locknuts P#(K2012). Refer to Figure 2-21a.

Position (1) weight bar P#(B2220) on top of the weight bracket as shown in Figure 2-21b. Center the weight bar on the weight bracket and secure using (2) 1/2"-13 x 4-1/4" u-bolts P#(K0331) and (4) 1/2"-13 nylon flange locknuts P#(K2012).

Figure 2-21a

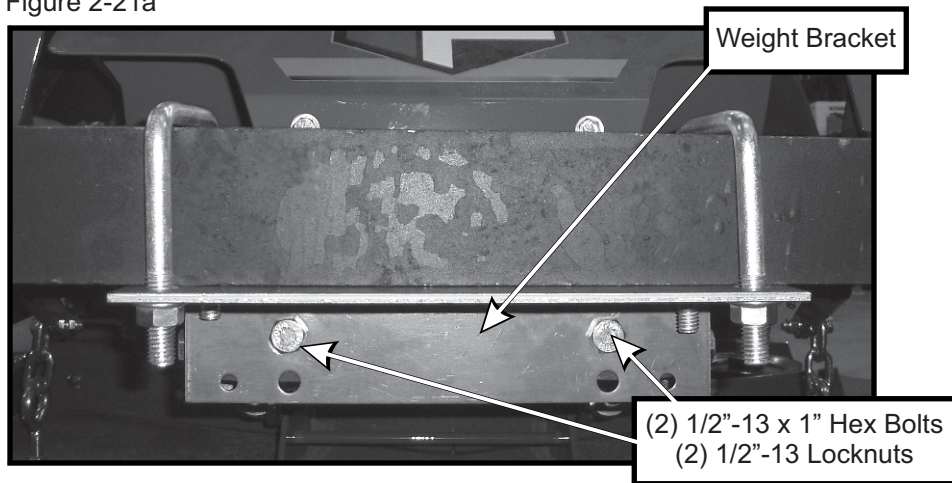
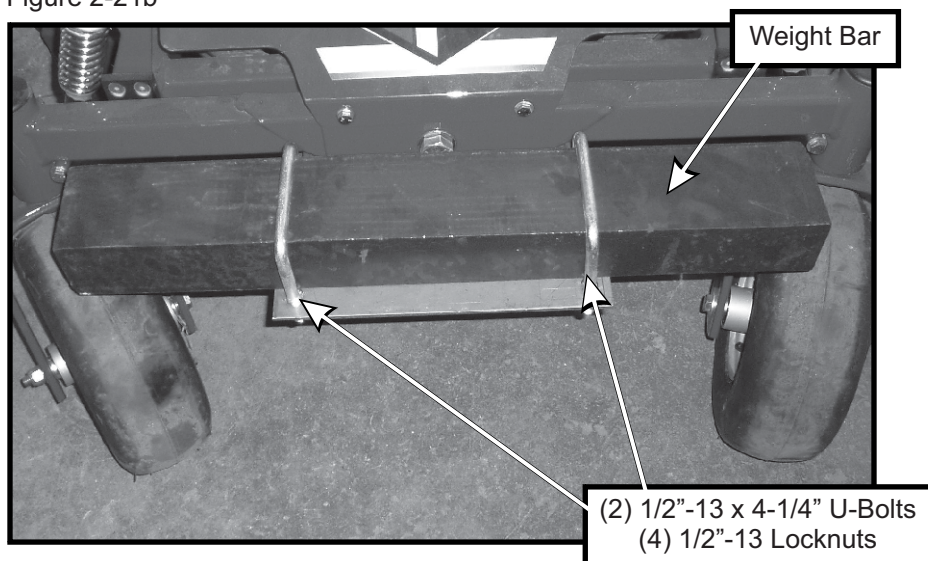

Figure 2-21b



2-22 Throttle Cable Installation

To install the throttle cable kit P#(A0060) to the box assembly, align the large end of the slot in the throttle base plate (Figure 2-22a) with the rivets located on the front of the box assembly frame (Figure 2-22b). Place the throttle base plate over the rivets. Slide the throttle cable kit to the right, moving the smaller end of the slot over the rivets. When positioned correctly, the throttle spring plate will snap into place (Figure 2-22c).

To remove the throttle cable kit, lift the throttle spring plate and slide the throttle kit to the left.

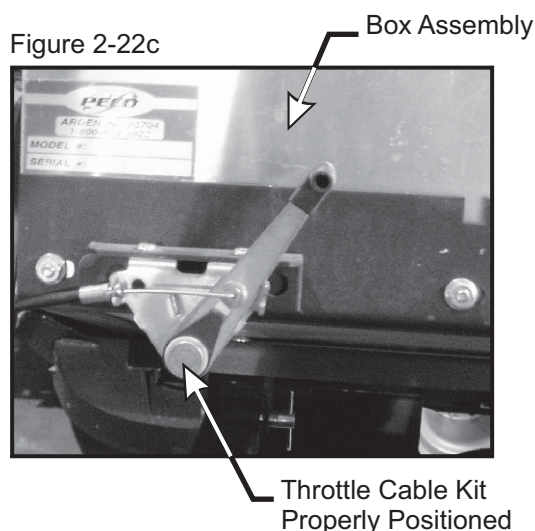
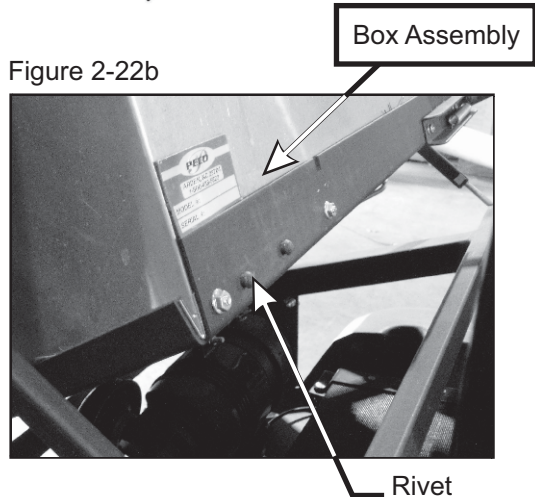
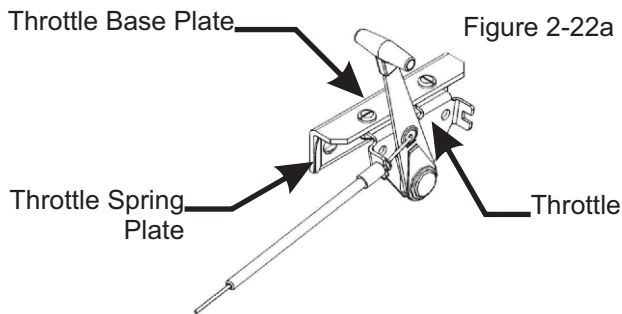
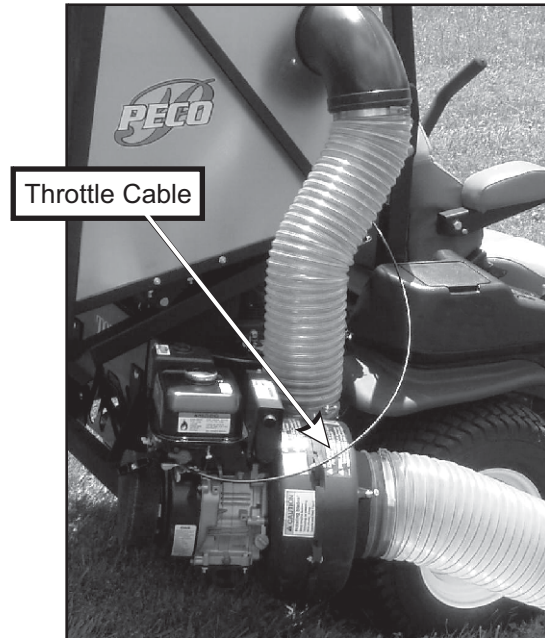
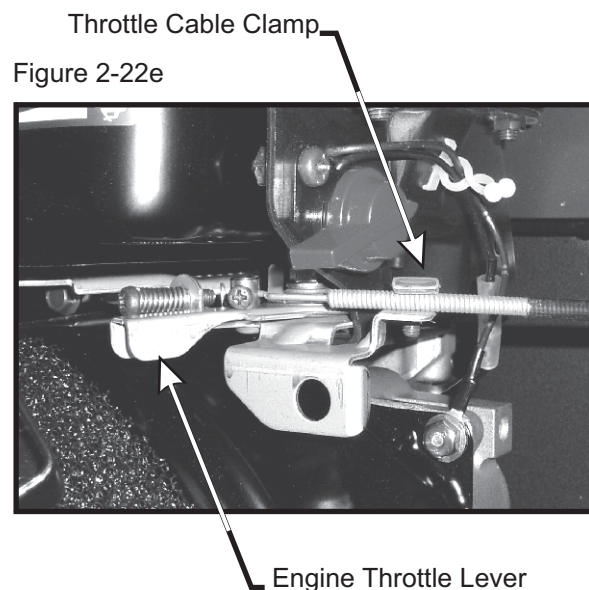

Figure 2-22d



To fasten the throttle cable end to the engine, place the throttle control lever into the "stop" position. Rotate the engine throttle lever to the "stop" position. Thread the wire end of the throttle cable into the engine throttle lever eyelet and tighten the screw. Fasten the throttle cable sleeve to the clamp on the engine throttle. Rotate the throttle control lever into the "fast" position to check for proper installation.

Note: Cable sleeve may need to be cut depending on the engine type. Once throttle cable is attached, pull the box handle to dump the box and be sure the cable does not alter the movement of the box.



**A0560
ALUMINUM GRASS
CONTAINER
EXPLODED VIEW**

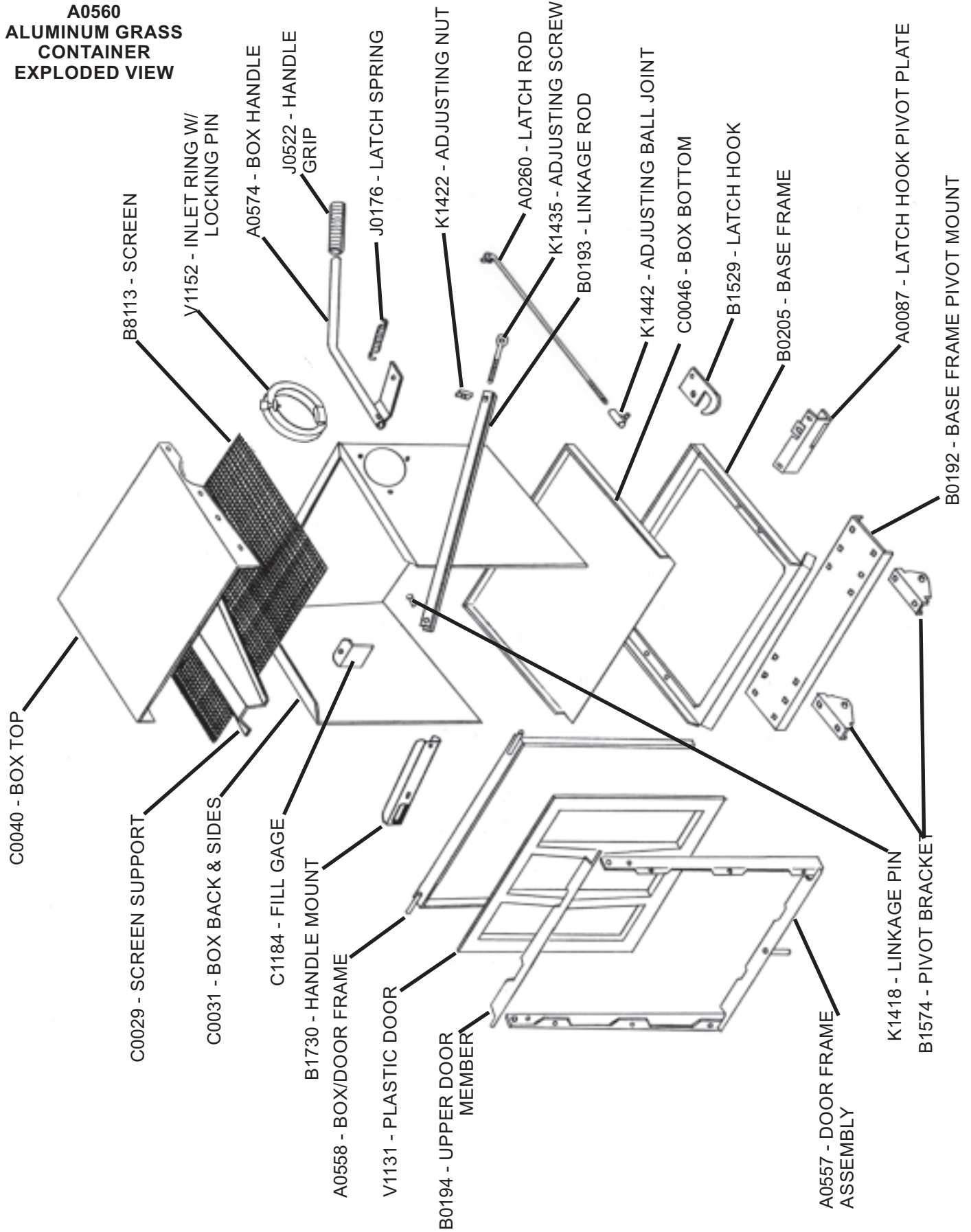

Unit Model #: 05721201

Mower: Snapper Pro

Owner's Manual: Q0461

Mower Type: S150XT

Deck Size: 52" & 61"

Deck Type: iCD Cutting System

Vac Type: 12 Cu. Ft. Pro 12 DFS

Drive Type: ENG: B&S 6.5HP Vanguard

Revision #: Final Release 5/08/13

Fits Year(s): 2012-2013



A1912 Vac Kit

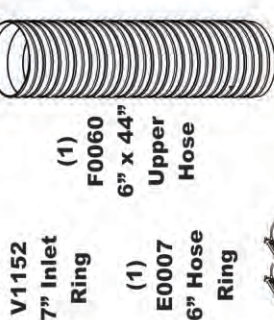

(1) V1152 7" Inlet Ring



(1) E0007 6" Hose Ring



(2) J0006 6" Hose Clamps

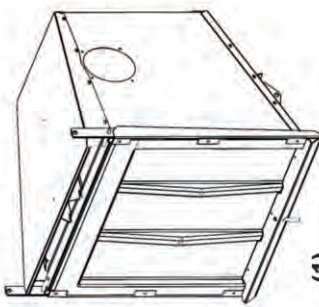

(1) A0560 Box Assembly



(1) A0574 Box Handle Assembly



(2) B0193 Door Linkage

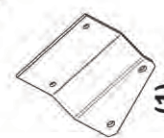

(1) B0805 Right Frame Leg



(1) B0804 Left Frame Leg

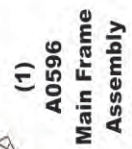

(1) A0596 Main Frame Assembly

A1913 Mount Kit



(1) F0080 8" x 39" Lower Hose



(2) J0080 8" Hose Clamps

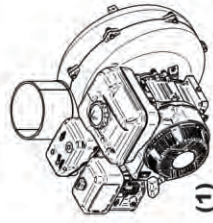

(1) A639 Engine/Blower Blade Assembly



(2) B0806 Muffler Guard Bracket



(1) HB0519 Hardware Bag



(1) E6009 8" Blower Cone



(1) A0274 Engine Mount Arm Assembly

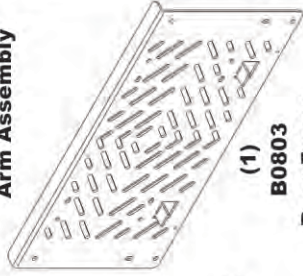

(1) B0803 Rear Frame Bracket



(1) A0060 70" Throttle Kit For (5.5. & 6.5 HP)

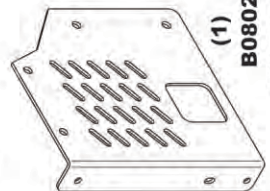

(1) B0802 Rt. Frame Bracket

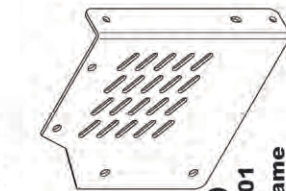

(1) B0801 Lt. Frame Bracket

A1914 Boot Kit



(1) E1902 Boot



(1) B0348 Boot Rod

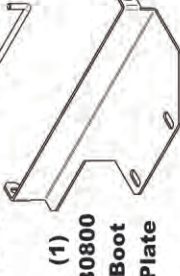

(1) B0800 Boot Plate



(1) HB0555 Hardware Bag

A1915 Weight Kit

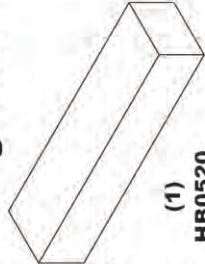

(1) B2220 27" Weight Bar



(1) HB0520 Hardware Bag

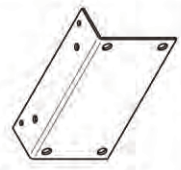

(1) B0523 Weight Bracket

Unit Model #: 05721202

Mower: Snapper Pro

Owner's Manual: Q0461

Mower Type: S150XT

Deck Size: 52" & 61"

Deck Type: iCD Cutting System

Vac Type: 12 Cu. Ft. Pro 12 DFS

Drive Type: ENG: B&S 900 Series

Revision #: Final Release 5/08/13

Fits Year(s): 2012-2013



A1912 Vac Kit

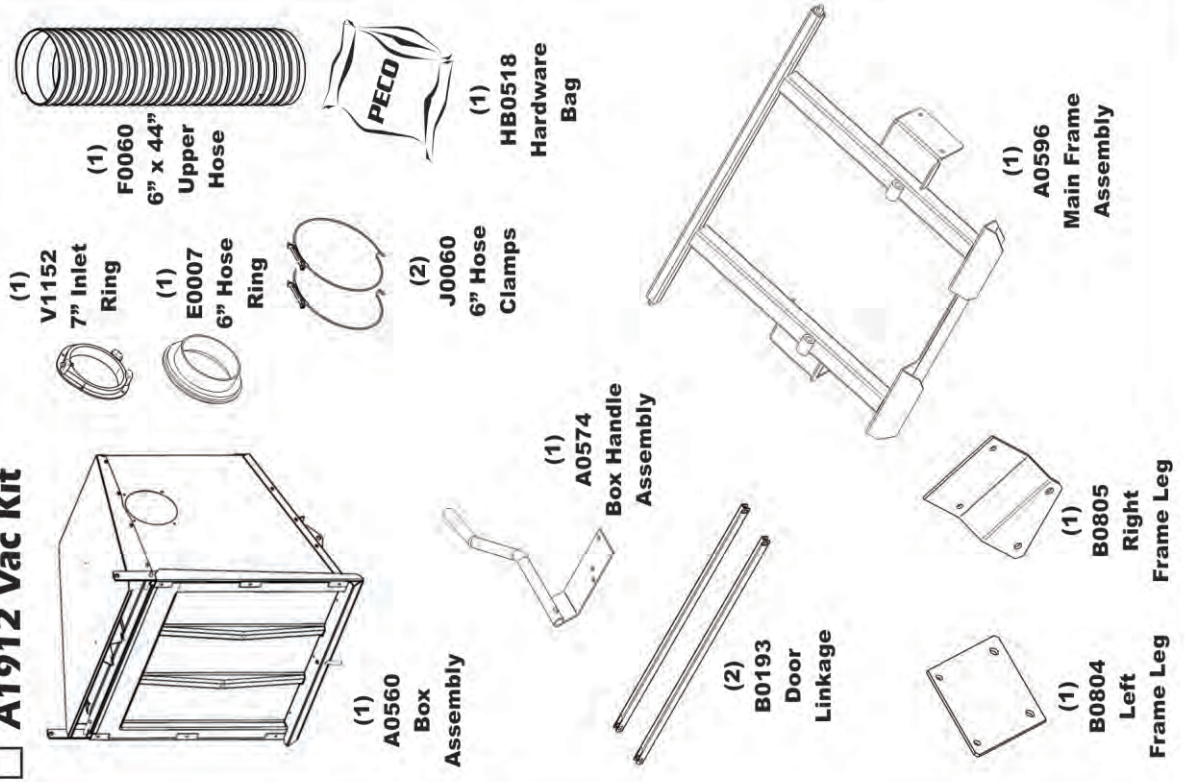

A1917 Mount Kit

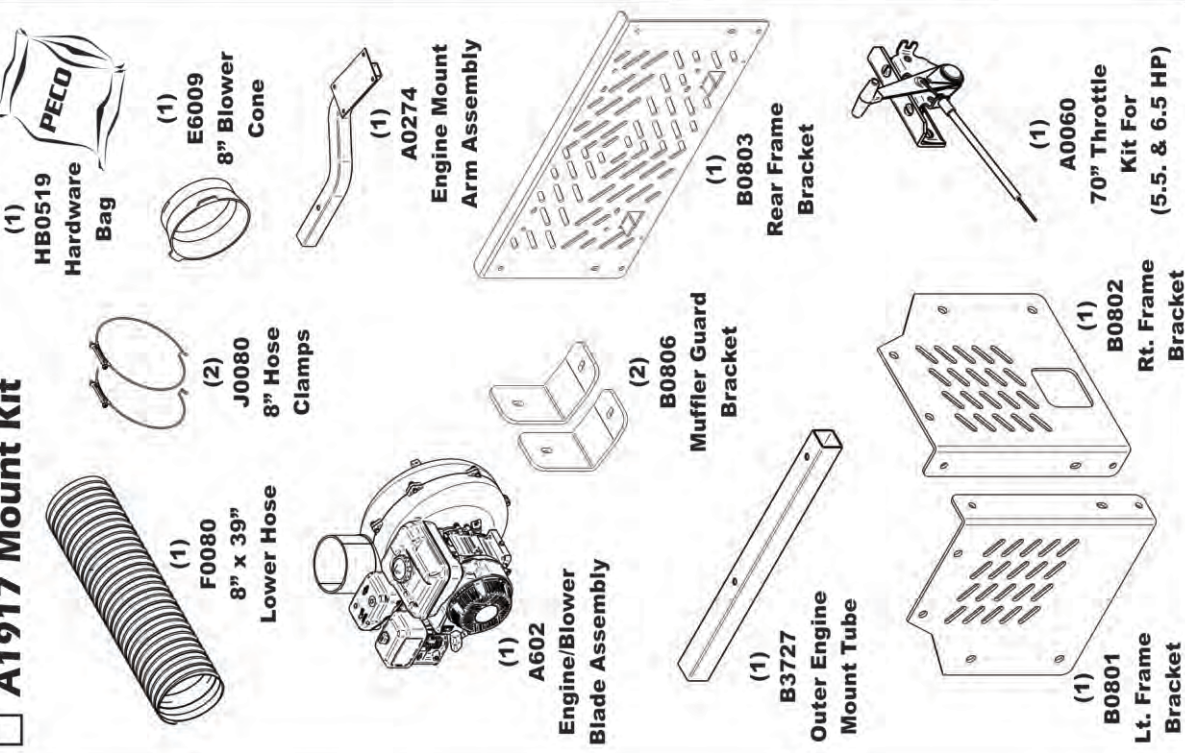

A1914 Boot Kit

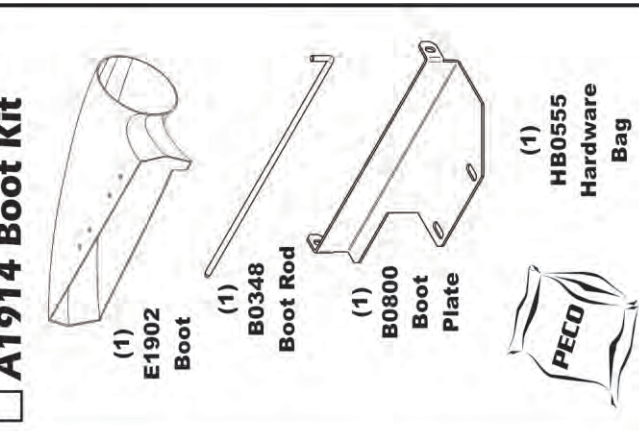

A1915 Weight Kit

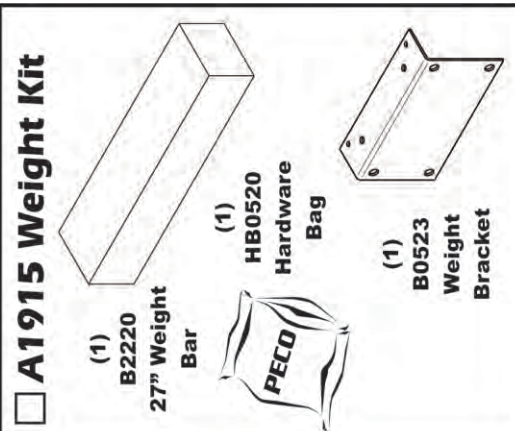

SECTION III OPERATING INSTRUCTIONS

3-1 General Safety

Only qualified people familiar with this operator's manual and the mower's operator's manual should operate this machine.

3-2 Operation & Tips On Mowing

- A. Perform BEFORE EACH USE maintenance list in paragraph 4-1.
- B. Start the engine/blower/blade assembly.
- B. Start mower.
- C. With the mower at high idle speed, engage the mower deck.
- D. Proceed to operate the control levers of the mower.

Note: If the collection system does not appear to be collecting the grass clippings; disengage the deck, and blower, engage the parking brake and turn the mower off. Check the upper hose, lower hose, top screen and boot for clogs.

To obtain the maximum effectiveness from your collection system the tips listed below should be followed:

- * Watch your speed- Normal conditions will allow a speed of up to approximately 5 mph, but thick, heavy damp conditions will require reduced ground speed.
- * Mow with sharp blades- A sharp blade cuts cleaner.
- * Wet grass and leaves will decrease effectiveness and will increase horsepower requirements.
- * Mow at higher cutting heights- Remove and mulch no more than 2" of grass length with each mowing. (Experts recommend not cutting off more than 1/3 of the grass blade length at any given time.)
- * Mow twice, at different height settings, (high, then low), if grass is extra tall.
- * Remember that horsepower requirements will vary with the mowing conditions such as type and height of turf grass, moisture content, amount of leaves, whether the terrain is flat or sloped, etc.

3-3 Unloading The Collection System

Note: Press the tab, located behind the operator's left side, downward to feel if the collection system is full. If the container is full there will be resistance when depressing the tab.

- A. Stop the forward movement of the mower.
- B. Disengage the mower deck.
- C. Using the throttle cable slow the engine down to idle.
- D. Push the dump handle, on the left of the operator, away from the unit. While holding the handle pushed away, move the handle upward. The container door will swing upward and the container will rotate downward. The container will release its contents.
- E. Once the contents of the container have fallen out, the container is ready to move back into its normal operating position. With the handle in the 'away' position, pull the handle downward until it stops. Move the handle towards the center of the mower. This motion will allow the latch to lock back into collection position.

Note: If you do not hold the handle away from the mower as you pull the handle downward, the latch will not lock and the container can unexpectedly release the contents collected.

SECTION IV MAINTENANCE

4-1 Maintenance Checklist

Before each use:

1. Check blades and spindles to be sure that no foreign objects, such as wire or steel strapping bands, are wrapped around them.
2. Inspect blades for wear. Replace if necessary. If it is necessary to sharpen the blades, remove the blades from the spindles before sharpening. DO NOT sharpen blades while still attached to the mower.
3. Make sure all shields are in place and in good condition. Repair or replace any missing or damaged shields.
4. Listen for abnormal sounds, which might indicate loose parts, damaged bearings, or other damage. Correct any deficiency before continuing operation.
5. Check for wear or deterioration of the upper or lower hoses. If there are any portions of the hose that have been torn or worn through, replace with genuine PECO parts.

After Each Use:

1. Clean all debris from machine especially from the container, and off of safety decals. Replace any missing or illegible decals.
2. Clean all debris from the box screen.
3. Inspect unit for worn or damaged components. Repair or replace before the next use. Any replacement component installed during repair shall include the components current safety decal specified by the manufacturers to be affixed to the component.

SECTION V PARTS AND SERVICE

5-1 Parts And Service Information

PECO collection system owners should record the name and telephone number of their Service Center. Your Service Center will be happy to supply replacement parts, accessories, and do any service or repairs to your collection system. If for any reason your Service Center is unable to service your collection system or supply replacement parts, contact PECO and include the following information on the chart below.

THE SERIAL NUMBER PLATE
IS LOCATED ON THE BOX
ASSEMBLY P#(A0560)

PECO	
OUTDOOR POWER EQUIPMENT	
Model Number	<input type="text"/>
Serial Number	<input type="text"/>
Arden, North Carolina 28704	

WRITE THE MODEL AND
SERIAL NUMBER IN THE
BOX ABOVE FOR FUTURE
REFERENCE.

Unit Model Number: _____

Unit Engine Size: _____

Unit Serial Number: _____

Date of purchase: ____/____/____

Dealer/Distributor Name: _____

Dealer's/Distributor's: _____ **State:** _____ **Zip:** _____

Phone Number: _____

Address: PECO Inc.

10 Walden Drive

Arden, NC 28704

Phone #: (828) 684-1234 or Toll Free: (800) 438-5823

Email: peco@lawnvac.com

SAFETY DECALS

To promote safe operation, PECO supplies safety decals on all products manufactured. Damage can occur to safety decals either through shipment, use or reconditioning. Contact your local Service Center for replacement decals.

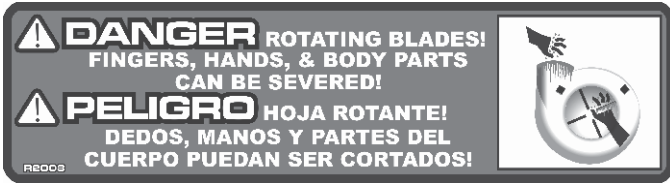

R2008



R2007

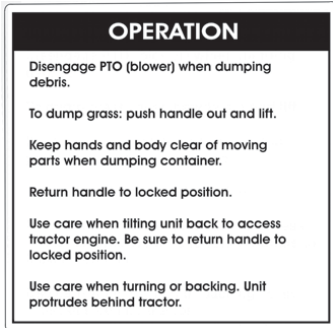

Part #: R1049



Part #: R1069



Part #: R1053



Part #: R1057



Part #: R1055



Part #: R1054



Part #:R4015



Part #: R4037



Part #: R4027



Part #: R1052



Part #: R1065



Part #:R1051



Part #:R4008



Part #: R1070

TORQUE SPECIFICATIONS

Proper torque for American fasteners used on Peco equipment.
Recommended Torque in Foot Pounds (Newton Meters).*

AMERICAN Bolt Head Markings

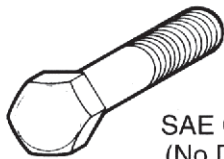

SAE Grade 2
(No Dashes)

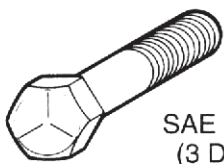

SAE Grade 5
(3 Dashes)

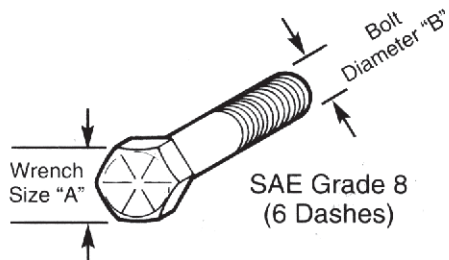

SAE Grade 8
(6 Dashes)

WRENCH SIZE (IN.) "A"	BOLT DIAMETER (IN.) "B" AND THREAD SIZE	SAE GRADE 2	SAE GRADE 5	SAE GRADE 8
7/16	1/4 - 20 UNC	6 (7)	8 (11)	12 (16)
7/16	1/4 - 28 UNF	6 (8)	10 (13)	14 (18)
1/2	5/16 - 18 UNC	11 (15)	17 (23)	25 (33)
1/2	5/16 - 24 UNF	13 (17)	19 (26)	27 (37)
9/16	3/8 - 16 UNC	20 (27)	31 (42)	44 (60)
9/16	3/8 - 24 UNF	23 (31)	35 (47)	49 (66)
5/8	7/16 - 14 UNC	32 (43)	49 (66)	70 (95)
5/8	7/16 - 20 UNF	36 (49)	55 (75)	78 (106)
3/4	1/2 - 13 UNC	49 (66)	76 (103)	106 (144)
3/4	1/2 - 20 UNF	55 (75)	85 (115)	120 (163)
7/8	9/16 - 12 UNC	70 (95)	109 (148)	153 (207)
7/8	9/16 - 18 UNF	79 (107)	122 (165)	172 (233)
15/16	5/8 - 11 UNC	97 (131)	150 (203)	212 (287)
15/16	5/8 - 18 UNF	110 (149)	170 (230)	240 (325)
1-1/8	3/4 - 10 UNC	144 (195)	266 (360)	376 (509)
1-1/8	3/4 - 16 UNF	192 (260)	297 (402)	420 (569)
1-5/16	7/8 - 9 UNC	166 (225)	430 (583)	606 (821)
1-5/16	7/8 - 14 UNF	184 (249)	474 (642)	668 (905)
1-1/2	1 - 8 UNC	250 (339)	644 (873)	909 (1232)
1-1/2	1 - 12 UNF	274 (371)	705 (955)	995 (1348)
1-1/2	1 - 14 UNF	280 (379)	721 (977)	1019 (1381)
1-11/16	1-1/8 - 7 UNC	354 (480)	795 (1077)	1288(1745)
1-11/16	1-1/8 - 12 UNF	397 (538)	890 (1206)	1444 (1957)
1-7/8	1-1/4 - 7 UNC	500 (678)	1120 (1518)	1817 (2462)
1-7/8	1-1/4 - 12 UNF	553 (749)	1241 (1682)	2013 (2728)
2-1/16	1-3/8 - 6 UNC	655 (887)	1470 (1992)	2382 (3228)
2-1/16	1-3/8 - 12 UNF	746 (1011)	1672 (2266)	2712 (3675)
2-1/4	1-1/2 - 6 UNC	870 (1179)	1950 (2642)	3161 (4283)
2-1/4	1-1/2 - 12 UNF	979 (1327)	2194 (2973)	3557 (4820)

METRIC

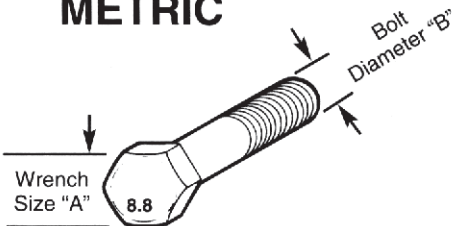

Numbers appearing on bolt heads indicate ASTM class.

*Use 75% of the specified torque value for plated fasteners. Use 85% of the specified torque values for lubricated fasteners.

Proper torque for metric fasteners used on Peco equipment.
Recommended torque in foot pounds (newton Meters).*

WRENCH SIZE (mm) "A"	BOLT DIA. (mm) "B"	ASTM 4.6	ASTM 8.8	ASTM 9.8	ASTM 10.9
8	5	1.8 (2.4)		5.1 (6.9)	6.5 (8.8)
10	6	3 (4)		8.7 (12)	11.1 (15)
13	8	7.3 (10)		21.1 (29)	27 (37)
16	10	14.5 (20)		42 (57)	53 (72)
18	12	25 (34)	74 (100)	73 (99)	93 (126)
21	14	40 (54)	118 (160)	116 (157)	148 (201)
24	16	62 (84)	167 (226)	181 (245)	230 (312)
30	20	122 (165)	325 (440)		449 (608)
33	22		443 (600)		611 (828)
36	24	211 (286)	563 (763)		778 (1054)
41	27		821 (1112)		1138 (1542)
46	30	418 (566)	1119 (1516)		1547 (2096)



**10 WALDEN DRIVE
ARDEN, NORTH CAROLINA 28704
(800) 438-5823 OR (828) 684-1234 FAX: (828) 684-0858
EMAIL: peco@lawnvac.com
WEBSITE: www.lawnvac.com**