

MODEL#: 290001221

MOWER NAME: TORO ZMASTER COMMERCIAL

MOWER MODEL: 74925

MOWER DECK SIZE: 60"

VAC NAME: 15 CUBIC FOOT PRO BAGGER

ENG: 900 SER. BR (9.00 GROSS TORQUE / 205 cc)

BOM0302



FOR YEAR: 2008 - 2005

REVISED: 5/9/2012

A???? UNIT ASSEMBLY

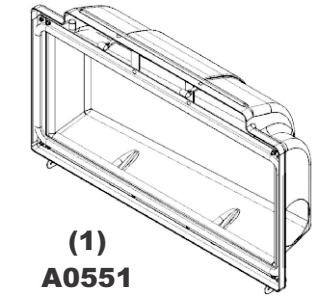

(1)
A0551
TOP
ASSEMBLY



(1)
V1054
6" PLASTIC
INLET



(1)
8" x 41"
LOWER
HOSE



(1)
6" x 29"
UPPER
HOSE

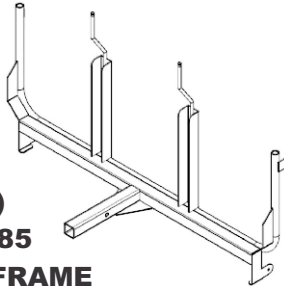

(1)
A0585
UPPER FRAME
ASSEMBLY



(2)
J6006
7" - 8"
HOSE CLAMPS

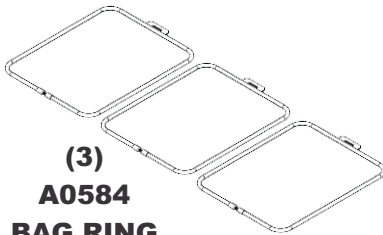

(3)
A0584
BAG RING
ASSEMBLY

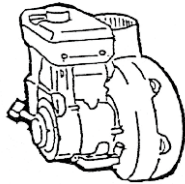

(1)
ENGINE/
BLOWER/
BLADE ASSY.



(1)
E6009
8" BLOWER
CONE

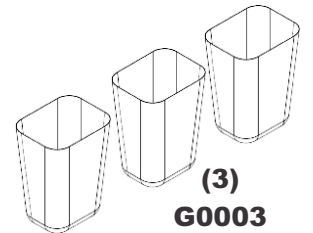

(1)
A0903
ENGINE MOUNT
ARM ASSY.

(3)
G0003
4 CU. FT.
COLLECTION
BAGS



(1)
#HB0307
HARDWARE
BAG

(1)
A????
LWR. MNT.
ASSEMBLY

A0563 - WEIGHT KIT

(2)
B0026
WEIGHT
BRACKETS

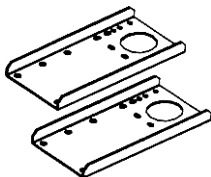

(1)
#HB0206
HARDWARE
BAG



(1)
B2220
WEIGHT

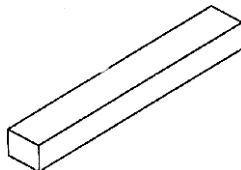

A0562 - 60" BOOT KIT

(1)
#HB0207
HARDWARE
BAG



(1)
B0201
BOOT
PLATE

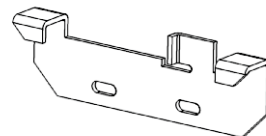

(1)
E1039
BOOT

