

MODEL#: 06621217

MOWER NAME: JOHN DEERE

MOWER MODEL: 717A, 727A Z TRAK

MOWER DECK SIZE: 48" & 54" DECK

VAC NAME: 12 CUBIC FOOT BOX



NOTE:



FOR YEAR: 2005-2003

REVISED: 04/26/06

WAS
066212-PTO-04

A0567 12 PTO VAC UNIT ASSEMBLY

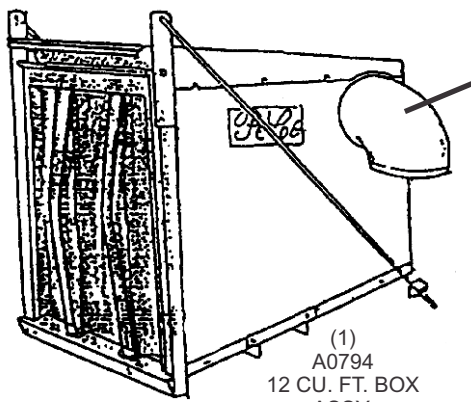

(1)
V1054
6" PLASTIC
INLET



(1)
6" x 30"
UPPER
HOSE



(1)
8" x 34" LOWER
HOSE



(2)
J6006
7"-8" HOSE
CLAMPS



(1)
HB0211
HARDWARE
BAG



(1)
HB0197
ENGINE PULLEY
HARDWARE BAG

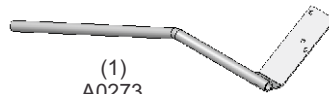

(1)
A0273
BOX HANDLE



(1)
B0064 LEFT
LOWER MAIN FRAME LEG



(1)
B0149 RIGHT
LOWER MAIN FRAME LEG



(1)
B0153
PTO ARM BRACE

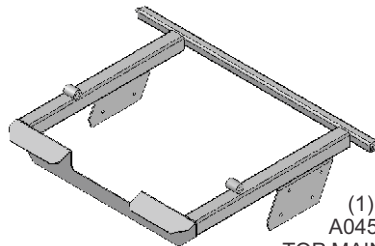

(1)
A0452
TOP MAIN FRAME
ASSEMBLY

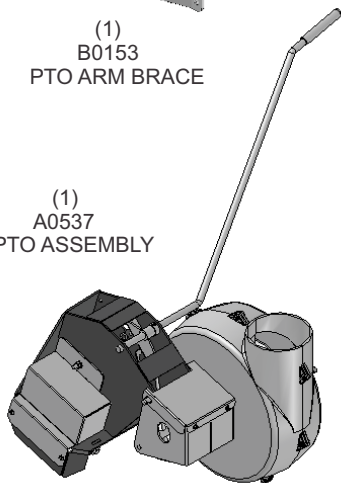

(1)
A0537
PTO ASSEMBLY

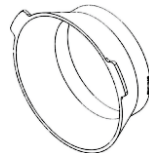

(1)
E6009
8" BLOWER
CONE

A0568 - 48" BOOT KIT



(1)
HB0210
HARDWARE BAG

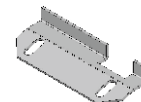

(1)
B0001
BOOT PLATE

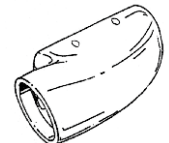

(1)
E1039
BOOT

A0508-UNIVERSAL WEIGHT KIT

(2)
B0026
WEIGHT
BRACKETS



(1)
HB0183
HARDWARE
BAG

(1)
B2220
WEIGHT BAR

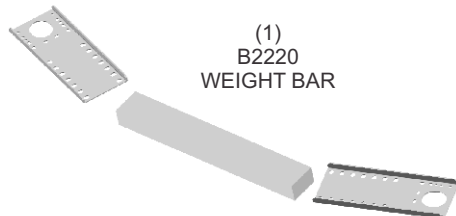

A0569 - 54" BOOT KIT



(1)
HB0210
HARDWARE BAG

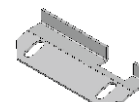

(1)
B0001
BOOT PLATE

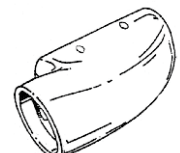

(1)
E1113
BOOT