

MODEL#: 06031509

MOWER NAME: JOHN DEERE

MOWER MODEL: Z900 SERIES

MOWER DECK SIZE: 54" 7-IRON

VAC NAME: 15 CUBIC FOOT PRO BAGGER

6.5 BRIGGS AND STRATTON VANGUARD

MANUAL: Q0404



FOR YEAR: 2009 - 2011

REVISED: 12/20/11

A1775 UNIT ASSEMBLY

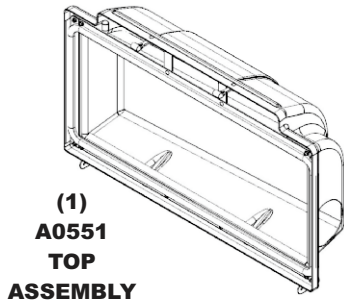

(1)
A0551
TOP
ASSEMBLY



(1)
V1054
6" PLASTIC
INLET



(1)
F0004
7" x 38"
LOWER
HOSE



(1)
F0001
6" x 30"
UPPER
HOSE



(4)
J1000
HOSE CLAMPS

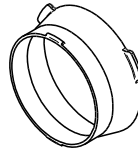

(1)
E6004
7" BLOWER
CONE

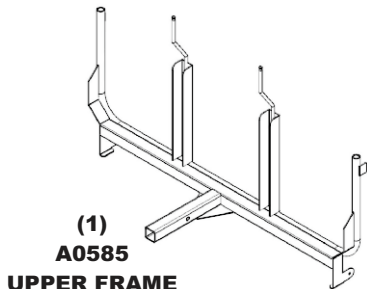

(1)
A0585
UPPER FRAME
ASSEMBLY

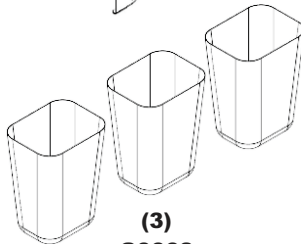

(3)
G0003
4 CU. FT.
COLLECTION
BAGS

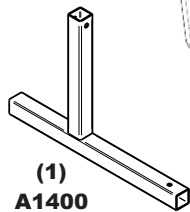

(1)
A1400
LWR. MNT.
TUBE ASSY.

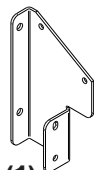

(1)
B0597
LT. LWR.
MAIN FRAME
LEG

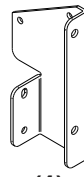

(1)
B0598
RT. LWR.
MAIN FRAME
LEG

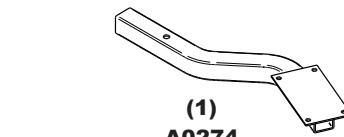

(1)
A0274
ENGINE MNT.
ARM ASSY.

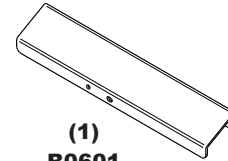

(1)
B0601
MNT. TUBE
SUPPORT BRKT.

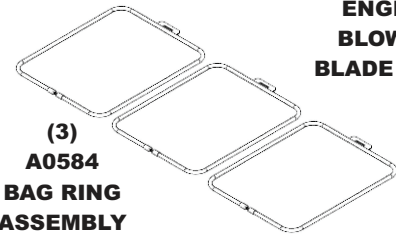

(3)
A0584
BAG RING
ASSEMBLY



(1)
HB0414
HARDWARE
BAG

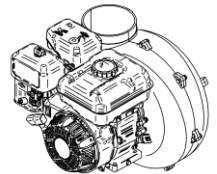

(1)
A639
ENGINE/
BLOWER/
BLADE ASSY.

A0620 THROTTLE KIT

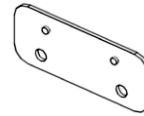

(1)
A0666
THROTTLE
MNT. PL.
ASSY.

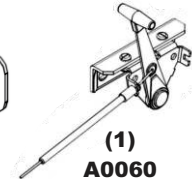

(1)
A0060
70" THROTTLE
KIT FOR
(5.5 & 6.5 HP)



(1)
HB0249
HARDWARE
BAG

A1768 - WEIGHT KIT



(1)
HB0413
HARDWARE
BAG

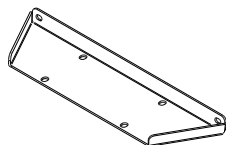

(1)
B0600
WEIGHT
BRACKET

(1)
B0035
WEIGHT

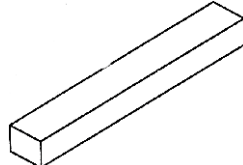

A1771 - 54" BOOT KIT



(1)
HB0412
HARDWARE
BAG

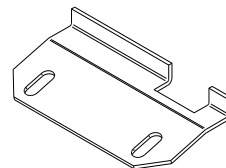

(1)
B0001
BOOT
PLATE

(1)
E1103
BOOT

