



# **PTO GRASS COLLECTION SYSTEM**

**DESIGNED FOR:**

**MODEL 48721201  
BAD BOY PUP SERIES MOWERS**



## **OPERATOR'S MANUAL**

**ASSEMBLY ● OPERATION ● MAINTENANCE**

# PTO GRASS COLLECTION SYSTEM

## TABLE OF CONTENTS

SECTION	PAGE	SECTION	PAGE
Safety - - - - -	2	2-11 Blower Cone Installation - - - - -	13
Safety Alert Symbols - - - - -	3	2-12 Impeller Blade Removal/Replacement - - - - -	13
Warranty - - - - -	4	2-13 Lengths Of Hose Adjustment - - - - -	14
I INTRODUCTION AND DESCRIPTION - - - - -	5	2-14 Upper Hose Installation - - - - -	14
1-1 Introduction - - - - -	5	2-15 Lower Hose To Blower Cone Installation - - - - -	14
1-2 Description - - - - -	5	2-16 Lower Hose To Boot Installation - - - - -	14
II INSTALLATION FOR USE - - - - -	5	III OPERATING INSTRUCTIONS - - - - -	15
2-1 Preparation Of Mower - - - - -	5,6	3-1 General Safety - - - - -	15
2-2 Left Lower Frame Leg Installation - - - - -	6	3-2 Operation & Tips On Mowing - - - - -	15
2-3 PTO Assembly Installation - - - - -	6	3-3 Disengagement Of The Blower - - - - -	15
2-4 Belt Installation - - - - -	6,7	3-4 Unloading The Collection System - - - - -	15
2-5 Cam Assembly Adjustment - - - - -	7	IV MAINTENANCE - - - - -	15
2-6 Top Main Frame Assembly Installation - - - - -	7	4-1 Maintenance Checklist - - - - -	15
2-7 Lift Handle To Aluminum Grass Container Installation - - - - -	7,12	4-2 Lubrication - - - - -	16
2-8 Aluminum Grass Container To Unit Installation - - - - -	12	V PARTS AND SERVICE - - - - -	16
2-9 Adjusting The Dump Mechanism - - - - -	12	5-1 Parts And Service Information - - - - -	16
2-10 Boot To Mower Deck Installation - - - - -	12,13	Safety Decals - - - - -	17
		Torque Specifications - - - - -	18

## Safety

1. Read the operator's manual carefully and familiarize yourself with the proper use of your attachment. Do not allow anyone who is not acquainted with the Safety Instructions to use your attachment.
2. Know the controls and how to stop quickly. **READ THE OPERATOR'S MANUAL!**
3. Do not allow children to operate the vehicle. Do not allow adults to operate it without proper instruction.
4. Be especially watchful of children and pets darting into the area while operating.
5. Keep your eyes and mind on your unit while mowing or operating your attachment. Don't let others distract you.
6. Do not attempt to operate your unit or mower when not in the driver's seat.
7. Always stop unit when emptying the container.
8. Stop unit, shut off deck and attachment, set parking brake, shut off mower engine and remove spark plug wire before removing clogs or removing or replacing hose, boot, blower cone, or performing any maintenance.
9. Mow across the face of slopes (not steeper than 10 degrees); never up and down the face of the slope.
10. It is recommended that the container be kept only half full when negotiating any slopes. Start mowing on slopes when the container is empty.
11. Inspect your lawn and remove any foreign objects before mowing. Never deliberately run the mower across any foreign object.
12. Wear ear protection if the noise level is offensive.
13. Wear eye protection to prevent debris from damaging your eyes.

# SAFETY

**WARNING!** **NEVER** operate the unit unless the discharge guard and either the deflector assembly or the vacuum collector adapter are fastened securely in place.

**WARNING!** Do not work around the mower deck boot or the blower area until you are certain that the mower blades and the blower impeller have stopped rotating.

**WARNING!** To avoid serious injury, perform maintenance on the vacuum collector; **ONLY AFTER STOPPING THE MOWER'S ENGINE AND WAITING FOR ALL MOVING PARTS TO COME TO A COMPLETE STOP.** Set the parking brake. Always remove the ignition key before beginning maintenance.

**WARNING!** For your own personal safety, **ALWAYS** mow **ACROSS** the face of slopes and **NEVER UP and DOWN** the face. **NEVER** attempt to mow excessively steep slopes, and use caution when turning on any slope.

## Safety Alert Symbol



This Safety Alert Symbol means: **“ATTENTION! BECOME ALERT! YOUR SAFETY IS INVOLVED!”**

This symbol is used to call attention to safety precautions that should be followed by the operator to avoid accidents. When you see this symbol, carefully read the message that follows and heed its advice. Failure to comply with safety precautions could result in death or serious bodily injury.

## Safety Signs

The signal words **DANGER**, **WARNING**, and **CAUTION** are used on the equipment safety signs. These words are intended to alert the viewer to the existence and the degree of hazard seriousness.



White letters on **RED**

This signal word indicates a potentially hazardous situation which, if not avoided, will result in death or serious injury.



Black letters on **ORANGE**

This signal word indicates a potentially hazardous situation which, if not avoided, could result in death or serious injury.

It may also be used to alert against unsafe practices.



Black letters on **YELLOW**

This signal word indicates a potentially hazardous situation exist which, if not avoided, will result in minor or moderate injury.

It may also be used to alert against unsafe practices.

# PECO LIMITED WARRANTY FOR NEW PRODUCTS

## A. WHAT IS WARRANTED?

PECO extends the following warranties to the original purchaser of each new PECO consumer product subject to the following limitations:

**1. PRODUCT WARRANTY:** Any part of any consumer product, which is defective in material or workmanship as delivered to the purchaser will be repaired or replaced, as PECO elects, without charge for parts or labor, if the defect appears within 12 months from the date of delivery of the product to the original purchaser. **ALL DEFECTIVE PARTS MUST BE RETURNED TO PECO FOR INSPECTION TO DETERMINE VALIDITY OF WARRANTY CLAIMS.** Freight and mailing will be borne by the customer.

**2. PARTS REPLACED DURING WARRANTY:** Any new PECO part which is furnished in performance of this warranty and is defective in material or workmanship as delivered to the purchaser will be repaired or replaced, as PECO elects, without charge if the defect appears within 90 days from the date of installation of such part or before the expiration of the original warranty period, whichever is later.

## B. SECURING WARRANTY ADJUSTMENTS.

Call PECO for Return Authorization. Damaged or broken parts, other than engines or batteries, must be returned to PECO Inc., 100 Airport Road, Arden, NC 28704 before any warranty adjustment can be authorized. At the time of requesting warranty adjustment, the purchaser must present evidence for date of delivery of the product. The purchaser shall pay any charge for the product to and from Arden, NC.

## C. ITEMS NOT COVERED BY PECO WARRANTY.

Engines and batteries attached to PECO products are covered under a separate warranty by the respective manufacturer.

## D. UNAPPROVED ALTERATION OR MODIFICATION.

All obligations of PECO Inc., under this warranty, shall be terminated if products are altered or modified in ways not approved by PECO Inc..

## E. ACCIDENTS AND NORMAL MAINTENANCE.

The warranty covers only defective material and workmanship. It does not cover depreciation or damage caused by normal wear, accident, improper use or abuse of products. The cost of normal maintenance and normal replacement of service items such as belts, cutting blades, hoses, etc., which are not defective shall be paid for by the purchaser.

## F. NO REPRESENTATIONS ADDITIONAL WARRANTIES, DISCLAIMER.

Neither PECO Inc. nor any company affiliated with it makes any warranties, representations or promises as to the quality of performance of its products other than those set forth herein. Except as described above, PECO Inc. makes no other warranties **AND SPECIFICALLY DISCLAIMS ANY AND ALL IMPLIED WARRANTIES OF FITNESS AND MERCHANTABILITY.**

## G. ANY MACHINE USED FOR RENTAL PURPOSES ARE GUARANTEED FOR 45 DAYS FROM DATE OF ORIGINAL SALE ONLY.

## H. REMEDIED EXCLUSIVE.

The only remedies the purchaser has in connection with the breach or performance of any warranty on PECO Inc. consumer products are set forth above. In no event will PECO be liable for special incidental or consequential damages.

## 1. NO SERVICE CENTER WARRANTY.

The selling Service Center makes no warranty on his own on any item warranted by PECO Inc. unless he delivers to purchaser a separate written warranty certificate specifically warranting the item. The dealer has no authority to make any representation or promise on behalf of PECO or to modify the terms of this warranty in any way.



# SECTION I

## INTRODUCTION AND DESCRIPTION

### 1-1 Introduction

We are pleased to have you as a Bad Boy customer. Your collection system has been designed to give you a low maintenance, simple, and effective way to collect the grass clippings from your mower. This manual is provided to give you the necessary instructions to properly mount and operate the collection system on your mower. Please read this manual thoroughly. Understand what each control is for and how to use it. Observe all safety decal precautions on the machine and noted throughout the manual.

**NOTE:** All references made to right, left, front, rear, top or bottom are as viewed from the normal operator's position on the mower.

### 1-2 Description

The collection system is designed for turf maintenance where there is a need to collect the grass clippings as the mower cuts the turf. It is also good for picking up leaves and twigs in pre-season and post-season clean-up.

The blower, mounted on the right side of the unit, uses a belt and gearbox system from the engine PTO shaft. Drive train protection comes through belt slippage. The blower draws grass clippings from the discharge area of the cutter deck up to the aluminum container mounted over the rear portion of the mower frame. The operator can engage the blower with a push of the over-center linkage on the right side of the unit. Once the container is full of clippings, the operator can easily push and raise the lift handle, releasing the container's rear door and the container will pivot towards the ground.

## Section II

### INSTALLATION FOR USE

#### 2-1 Preparation Of Mower

Carefully dismantle shipping crate from around the components. Cut retaining straps and separate the parts. The collection system will have various parts located inside. Remove and sort all parts for easy identification.

**NOTE:** Before each step of assembly it will help to study the exploded drawings on pages 8, 9, 10 and 11.

From the underside of the mower engine remove the bolt and bushing from the electric clutch assembly. Replace these parts with the engine pulley assembly P#(A0611), lock washer, and bolt. See the listing below for information on what hardware will need to be used and added for the various types of mower engine options:

**23HP, 32HP Vanguard & 26HP Briggs ELS** - Add (2) flat washers P#(K0131) between clutch and pump pulley, use (1) 7/16"-20 x 4" HHCS P#(K0359) and (1) 7/16" lock washer P#(K0053) to fasten engine pulley assembly.

**26HP Kawasaki** - Add (1) flat washer P#(K0131) between clutch and pump pulley (has 2 existing washers between clutch and pump pulley), use (1) M10-1.5 x 90MM HHCS P#(K0117) and (1) 7/16" lock washer P#(K0053) to fasten engine pulley assembly.

**27HP & 30HP Kohler** - Do not add washer (has 1 existing washer between clutch and pump pulley), use (1) 7/16"-20 x 4" HHCS P#(K0359) and (1) 7/16" lock washer P#(K0053) to fasten engine pulley assembly. The added pulley will power the collection system. Note that the center of the hub that is extended should be upward toward the engine (Figure 1). Torque the bolt to 55 ft./lbs.

**31HP Kawasaki** - Do not add washer (has 1 existing washer between clutch and pump pulley), use (1) 7/16"-20 x 3-3/4" HHCS P#(K0350) and (1) 7/16" helical spring lock washer P#(K0140) to fasten the engine pulley assembly number 13 P#(A0732).

The added pulley will power the collection system. Note that the center of the hub that is extended should be upward toward the engine (Figure 1). Torque the bolt to 55 ft./lbs.

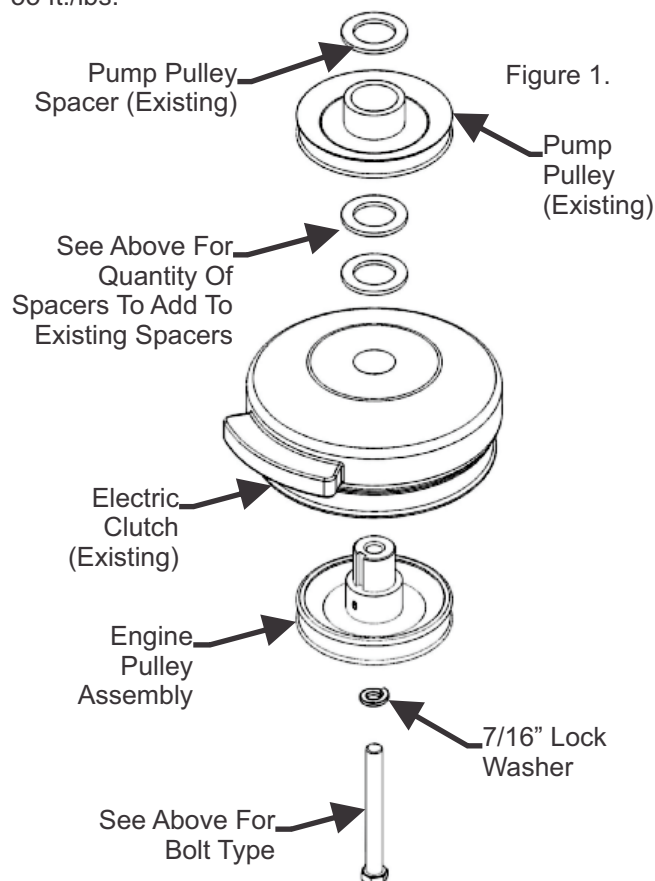

**NOTE:** Before continuing installation, you must install the Bad Boy Pup Series bolt-on hitch P#(093-1112-00) for the rear of the mower. Adding this hitch is required for mounting the collection system. Contact Bad Boy to purchase at (870) 698-0090.

## 2-2 Left Lower Frame Leg Installation

Remove the (2) existing bolts and nuts from the left side that fastens the mower's rear frame to the mower's chassis. Align the (2) lower holes on the left lower frame leg P#(B0182) (Figure 2) to the (2) lower holes on the mower's rear frame. Fasten by using (2) 5/16"-18 x 1-1/4" Grade 8 HHCS P#(K0118) and (2) 5/16"-18 flange nuts P#(K1178). Once the frame leg is fastened, drill a hole into the mower's rear frame by using the frame leg as a pilot and using a 5/16" drill bit. Fasten by using (1) 5/16"-18 x 1-1/4" Grade 8 HHCS P#(K0118) and (1) 5/16"-18 flange nut P#(K1178). Tighten all nuts and bolts.

Figure 2.

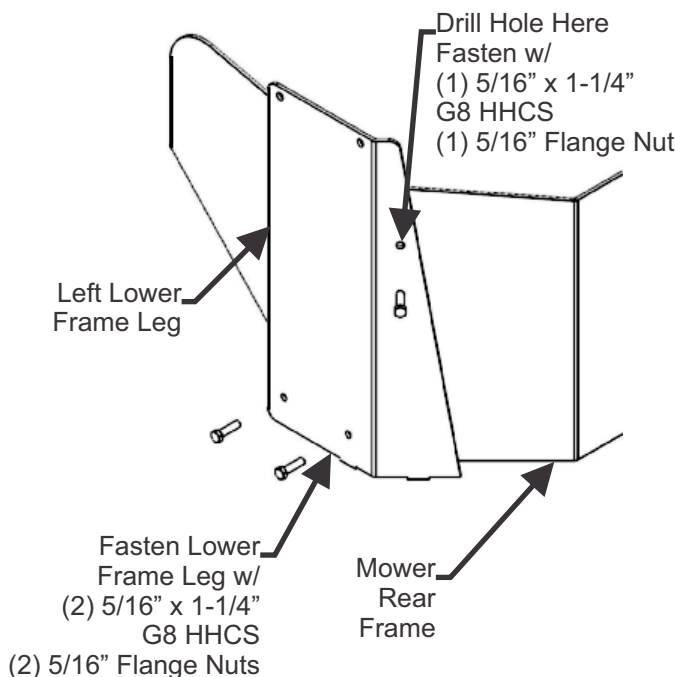

## 2-3 PTO Assembly Installation

Remove the (2) existing bolts and nuts from the right side that fastens the mower's rear frame to the mower's chassis. Align the (2) lower holes on the PTO assembly P#(A0610) (Figure 3) to the (2) lower holes on the mower's rear frame. Fasten by using (2) 5/16"-18 x 1-1/4" Grade 8 HHCS P#(K0118) and (2) 5/16"-18 flange nuts P#(K1178). Once the PTO assembly is fastened, drill a hole into the mower's rear frame by using the PTO assembly as a pilot and using a 5/16" drill bit. Fasten by using (1) 5/16"-18 x 1-1/4" Grade 8 HHCS P#(K0118) and (1) 5/16"-18 flange nut P#(K1178). Tighten all nuts and bolts.

Figure 3.

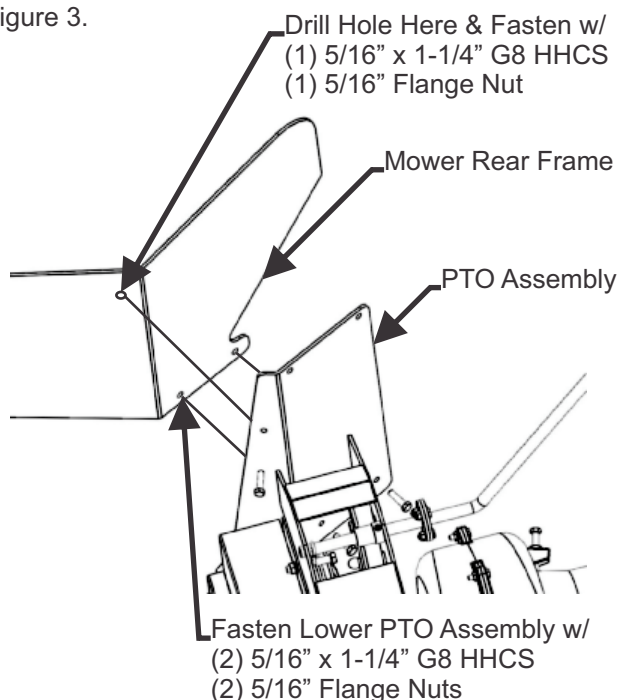

## 2-4 Belt Installation

Remove the pulley guard P#(B0075) by removing the (2) 1/4"-20 x 1/2" HHSTS P#(K0353), see page 10, diagram # 38 and #39 for part location. Loosen the (2) bolts that secure the gear box assembly P#(A0429) to the PTO mount plate (Figure 4). Loosen the adjustment bolt P#(K0348) until the gear box assembly is at the far left adjustment (the gear box is moved towards the mower's engine pulley). Connect the kevlar cord belt from the engine pulley to the lower gear box pulley (Figure 5).

To tension the drive belt, turn the adjustment bolt clockwise until there is 1" of deflection, with 10-11 lbs. of pressure between the engine pulley and the gear box pulley. Once the correct tension of the belt is achieved, tighten the (2) bolts that secure the gear box assembly.

Figure 4.

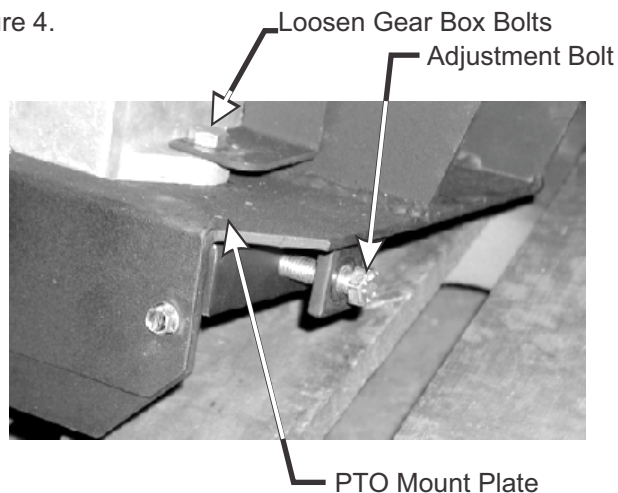
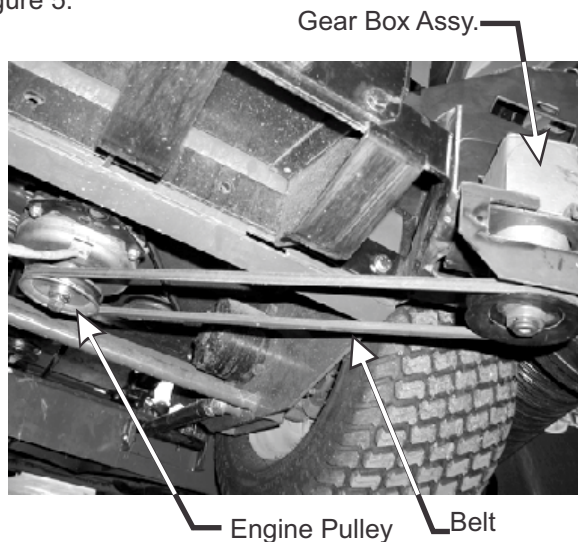

Figure 5.



## 2-5 Cam Assembly Adjustment

The cam assembly P#(A0422), which controls the blower belt tension, comes from the factory pre-adjusted. If the belt is too tight or becomes too loose, remove the hair pin clip P#(K0099) from the belt tension rod P#(K0326) and pull the "L" end of the rod out of its hole in the cam assembly. The tension rod may then be screwed out to tighten the belt or screwed in to loosen the belt. Replace the "L" end into the top hole in the cam and replace the hair pin clip. Adjust the cam stop bolt P#(K1159) to allow the cam to rotate slightly over center when the blower is disengaged (Figure 6).

Figure 6.

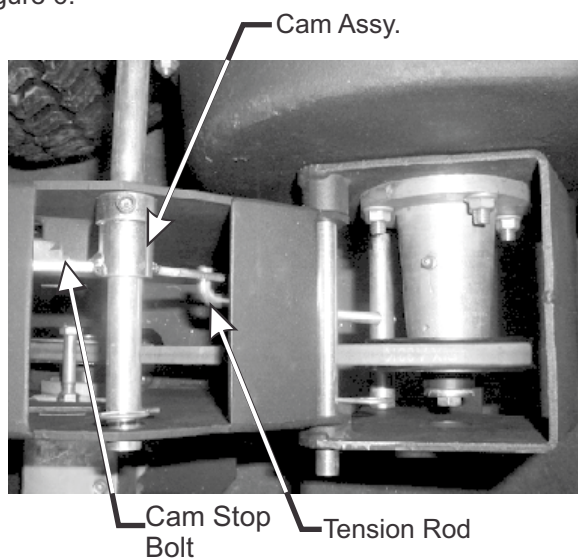

## 2-6 Top Main Frame Assembly Installation

Place the top main frame assembly P#(A0596) on top of the left lower main frame leg and the PTO assembly

(Figure 7 & 8). Align the holes to each side and fasten by using (2) 3/8"-16 x 3/4" HHCS P#(K1190) and (2) 3/8"-16 flange nuts P#(K1215) per side. Tighten all nuts and bolts.

Figure 7.

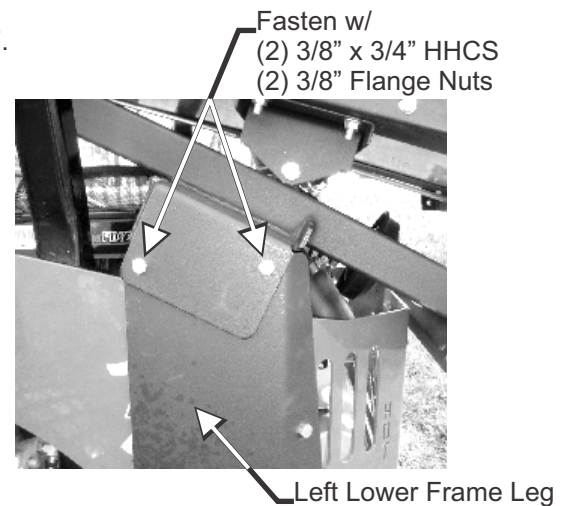
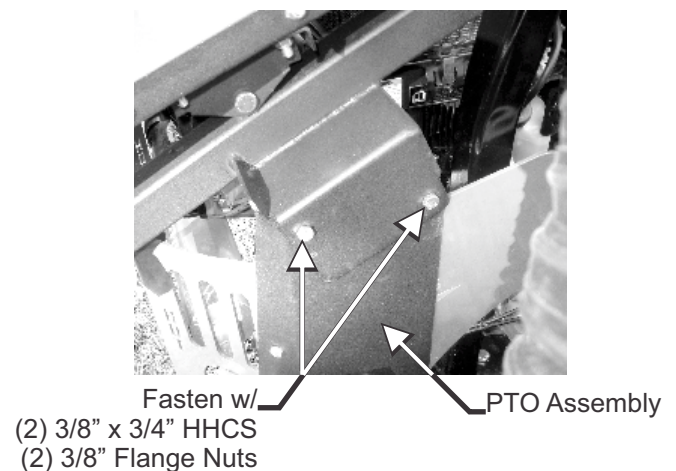

Figure 8.



## 2-7 Lift Handle To Aluminum Grass Container Installation

The various parts of the handle assembly P#(A0574) must be attached to the container frame. Figure 9 shows the orientation and location of the components. Slide the lift handle into the slot in the handle mount bracket P#(B1730) on the grass container. It may be necessary to remove the handle grip P#(J0522) to allow the handle to fit through the slot.

Before attaching the handle, hook one end of the spring P#(J0176) into the hole on the underside of the handle.

Continued on page 12.



Figure 9.  
Lift Handle Assy.

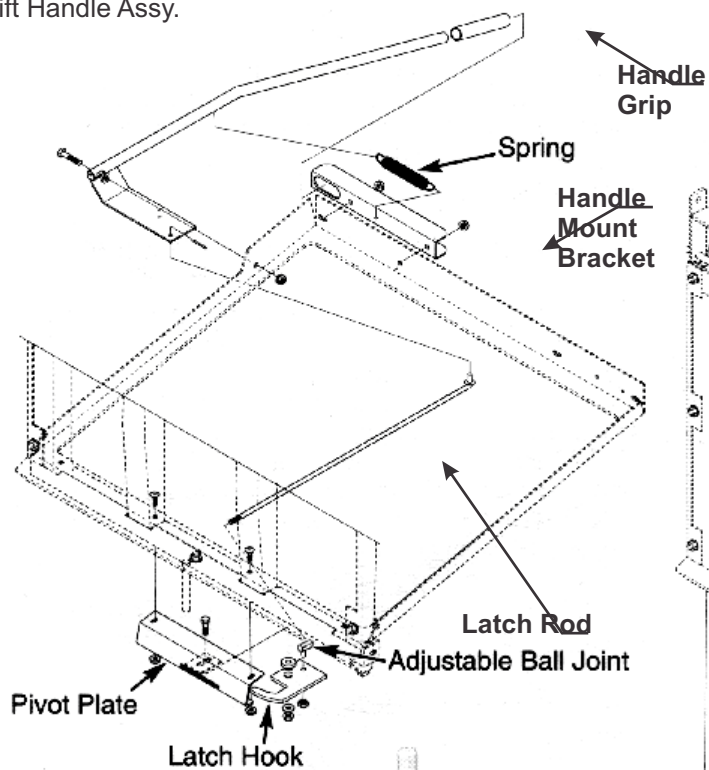

Figure 10.  
Aluminum Grass Container  
With Handle Attached

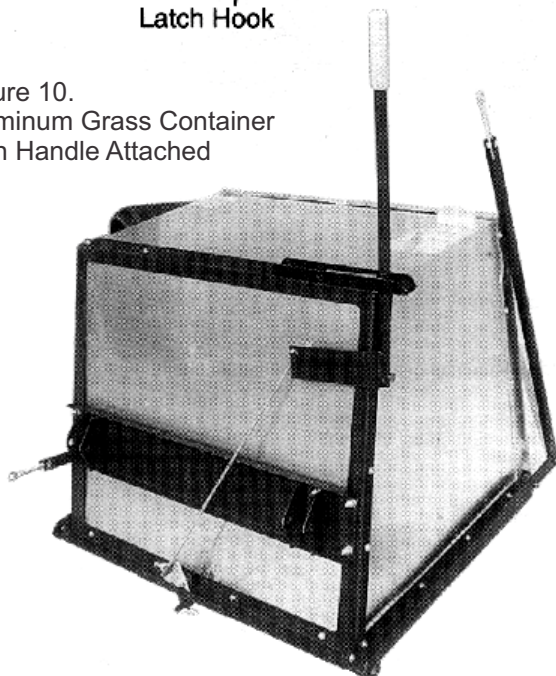
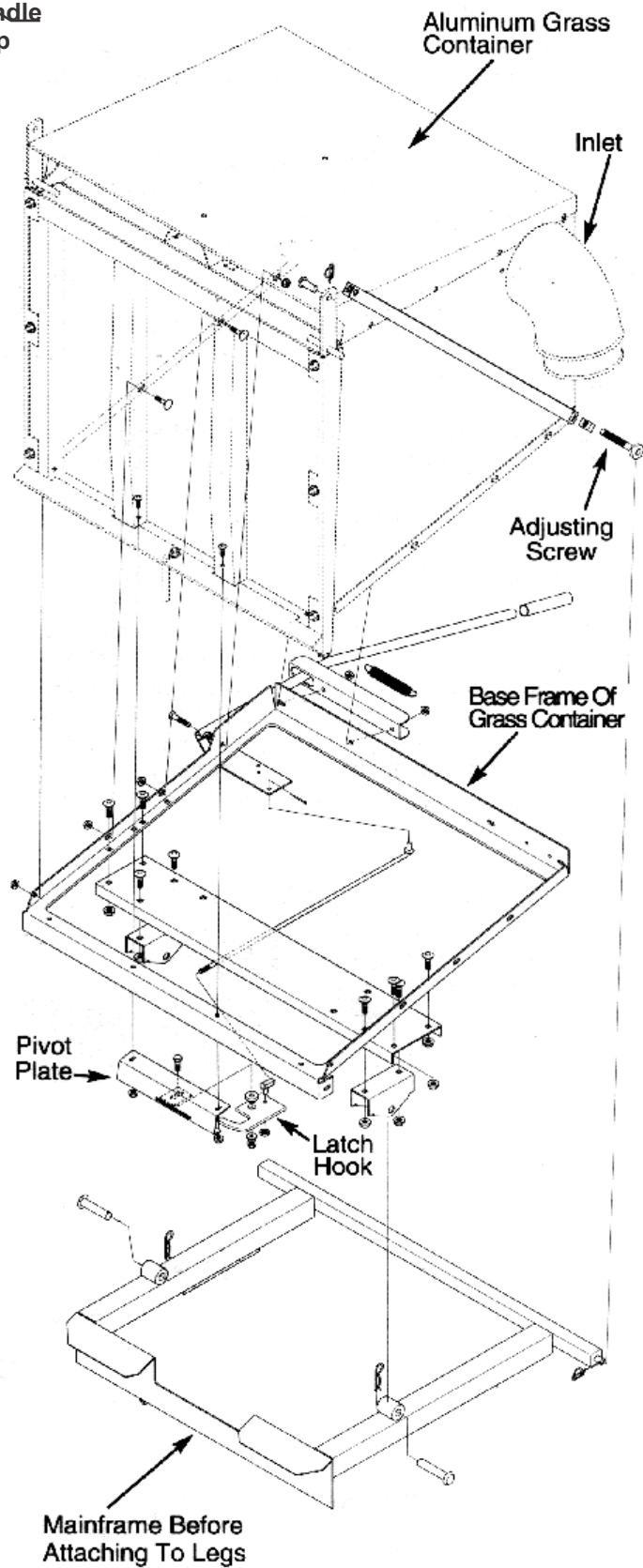

Figure 11.  
Latch Hook Mechanism Assembled

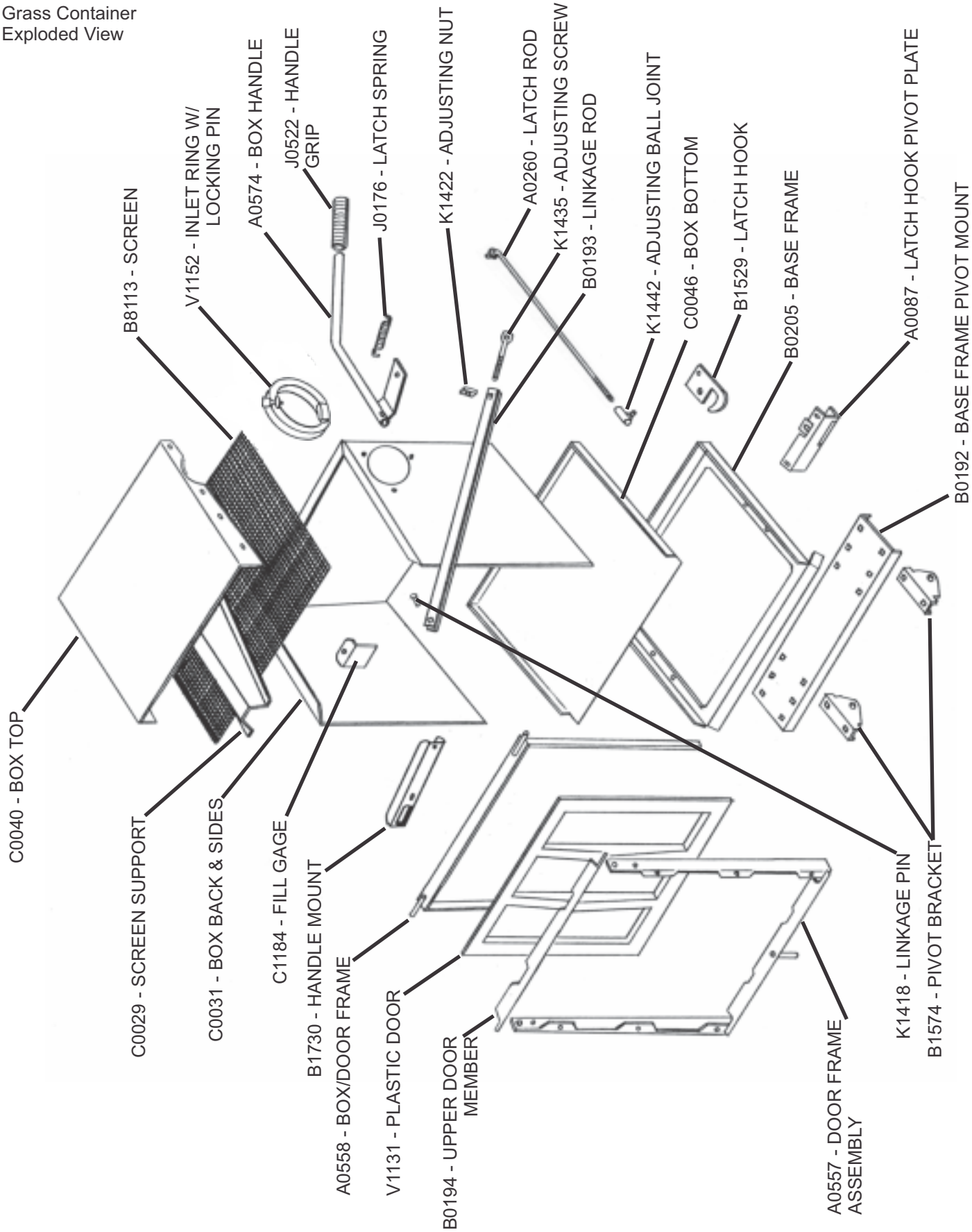

Figure 12. Aluminum Grass Container Assy.





Aluminum  
Grass Container  
Exploded View



# Exploded Parts View

Exploded View Of The  
A0610 - PTO Assembly

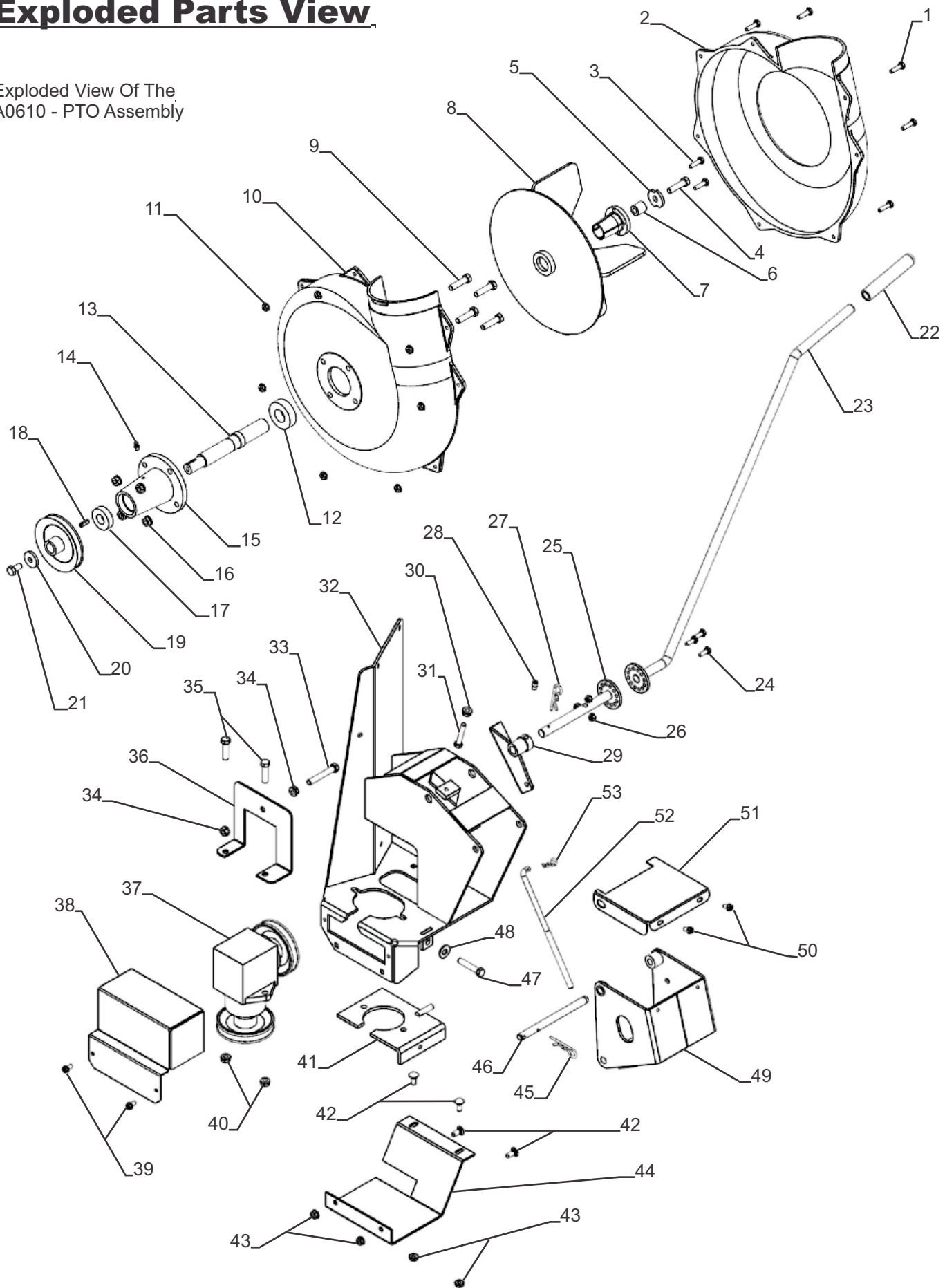

## Parts View

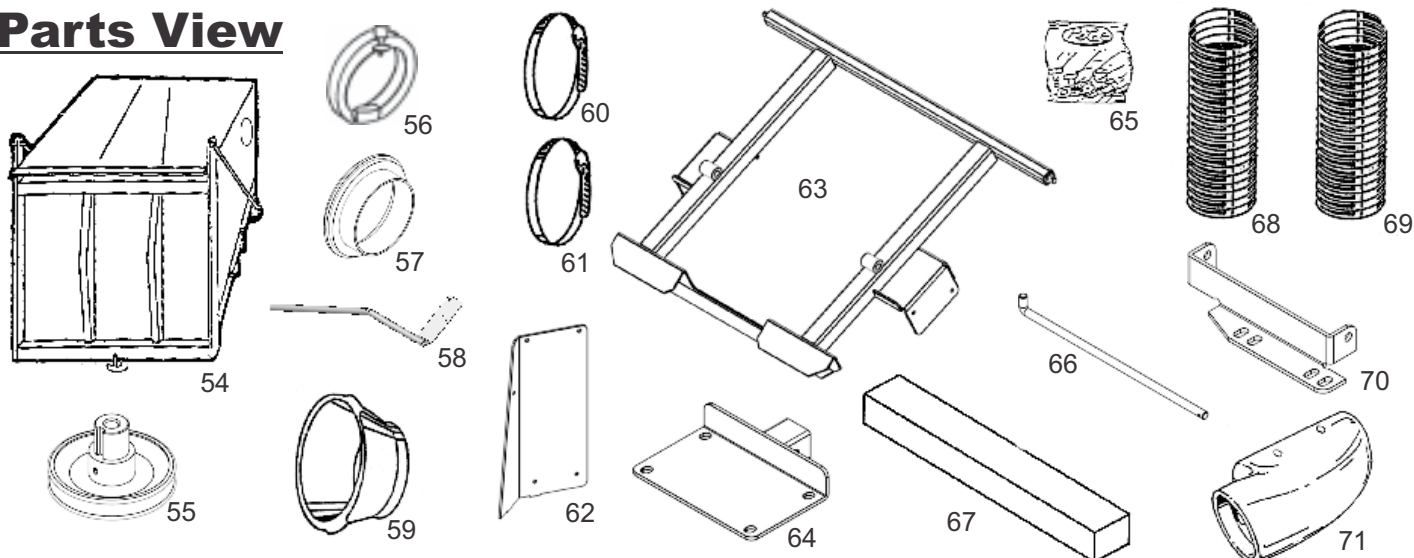

Item	Part No.	Qty.	Description
1	K1125	7	1/4"-20 x 1" HHCS
2	E4004F	1	BLOWER HOUSING FRONT
3	K1225	2	1/4"-20 x 1" HHCS G8
4	K1211	1	3/8"-16 x 1-1/2" HHCS G8
5	K0278	1	TAPER-LOCK WASHER
6	S3242	1	TAPER-LOCK SPACER
7	S4302	1	TAPER-LOCK BUSHING
8	A0914	1	4 BLADE IMPELLER ASSEMBLY
9	K1193	4	3/8"-16 x 1-1/2" HHCS
10	E4004B	1	BLOWER HOUSING BACK
11	K1126	7	1/4"-20 FLANGE NUT
12	N0147	1	LARGE BEARING
13	B1758	1	PTO SHAFT
14	J0801	1	ZIRC FITTING
15	E0121	1	PTO SHAFT HOUSING
16	K1215	4	3/8"-16 FLANGE NUT
17	N0148	1	SMALL BEARING
18	J0254	1	3/16" SQ. x 3/4" LONG KEY-WAY
19	M0228	1	BLOWER PULLEY
20	K1446	1	WASHER
21	K1190	1	3/8"-16 x 3/4" HHCS
22	V1151	1	BLACK HANDLE GRIP
23	A0603	1	PTO HANDLE ASSEMBLY
24	K1222	3	1/4"-20 x 3/4" HHCS
25	A0604	1	PTO HANDLE MOUNT ASSEMBLY
26	K1128	3	1/4"-20 NYLOC NUT
27	K0086	1	HAIR PIN CLIP
28	K0356	1	3/8"-16 SET SCREW
29	A0422	1	CAM BRACKET ASSEMBLY
30	K1178	1	5/16"-18 FLANGE NUT
31	K1159	1	5/16"-18 x 2" HHCS
32	A0593	1	PTO ARM ASSEMBLY
33	K1197	1	3/8"-16 x 2-1/2" HHCS
34	K1215	2	3/8"-16 FLANGE NUT
35	K1193	2	3/8"-16 x 1-1/2" HHCS
36	B0076	1	BELT GUIDE BRACKET
37	A0429	1	GEAR BOX ASSEMBLY
38	B0075	1	PULLEY GUARD

Item	Part No.	Qty.	Description
39	K0353	2	1/4"-20 x 1/2" HHSTS
40	K1215	2	3/8"-16 FLANGE NUT
41	A0436	1	BELT TENSION BRACKET ASSEMBLY
42	K1142	4	5/16"-18 x 3/4" CARRIAGE BOLT
43	K1178	4	5/16"-18 FLANGE NUT
44	B0162	1	SKID PLATE
45	K0086	1	HAIR PIN CLIP
46	B1755	1	BLOWER PIVOT ROD
47	K0348	1	3/8"-16 x 2" HHCS
48	K0075	1	3/8" FLAT WASHER
49	A0144	1	BLOWER MOUNT BRACKET ASSEMBLY
50	K0353	2	1/4"-20 x 1/2" HHSTS
51	B0121	1	BLOWER BELT GUARD
52	K0326	1	BELT TENSION ROD
53	K0130	1	HAIR PIN CLIP
54	A0560	1	12 CU. FT. BOX ASSEMBLY
55	A0611	1	ENGINE PULLEY ASSEMBLY
56	V1152	1	INLET RING
57	E0007	1	6" HOSE RING
58	A0574	1	BOX HANDLE
59	E6009	1	8" BLOWER CONE
60	J1000	2	2"-10" HOSE CLAMP
61	J1000	2	2"-10" HOSE CLAMP
62	B0182	1	LEFT LOWER MAIN FRAME LEG
63	A0596	1	TOP MAIN FRAME ASSEMBLY
64	A0597	1	WEIGHT BRACKET ASSEMBLY
65	HB0230	1	UNIT HARDWARE BAG
	HB0234	1	ENGINE PULLEY HARDWARE BAG
	HB0232	1	BOOT KIT HARDWARE BAG
	HB0375	1	WEIGHT KIT HARDWARE BAG
66	B0244	1	BOOT ROD
67	B2220	1	WEIGHT BAR
68	*****	1	6" x 50" UPPER HOSE
69	*****	1	8" x 34" LOWER HOSE
70	B0184	1	BOOT PLATE
71	E1113	1	BOOT



Hook the other end of the spring into the open hole in the handle mount bracket. Fasten the handle to the grass container frame by using (1) 3/8"-16 x 2" HHCS P#(K1208) and (2) 3/8"-16 flange nuts P#(K1215). At this point the handle can pivot back and forth in the slot of the handle mount bracket. With the handle in place, fasten the ball joint P#(K1442) to the end of the latch rod P#(A0260). Tighten to approximately half way down the threads of the latch rod. Slide the ball joint into the hole on the latch hook P#(B1529). Use (1) 5/16"-24 hex nut P#(K1444) and (1) 5/16" lock washer P#(K0043) to fasten the ball joint to the latch hook. Attach the opposite end of the latch rod into the handle. Fasten the rod to the handle by using (1) 3/32" x 3/4" cotter pin P#(K0094). Adjust the rod to allow the hook to close the box door completely.

Refer to pages 8, 9, 10 and 11 for exploded parts drawings and photographs of the complete assembly.

## 2-8 Aluminum Grass Container To Unit Installation

**NOTE:** IT IS RECOMMENDED THAT 3 PEOPLE ASSIST IN MOUNTING THE CONTAINER.

With three people available, two can lower the container onto the frame while the third person inserts the pivot pins P#(K0172) through the holes. Insert the pins from the outside to the inside. Secure with (1) 5/8" washer P#(K0058) and (1) 5/32" x 2-5/8" hair pin clip P#(K0088) per pivot pin. Reattach the bottom ends of the door linkage rods to the main frame by using (1) rue-ring cotter pin P#(K1437) per side. To test the functionality of the dump mechanism, pull the lift handle away from the unit and lift upward (Figure 9). The door of the container should open and the box should pivot towards the ground. Please ensure that no one is standing behind the door as the container is being dumped.

## 2-9 Adjusting The Dump Mechanism

The linkage rods may be adjusted in two places, at the adjusting screw P#(K1435) and the latch assembly items. See Figures 9 & 11 for visual clarification. To change the door closure tightness, screw the adjusting screw in or out. To adjust the latch, change the length of the latch rod by screwing the latch adjusting ball joint in or out. The latch hook pivot should be in the middle of the slot in the latch hook pivot plate. Slide the pivot back or forth and then re-tighten.

## 2-10 Boot To Mower Deck Installation

### 60" Boot Plate Mounting Instructions

To mount the boot plate P#(B0184) to the boot P#(E1113) use (2) 3/8"-16 x 1" carriage bolts P#(K1182) and (2) 3/8"-16 flange nuts P#(K1215). See Figure 14 for bolt placement.

### 48" & 52" Boot Plate Mounting Instructions

To mount the boot plate P#(B0184) to the boot P#(E1113) use (2) 3/8"-16 x 1" carriage bolts P#(K1182) and (2) 3/8"-16 flange nuts P#(K1215). See Figure 15 for bolt placement.

**NOTE:** When bolting the boot and boot plate together, the head of the bolt is placed from the inside of the boot. This will prevent grass from collecting on the bolts.

### For All Deck Sizes

Remove the bolts that hold the deflector shield in place so that the boot rod can fasten the boot and boot plate to the mower deck. Align the holes in the boot plate to the holes in the deflector shield mount and slide the boot rod P#(B0244) through and fasten by using (1) hair pin clip P#(K0099).

**NOTE:** The mower's deflector shield is removed in the following photo for clarity. Always have the deflector shield mounted when mowing.

Figure 14.

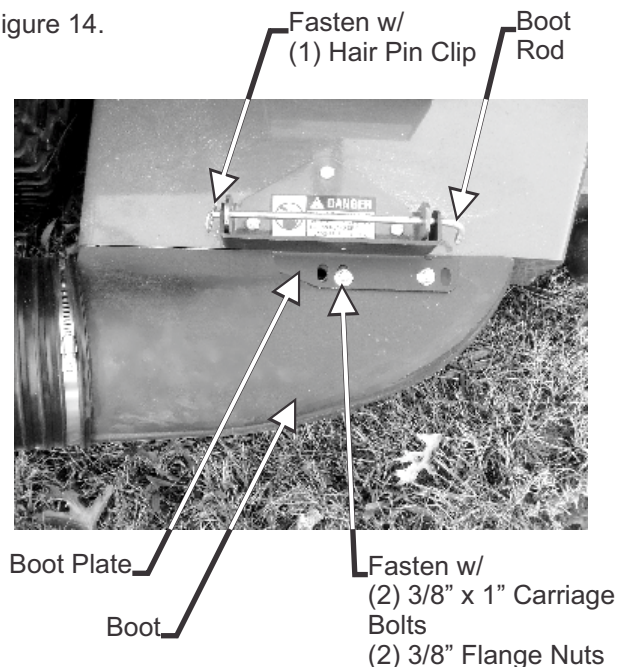
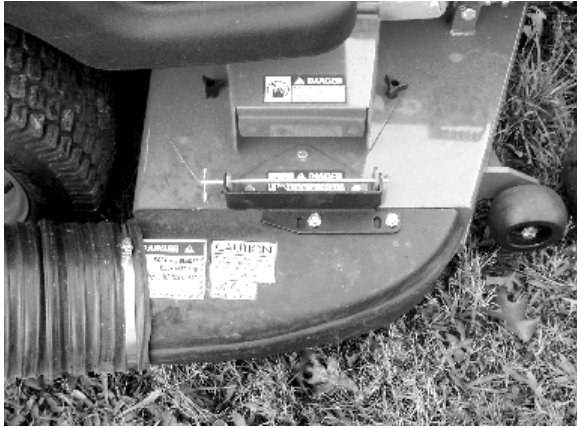

Figure 15.



lock bushing, forcing the blade to break-away from the taper-lock bushing. If the impeller will not move, hit the base of the impeller, between each vein, with a hammer, then try again.

To Replace: Place impeller blade over the engine shaft (Figure 18). Slide the taper-lock bushing into the engine shaft and into the impeller blade, aligning the non-threaded holes of the taper-lock bushing to the threaded holes of the impeller blade. Fasten by using (2) 1/4"-20 x 1" HHCS Grade 8 (torque to 15 ft. lbs), (1) spacer washer and (1) 3/8"-16 x 1" HHCS Grade 8 w/ washer.

## 2-11 Blower Cone Installation

Thread (1) 5/16"-18 jam nut P#(K0120) onto each end of (2) 5/16"-18 x 2-1/2" HHCS P#(K0125). Now partially thread the bolts into each of the two tabs located on the blower housing. Place blower cone so the two tabs line up with the bolts then tighten completely. See Figure 16.

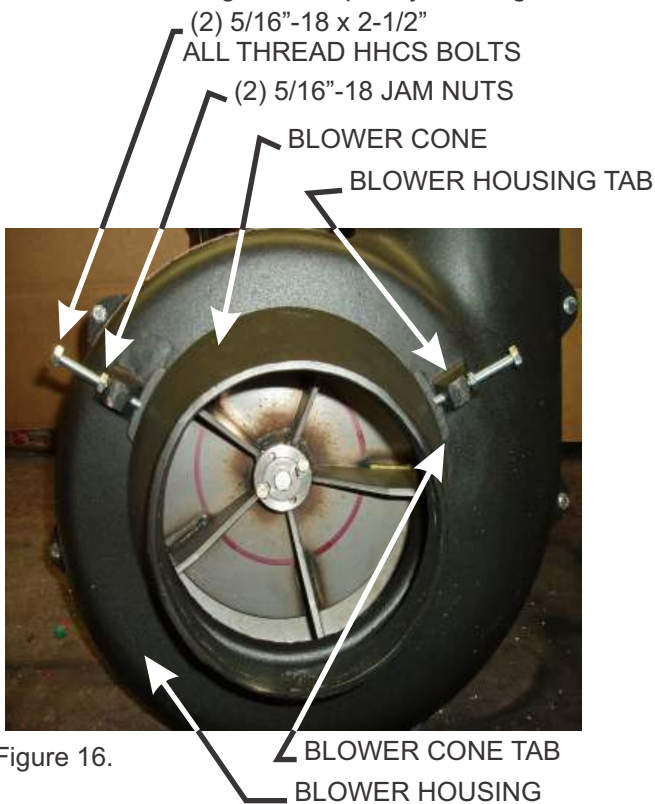

Figure 16.

Figure 17. Impeller Blade

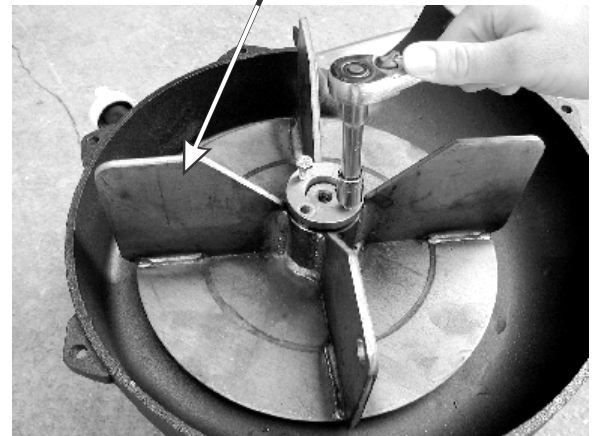

Figure 18.

Taper-Lock Bushing



## 2-12 Impeller Blade Removal/Replacement

To Remove: First remove the center 3/8" bolt and the (2) washers from the taper-lock bushing (Figure 17). Next remove the (2) 1/4" bolts and place them into the threaded holes (next to the holes they were removed from). Gradually thread each bolt evenly into the taper-



## 2-13 Lengths Of Hose Adjustment

The hoses in steps 2-14 and 2-15 must be cut to fit your machine. Follow steps 2-14 and 2-15. Do not cut the hoses until you have tried to fit them on your machine. Remember that the hoses have to be long enough to allow for enough clamping surface between the inlet, blower assembly, and the deck boot.

## 2-14 Upper Hose Installation

Slide (1) 5"-6" upper hose clamp P#(J6011) onto both ends of the 6" upper hose. Place (1) hose ring P#(E0007) into one end of the 6" hose making sure the hose is on at least 2", then tighten the hose clamp. Proceed to slide the opposite end of the 6" hose onto the blower assembly and tighten hose clamp. Place the hose ring onto the inlet ring and tighten the locking pin. See Figure 19 for details. Make sure both ends of the hose are clearly attached to the inlet and the blower assembly outlet.

Figure 19.

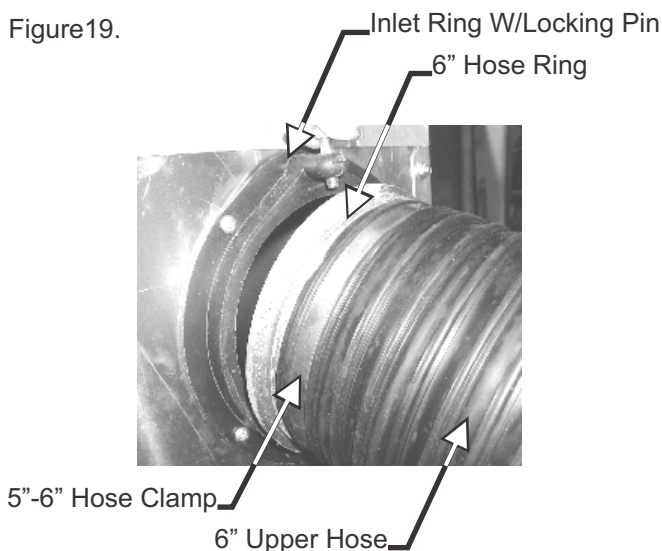
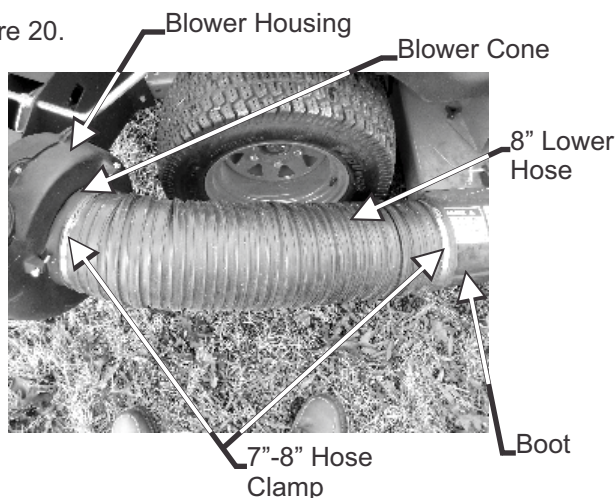

Figure 20.



## 2-15 Lower Hose To Blower Cone Installation

Slide a 7"-8" hose clamp P#(J6006) over both ends of the lower hose. Then proceed to slide the lower hose onto the blower cone. Tighten the hose clamp. The assembly should look like Figure 20.

## 2-16 Lower Hose To Boot Installation

Take the unattached end of the lower hose and slide it over the circular end of the boot. Use the lower hose clamp to secure the hose to the boot (Figure 20). Tip: Before securing clamp rotate hose counter-clockwise (away from yourself) approximately 1" to add in retaining boot to mower deck.

## 2-17 Front Weight Installation

Slide the weight bracket assembly P#(A0597) into the mower's front receiver hitch (Figure 21). Fasten by using (1) 5/8" x 3" clevis pin P#(K0172) and (1) 5/32" x 2-5/8" hair pin clip P#(K0088). When installing the weight bar (Figure 22) P#(B2220), you should have another person help position the weight centered onto the weight bracket assembly. Fasten the weight by using (2) 1/2"-13 U-bolts P#(K0331) and (4) 1/2"-13 flange nuts P#(K1246). Tighten all nuts and bolts.

Figure 21.

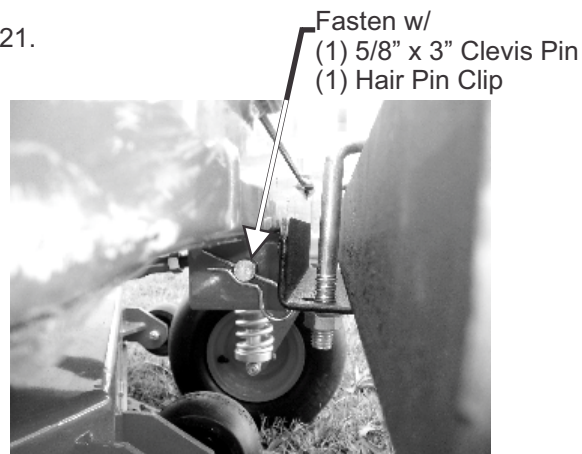
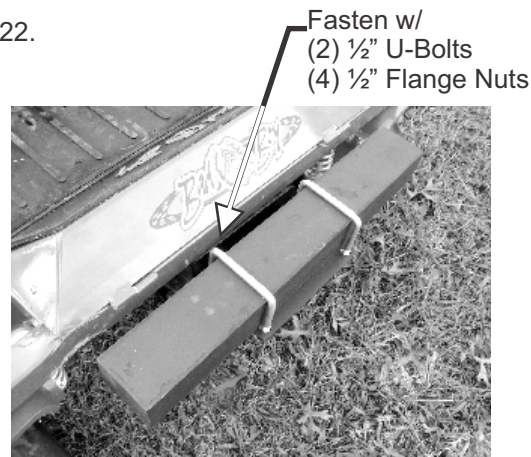

Figure 22.





## SECTION III

### OPERATING INSTRUCTIONS

#### 3-1 General Safety

Only qualified people familiar with this operator's manual and the mower's operator's manual should operate this machine.

#### 3-2 Operation And Tips On Mowing

- A. Perform BEFORE EACH USE the maintenance list in paragraph 4-1.
- B. Start mower.
- C. With the mower at high idle speed, engage the mower deck.
- D. While seated in the operator's seat, rotate the engagement handle of the collection system away from the mower. Continue to rotate the handle until it stops in an over center position. With the blower engaged, you can proceed to operate the control levers of the mower.

**NOTE:** If the collection system does not appear to be collecting the grass clippings; disengage the deck, and blower, engage the parking brake and turn the mower off. Proceed to section 3-3, and review the section 2-4 and 2-5, in this manual.

To obtain the maximum effectiveness from your collection system the tips listed below should be followed:

- \* Watch your speed- Normal conditions will allow a speed of up to approximately 5 mph, but thick, heavy damp conditions will require reduced ground speed.
- \* Mow with sharp blades- A sharp blade cuts cleaner.
- \* Wet grass and leaves will decrease effectiveness and will increase horsepower requirements.
- \* Mow at higher cutting heights- Remove and mulch no more than 2" of grass length with each mowing. (Experts recommend not cutting off more than 1/3 of the grass blade length at any given time.)
- \* Mow twice, at different height settings, (high, then low), if grass is extra tall.
- \* Remember that horsepower requirements will vary with the mowing conditions such as type and height of turf grass, moisture content, amount of leaves, whether the terrain is flat or hilly, etc.

#### 3-3 Disengagement Of The Blower

- A. To disengage the blower, rotate the engagement handle towards the mower.

**WARNING:** The blower will continue to spin. DO NOT TOUCH the blower, pulleys, or the belt until the tractor is turned off. DO NOT adjust the belt tension until the mower is turned off. Refer to section 2-4 and 2-5 of the manual

#### 3-4 Unloading The Collection System

**NOTE:** Press the tab, located behind the operator's left side, downward to feel if the collection system is full. If the container is full there will be resistance when depressing the tab.

- A. Stop the forward movement of the mower.
- B. Disengage the mower deck.
- C. Disengage the blower.
- D. Verify that the dump area is clear.
- E. Push the dump handle, on the left of the operator, away from the unit. While holding the handle pushed away, move the handle upward. The container door will swing upward and the container will rotate downward. The container will release its contents.
- F. Once the contents of the container have fallen out, the container is ready to move back into its normal operating position. With the handle in the 'away' position, pull the handle downward until it stops. Move the handle towards the center of the mower. This motion will allow the latch to lock back into collection position.

**NOTE:** If you do not hold the handle away from the mower as you pull the handle downward, the latch will not lock and the container can unexpectedly release the contents collected.

## SECTION IV MAINTENANCE

#### 4-1 Maintenance Checklist

Before each use:

1. Check blades and spindles to be sure that no foreign objects, such as wire or steel strapping bands, are wrapped around them.
2. Inspect blades for wear. Replace if necessary. If it is necessary to sharpen the blades, remove the blades from the spindles before sharpening. DO NOT sharpen blades while still attached to the mower.
3. Make sure all shields are in place and in good condition. Repair or replace any missing or damaged shields.
4. Perform lubrication per paragraph 4-2.
5. Listen for abnormal sounds, which might indicate loose parts, damaged bearings, or other damage. Correct any deficiency before continuing operation.
6. With the engine off, engage the blower assembly. Check the belt tension and inspect the pulley belt for cracks or tears.
7. Check for wear or deterioration of the upper or lower hoses. If there are any portions of the hose that have been torn or worn through, replace with genuine Bad Boy parts.

After Each Use:

1. Clean all debris from machine especially from the container, underneath the belt shields, and

- safety decals. Replace any missing or illegible decals.
2. Inspect the unit for worn or damaged components.  
Repair or replace before the next use. Any replacement component installed during repair shall include the component's current safety decal specified by the manufacturers to be affixed to the component.
  3. Check belt for proper tension.

## 4-2 Lubrication

**NOTE:** Use only white lithium based grease for lubrication of the shaft on the blower assembly.

1. On initial use: Grease the fitting on the blower shaft.
2. Every 25 hours of use: Re-grease the grease fitting.
3. Every 200 hours of use: Check oil levels in gear box.  
Oil in gear box should cover the gears. If not, fill using an EP90 weight oil. 6oz. will fill the gear box from empty.

# SECTION V PARTS AND SERVICE

## 5-1 Parts And Service Information

Bad Boy collection system owners should record the name and telephone number of their Service Center. Your Service Center will be happy to supply replacement parts, accessories, and do any service or repairs to your collection system. If for any reason your Service Center is unable to service your collection system or supply replacement parts, contact PECO and include the following information on the chart below.

THE SERIAL NUMBER PLATE IS LOCATED ON THE ALUMINUM BOX NEAR THE DUMP HANDLE

<b>PECO</b>	
<b>OUTDOOR POWER EQUIPMENT</b>	
<b>Model Number</b>	<input type="text"/>
<b>Serial Number</b>	<input type="text"/>
<b>Arden, North Carolina 28704</b>	

WRITE THE MODEL AND SERIAL NUMBER IN THE BOX ABOVE FOR FUTURE REFERENCE.

**Unit Model Number:** \_\_\_\_\_

**Unit Engine Size:** \_\_\_\_\_

**Unit Serial Number:** \_\_\_\_\_

**Date of purchase:** \_\_\_\_/\_\_\_\_/\_\_\_\_

**Dealer/Distributor Name:** \_\_\_\_\_

**Address:** \_\_\_\_\_ **State:** \_\_\_\_\_ **Zip:** \_\_\_\_\_

**Phone Number:** \_\_\_\_\_

**Address: PECO Inc.**  
**100 AIRPORT ROAD**  
**Arden, NC 28704**

**Phone #: (828) 684-1234 or Toll Free: (800) 438-5823**

**Email: [peco@lawnvac.com](mailto:peco@lawnvac.com)**

## SAFETY DECALS

To promote safe operation, Bad Boy supplies safety decals on all products manufactured. Damage can occur to safety decals either through shipment, use or reconditioning. Contact your local Service Center for replacement decals.



Part #: R1050

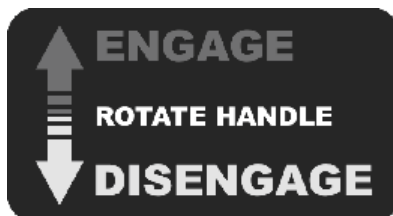

Part #: R1083

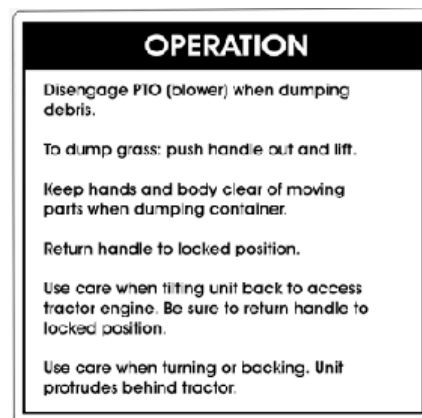

Part #: R1049



Part #: R1054



Part #: R1051



Part #: R1053



Part #: R1057



Part #: R4037



Part #: R1052

**TO DUMP GRASS: PUSH HANDLE OUT AND LIFT**

50031306

Part #: R1055



# TORQUE SPECIFICATIONS

Proper torque for American fasteners used on Bad Boy equipment.  
Recommended Torque in Foot Pounds (Newton Meters).\*

## AMERICAN Bolt Head Markings



SAE Grade 2  
(No Dashes)

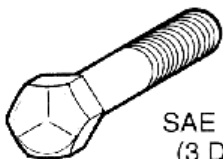

SAE Grade 5  
(3 Dashes)

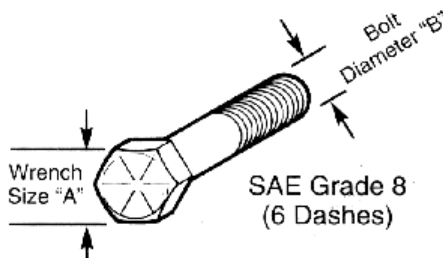

SAE Grade 8  
(6 Dashes)

WRENCH SIZE (IN.) "A"	BOLT DIAMETER (IN.) "B" AND THREAD SIZE	SAE GRADE 2	SAE GRADE 5	SAE GRADE 8
7/16	1/4 - 20 UNC	6 (7)	8 (11)	12 (16)
7/16	1/4 - 28 UNF	6 (8)	10 (13)	14 (18)
1/2	5/16 - 18 UNC	11 (15)	17 (23)	25 (33)
1/2	5/16 - 24 UNF	13 (17)	19 (26)	27 (37)
9/16	3/8 - 16 UNC	20 (27)	31 (42)	44 (60)
9/16	3/8 - 24 UNF	23 (31)	35 (47)	49 (66)
5/8	7/16 - 14 UNC	32 (43)	49 (66)	70 (95)
5/8	7/16 - 20 UNF	36 (49)	55 (75)	78 (106)
3/4	1/2 - 13 UNC	49 (66)	76 (103)	106 (144)
3/4	1/2 - 20 UNF	55 (75)	85 (115)	120 (163)
7/8	9/16 - 12 UNC	70 (95)	109 (148)	153 (207)
7/8	9/16 - 18 UNF	79 (107)	122 (165)	172 (233)
15/16	5/8 - 11 UNC	97 (131)	150 (203)	212 (287)
15/16	5/8 - 18 UNF	110 (149)	170 (230)	240 (325)
1-1/8	3/4 - 10 UNC	144 (195)	266 (360)	376 (509)
1-1/8	3/4 - 16 UNF	192 (260)	297 (402)	420 (569)
1-5/16	7/8 - 9 UNC	166 (225)	430 (583)	606 (821)
1-5/16	7/8 - 14 UNF	184 (249)	474 (642)	668 (905)
1-1/2	1 - 8 UNC	250 (339)	644 (873)	909 (1232)
1-1/2	1 - 12 UNF	274 (371)	705 (955)	995 (1348)
1-1/2	1 - 14 UNF	280 (379)	721 (977)	1019 (1381)
1-11/16	1-1/8 - 7 UNC	354 (480)	795 (1077)	1288 (1745)
1-11/16	1-1/8 - 12 UNF	397 (538)	890 (1206)	1444 (1957)
1-7/8	1-1/4 - 7 UNC	500 (678)	1120 (1518)	1817 (2462)
1-7/8	1-1/4 - 12 UNF	553 (749)	1241 (1682)	2013 (2728)
2-1/16	1-3/8 - 6 UNC	655 (887)	1470 (1992)	2382 (3228)
2-1/16	1-3/8 - 12 UNF	746 (1011)	1672 (2266)	2712 (3675)
2-1/4	1-1/2 - 6 UNC	870 (1179)	1950 (2642)	3161 (4283)
2-1/4	1-1/2 - 12 UNF	979 (1327)	2194 (2973)	3557 (4820)

## METRIC

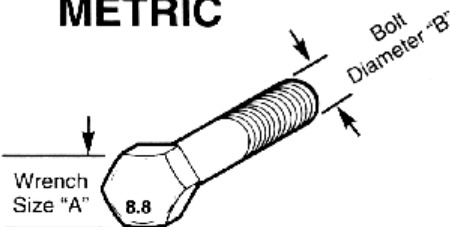

Numbers appearing on bolt heads  
indicate ASTM class.

Proper torque for metric fasteners used on Peco equipment.  
Recommended torque in foot pounds (newton Meters).\*

WRENCH SIZE (mm) "A"	BOLT DIA. (mm) "B"	ASTM 4.6	ASTM 8.8	ASTM 9.8	ASTM 10.9
8	5	1.8 (2.4)		5.1 (6.9)	6.5 (8.8)
10	6	3 (4)		8.7 (12)	11.1 (15)
13	8	7.3 (10)		21.1 (29)	27 (37)
16	10	14.5 (20)		42 (57)	53 (72)
18	12	25 (34)	74 (100)	73 (99)	93 (126)
21	14	40 (54)	118 (160)	116 (157)	148 (201)
24	16	62 (84)	167 (226)	181 (245)	230 (312)
30	20	122 (165)	325 (440)		449 (608)
33	22		443 (600)		611 (828)
36	24	211 (286)	563 (763)		778 (1054)
41	27		821 (1112)		1138 (1542)
46	30	418 (566)	1119 (1516)		1547 (2096)

\*Use 75% of the specified torque value for plated  
fasteners. Use 85% of the specified torque  
values for lubricated fasteners.

## NOTES

**Turn any Bad Boy Lawn Vac into a  
total lawn grooming tool with the Bad  
Boy Wand Kit!**

With your Bad Boy Wand Attachment you will double the ability of your Bad Boy Lawn Vac. Using the same powerful vacuum/blower that makes your Lawn Vac work so well, you will be able to get to all those hard-to-reach places where you needed a rake or broom before.

**Contact Bad Boy Today!**

