



# COMMERCIAL PTO - GRASS COLLECTION SYSTEM

Model# 49621204

COUNTRY  
**CLIPPER**  
ZERO TURN MOWER

**Charger**  
52 & 60" DECKS  
MODEL YEAR:  
**2013-2018**



## OPERATOR'S MANUAL

ASSEMBLY • OPERATION • MAINTENANCE

# GRASS COLLECTION SYSTEM

## TABLE OF CONTENTS

SECTION	PAGE	SECTION	PAGE
Safety .....	2	Length Of Hose Adjustment .....	18
Safety Alert Symbols .....	3	Upper Hose Installation .....	18
Warranty .....	4	Lower Hose To Blower Cone Installation .....	18
I INTRODUCTION AND DESCRIPTION .....	5	Lower Hose To Boot Installation .....	18
Introduction .....	5	Impeller Blade Removal And Replacement .....	19
Description .....	5	Weight Kit Installation/ Left Caster .....	20
II INSTALLATION FOR USE .....	5	Weight Kit Installation/ Right Caster .....	21
Preparation Of Mower .....	5	Exploded Views and Parts List .....	22-27
Right Frame Bracket Installation .....	6	Overall Parts List .....	28
Left Lower Main Frame Leg Installation .....	7-8	III OPERATING INSTRUCTIONS .....	29
Right Lower Main Frame Leg Installation .....	9	General Safety .....	29
PTO Stop Plate Installation .....	10	Operation & Tips On Mowing .....	29
PTO Assembly & Handle Installation .....	11	Disengagement Of The Blower .....	29
Belt Installation & Adjustment .....	12	Unloading The Collection System .....	29
Cam Assembly Adjustment .....	13	IV MAINTENANCE .....	29
Blower Cone Installation .....	13	Maintenance Checklist .....	29-30
Main Frame Assembly Installation .....	14	Lubrication .....	30
Lift Handle Installation .....	15	V PARTS AND SERVICE .....	30
Aluminum Box Assembly Installation .....	16	Parts And Service Information .....	30
Dump Mechanism Adjustment .....	16	Safety Decals .....	31
Boot Plate Installation .....	17	Torque Specifications .....	32

## SAFETY

1. Read the operator's manual carefully and familiarize yourself with the proper use of your attachment. Do not allow anyone who is not acquainted with the Safety Instructions to use your attachment.
2. Know the controls and how to stop them quickly. **READ THE OPERATOR'S MANUAL!**
3. Do not allow children to operate the machine. Do not allow adults to operate it without proper instruction.
4. Be especially watchful of children and pets entering into the area while operating.
5. Keep your eyes and mind on your machine while mowing or operating your attachment. Don't let others distract you.
6. Do not attempt to operate your machine when not in the driver's seat.
7. Always shut off blades and engine when emptying the container.
8. Stop machine, shut off deck attachment, set parking brake, shut off engine and remove ignition key before removing clogs, removing or replacing hose, boot, blower cone, or performing any maintenance.
9. Mow across the face of slopes (not more than 10 degrees); never up and down the face.
10. It is recommended that the container be emptied when half full while operating on slopes. Start mowing on slopes when the container is empty.
11. Inspect your lawn and remove any foreign objects before mowing. Never deliberately run the mower across any foreign object.
12. Wear hearing protection.
13. Wear eye protection to prevent debris from getting into your eyes.

# SAFETY

**WARNING!** **NEVER** operate the mower unless the discharge guard and either the deflector assembly or the vacuum collector adapter are fastened securely in place.

**WARNING!** Do not work around the mower deck boot or the blower area until you are certain that the mower blades and the blower impeller have stopped rotating.

**WARNING!** To avoid serious injury, perform maintenance on the vacuum collector; **ONLY AFTER STOPPING THE MOWER'S ENGINE AND WAITING FOR ALL MOVING PARTS TO COME TO A COMPLETE STOP.** Set the parking brake. Always remove the ignition key before beginning maintenance.

**WARNING!** For your own personal safety, **ALWAYS** mow **ACROSS** the face of slopes and **NEVER UP** and **DOWN** the face. **NEVER** attempt to mow excessively steep slopes, and use caution when turning on any slope.

## Safety Alert Symbol



This Safety Alert Symbol means: **“ATTENTION! BECOME ALERT! YOUR SAFETY IS INVOLVED!”**

This symbol is used to call attention to safety precautions that should be followed by the operator to avoid accidents. When you see this symbol, carefully read the message that follows and heed its advice. Failure to comply with safety precautions could result in death or serious bodily injury.

## Safety Signs

The signal words **DANGER**, **WARNING**, and **CAUTION** are used on the equipment safety signs. These words are intended to alert the viewer to the existence and the degree of hazard seriousness.



White letters on **RED**

This signal word indicates a potentially hazardous situation which, if not avoided, will result in death or serious injury.



Black letters on **ORANGE**

This signal word indicates a potentially hazardous situation which, if not avoided, could result in death or serious injury.

It may also be used to alert against unsafe practices.



Black letters on **YELLOW**

This signal word indicates a potentially hazardous situation which, if not avoided, will result in minor or moderate injury.

It may also be used to alert against unsafe practices.



# PECO LIMITED WARRANTY FOR NEW PRODUCTS

## A. WHAT IS UNDER WARRANTY?

PECO extends the following warranties to the original purchaser of each new PECO consumer product subject to the following limitations.

**1. PRODUCT WARRANTY:** Any part of any consumer product, which is defective in material or workmanship as delivered to the purchaser will be repaired or replaced, as PECO elects, without charge for parts or labor, if the defect appears within 12 months from the date of delivery of the product to the original purchaser. ALL DEFECTIVE PARTS MUST BE RETURNED TO PECO FOR INSPECTION TO DETERMINE VALIDITY OF WARRANTY CLAIMS. Freight and mailing will be borne by the customer.

**2. PARTS REPLACED DURING WARRANTY:** Any new PECO part which is furnished in performance of this warranty and is defective in material or workmanship as delivered to the purchaser will be repaired or replaced, before the expiration of the original warranty period, whichever is later.

**3. COMMERCIAL USE:** Products put to personal use around a single household or residence is considered 'Residential'; Products put to any business use (agricultural, commercial, or industrial) or used at multiple locations is considered 'Commercial.' Products designated as 'Commercial' are warrantied for 12 months from the date of delivery of the product to the original purchaser when used for in commercial applications. Products designated as 'Residential' are warrantied for 90 days from the date of delivery of the product to the original purchaser when in commercial applications.

## B. SECURING WARRANTY ADJUSTMENTS

Call PECO for Return Authorization. Damaged or broken parts other than engines or batteries, must be returned to New PECO, Inc. at 10 Walden Drive, Arden, NC 28704 before any warranty adjustment can be authorized. At the time of requesting warranty adjustment, the purchaser must present evidence of the date of delivery of the product. The purchaser shall pay any charge for the product to and from Arden, NC.

## C. ITEMS NOT COVERED BY PECO WARRANTY

Engines and batteries attached to PECO products are covered under a separate warranty by the respective manufacturer.

## D. UNAPPROVED ALTERATION OR MODIFICATION

All obligations of New PECO, Inc. under this warranty shall be terminated if products are altered or modified in ways not approved by New PECO, Inc.

## E. ACCIDENTS AND NORMAL MAINTENANCE

The warranty covers only defective material and workmanship. It does not cover depreciation or damage caused by normal wear, accident, improper use or abuse of products. The cost of normal maintenance and normal replacement of service items such as belts, cutting blades, hoses, etc., which are not defective shall be paid for by the purchaser.

## F. NO REPRESENTATIONS ADDITIONAL WARRANTIES, DISCLAIMER

Neither New PECO, Inc. nor any company affiliated with it makes any warranties, representations or promises as to the quality of performance of its products other than those set forth herein. Except as described above, New PECO, Inc. makes no other warranties AND SPECIFICALLY DISCLAIMS ANY AND ALL IMPLIED WARRANTIES OF FITNESS AND MERCHANTABILITY.

## G. PRODUCTS USED FOR RENTAL OR LEASE PURPOSES ARE WARRANTIED FOR 45 DAYS FROM DATE OF ORIGINAL SALE ONLY

## H. REMEDIED EXCLUSIVE

The only remedies the purchaser has in connection with the breach or performance of any warranty on New PECO, Inc. consumer products are set forth above. In no event will PECO be liable for special incidental or consequential damages.

### 1. NO SERVICE CENTER WARRANTY

The selling Service Center makes no warranty on his own on any item warranted by New PECO, Inc. unless he delivers to purchaser a separate written warranty certificate specifically warranting the item. The dealer has no authority to make any representation or promise on behalf of PECO or to modify the terms of this warranty in any way.



## SECTION I

### INTRODUCTION AND DESCRIPTION

#### Introduction

Your grass collection system has been designed to give you a low maintenance, simple, and effective way to collect the grass clippings from your mower. This manual is provided to give you the necessary instructions to properly mount and operate the collection system on your mower. Please read this manual thoroughly. Understand what each control is for and how to use it. Observe all safety decal precautions on the machine and noted throughout the manual.

**NOTE:** all references made to right, left, front, rear, top or bottom are as viewed from the normal operator's position on the mower.

#### Description

The grass collection system is designed for turf maintenance where there is a need to collect the grass clippings as the mower cuts the turf. It is also used for picking up leaves and in pre-season and post-season clean-up. The blower, mounted on the right side of the unit, uses a belt and gearbox system from the engine PTO shaft. Drive train protection comes through belt slippage. The blower draws grass clippings from the discharge area of the cutter deck back to the 12 cubic foot aluminum box at the rear portion of the mower frame. The operator can engage the blower with a push of the over-center linkage on the right side of the unit. Once the container is full, the operator can easily push and raise the dump handle, opening the rear door on the container and pivoting the box to the ground. Once empty, the operator can easily lower and pull the dump handle, pivoting the box back into position and closing the door.

Remove the D-drive spacer using an arbor press or equivalent. On removal, adjacent bearing OUTER race must be supported or bearing damage may occur. Refer to Figure 2-1b.

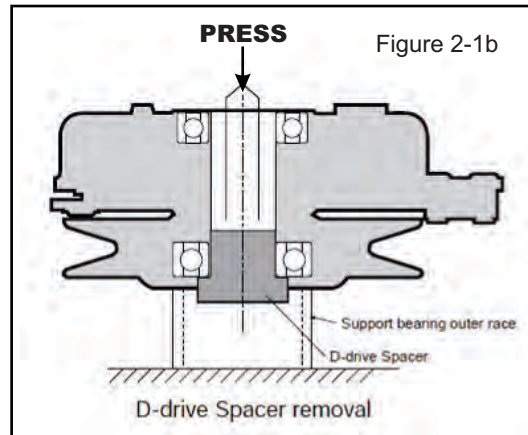

The engine pulley assembly must be installed using an arbor press or equivalent. Upon Installation, opposite bearing inner race must be supported or bearing damage may occur. Refer to Figure 2-1c.

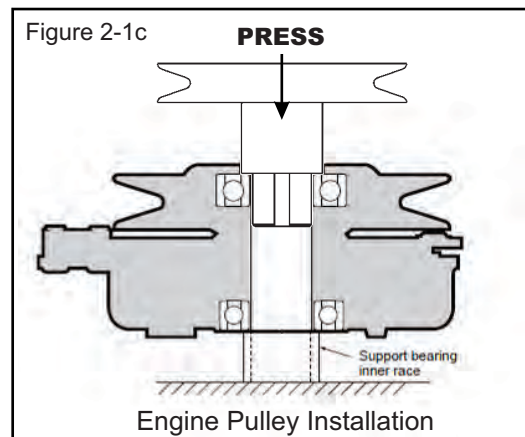

For Kawasaki FX801V and 27HP Kohler, replace these parts with the engine pulley P#(M0266) and bushing number 6 P#(S0191), 7/16" lock washer P#(K0140), and 7/16"-20 x 3-1/2" hex bolt P#(K0550). The added pulley will power the collection system. Note that the center of the hub that is extended, should be upward toward the engine (Figure 2-1d). Torque the bolt to 55 ft./lbs.

## Section II

### INSTALLATION FOR USE

#### Preparation Of Mower

Remove deck drive belt from the clutch pulley (refer to your Country Clipper operator's manual). From the underside of the engine, disconnect the wiring harness attached to the electric clutch. Remove the bolt and electric clutch from the mower. Refer to Figure 2-1a.

Figure 2-1a

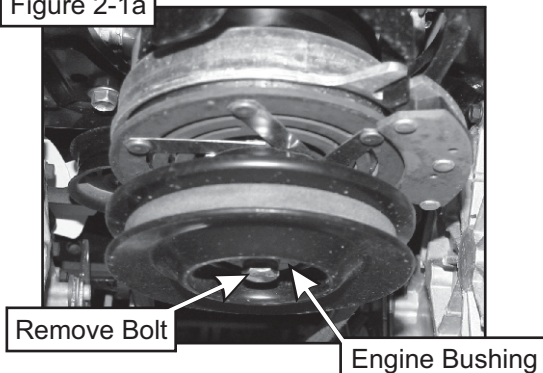

Remove the D-drive spacer using an arbor press or equivalent. On removal, adjacent bearing OUTER race must be supported or bearing damage may occur. Refer to Figure 2-1b.

Figure 2-1d

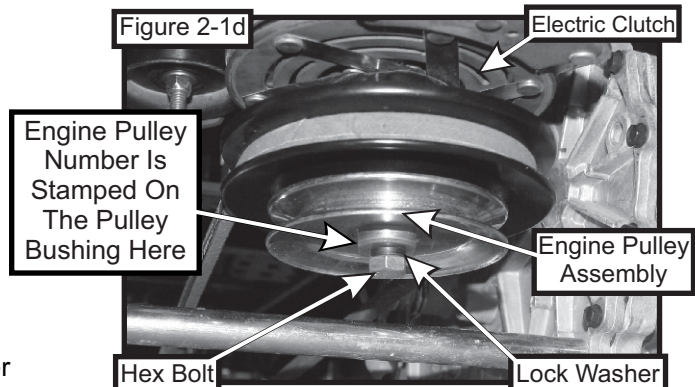

## Right Frame Bracket Installation

First, remove the pre-existing hardware on the right hand side panel of the mower. Refer to Figure A.

Next, align the middle bolt holes of each set of holes on the left side of the Rt. Frame Bracket (Item #1) to those located on the mower's right hand side panel.

Secure the Rt. Frame Bracket (Item #1) to the right hand side panel using (2) 3/8"-16 x 1" HHCS (Item #5), (2) 3/8" Ny-Flange Lock Nuts (Item #6), (1) 1/2"-13 x 1" HHCS (Item #2), (1) 1/2"-13 x 2" HHCS (Item #3) and (2) 1/2"-13 Ny-Flange Lock Nuts (Item #4). Refer to Figure B.

Figure A

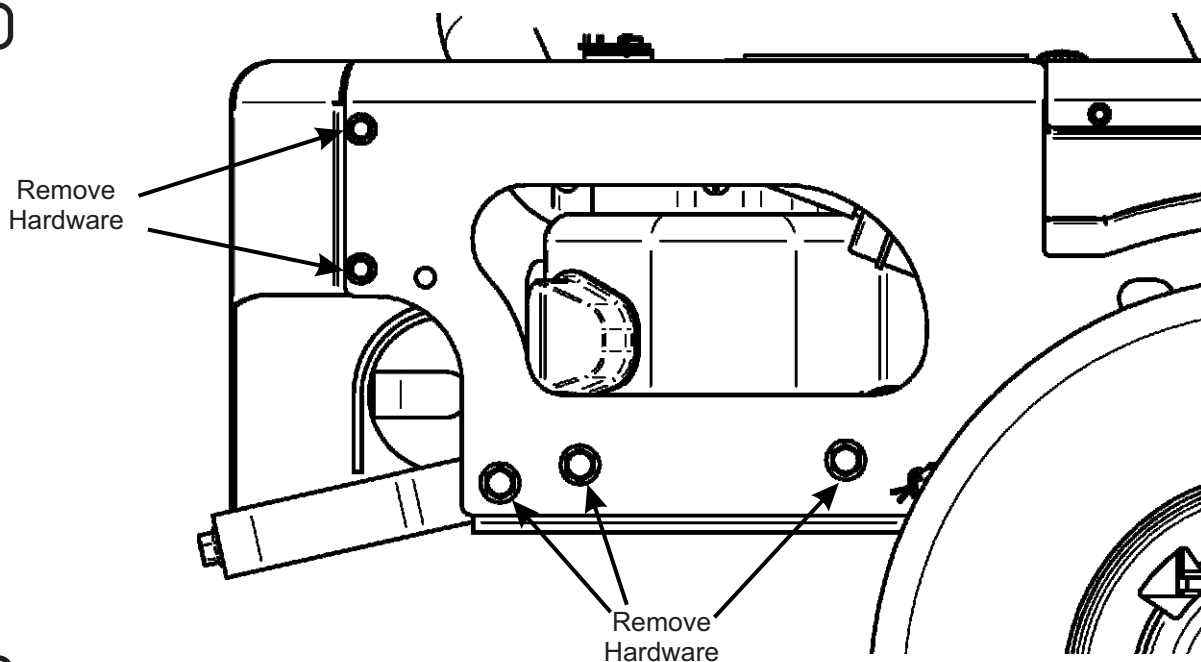
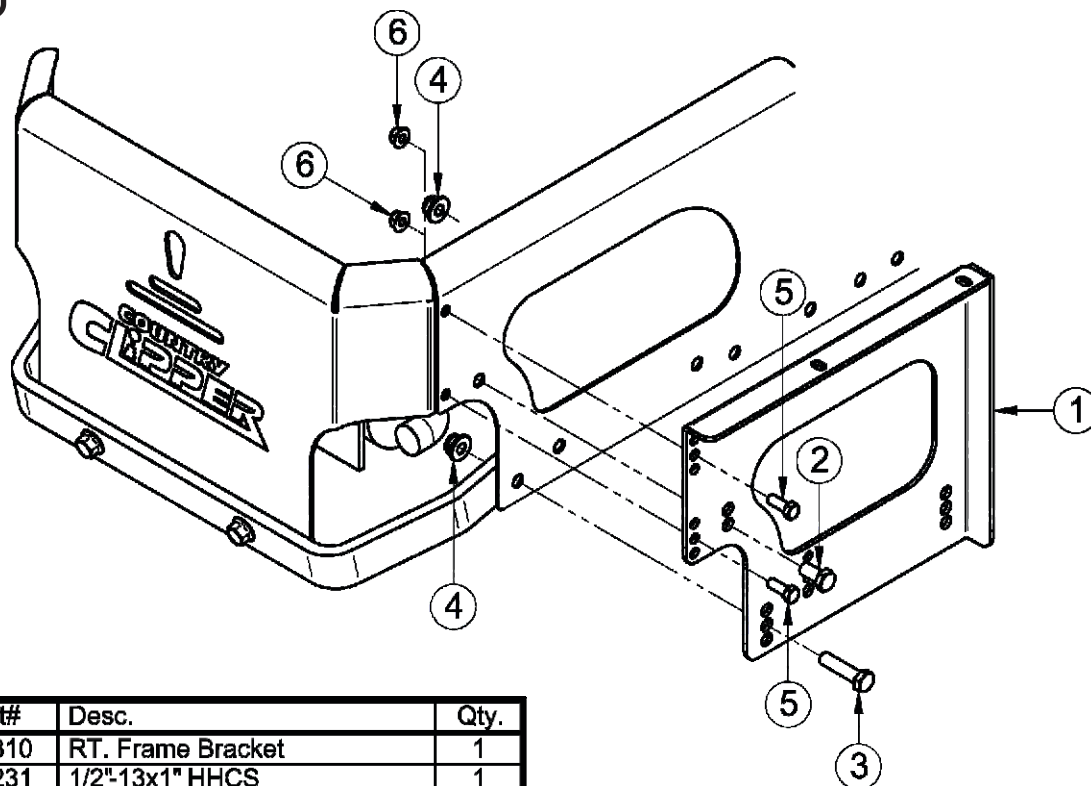

Figure B



Item#	Part#	Desc.	Qty.
1	B0810	RT. Frame Bracket	1
2	K1231	1/2"-13x1" HHCS	1
3	K1234	HHCS 1/2"-13x2"	1
4	K2012	1/2"-13 Ny-Flange Lock Nut	2
5	K1191	HHCS 3/8"-16x1"GR5	2
6	K2038	Ny-Flange Lock Nut3/8"-16	2

## Left Lower Main Frame Leg Installation

First, unhook the mower's spring and remove the spring mount plate and its hardware from the left hand side panel and set the spring mount plate aside. Next, remove the remaining hardware from the left hand side panel. Refer to Figure A.

Align the bolt holes of the Left Lower Main Frame Leg (Item #1) to those located on the mower's left hand side panel.

Secure the Lt. Lwr. Main Frame Leg (Item #1) to the left hand side panel using (2) 3/8"-16 x 1" HHCS (Item #4), (2) 3/8" Flat Washers (Item #5), (2) 3/8"-16 Ny-Flange Lock Nuts (Item #6), (1) 1/2"-13 x 1" HHCS (Item #2) and (1) 1/2"-13 Ny-Flange Lock Nuts (Item #3). Refer to Figure B.

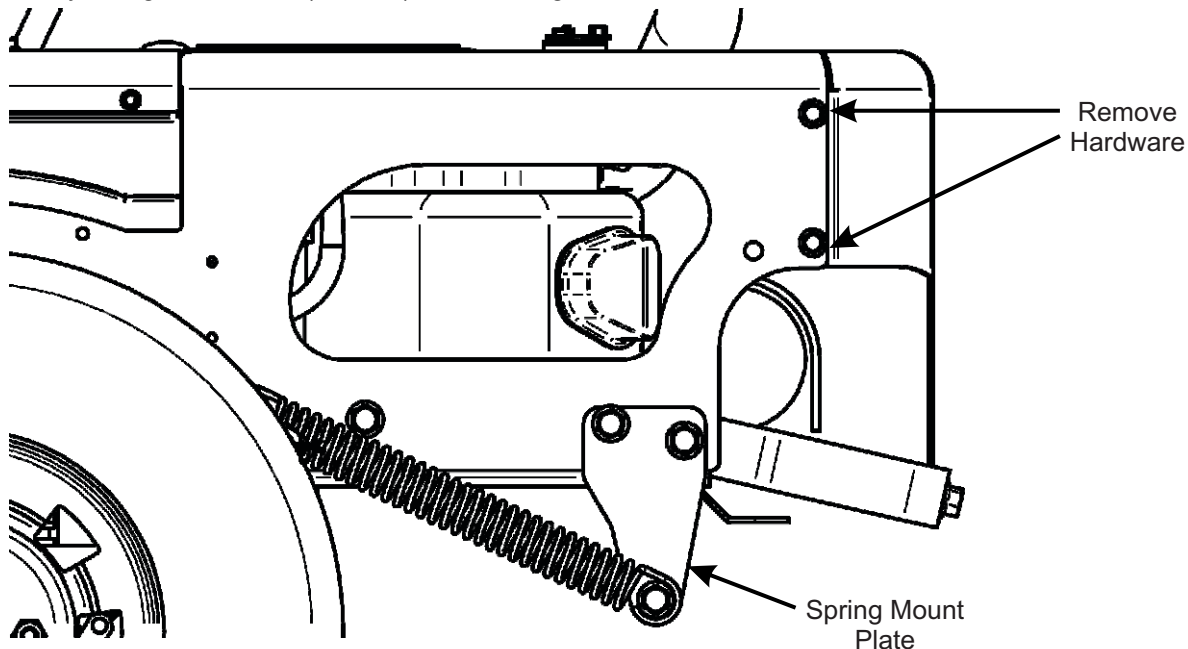

Figure A

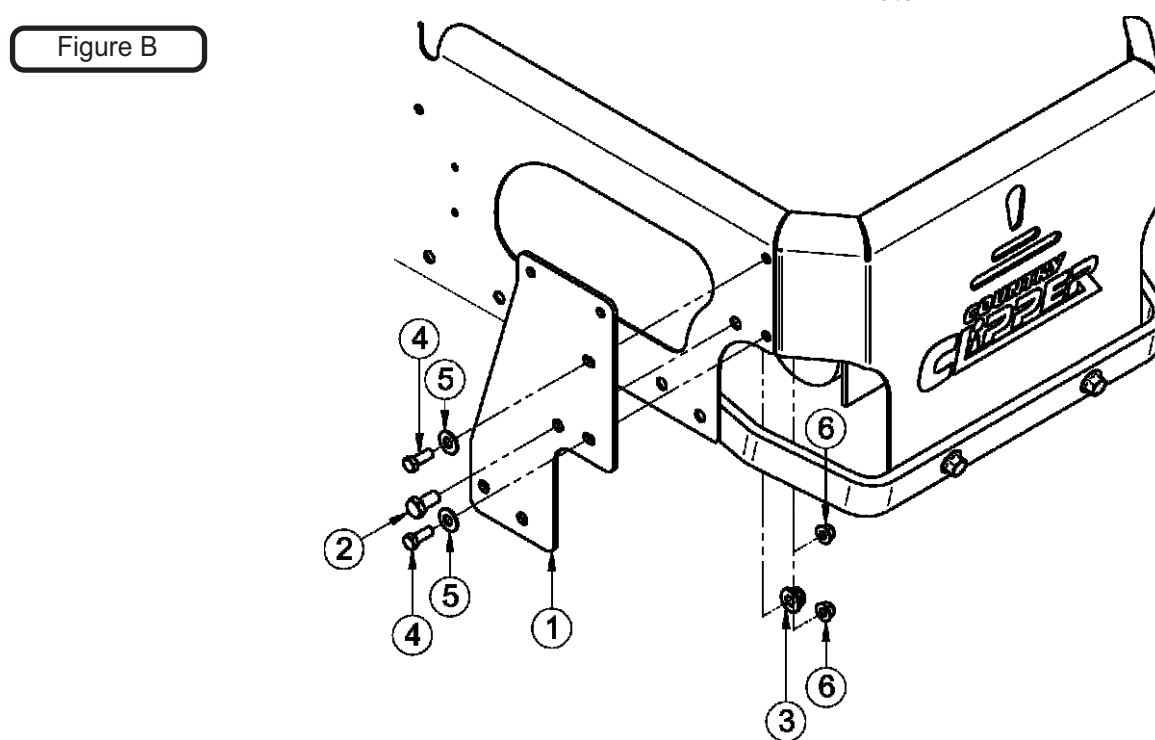

Figure B

Item#	Part#	Desc.	Qty.
1	B0874	Lt. Lwr. Main Frame Leg	1
2	K1231	1/2"-13x1" HHCS	1
3	K2012	1/2"-13 Ny-Flange Lock Nut	1
4	K1191	HHCS 3/8"-16x1"GR5	2
5	K0047	Flat Washer 3/8" / 1.00ODx.446IDx.075T	2
6	K2038	Ny-Flange Lock Nut 3/8"-16	2



**Left Lower Main Frame Leg Installation (Continued)**

Align the spring mount plate, removed from earlier, to the bottom (2) bolt holes of the Lt. Lwr. Main Frame Leg. Secure the spring mount plate to the Lt. Lwr. Main Frame Leg by using (2) 1/2"-13 x 2" HHCS (Item #7) and (2) 1/2"-13 Ny-Flange Lock Nuts (Item #8). Refer to Figure C.

Figure C

Item#	Part#	Desc.	Qty.
7	K1234	HHCS 1/2"-13x2"	2
8	K2012	1/2"-13 Ny-Flange Lock Nut	2

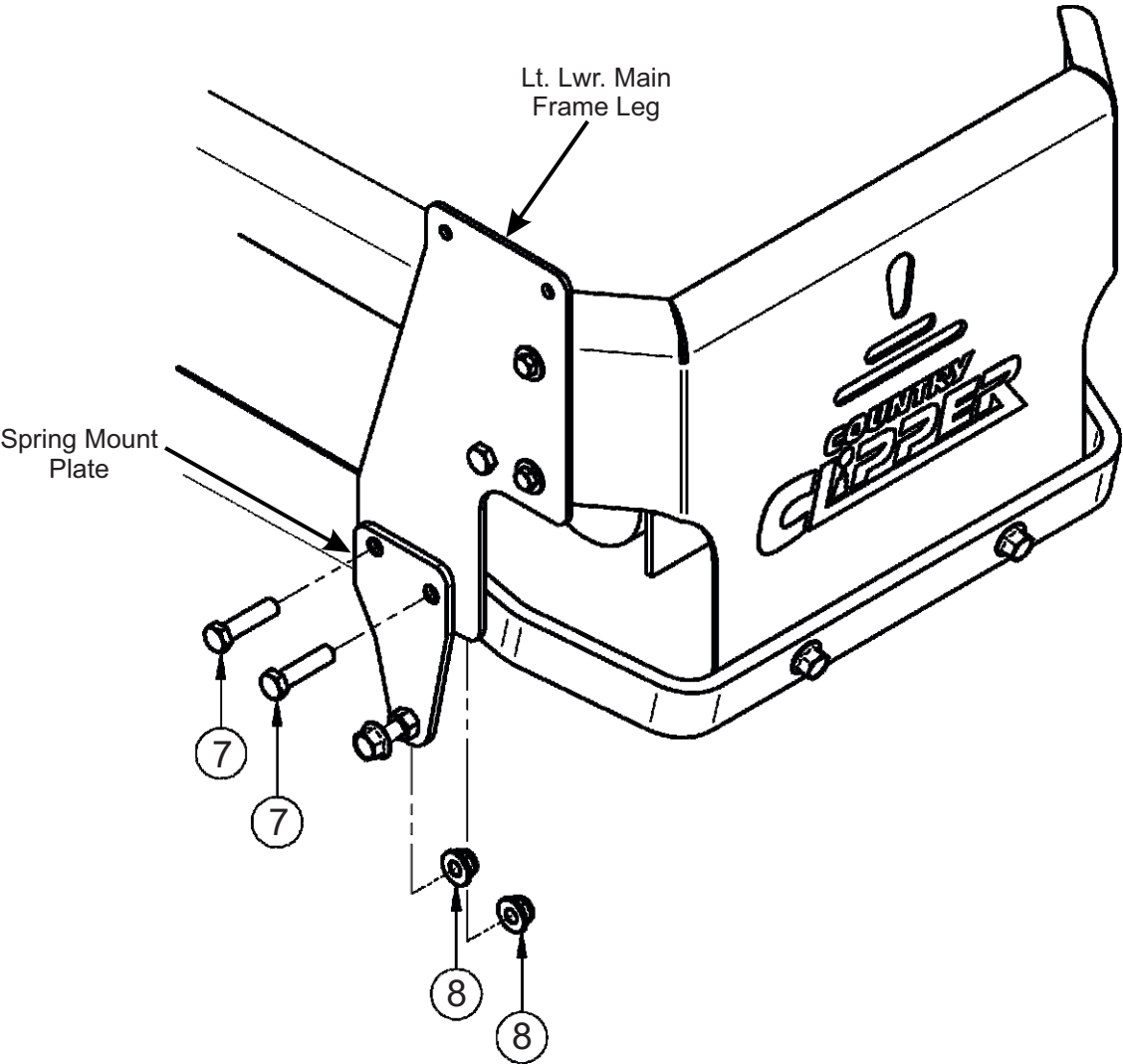

## Right Lower Main Frame Leg & PTO Mount Plates Installation

Position the Rt. Lower Main Frame Leg (Item #3) over the Rt. Frame Bracket and loosely secure the Rt. Lower Main Frame Leg by using (2) 3/8"-16 x 1-1/4" HHCS (Item #7), (2) 3/8" Flat Washers (Item #8) and (2) 3/8"-16 Ny-Flange Lock Nuts (Item #9). Refer to Figure A.

Next, align the Lt. PTO Mount Plate (Item #1) to the Rt. Frame Bracket and the Rt. Lower Main Frame Leg. Secure the Lt. PTO Mount Plate by loosening and replacing the Ny-Flange Lock Nut securing the Rt. Lower Main Frame Leg then using (1) 1/2"-13 x 2" HHCS (Item #4) and (1) 1/2"-13 Ny-Flange Lock Nut (Item #6). Refer to Figure A.

Align the Rt. PTO Mount Plate (Item #2) to the Rt. Frame Bracket and the Rt. Lower Main Frame Leg. Secure the Rt. PTO Mount Plate by loosening and replacing the Ny-Flange Lock Nut securing the Rt. Lower Main Frame Leg then using (1) 1/2"-13 x 1-1/2" HHCS (Item #5) and (1) 1/2"-13 Ny-Flange Lock Nut (Item #6). Refer to Figure A.

Figure A

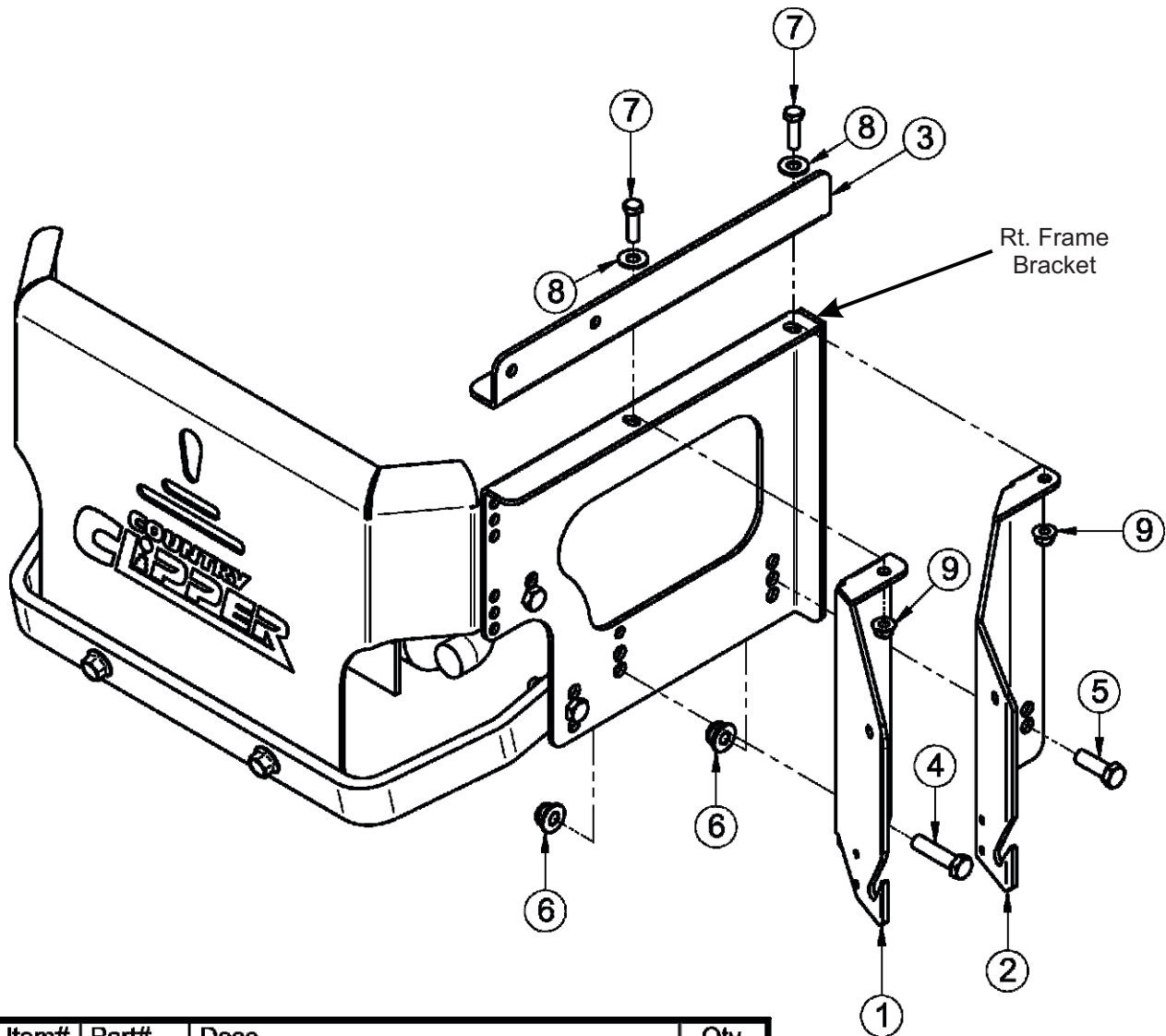

Item#	Part#	Desc.	Qty.
1	B0813	Lt. PTO Mnt. Pl.	1
2	B0814	Rt. PTO Mnt. Pl.	1
3	B0875	Rt. Lwr. Main Frame Leg	1
4	K1234	HHCS 1/2"-13x2"	1
5	K1233	1/2"-13x1-1/2"HHCS	1
6	K2012	1/2"-13Ny-Flange Lock Nut	2
7	K1192	HHCS 3/8"-16x1-1/4"GR5	2
8	K0047	Flat Washer 3/8"/1.00ODx.446IDx.075T	2
9	K2038	Ny-Flange Lock Nut 3/8"-16	2

**PTO Stop Plate Installation**

Position the PTO Stop Plate (Item #1) in between the Left and the Right PTO Mount Plates. Align the bolt holes of the PTO Stop Plate to those of the Left and Right PTO Mount Plates.

Secure the PTO Stop Plate by using (4) 1/4"-20 x 3/4" HHCS and (4) 1/4"-20 Ny-Flange Lock Nuts. Refer to Figure A.

Figure A

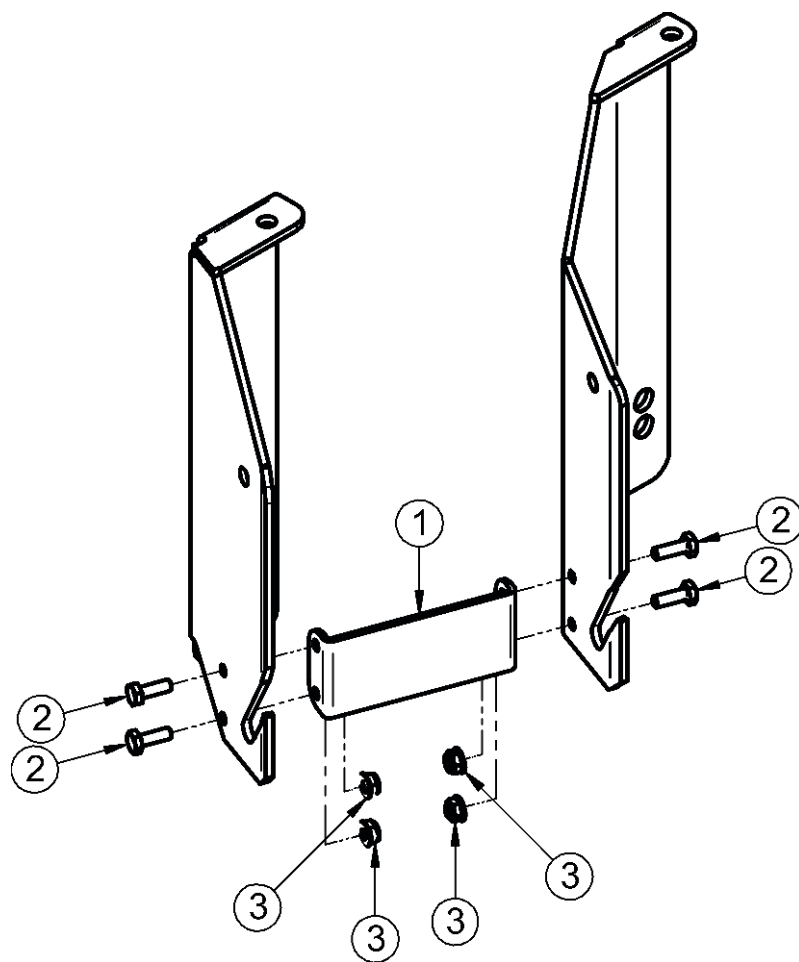

Item#	Part#	Desc.	Qty.
1	B0736	PTO Stop Pl.	1
2	K1222	1/4"-20X3/4" HHCS	4
3	K2014	1/4"-20 Ny-Flange Lock Nut	4



## PTO Assembly & Handle Assembly Installation

To mount the PTO Assembly, insert the Pivot Rod on the PTO Assembly P#(A1623) into the mounting slots located on the Left & Right PTO Mount Plates (Figure A). Tilt the PTO Assembly upward and insert the PTO Mount Pin P#(B0274) through the hole in the top of the Right PTO Mount Plate Assembly. Secure the PTO Mount Pin using (1) 1/8" Hair Pin Clip P#(K0086) as shown below.

**Note:** Remove the gearbox pulley guard in preparation for the belt installation. Refer to Figure A.

To install the PTO Handle (Item#1), attach the PTO Handle to the PTO Assembly using (3) 1/4"-20 x 3/4" HHCS (Item#3) and (3) 1/4"-20 Ny-Flange Lock Nuts (Item#4). Attach the Handle Grip (Item#2) to the PTO Handle. Refer to Figure B

**NOTE:** The PTO Handle can be adjusted after achieving proper belt adjustment. To adjust the handle, remove (3) 1/4"-20 x 3/4" HHCS (Item#3) and (3) 1/4"-20 Ny-Flange Lock Nuts (Item#4), rotate handle until positioned in the desired location (while aligning holes) and replace the hardware. The bolts should be kept approximately 120 degrees apart to ensure proper fastening.

Figure A

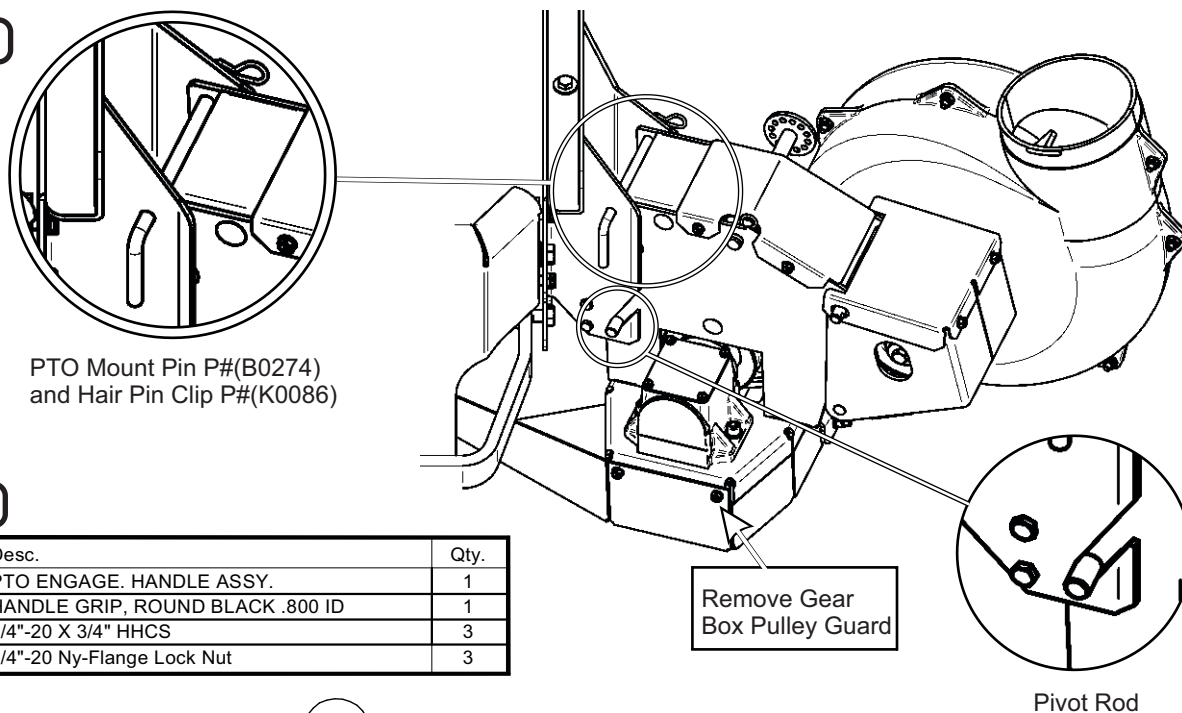
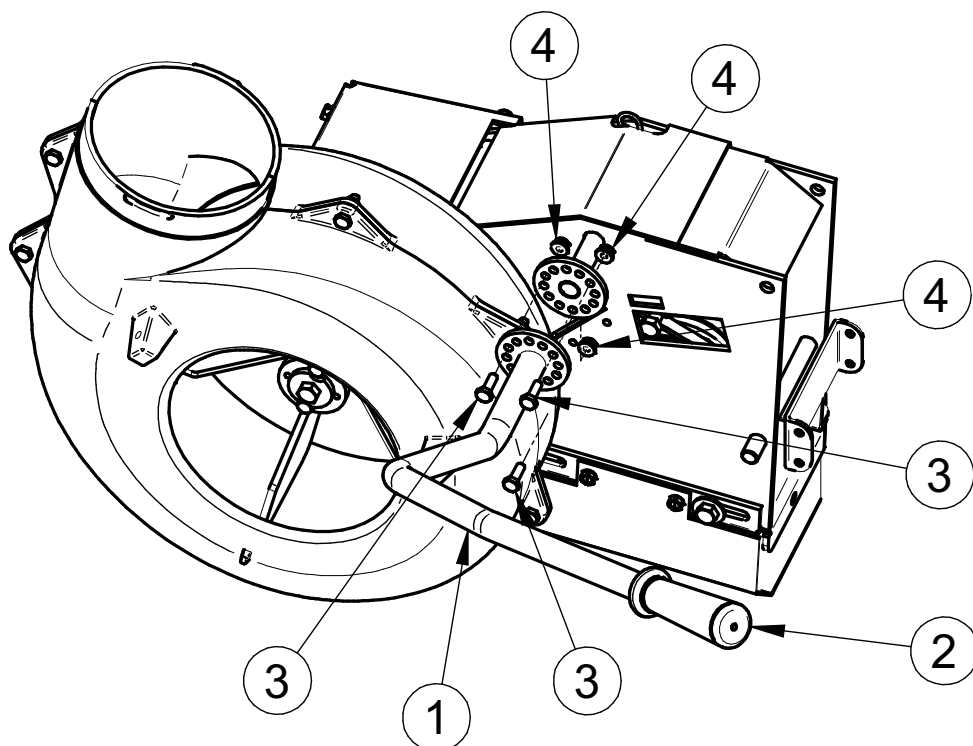

Figure B

Item #	Part #	Desc.	Qty.
1	A1142	PTO ENGAGE. HANDLE ASSY.	1
2	J0522	HANDLE GRIP, ROUND BLACK .800 ID	1
3	K1222	1/4"-20 X 3/4" HHCS	3
4	K2014	1/4"-20 Ny-Flange Lock Nut	3



## Belt Installation & Adjustment

Loosen the (4) bolts P#(K1191), (2) on each side, that secure the gear box assembly to the PTO assembly P#(A1950) (Figure A and B).

Figure A

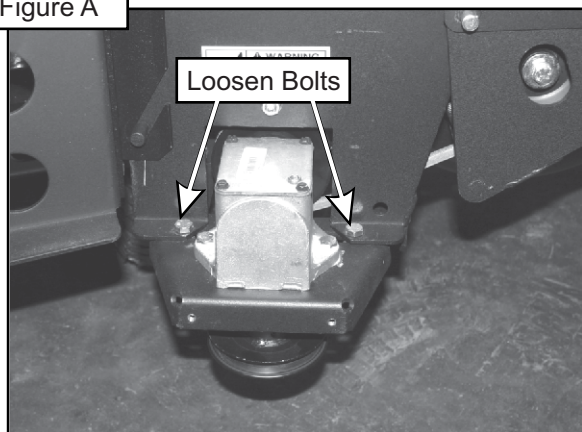
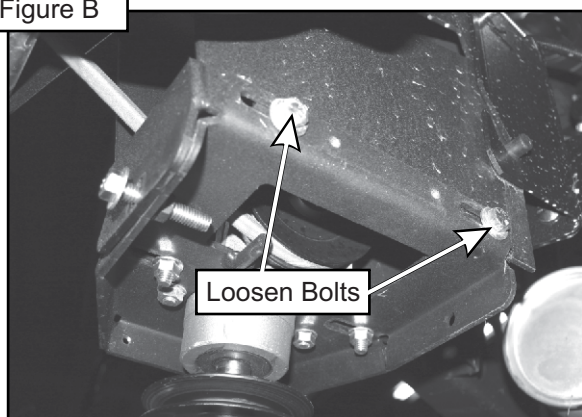
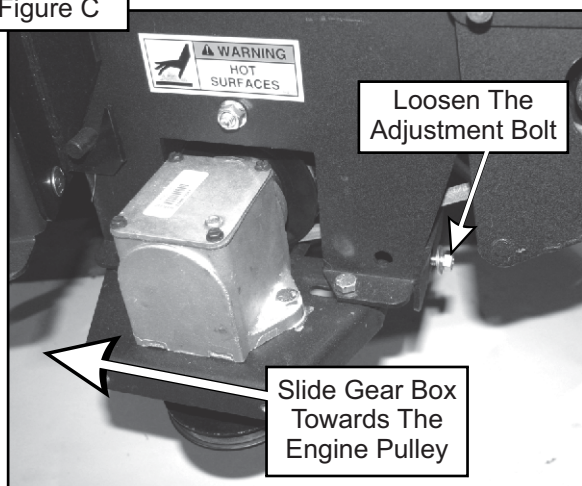

Figure B



Loosen the adjustment bolt P#(K0348) until the gear box assembly is at its far left adjustment (the gear box is moved toward the mower's engine pulley). Refer to Figure C.

Figure C



Connect the belt A56K P#(M0255) from the engine pulley to the lower gear box pulley (Figure D).

Figure D

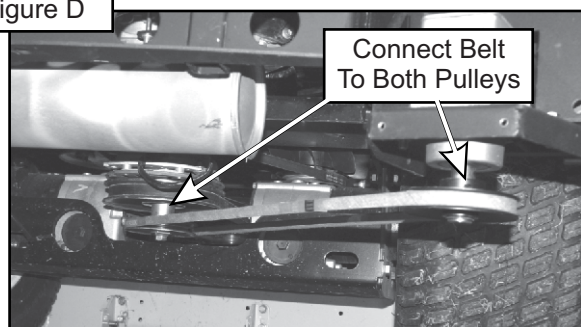

To tension the drive belt, turn the adjustment bolt clockwise (Figure E) until there is 1" of deflection, with 10-11 lbs. of pressure, at the center of the belt between the engine pulley and the gear box pulley.

Figure E

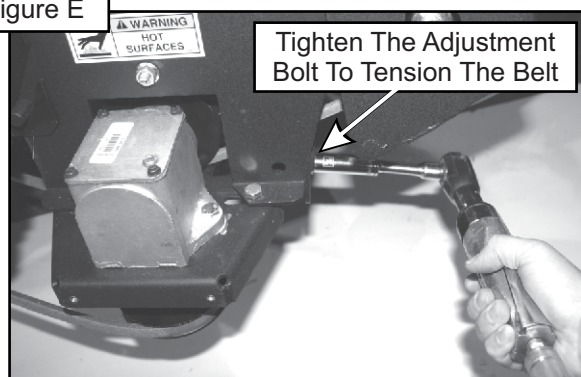

Once the correct tension of the belt is achieved, tighten the (4) bolts that secure the gear box assembly. Refer to Figures F and G. Replace the belt guard and hardware that was removed in the previous step.

Figure F

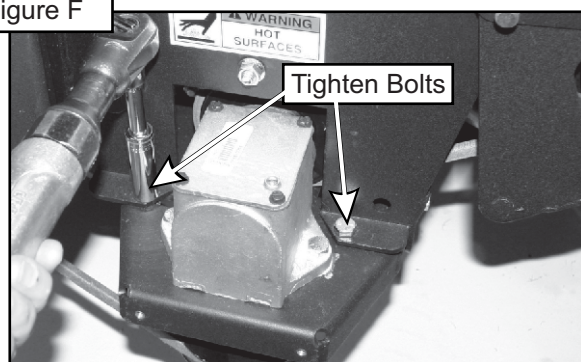
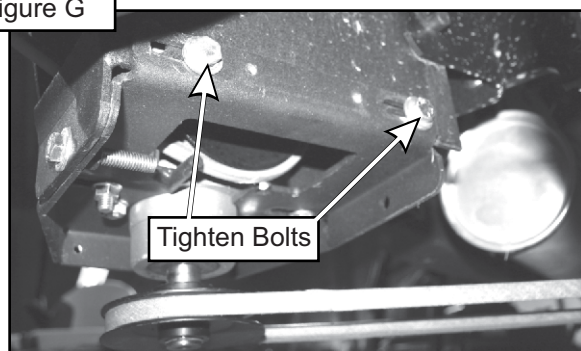

Figure G





## Cam Assembly Adjustment

The cam assembly P#(A0422), which controls the blower belt tension, comes from the factory pre-adjusted. If the belt is too tight or becomes too loose, remove the hair pin clip P#(K0130) from the belt tension rod P#(K0326) and pull the "L" end of the rod out of it's hole in the cam assembly.

The tension rod may then be screwed out to tighten the belt or screwed in to loosen the belt. Replace the "L" end into the top hole in the cam and replace the hair pin clip. Adjust the cam stop bolt P#(K1159) to allow the cam to rotate slightly over center when the blower is engaged (Figure A).

Figure A

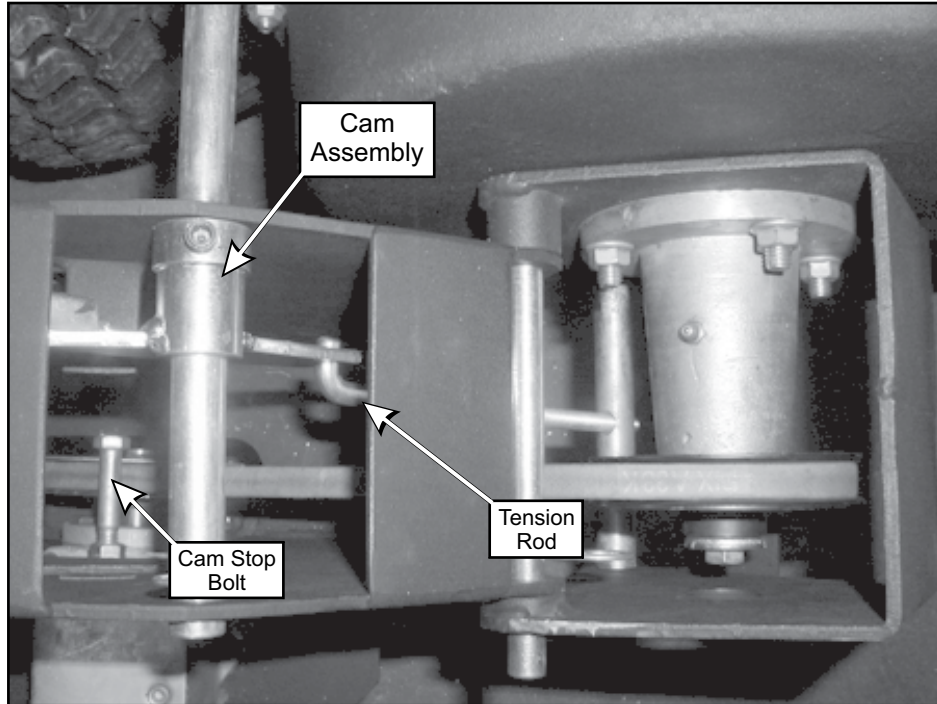

## Blower Cone Installation

Thread (1) 5/16"-18 Jam Nut P#(K0120) onto each end of (2) 5/16"-18 x 2-1/2" HHCS P#(K0125) as shown in Figure B.

Figure B

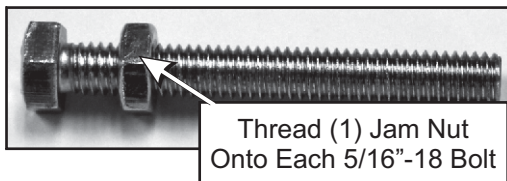

Now partially thread (1) bolt into each of the two threaded bosses located on the blower housing. Place blower cone so the two tabs line up with the bolts and tighten completely as shown in Figure C.

Figure C

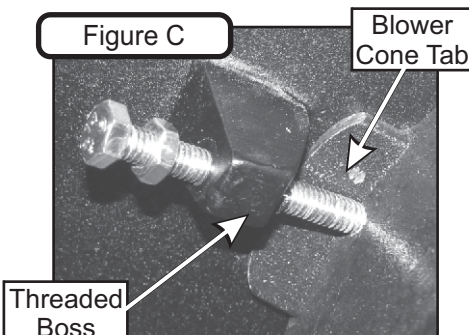

Once the (2) bolts are tight, tighten the jam nuts against the threaded boss as shown in Figure D.

Figure D

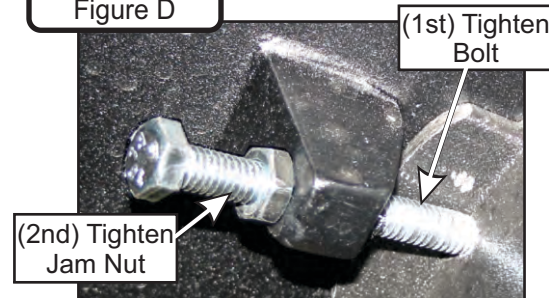

Refer to Figure E for proper Blower Cone installation.

Figure E

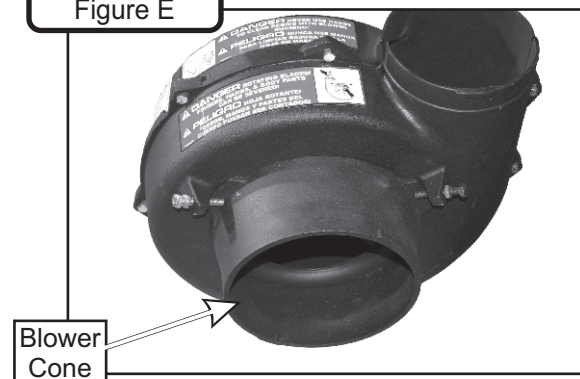



# Main Frame Assembly Installation

Align the Main Frame Assembly (Item #1) to the Lt. Lwr. Main Frame Leg and the Rt. Lwr. Main Frame Leg. Secure the Main Frame Assembly by using (4) 3/8"-16 x 1-1/4" HHCS (Item #2) and (4) 3/8"-16 Ny-Flange Lock Nuts (Item #3). Refer to Figure A.

Figure C

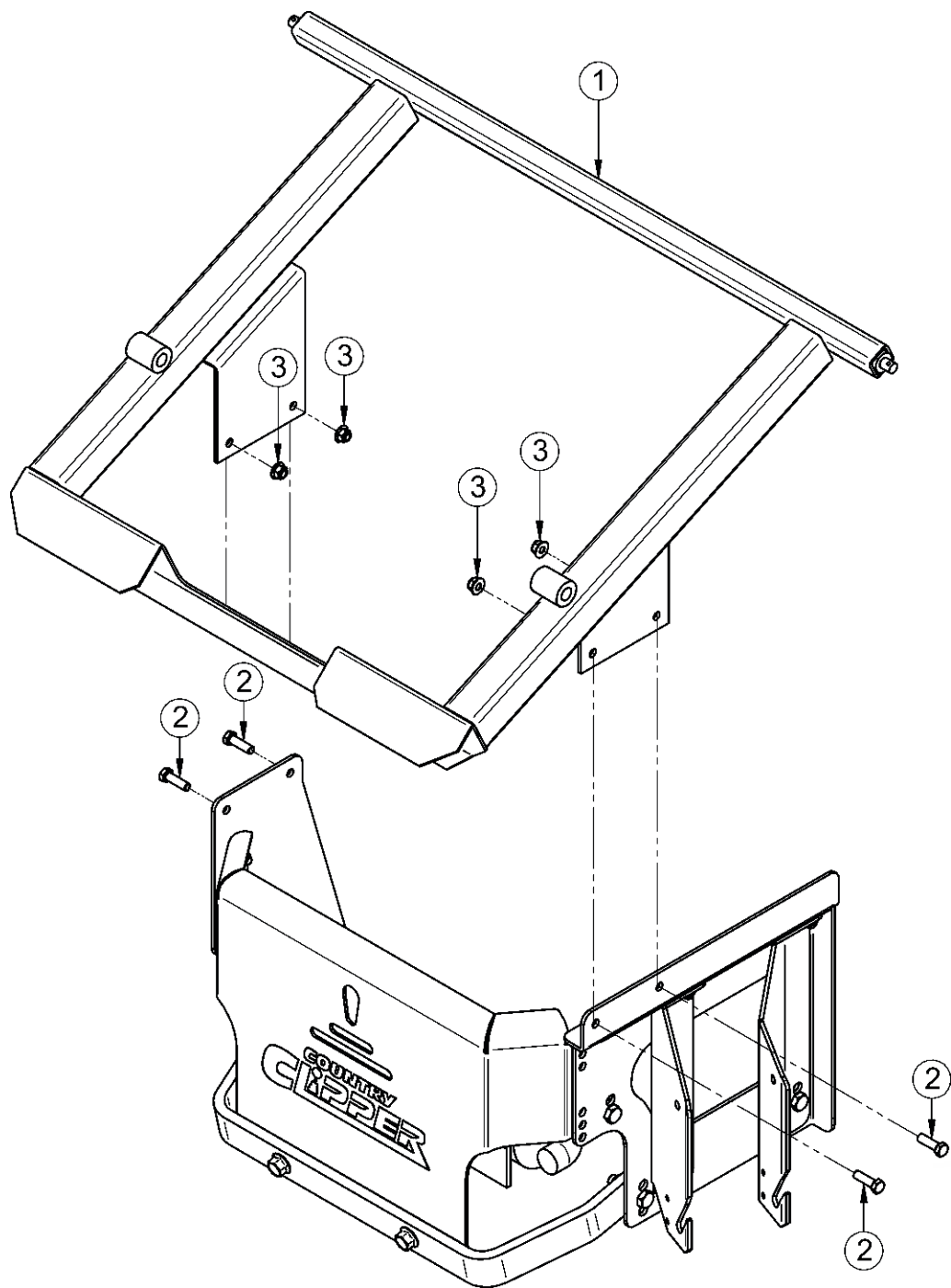

Item#	Part#	Desc.	Qty.
1	A0601	MAIN FRAME ASSY	1
2	K1192	HHCS 3/8"-16x1-1/4" GR5	4
3	K2038	Ny-Flange Lock Nut 3/8"-16	4

## Lift Handle Installation

**NOTE:** Before continuing the Lift Handle installation, have someone assist you in turning the grass container upside down. Insert (1) 3/8"-16 x 2" HHCS P#(K1208) into the Lift Handle P#(A0273), and secure with (1) 3/8"-16 Flange Nut P#(K1215). Thread the Flange Nut onto the bolt upside down, as shown in Figure A. Do not tighten the Nut fully at this time.

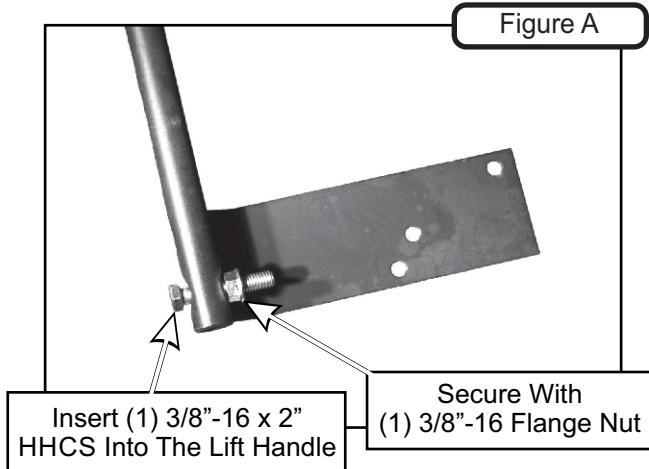

Slide the Lift Handle through the slot on the Handle Mount Bracket. Insert the lift handle into the box frame as shown in Figure B, and secure using (1) 3/8"-16 Flange Nut P#(K1215) on the inside of the container as shown in Figure C. Now test the movement of the handle. It should have full-range of movement in the slot. If the handle does not have full-range of movement, adjust the 3/8"-16 Flange Nut. Once achieved, tighten the fasteners.

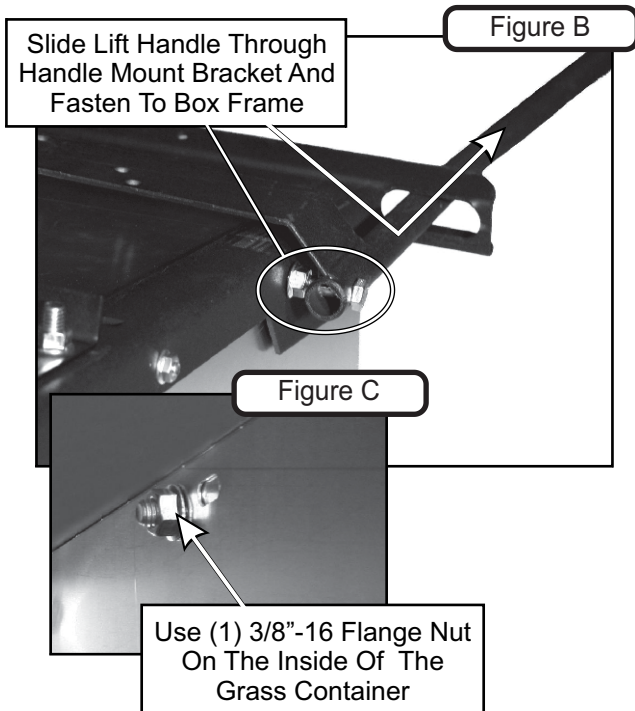

Fasten the Ball Joint P#(K1442) to the end of the Latch Rod P#(A0620). Tighten the Ball Joint to approximately half way down the threads on the Latch Rod. Attach the Ball Joint to the Latch Hook as shown in Figure D, using (1) 5/16"-24 Hex Nut P#(K1444) and (1) 5/16" Lock Washer P#(K0043).

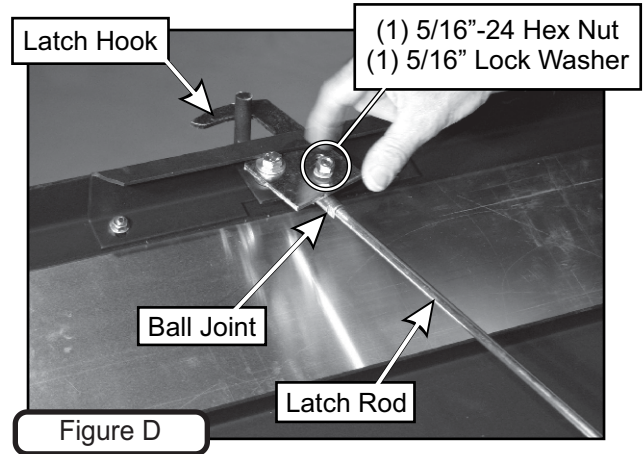

Attach the other end of the Latch Rod to the Lift Handle, as shown in Figure E. Attach one end of the Spring P#(J0176) to the Lift Handle and the other end of the Spring to the Handle Mount Bracket as shown in Figure F. Adjust the Ball Joint up or down on the Latch Rod threads until the Latch Hook closes completely. After adjusting the Latch Hook, secure the Latch Rod to the Lift Handle using (1) Cotter Pin P#(K0094).

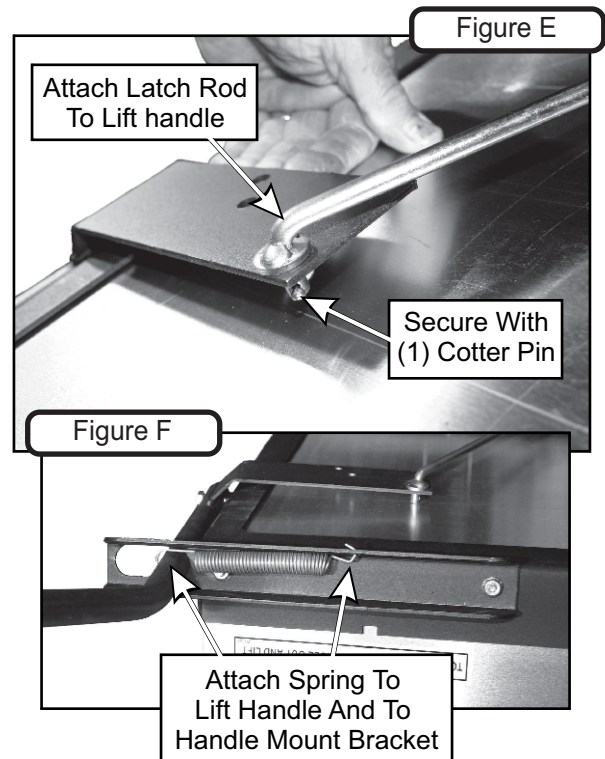

## Aluminum Box Assembly Installation

**NOTE:** It is recommended that two extra people assist in mounting the Box Assembly. Two can lower the Box onto the frame while the third person inserts the Pivot Pins P#(K0172) through the holes. Insert the Pins from the outside to the inside. Secure with (1) 5/8" Washer P#(K0058) and (1) 5/32" x 2-5/8" Hair Pin Clip P#(K0088) per Pivot Pin (Figure B). Reattach the bottom ends of the door opening linkages to the Main Frame by using (1) Rue-Ring Cotter Pin P#(K1437) per side. To test the functionality of the dump mechanism, pull the Lift Handle away from the unit, and lift upward. The Door of the Box Assembly should open and the Box should pivot clockwise towards the ground.

Figure A

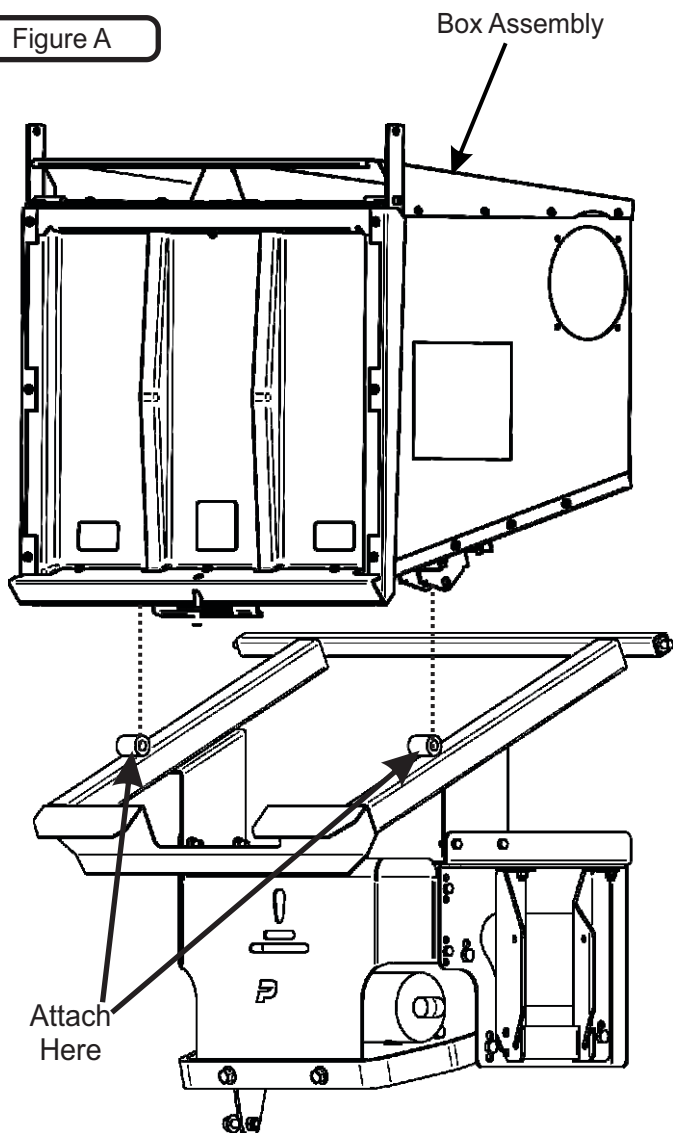
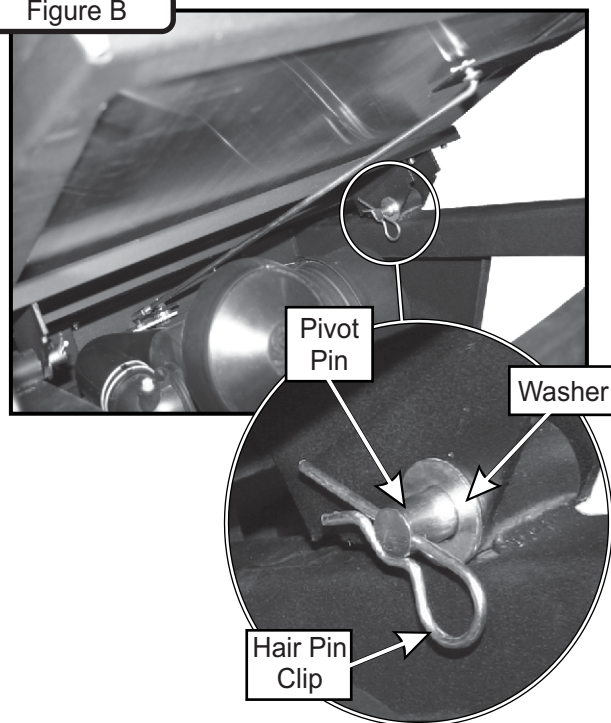

Figure B



## Dump Mechanism Adjustment

The mechanism may be adjusted in three places, at the Adjusting Screw P#(K1435), at the Latch Hook Pivot Bolt and the linkage Ball Joint. To change the door closure tightness, thread the Adjusting Screw (Figure C) in or out or by adjusting the Latch Hook Pivot Bolt within its' mounting slot. To adjust the Latch Hook closure angle, thread the Linkage Ball Joint in or out.

Figure C

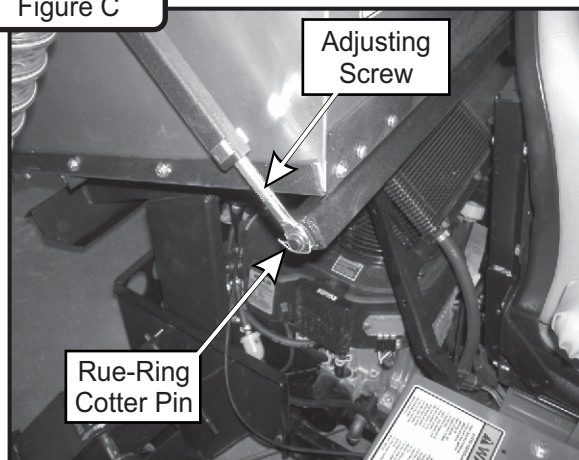



## Boot Installation

Secure the Boot Plate P#(B0820) to the Aluminum Boot P#(E1902A) using (2) 3/8"-16 x 1" Carriage Bolts P#(K1182) and (2) 3/8"-16 Nylon Flange Locknuts P#(K2038). Insert the Carriage Bolts from the inside of the Boot so the threads are on the top of the Boot. This will prevent grass clippings from collecting on the threads. Leave the hardware loose until the Boot Plate has been attached to the mower deck. Refer to Figure A and B for reference.

Remove the hardware from the grass deflector and insert (1) Boot Rod P#(B4331) into the grass deflector mounting holes as shown in Figure A. Secure the Boot Rod using (1) Hair Pin Clip P#(K0099). With the Carriage Bolts still loose, adjust the position of the Boot so that there is no gap between the mower deck and the Boot. Tighten the hardware at this time.

Figure A

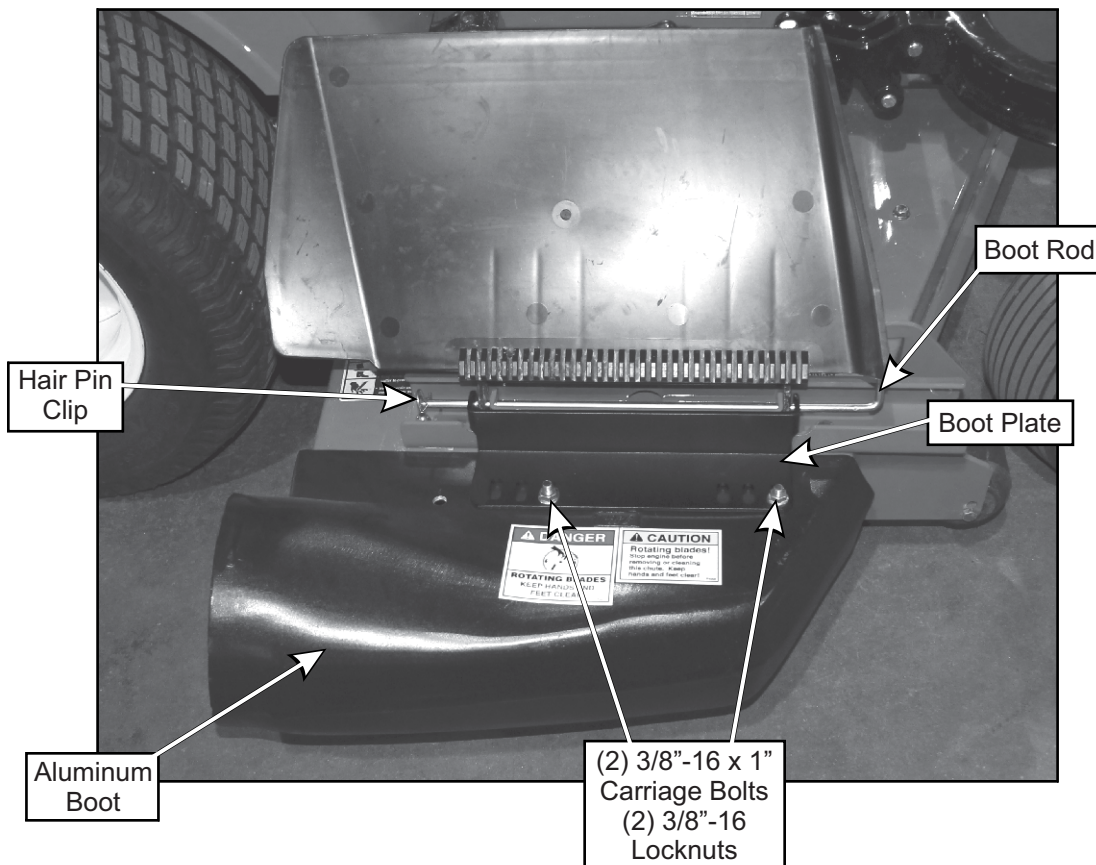
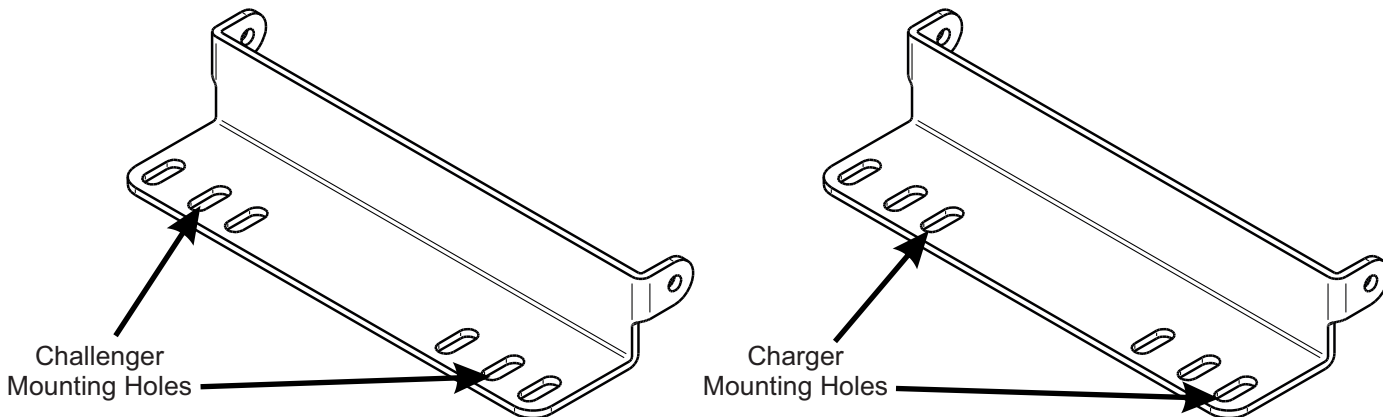

Figure B



## Length Of Hose Adjustment

The hoses in the following steps must be cut to fit your machine. Do not cut the hoses until you have tried to fit them on your machine. Remember that the hoses need to be long enough to allow for the opening and closing of the collection system as well as allowing ample clamping surface between each component.

## Upper Hose Installation

Slide a Hose Clamp P#(J0060) over one end of the 6" Upper Hose. Secure this end of the 6" Upper Hose to the Blower Outlet. See Figure below for details. Secure opposite end of the 6" Upper Hose to the Inlet. Make sure both ends are securely fastened by tightening the Hose Clamp and rotating the Inlet Snap Fastener towards the hose to lock in place.

## Lower Hose To Blower Cone Installation

Slide a Hose Clamp P#(J0080) over both ends of the Lower Hose. Secure one end of the Lower Hose to the Blower Cone and fasten by tightening the Hose Clamp.

## Lower Hose To Boot Installation

Take the unattached end of the Lower Hose and secure it to the circular end of the Boot and fasten by tightening the Hose Clamp.

Tip: Before securing Hose Clamp fully, rotate Lower Hose counter-clockwise (away from yourself) approximately 1" to aid in retaining Boot to mower deck.

Figure A

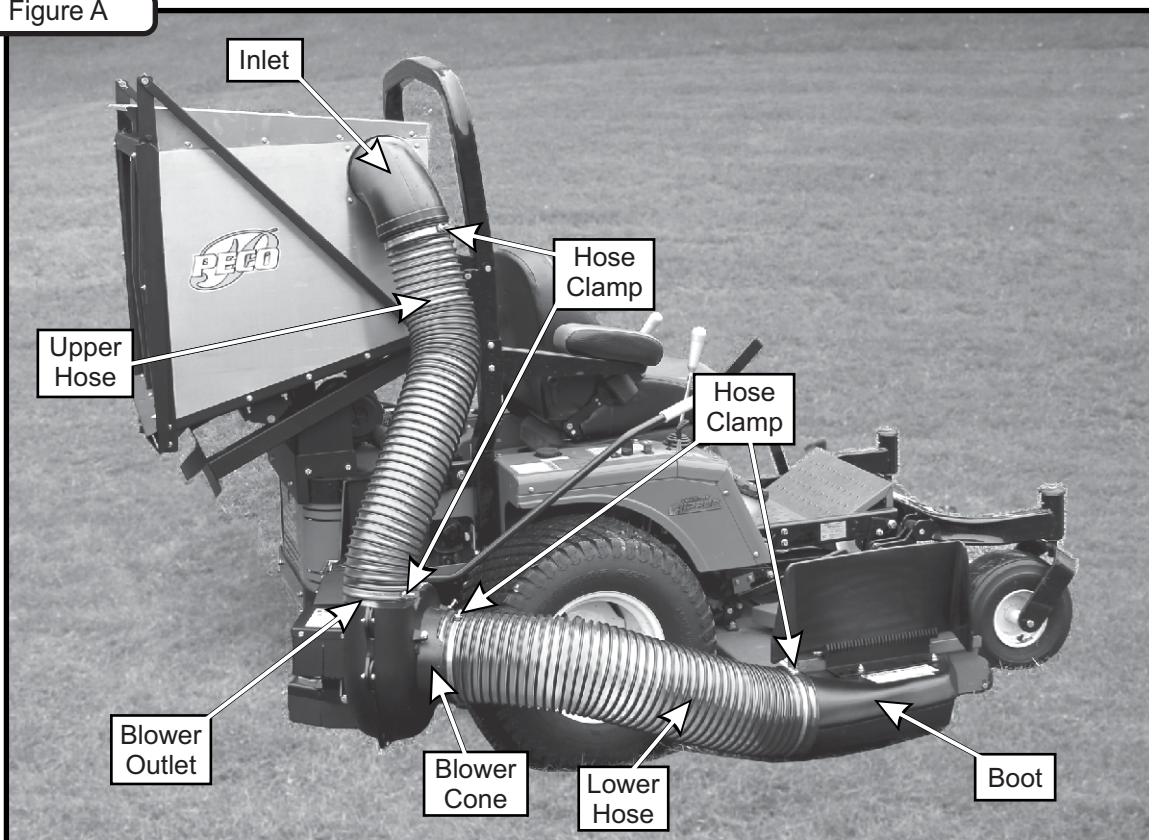

## Impeller Blade Removal/Replacement

To gain impeller blade (#1) access, first remove the blower cone (#2) from the blower housing, located on the PTO assembly P#(A1821), by removing two blower cone bolts and nuts (#3). Next, remove the blower housing front (#4) by removing seven bolts and nuts (#5) around the outer housing edge. Refer to Figure A.

**To Remove:** First, remove one 3/8"-16 x 1-1/2" HHCS P#(K1211) (#6), one taper-lock bushing washer P#(K0278) (#7) and one spacer bushing P#(S3242) (#8) from the taper-lock bushing (#9). See Figure 2-20. Next, remove two 1/4"-20 x 1" HHCS (#10) and place them into the threaded holes (#11) of the taper-lock bushing P#(S4302). Last, gradually thread each bolt evenly into the taper-lock bushing, forcing the blade to break-away from the taper-lock bushing.

### Tips on removing impeller blade;

- 1 - Try carefully hitting the base of the impeller blade (#1), between each vein (#12), with a rubber mallet to loosen the taper-lock bushing hold.
- 2 - Spray break-free lubricant into the surrounding areas of the taper-lock bushing (#9) and repeat Tip 1.

**To Replace:** First, place the impeller blade (#1) over the drive shaft (#13). Next, slide the taper-lock bushing (#9) on to the drive shaft and into the impeller blade, aligning the **non-threaded** holes (#14) of the taper-lock bushing to the threaded holes of the impeller blade. Then, fasten by using two 1/4"-20 x 1" HHCS (#10), one spacer bushing (#8) one taper lock bushing washer (#7), and one 3/8"-16 x 1-1/2" HHCS (#6). Torque all bolts to the specifications located in the chart towards the back of this manual. Last, rotate the impeller blade to ensure that the blade is clear of contact on all sides of the blower housing.

Figure A

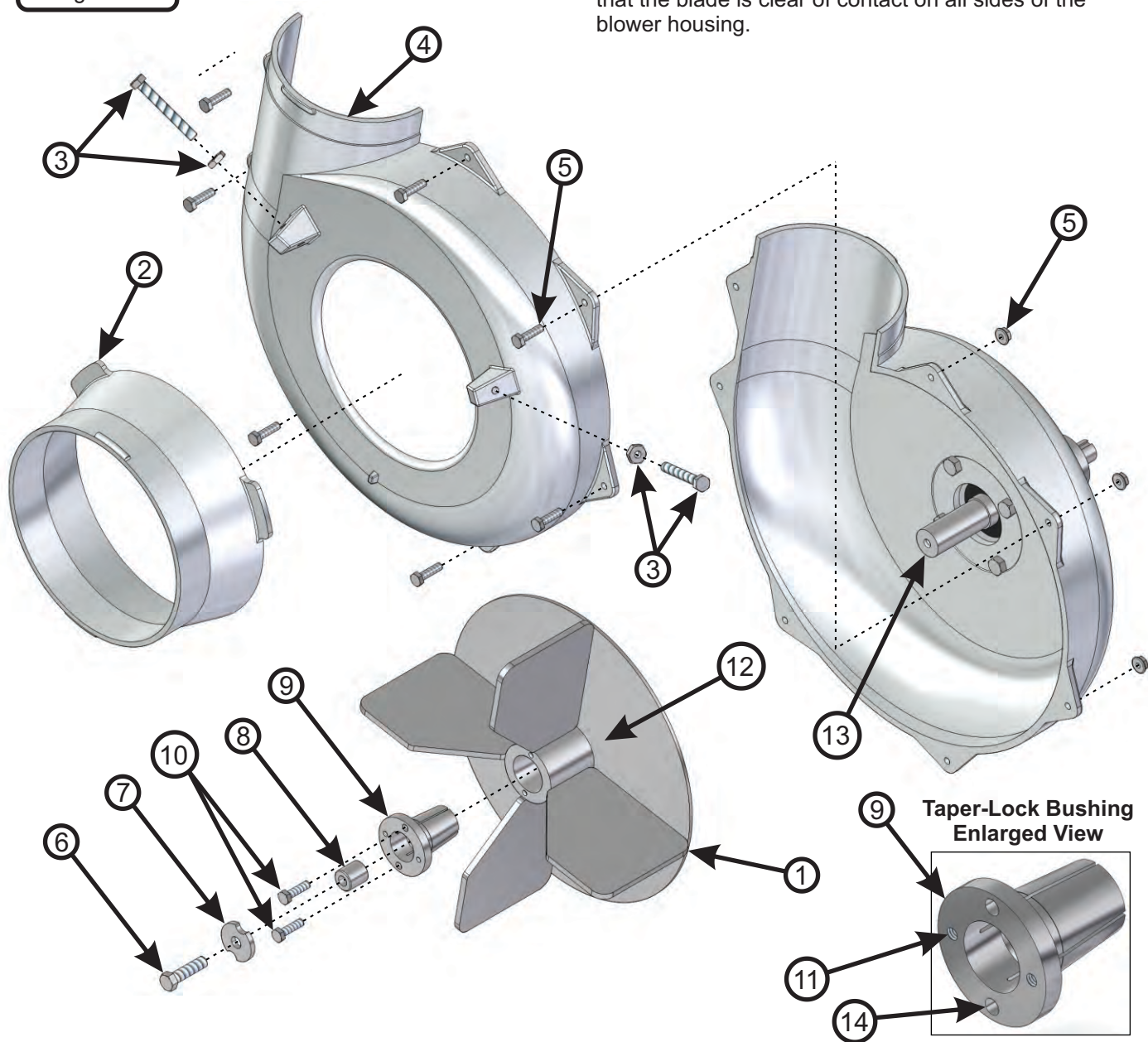



# Weight Kit Installation / Left Caster

NOTE: This Assembly Installation is intended for the Left Caster of the mower.

Position the Quad Weight Bracket Base (Item#1) under the caster tubing w/ opening towards caster fork. Next, position the Weight Bracket Clamp (Item#2) on top of caster tubing w/ opening towards caster fork.

Align the (4) holes of the Weight Bracket Clamp (Item#2) to the holes in the Quad Weight Bracket Base (Item#1). Loosely fasten the Weight Bracket Clamp (Item#2) to the Weight Bracket Base (Item#1) using (4) 5/16"-18 x 3" Bolts (Item#4) & (4) 5/16"-18 Ny-Flange Lock Nuts (Item#5).

Position the Weight Bracket Base and the Weight Bracket Clamp assembly along the caster tubing to prevent interference from caster forks or any other objects. Tighten the fasteners in an 'X' pattern until assembly is firmly clamped to caster tubing. Do not over tighten which may result in bending Weight Bracket Clamps (Item#3).

To Install the Weights, insert (2) Weights (Item#3) Into the Weight Bracket Base (Item#2) & align the holes of the Weights w/ the holes of the Weight Bracket Base (Item#2). Fasten the Weights (Item#1) to the Weight Bracket Base Using (1) Clevis Pin (Item#6) & (1) Hair Pin Clip (Item#7) per weight. Repeat for additional Weights.

Refer to the Figure Below.

Figure A

Item#	Part#	Desc.	Qty.
1	B1063	QuadWeightBracket/Base	1
2	B1015	WeightBracket/Clamp	1
3	Y0025	28lb.SuitcaseWeight	4
4	K1472	HHCS5/16"18x3" GR5	4
5	K2516	Ny-FlangeLockNut5/16"18	4
6	K1482	1/2"x5" SteelClevisPin	2
7	K1478	HairPinCotter/DoubleLoop	2

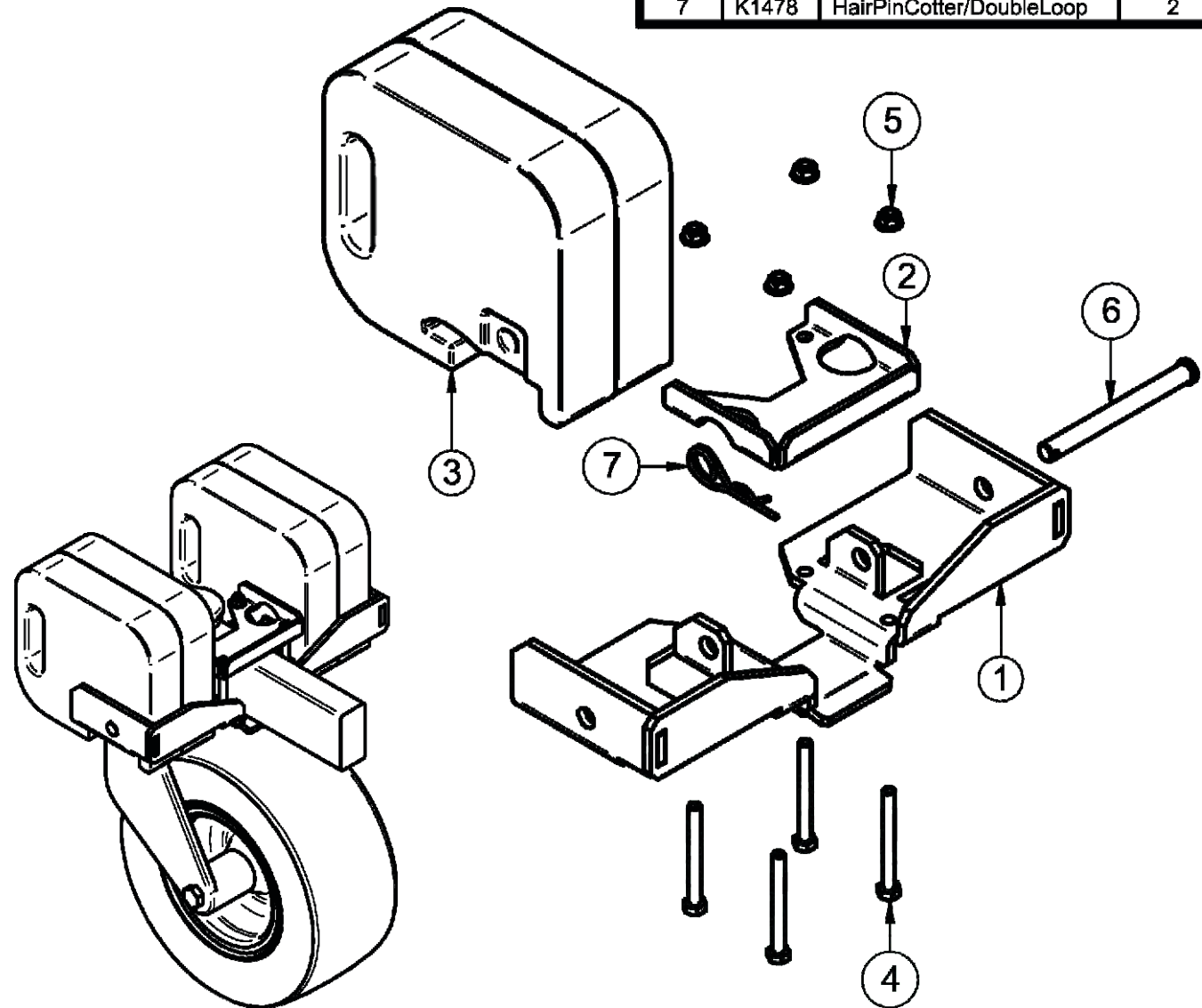

# Weight Kit Installation / Right Caster

NOTE: This Assembly Installation is intended for the Right Caster of the mower.

Position the Dual Weight Bracket Base (Item#1) under the caster tubing w/ opening towards caster fork. Next, position the Weight Bracket Clamp (Item#2) on top of caster tubing w/ opening towards caster fork.

Align the (4) holes of the Weight Bracket Clamp (Item#2) to the holes in the Dual Weight Bracket Base (Item#1). Loosely fasten the Weight Bracket Clamp (Item#2) to the Weight Bracket Base (Item#1) using (4) 5/16"-18 x 3" Bolts (Item#4) & (4) 5/16"-18 Ny-Flange Lock Nuts (Item#5).

Position the Weight Bracket Base and the Weight Bracket Clamp assembly along the caster tubing to prevent interference from caster forks or any other objects. Tighten the fasteners in an 'X' pattern until assembly is firmly clamped to caster tubing. Do not over tighten which may result in bending Weight Bracket Clamps (Item#3).

To Install the Weights, insert (1) Weight (Item#3) Into the Weight Bracket Base (Item#2) & align the holes of the Weight w/ the holes of the Weight Bracket Base (Item#2). Fasten the Weight (Item#1) to the Weight Bracket Base Using (1) Clevis Pin (Item#6) & (1) Hair Pin Clip (Item#7) per weight. Repeat for additional Weights.

Refer to the Figure Below.

Figure A

Item #	Part #	Desc.	Qty.
1	BI014	Dual Weight Bracket / Base	1
2	BI015	Weight Bracket / Clamp	1
3	Y0025	28 lb. Suitcase Weight	2
4	KI472	HHCS 5/16"-18 x 3" GR5	4
5	K2516	Ny-Flange Lock Nut 5/16"-18	4
6	KI473	Clevis Pin 1/2" x 3"	2
7	KI478	Hair Pin Cotter / Double Loop	2

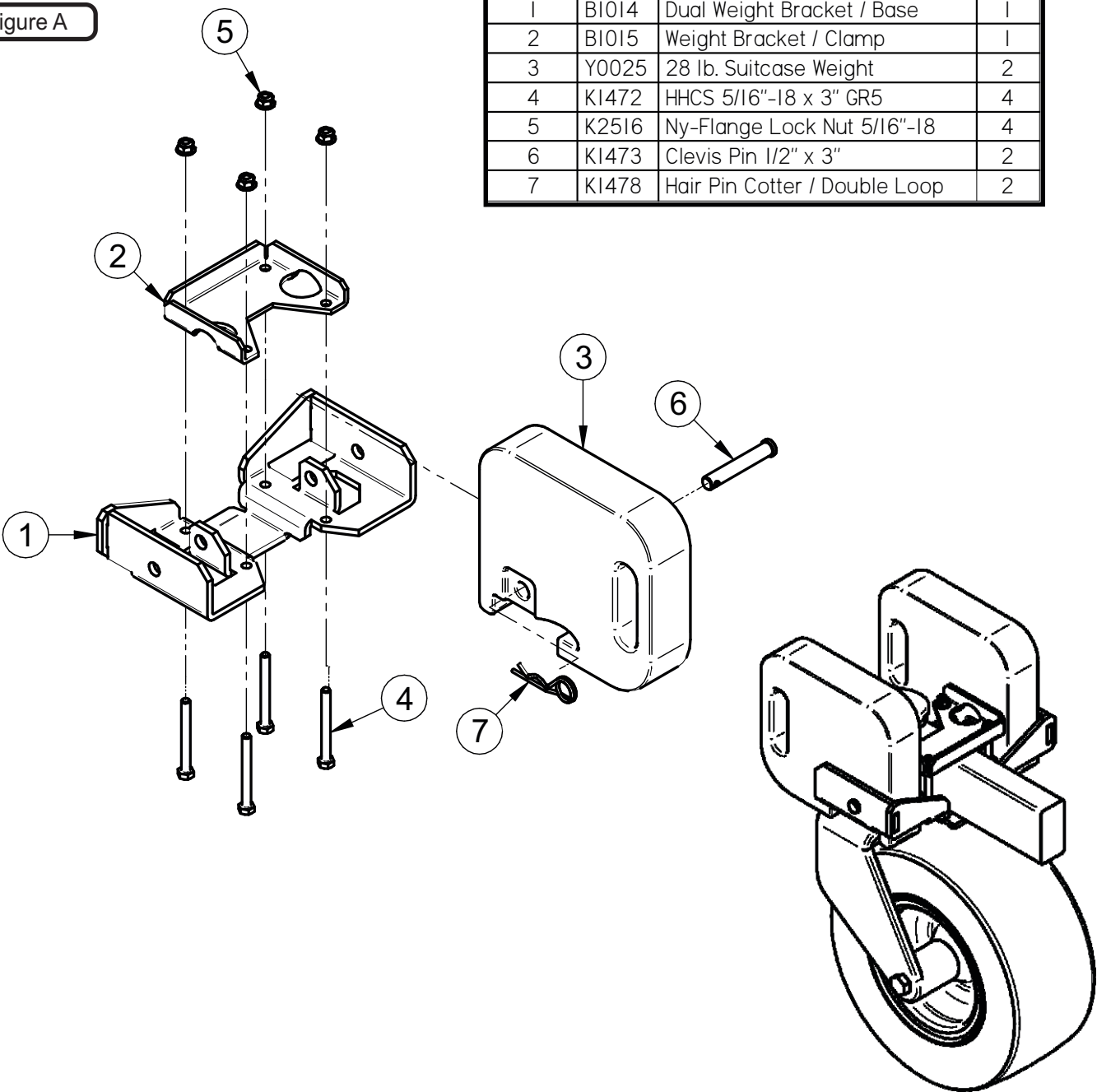



A0794  
ALUMINUM GRASS  
CONTAINER  
EXPLODED VIEW

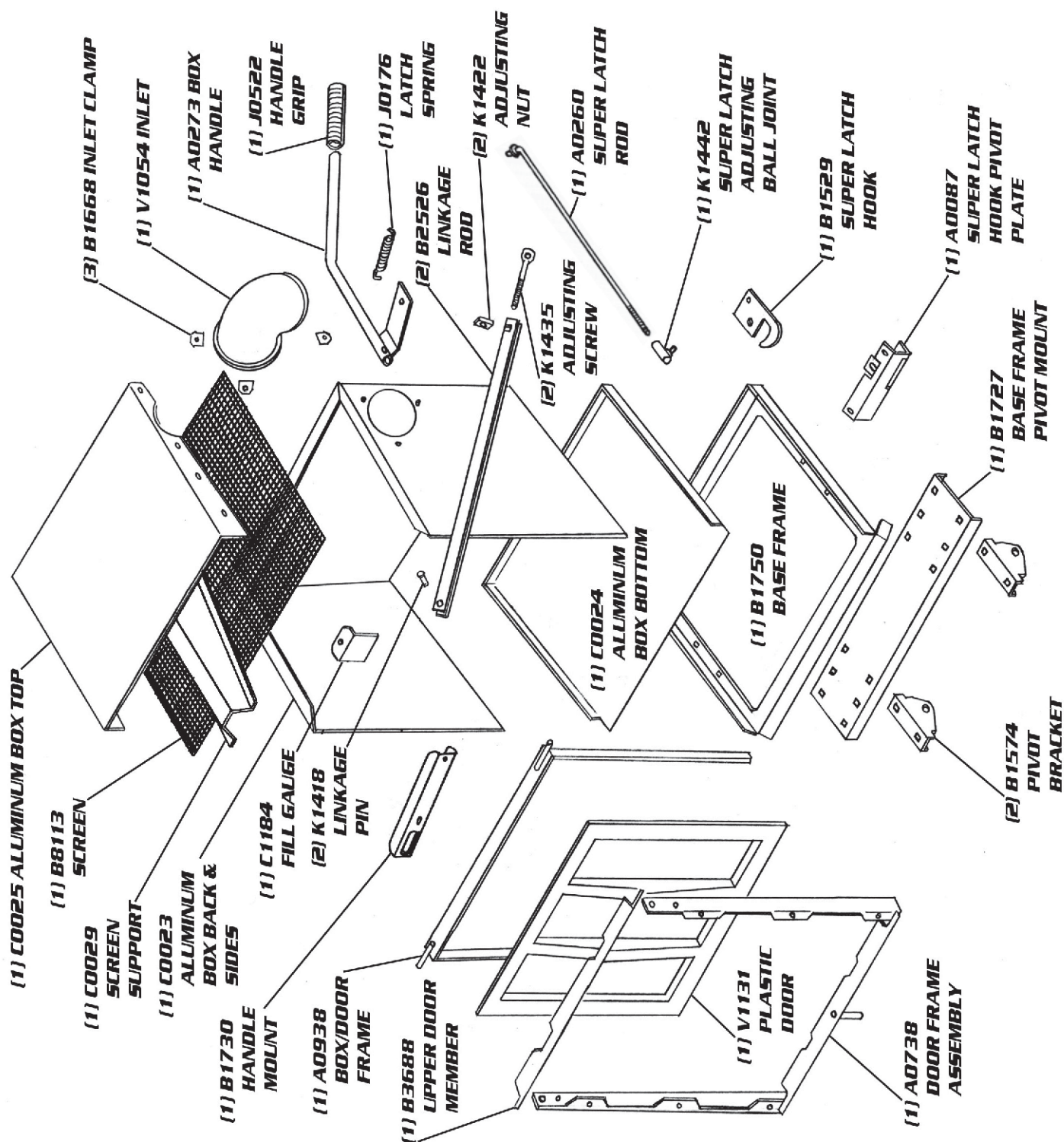

# PTO Parts Exploded View/List

## A1841\_01 PTO Arm Assembly

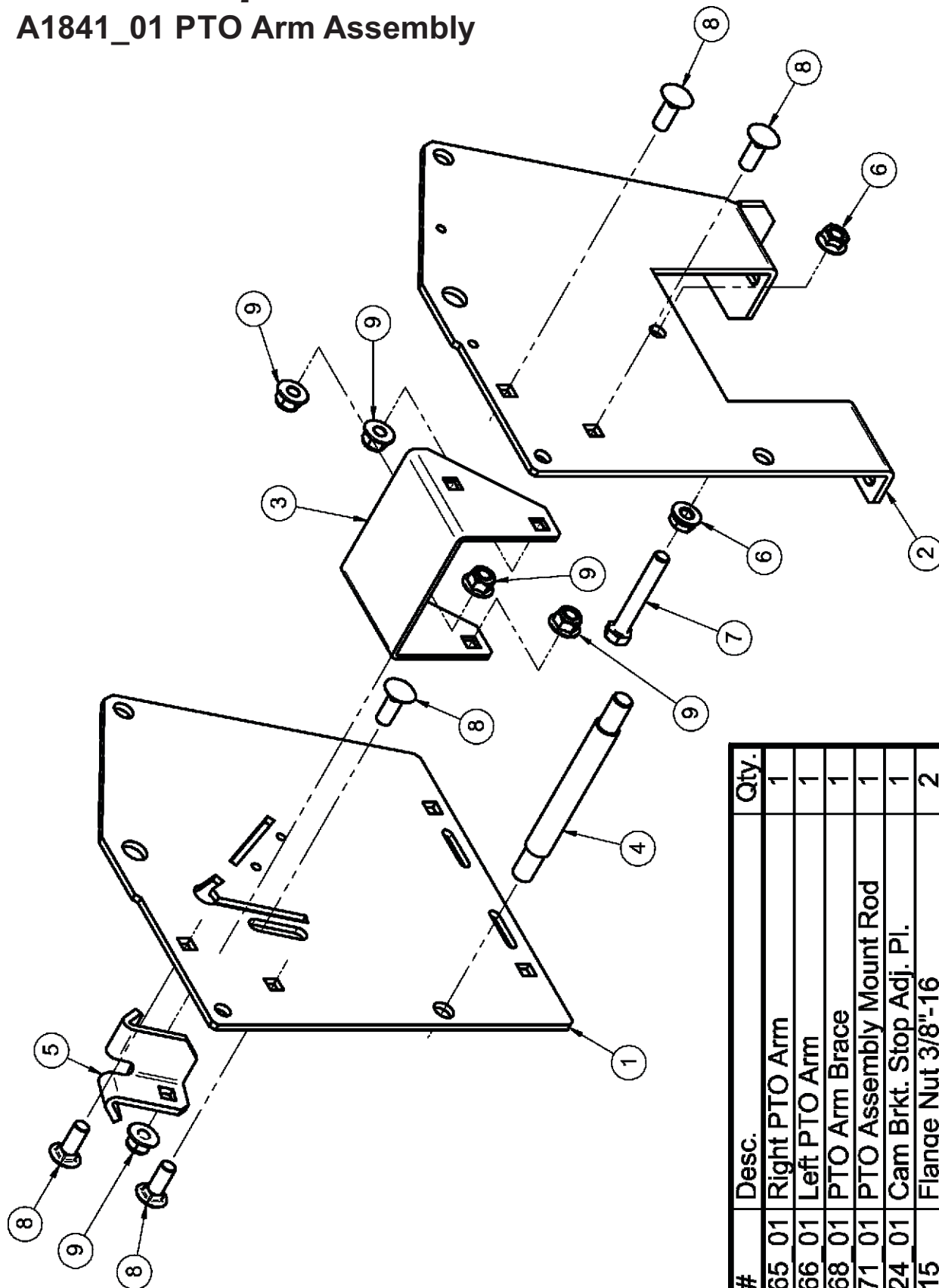

Item#	Part#	Desc.	Qty.
1	B0265 01	Right PTO Arm	1
2	B0266 01	Left PTO Arm	1
3	B0268 01	PTO Arm Brace	1
4	B0271 01	PTO Assembly Mount Rod	1
5	B0024 01	Cam Brkt. Stop Adj. Pl.	1
6	K1215	Flange Nut 3/8"-16	2
7	K1197	3/8"-16X21/2" HHCS	1
8	K1182	Carriage Bolt 3/8"-16x1"	5
9	K2038	Ny-Flange Lock Nut 3/8"-16	5

## **Exploded Parts View**

### **A1941\_01 PTO Base Assembly**

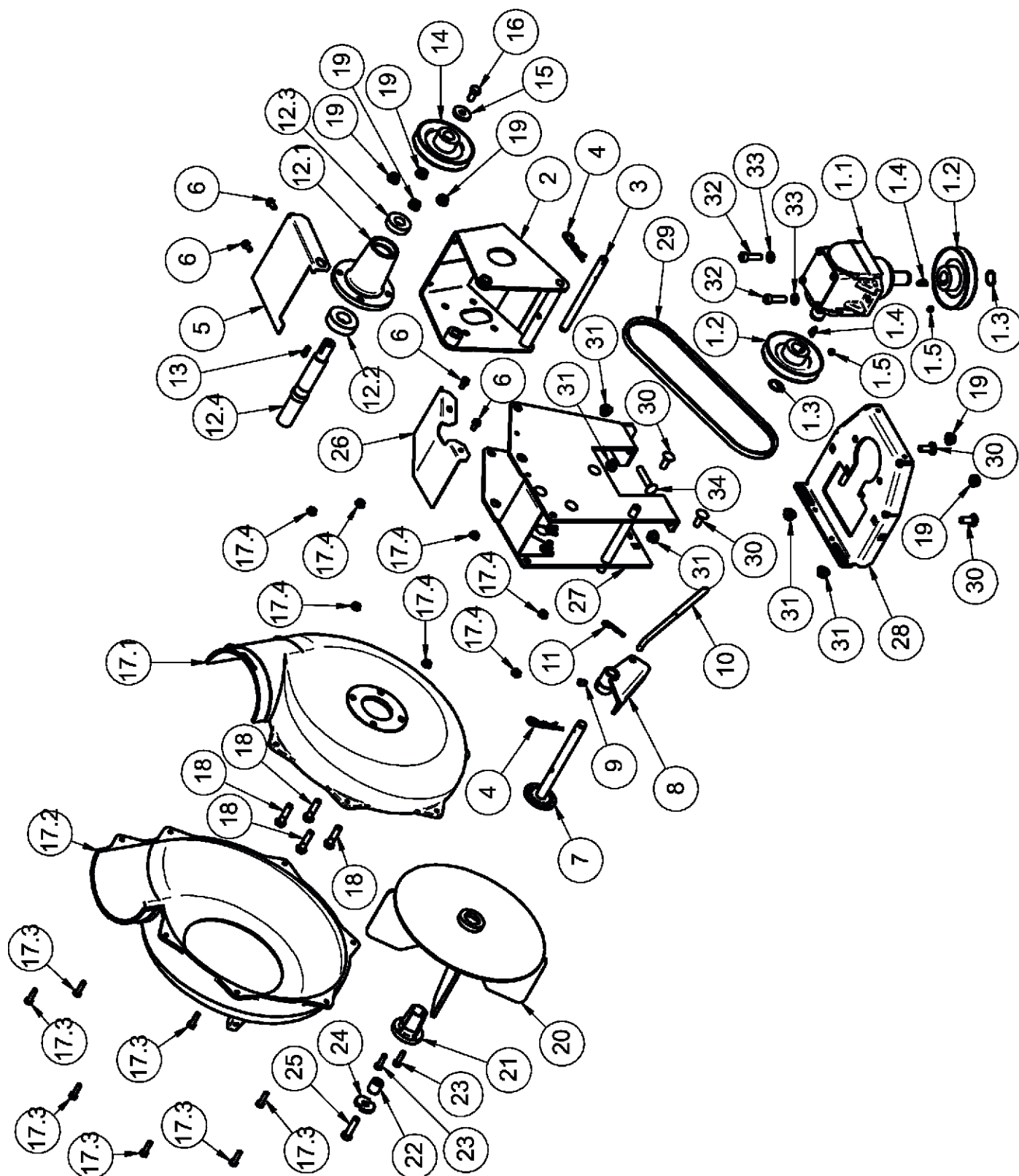

## **PTO Parts View/List**

### **A1941\_01 PTO Base Assembly**

Item#	Part#	Desc.	Qty.
1	A0429	Gear Box Assy.	1
1.1	A0431	Gearbox	1
1.2	A0498	Pulley Assy. / GearBox	2
1.3	K0360	Snap Ring / 7/8"Shaft	2
1.4	J0272	Woodruff Key #9	2
1.5	K0035	Set Screw 5/16" -18x1/4" CupPoint	2
2	A0144	Blower Mnt. Brkt. Assy.	1
3	B1755	BLOWER PIVOT ROD	1
4	K0086	Hair Pin Clip.125ODx2.50	2
5	B0121	Blower Belt Guard	1
6	K0353	HWHTCS 1/4" -20x1/2"	4
7	A0604	PTO HANDLE MOUNT ASSY	1
8	A0422	CAM BRACKET ASSEMBLY	1
9	K0356	3/8"-16 TAPERED SET SCREW	1
10	K0326	BELT TENSION ROD 3/8"-16	1
11	K0130	.091ODx1.625L HAIR PIN CLIP	1
12	A0306	PTO Shaft Assy.	1
12.1	E0121	PTO Shaft Housing	1
12.2	N0147	Bearing (2.0472OD,0.9843ID,0.5906W)	1
12.3	N0148	Bearing (1.625OD,0.750ID,0.4375W)	1
12.4	B1758	PTO Shaft	1
13	J0254	Key / 3/16" x3/16" x3/4"	1
14	M0228	Pulley / Impeller Shaft	1
15	K1446	PTO Housing Washer	1
16	K1190	HHCS / 3/8"-16x3/4"	1
17	E4004A	BLOWER HSG. ASSY.	1
17.1	E4004B	BLOWER HSG. BACK	1
17.2	E4004F	BLOWER HSG. FRONT	1
17.3	K1125	HHCS 1/4" -20X1" GR2	7
17.4	K1126	Flange Nut 1/4" -20	7
18	K1193	HHCS 3/8" -16X1-1/2"GR5	4
19	K1215	Flange Nut 3/8"-16	6
20	A0645	4-Blade Impeller Assy	1
21	S4302	TAPER - LOCK BUSHING	1
22	S3242	Spacer Bushing / .750IDx.380IDx.830L	1
23	K1225	HHCS 1/4" -20X1" GR8	2
24	K0278	Double Indented Washer 7/16"1.375ODx.440IDx.179T	1
25	K1211	3/8"-16x1-1/2"HHCS GR8	1
26	B0270	PTO Arm Guard	1
27	A1804_01	PTO Arm Assembly	1
28	A0624_01	Base Plate Assembly	1
29	M0250	A30K KEVLAR BELT	1
30	K1182	Carriage Bolt 3/8"-16x1"	4
31	K2038	Ny-Flange Lock Nut 3/8"-16	5
32	K0309	3/8"-16x1-1/4"SHCS	2
33	K0048	Lock Washer 3/8"	2
34	K1184	Carriage Bolt 3/8"-16x2"	1



## **PTO Parts View/List**

### **A0623 PTO Assembly**

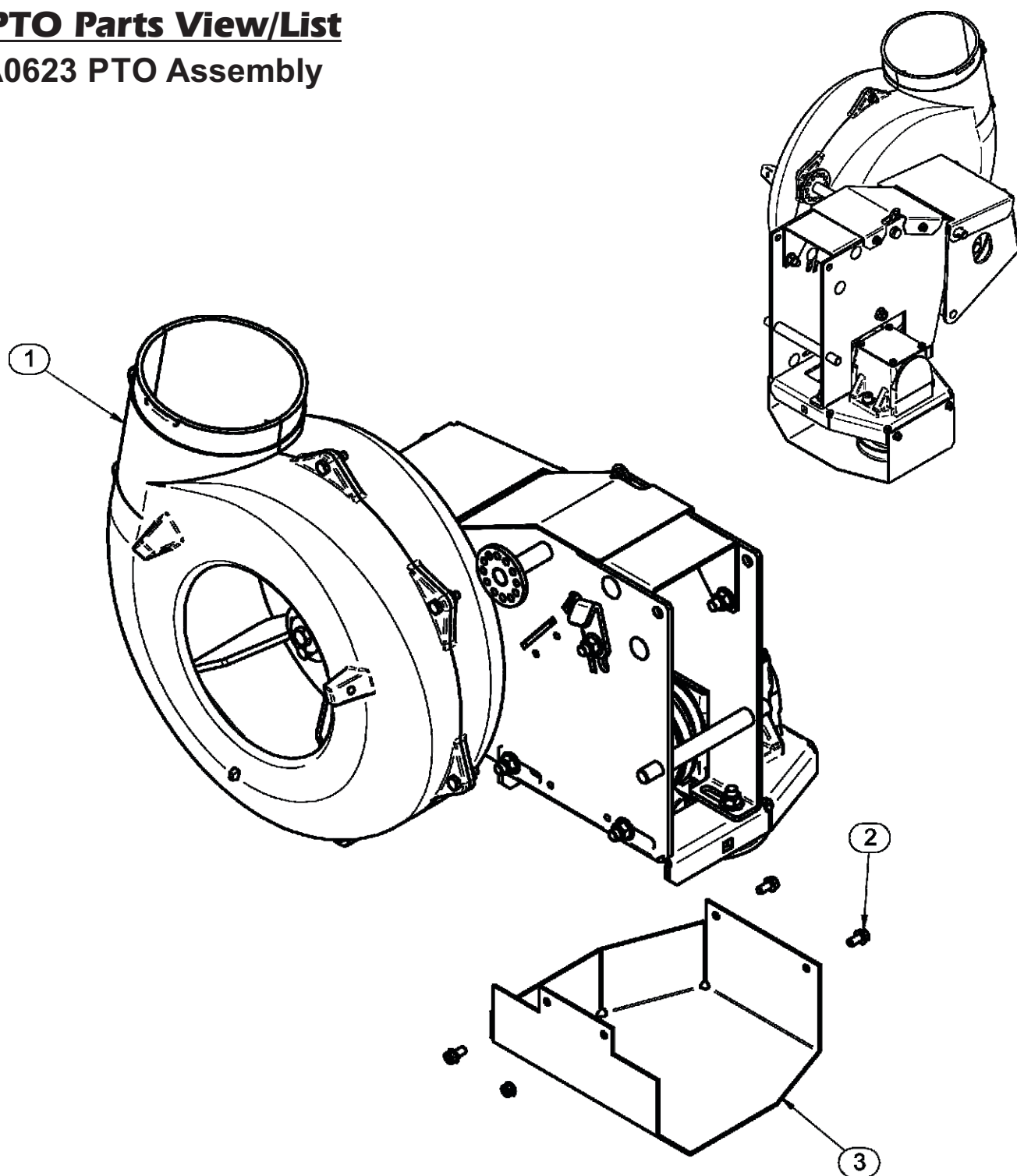

Item#	Part#	Desc.	Qty.
1	A1941_01	PTO Assy / Generic	1
2	K0353	HWHTCS 1/4"-20x1/2"	4
3	B0269	Small Pulley Guard	1

# **PTO Parts Exploded View/List**

## **A1950 PTO Assembly w/ Heat Guard**

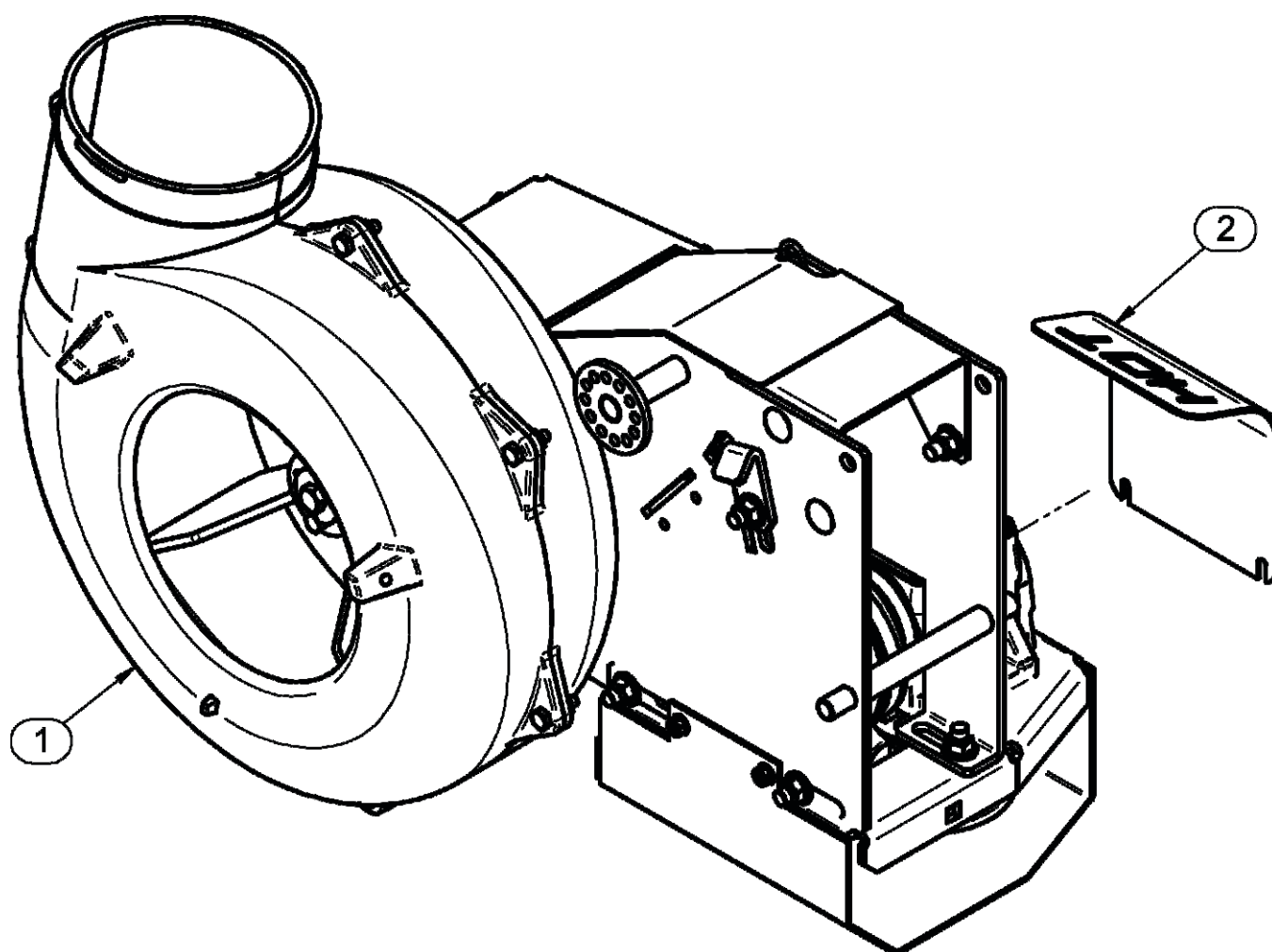

Item#	Part#	Description	Qty.	Rev#
1	A0623	PTO Assy / Small Pulley Guard	1	5
2	B0833	Gear Box Heat Guard	1	



Unit Model #: 49621204

Mower: Country Clipper

Owner's Manual: Q0484

Mower Type: Charger

Engine Type: Kawasaki FX801V & Kohler 27HP

Deck Size: 52" & 60"

Vac Type: Pro 12

Deck Type:

Drive Type: PTO-C (4-Blade)

Revision #: 2 - Updated Model Year - 9/6/2017 | Updated Weight Kit - 5/30/2018

Fits Year(s): 2013 - 2018

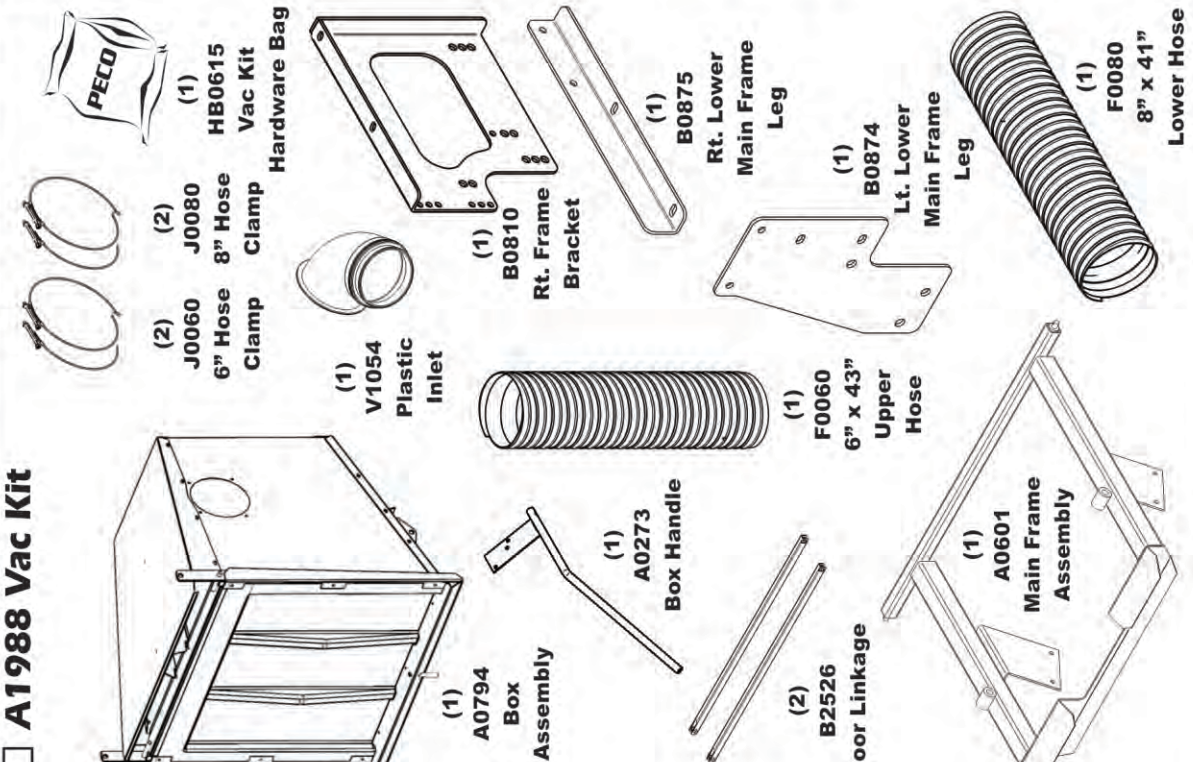
☐ **A1988 Vac Kit**

(1) A0794 Box Assembly

(1) A0273 Box Handle

(2) B2526 Door Linkage

(1) A0601 Main Frame Assembly

(1) F0060 6" x 43" Upper Hose

(1) B0874 Lt. Lower Main Frame Leg

(1) B0875 Rt. Lower Main Frame Leg

(1) F0080 8" x 41" Lower Hose

(1) B0810 Rt. Frame Bracket

(1) V1054 Plastic Inlet

(2) J0060 6" Hose Clamp

(2) J0080 8" Hose Clamp

(1) HB0615 Vac Kit Hardware Bag

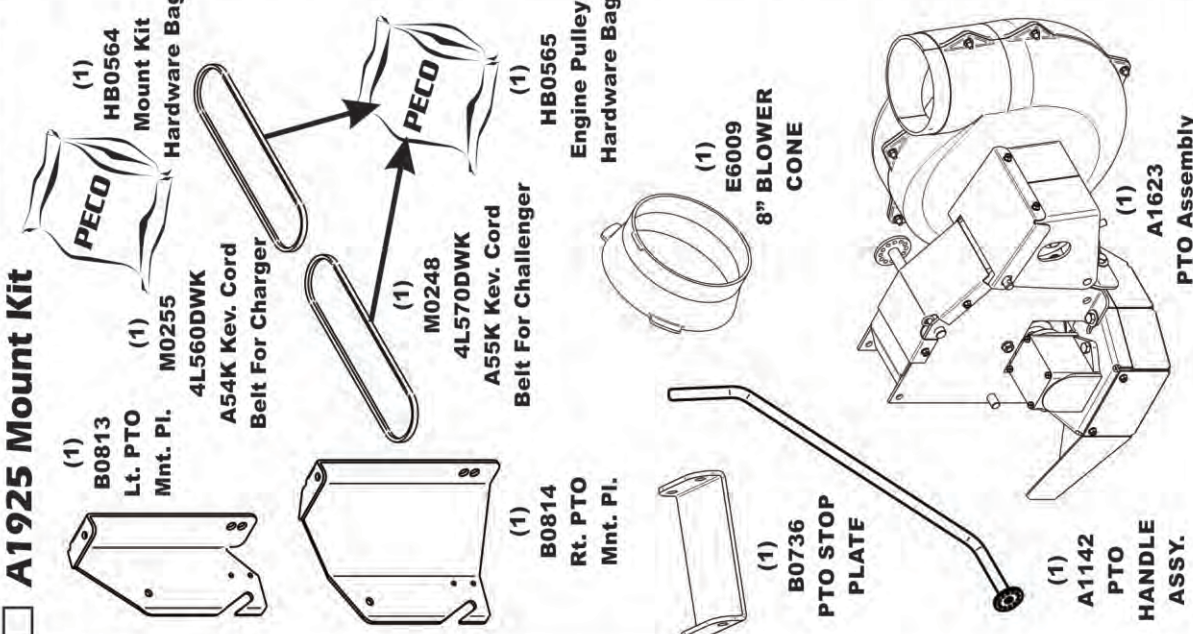
☐ **A1925 Mount Kit**

(1) B0813 Lt. PTO Mnt. Pl.

(1) M0255 4L560DVK A54K Kev. Cord Belt For Charger

(1) HB0564 Mount Kit Hardware Bag

(1) M0248 4L570DVK A55K Kev. Cord Belt For Challenger

(1) HB0565 Engine Pulley Hardware Bag

(1) E6009 8" BLOWER CONE

(1) B0736 PTO STOP PLATE

(1) A1142 PTO HANDLE ASSY.

(1) A1623 PTO Assembly

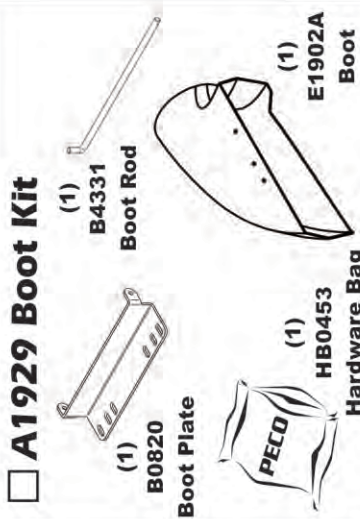
☐ **A1929 Boot Kit**

(1) B0820 Boot Plate

(1) HB0453 Hardware Bag

(1) E1902A Boot

☐ **A2162 Quad Weight Kit / Single Caster**

(4) Y0025 28 lb. Weight

(1) B1015 Weight Bracket Clamp

(1) HB0713 Hardware Bag

(1) B1063 Quad Weight Bracket Base

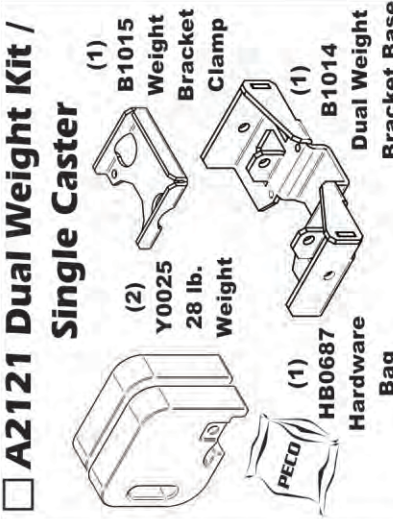
☐ **A2121 Dual Weight Kit / Single Caster**

(2) Y0025 28 lb. Weight

(1) B1015 Weight Bracket Clamp

(1) HB0687 Hardware Bag

(1) B1014 Dual Weight Bracket Base



## SECTION III

### OPERATING INSTRUCTIONS

#### General Safety

Only qualified people familiar with this operator's manual and the mower's operator's manual should operate this machine.

#### Operation And Tips On Mowing

- A. Perform BEFORE EACH USE the maintenance list referenced in Section IV.
- B. Start mower.
- C. With the mower at high idle speed, engage the mower deck.
- D. While seated in the operator's seat, move Bagger PTO switch to the on position. With the PTO assembly engaged, you can proceed to operate the control levers of the mower.

**NOTE:** If the collection system does not appear to be collecting the grass clippings, disengage the deck and PTO assembly, then, engage the parking brake and turn the mower off. Check upper and lower hoses for any clogs.

To obtain the maximum effectiveness from your collection system, the tips listed below should be followed:

- \* Watch your speed- Normal conditions will allow a speed of up to approximately 4 mph, but thick, heavy damp conditions will require reduced ground speed.
- \* Mow with sharp blades- A sharp blade cuts cleaner.
- \* Wet grass and leaves will decrease effectiveness and will increase horsepower requirements.
- \* Mow at higher cutting heights- Remove and mulch no more than 2" of grass length with each mowing. (Experts recommend not cutting off more than 1/3 of the grass blade length at any given time.)
- \* Mow twice, at different height settings, (high, then low), if grass is extra tall.
- \* Remember that horsepower requirements will vary with the mowing conditions such as type and height of turf grass, moisture content, amount of leaves, whether the terrain is flat or hilly, etc.

#### Disengagement Of The PTO Assembly

- A. To disengage the PTO assembly, move Bagger PTO switch to the off position.

**WARNING:** The PTO assembly blades will continue to spin. DO NOT TOUCH the PTO assembly, pulleys, or the belt until the tractor is turned off. DO NOT adjust the belt tension until the mower is turned off. Refer to the Belt Installation section of the manual.

#### Unloading The Collection System

**NOTE:** To determine when the collection bags are full, follow the following steps:

- A. Stop the forward movement of the mower.
- B. Disengage the mower deck.
- C. Disengage the PTO assembly.
- D. Engage the parking brake.
- E. Once the parking brake has been engaged, then and only then, walk behind the mower and check the collection bags by first unhooking the rubber strap with S-hook that secures the plastic top, then lift the plastic hood. Load in bags should not exceed the height of the installed bag.
- F. To remove the bags from the frame, slide bags out and turn bags over to deposit clippings.
- G. Slide empty bags back onto the frame and secure plastic top with the rubber strap with S-hook.

**NOTE:** Do not allow collection bags to become over-filled as potential damage may occur to your equipment. Also, be sure to clean the hood screen as needed.

## SECTION IV

### MAINTENANCE

#### Maintenance Checklist

Before each use:

- 1. Check blades and spindles to be sure that no foreign objects, such as wire or steel strapping bands, are wrapped around them.
- 2. Inspect blades for wear. Replace if necessary. If it is necessary to sharpen the blades, remove the blades from the spindles before sharpening. DO NOT sharpen blades while still attached to the mower.



3. Make sure all shields are in place and in good condition. Repair or replace any missing or damaged shields.
4. Perform lubrication per instructions.
5. Listen for abnormal sounds, which might indicate loose parts, damaged bearings, or other damage. Correct any deficiency before continuing operation.
6. With the engine off, engage the blower assembly. Check the belt tension and inspect the pulley belt for cracks or tears.
7. Check for wear or deterioration of the upper or lower hoses. If there are any portions of the hose that have been torn or worn through, replace immediately.

**After Each Use:**

1. Clean all debris from machine especially from the container, underneath the belt shields, and safety decals. Replace any missing or illegible decals.
2. Inspect the unit for worn or damaged components. Repair or replace before the next use. Any replacement component installed during repair shall include the component's current safety decal specified by the manufacturers to be affixed to the component.
3. Under normal usage, the bag material is subject to deterioration and wear and should therefore be frequently checked for necessary replacement. Any replacement bag should be checked to ensure compliance with the original manufacturer's recommendations or specifications.
4. Check belt for proper tension.

## 4-2 Lubrication

**Gearbox:**

**NOTE:** The gearbox is filled with 6.0 oz. of Mobilube HD Plus 80W-90 oil and permanently sealed. There is no need for scheduled lubrication. The oil level should only be checked if a leak is observed or if a change in gearbox noise is noticed.

Operators are recommended to check for leaks weekly. If a leak is observed, both the gasket and the seals are recommended to be replaced.

Replace the oil using 5.5 oz. of the recommended Mobilube HD Plus 80W-90 oil. Be sure to not overfill.

**Blower Assembly:**

**NOTE:** The following is for older PTO models that contain a greaseable zirc fitting. Newer models contain maintenance-free bearings and are without a greasable fitting.

1. On initial use: Grease the fitting on the blower shaft.
2. Every 25 hours of use: Re-grease the grease fitting.

**NOTE:** Use only white lithium based grease for lubrication of the shaft on the blower assembly.

## SECTION V - PARTS & SERVICE

### 5-1 Parts And Service Information

Collection system owners should record the name and telephone number of their Service Center. Your Service Center will be happy to supply replacement parts, accessories, and do any service or repairs to your collection system. If for any reason your Service Center is unable to service your collection system or supply replacement parts, contact New PECO, Inc. and include the following information on the chart below.

### DOCUMENT THE FOLLOWING INFORMATION FOR FUTURE REFERENCE

**Unit Model Number:** \_\_\_\_\_

**Unit Engine Size:** \_\_\_\_\_

**Unit Serial Number:** \_\_\_\_\_

**Date of purchase:** \_\_\_\_/\_\_\_\_/\_\_\_\_

**Dealer/Distributor Name:** \_\_\_\_\_

**Address:** \_\_\_\_\_ **State:** \_\_\_\_\_ **Zip:** \_\_\_\_\_

**Phone Number:** \_\_\_\_\_

**New PECO, Inc.**

**10 Walden Dr | Arden, North Carolina 28704**

**Phone: 1-800-438-5823 | 828-684-1234**

**Fax: 828-684-0858**

**Email: [peco@lawnvac.com](mailto:peco@lawnvac.com)**

**Website: [www.lawnvac.com](http://www.lawnvac.com)**

## SAFETY DECALS

To promote safe operation, PECO supplies safety decals on all products manufactured. Damage can occur to safety decals either through shipment, use or reconditioning. Contact your local Service Center for replacement decals.



# R2008



# R2007



Part #: R1049  
Operation



Part #: R1069  
Warning - Turn Off Blower



Part #: R1053  
Caution - Keep Hands  
And Body Clear



Part #: R1055  
Dump Grass

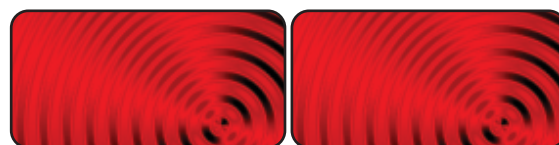

Part #: R1057  
Red Reflector Label

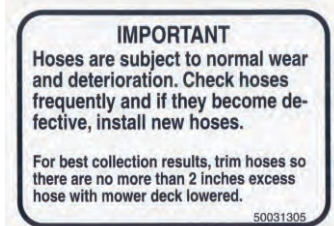

Part #: R1054  
Important - Hose Wear



Part # R0024  
Danger - Keep Hands  
Clear



Part# R0022  
Designed & Built  
In The USA



Part #: R4008  
Caution - Rotating Blades!



Part # R0025  
Danger - Rotating  
Blades



Part #: R1051  
Warning - Hearing Protection



Part #: R1083  
Engage/Disengage



Part #: R1070  
PECO Logo

# TORQUE SPECIFICATIONS

Proper torque for American fasteners used on equipment.  
Recommended Torque in Foot Pounds (Newton Meters).\*

## AMERICAN Bolt Head Markings

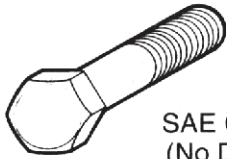

SAE Grade 2  
(No Dashes)

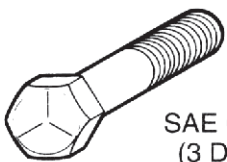

SAE Grade 5  
(3 Dashes)

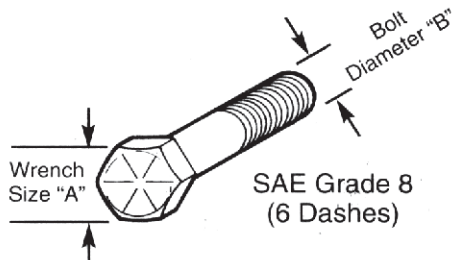

SAE Grade 8  
(6 Dashes)

WRENCH SIZE (IN.) "A"	BOLT DIAMETER (IN.) "B" AND THREAD SIZE	SAE GRADE 2	SAE GRADE 5	SAE GRADE 8
7/16	1/4 - 20 UNC	6 (7)	8 (11)	12 (16)
7/16	1/4 - 28 UNF	6 (8)	10 (13)	14 (18)
1/2	5/16 - 18 UNC	11 (15)	17 (23)	25 (33)
1/2	5/16 - 24 UNF	13 (17)	19 (26)	27 (37)
9/16	3/8 - 16 UNC	20 (27)	31 (42)	44 (60)
9/16	3/8 - 24 UNF	23 (31)	35 (47)	49 (66)
5/8	7/16 - 14 UNC	32 (43)	49 (66)	70 (95)
5/8	7/16 - 20 UNF	36 (49)	55 (75)	78 (106)
3/4	1/2 - 13 UNC	49 (66)	76 (103)	106 (144)
3/4	1/2 - 20 UNF	55 (75)	85 (115)	120 (163)
7/8	9/16 - 12 UNC	70 (95)	109 (148)	153 (207)
7/8	9/16 - 18 UNF	79 (107)	122 (165)	172 (233)
15/16	5/8 - 11 UNC	97 (131)	150 (203)	212 (287)
15/16	5/8 - 18 UNF	110 (149)	170 (230)	240 (325)
1-1/8	3/4 - 10 UNC	144 (195)	266 (360)	376 (509)
1-1/8	3/4 - 16 UNF	192 (260)	297 (402)	420 (569)
1-5/16	7/8 - 9 UNC	166 (225)	430 (583)	606 (821)
1-5/16	7/8 - 14 UNF	184 (249)	474 (642)	668 (905)
1-1/2	1 - 8 UNC	250 (339)	644 (873)	909 (1232)
1-1/2	1 - 12 UNF	274 (371)	705 (955)	995 (1348)
1-1/2	1 - 14 UNF	280 (379)	721 (977)	1019 (1381)
1-11/16	1-1/8 - 7 UNC	354 (480)	795 (1077)	1288 (1745)
1-11/16	1-1/8 - 12 UNF	397 (538)	890 (1206)	1444 (1957)
1-7/8	1-1/4 - 7 UNC	500 (678)	1120 (1518)	1817 (2462)
1-7/8	1-1/4 - 12 UNF	553 (749)	1241 (1682)	2013 (2728)
2-1/16	1-3/8 - 6 UNC	655 (887)	1470 (1992)	2382 (3228)
2-1/16	1-3/8 - 12 UNF	746 (1011)	1672 (2266)	2712 (3675)
2-1/4	1-1/2 - 6 UNC	870 (1179)	1950 (2642)	3161 (4283)
2-1/4	1-1/2 - 12 UNF	979 (1327)	2194 (2973)	3557 (4820)

## METRIC

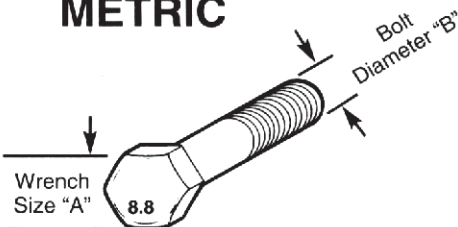

Numbers appearing on bolt heads  
indicate ASTM class.

Proper torque for metric fasteners used on equipment.  
Recommended torque in foot pounds (newton Meters).\*

WRENCH SIZE (mm) "A"	BOLT DIA. (mm) "B"	ASTM 4.6	ASTM 8.8	ASTM 9.8	ASTM 10.9
8	5	1.8 (2.4)		5.1 (6.9)	6.5 (8.8)
10	6	3 (4)		8.7 (12)	11.1 (15)
13	8	7.3 (10)		21.1 (29)	27 (37)
16	10	14.5 (20)		42 (57)	53 (72)
18	12	25 (34)	74 (100)	73 (99)	93 (126)
21	14	40 (54)	118 (160)	116 (157)	148 (201)
24	16	62 (84)	167 (226)	181 (245)	230 (312)
30	20	122 (165)	325 (440)		449 (608)
33	22		443 (600)		611 (828)
36	24	211 (286)	563 (763)		778 (1054)
41	27		821 (1112)		1138 (1542)
46	30	418 (566)	1119 (1516)		1547 (2096)

\*Use 75% of the specified torque value for plated  
fasteners. Use 85% of the specified torque  
values for lubricated fasteners.

## NOTES





**100 AIRPORT ROAD  
ARDEN, NORTH CAROLINA 28704  
(800) 438-5823 OR (828) 684-1234 FAX: (828) 684-0858  
EMAIL: [peco@lawnvac.com](mailto:peco@lawnvac.com)  
WEBSITE: [www.lawnvac.com](http://www.lawnvac.com)**