

# EASY DUMP BAGGING SYSTEM

MODEL# EDBS



DESIGNED FOR THE BOSS AND CHARGER SERIES



## OPERATOR'S MANUAL

ASSEMBLY ● OPERATION ● MAINTENANCE

MANUAL#: Q0417

Revision: 3 - 06/18/2018

PART# 629FR-001A

# GRASS COLLECTION SYSTEM

## TABLE OF CONTENTS

SECTION	PAGE	SECTION	PAGE
Safety - - - - -	2	2-13 Blower Cone Installation - - - - -	15
Safety Alert Symbols - - - - -	3	2-14 Impeller Blade Removal/Replacement - - - - -	15
Warranty - - - - -	4	2-15 Boot To Mower Deck Installation - - - - -	16
I INTRODUCTION AND DESCRIPTION - - - - -	5	2-16 Length Of Hose Adjustment - - - - -	16
1-1 Introduction - - - - -	5	2-17 Upper Hose Installation - - - - -	16
1-2 Description - - - - -	5	2-18 Lower Hose To Blower Cone Installation - - - - -	16
II INSTALLATION FOR USE - - - - -	5	2-19 Lower Hose To Boot Installation - - - - -	16
2-1 Preparation Of Mower - - - - -	5-6	2-20 Front Weight Installation - - - - -	17
2-2 Right PTO Mount Plate Assembly Installation - - -	6	III OPERATING INSTRUCTIONS - - - - -	18
2-3 Left Mount Plate Installation - - - - -	6	3-1 General Safety - - - - -	18
2-4 Rear Mount Plate and Main Frame Assembly Installation - - - - -	6	3-2 Operation & Tips On Mowing - - - - -	18
2-5 Universal PTO Installation - - - - -	7	3-3 Disengagement Of The Blower - - - - -	18
2-6 PTO Handle Installation - - - - -	7	3-4 Unloading The Collection System - - - - -	18
2-7 Belt Installation - - - - -	7	IV MAINTENANCE - - - - -	18
2-8 Lift Handle Installation - - - - -	8	4-1 Maintenance Checklist - - - - -	18
2-9 Exhaust Diverter Installation - - - - -	9	4-2 Lubrication - - - - -	19
2-10 Cam Assembly Adjustment - - - - -	9	V PARTS AND SERVICE - - - - -	19
2-11 Aluminum Grass Container Installation - - - - -	9	5-1 Parts And Service Information - - - - -	19
2-12 Dump Mechanism Adjustment - - - - -	9	Safety Decals - - - - -	20
Exploded Views and Part Drawings - - - - -	10-14	Torque Specifications - - - - -	21

## SAFETY

1. Read the operator's manual carefully and familiarize yourself with the proper use of your attachment. Do not allow anyone who is not acquainted with the Safety Instructions to use your attachment.
2. Know the controls and how to stop them quickly. **READ THE OPERATOR'S MANUAL!**
3. Do not allow children to operate the machine. Do not allow adults to operate it without proper instruction.
4. Be especially watchful of children and pets entering into the area while operating.
5. Keep your eyes and mind on your machine while mowing or operating your attachment. Don't let others distract you.
6. Do not attempt to operate your machine when not in the driver's seat.
7. Always shut off blades and engine when emptying the container.
8. Stop machine, shut off deck attachment, set parking brake, shut off engine and remove ignition key before removing clogs, removing or replacing hose, boot, blower cone, or performing any maintenance.
9. Mow across the face of slopes (not more than 10 degrees); never up and down the face.
10. It is recommended that the container be emptied when half full while operating on slopes. Start mowing on slopes when the container is empty.
11. Inspect your lawn and remove any foreign objects before mowing. Never deliberately run the mower across any foreign object.
12. Wear hearing protection.
13. Wear eye protection to prevent debris from getting into your eyes.

# SAFETY

**WARNING!** **NEVER** operate the mower unless the discharge guard and either the deflector assembly or the vacuum collector adapter are fastened securely in place.

**WARNING!** Do not work around the mower deck boot or the blower area until you are certain that the mower blades and the blower impeller have stopped rotating.

**WARNING!** To avoid serious injury, perform maintenance on the vacuum collector; **ONLY AFTER STOPPING THE MOWER'S ENGINE AND WAITING FOR ALL MOVING PARTS TO COME TO A COMPLETE STOP.** Set the parking brake. Always remove the ignition key before beginning maintenance.

**WARNING!** For your own personal safety, **ALWAYS** mow **ACROSS** the face of slopes and **NEVER UP** and **DOWN** the face. **NEVER** attempt to mow excessively steep slopes, and use caution when turning on any slope.

## Safety Alert Symbol



This Safety Alert Symbol means: **“ATTENTION! BECOME ALERT! YOUR SAFETY IS INVOLVED!”**

This symbol is used to call attention to safety precautions that should be followed by the operator to avoid accidents. When you see this symbol, carefully read the message that follows and heed its advice. Failure to comply with safety precautions could result in death or serious bodily injury.

## Safety Signs

The signal words **DANGER**, **WARNING**, and **CAUTION** are used on the equipment safety signs. These words are intended to alert the viewer to the existence and the degree of hazard seriousness.



White letters on **RED**

This signal word indicates a potentially hazardous situation which, if not avoided, will result in death or serious injury.



Black letters on **ORANGE**

This signal word indicates a potentially hazardous situation which, if not avoided, could result in death or serious injury.

It may also be used to alert against unsafe practices.



Black letters on **YELLOW**

This signal word indicates a potentially hazardous situation which, if not avoided, will result in minor or moderate injury.

It may also be used to alert against unsafe practices.

# PECO LIMITED WARRANTY FOR NEW PRODUCTS

## A. WHAT IS UNDER WARRANTY?

PECO extends the following warranties to the original purchaser of each new PECO consumer product subject to the following limitations.

**1. PRODUCT WARRANTY:** Any part of any consumer product, which is defective in material or workmanship as delivered to the purchaser will be repaired or replaced, as PECO elects, without charge for parts or labor, if the defect appears within 12 months from the date of delivery of the product to the original purchaser. ALL DEFECTIVE PARTS MUST BE RETURNED TO PECO FOR INSPECTION TO DETERMINE VALIDITY OF WARRANTY CLAIMS. Freight and mailing will be borne by the customer.

**2. PARTS REPLACED DURING WARRANTY:** Any new PECO part which is furnished in performance of this warranty and is defective in material or workmanship as delivered to the purchaser will be repaired or replaced, before the expiration of the original warranty period, whichever is later.

**3. COMMERCIAL USE:** Products put to personal use around a single household or residence is considered 'Residential'; Products put to any business use (agricultural, commercial, or industrial) or used at multiple locations is considered 'Commercial.' Products designated as 'Commercial' are warrantied for 12 months from the date of delivery of the product to the original purchaser when used for in commercial applications. Products designated as 'Residential' are warrantied for 90 days from the date of delivery of the product to the original purchaser when in commercial applications.

## B. SECURING WARRANTY ADJUSTMENTS

Call PECO for Return Authorization. Damaged or broken parts other than engines or batteries, must be returned to New PECO, Inc. at 10 Walden Drive, Arden, NC 28704 before any warranty adjustment can be authorized. At the time of requesting warranty adjustment, the purchaser must present evidence of the date of delivery of the product. The purchaser shall pay any charge for the product to and from Arden, NC.

## C. ITEMS NOT COVERED BY PECO WARRANTY

Engines and batteries attached to PECO products are covered under a separate warranty by the respective manufacturer.

## D. UNAPPROVED ALTERATION OR MODIFICATION

All obligations of New PECO, Inc. under this warranty shall be terminated if products are altered or modified in ways not approved by New PECO, Inc.

## E. ACCIDENTS AND NORMAL MAINTENANCE

The warranty covers only defective material and workmanship. It does not cover depreciation or damage caused by normal wear, accident, improper use or abuse of products. The cost of normal maintenance and normal replacement of service items such as belts, cutting blades, hoses, etc., which are not defective shall be paid for by the purchaser.

## F. NO REPRESENTATIONS ADDITIONAL WARRANTIES, DISCLAIMER

Neither New PECO, Inc. nor any company affiliated with it makes any warranties, representations or promises as to the quality of performance of its products other than those set forth herein. Except as described above, New PECO, Inc. makes no other warranties AND SPECIFICALLY DISCLAIMS ANY AND ALL IMPLIED WARRANTIES OF FITNESS AND MERCHANTABILITY.

## G. PRODUCTS USED FOR RENTAL OR LEASE PURPOSES ARE WARRANTIED FOR 45 DAYS FROM DATE OF ORIGINAL SALE ONLY

## H. REMEDIED EXCLUSIVE

The only remedies the purchaser has in connection with the breach or performance of any warranty on New PECO, Inc. consumer products are set forth above. In no event will PECO be liable for special incidental or consequential damages.

### 1. NO SERVICE CENTER WARRANTY

The selling Service Center makes no warranty on his own on any item warranted by New PECO, Inc. unless he delivers to purchaser a separate written warranty certificate specifically warranting the item. The dealer has no authority to make any representation or promise on behalf of PECO or to modify the terms of this warranty in any way.



# SECTION I

## INTRODUCTION AND DESCRIPTION

### 1-1 Introduction

Your grass collection system has been designed to give you a low maintenance, simple and effective way to collect the grass clippings from your mower. This manual is provided to give you the necessary instructions to properly mount and operate the collection system on your mower. Please read this manual thoroughly. Understand what each control is for and how to use it. Observe all safety decal precautions on the machine and noted throughout the manual.

**NOTE:** all references made to right, left, front, rear, top or bottom are as viewed from the normal operator's position on the mower.

### 1-2 Description

The grass collection system is designed for turf maintenance where there is a need to collect the grass clippings as the mower cuts the turf. It is also used for picking up leaves and twigs in pre-season and post-season clean-up.

The blower, mounted on the right side of the unit, uses a belt and gearbox system from the engine PTO shaft. Drive train protection comes through belt slippage. The blower draws grass clippings from the discharge area of the cutter deck up to the aluminum container mounted over the rear portion of the mower frame. The operator can engage the blower with a push of the over-center linkage on the right side of the unit. Once the container is full of clippings, the operator can easily push and raise the lift handle, releasing the container's rear door and the container will pivot towards the ground.

## Section II

### INSTALLATION FOR USE

#### 2-1 Preparation Of Mower

Carefully dismantle the wooden shipping crate from around the components. Cut the retaining straps and separate the parts. The grass collection system will have various parts located inside. Remove and sort all parts for easy identification.

**NOTE:** Before each step of assembly it will help to study the exploded drawings on pages 10 through 14. From the underside of the engine remove the bolt and bushing from the electric clutch assembly. It will help to use a bungee cord or similar device to hold the electric clutch in place during this step.

For 25HP Kawasaki or 23,27,28,& 30HP Kohler, replace these parts with the engine pulley assembly number 6 P#(A0611), 7/16" lock washer P#(K0140), and 7/16"-20 x 3-3/4" hex bolt P#(K0350). For 31HP Kawasaki, use engine pulley assembly number 6 P#(A0611), 7/16" lock washer P#(K0140), and 7/16"-20 x 3-1/4" hex bolt P#(K0351). For 26HP Kawasaki, use engine pulley assembly number 6 P#(A0611), 7/16" lock washer P#(K0140), and M10-1.5MM x 100MM hex bolt P#(K0398). For 35HP & 37HP Kawasaki, use engine pulley assembly number 22 P#(A1174), 7/16" lock washer P#(K0140), 7/16"-20 x 2-3/4" hex bolt P#(K0397) and 1/4" x 1/4" x 1-1/2" keystock P#(K1623). The added pulley will power the collection system. Note that the center of the hub that is extended, should be upward toward the engine (Figure 2-1a). Torque the bolt to 55 ft./lbs.

Figure 2-1a

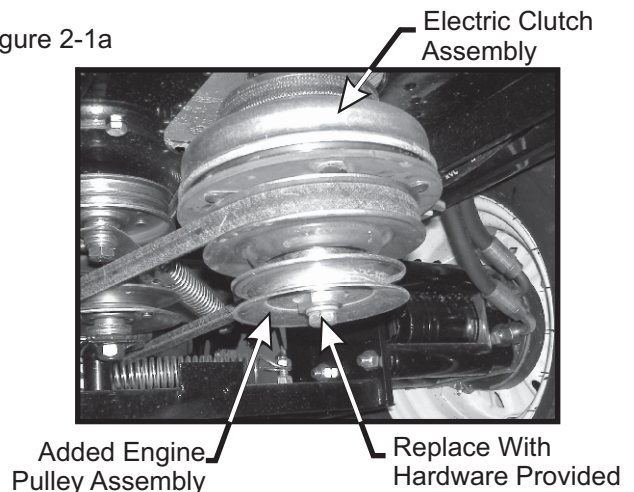

### Removing The Rear Panel Guard

The rear panel guard and existing hardware must be removed from the rear frame of the mower. Refer to Figure 2-1b.

Figure 2-1b

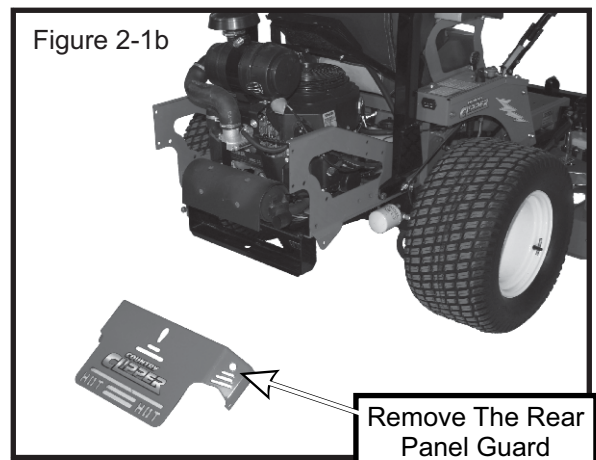

## Rotating The Donaldson Air Cleaner

**Note:** If equipped with a Donaldson air cleaner, unit must be rotated to make clearance for top main frame assembly. To rotate the Donaldson air cleaner, loosen the bolt on the air cleaner bracket, rotate the air cleaner forward as needed for clearance as shown in Figure 2-1c and tighten.

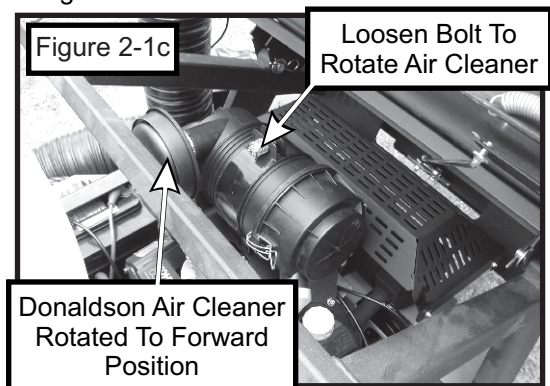

## 2-2 Right PTO Mount Plate Assembly Installation

Fasten the right PTO mount plate assembly P#(A1230) to the right panel guard using (2) 1/2"-13 x 1-1/2" HHCS and P#(K1233) and (2) 1/2"-13 nyloc nut P#(K1247), as shown in Figure 2-2.

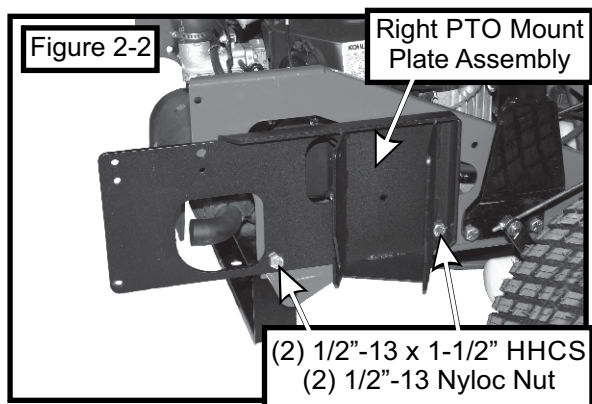

## 2-3 Left Mount Plate Installation

Fasten the left mount plate P#(B0661) to the left panel guard (2) 1/2"-13 x 1-1/2" HHCS and P#(K1233) and (2) 1/2"-13 nyloc nut P#(K1247), as shown in Figure 2-3.

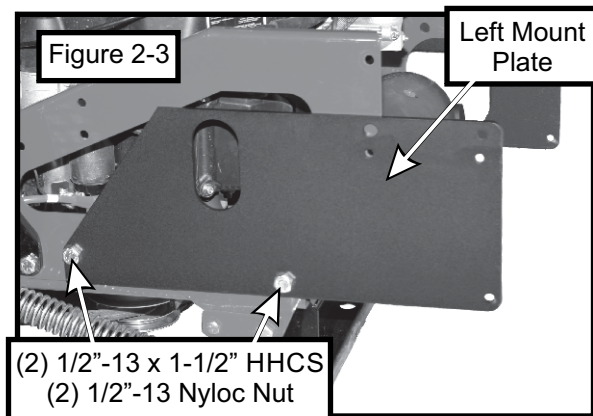

## 2-4 Rear Mount Plate and Main Frame Assembly Installation

**NOTE:** It is recommended that you have someone assist you during this step of the installation.

Lift the rear mount plate P#(B0350) into position as shown in Figure 2-4a. Secure the bottom two holes on the rear mount plate to left and right mount plates using (2) 3/8"-16 x 1-1/2" HHCS P#(K1193) and (2) 3/8"-16 nyloc nut P#(K1216). Secure the main frame assembly P#(A1231) to the left and right mount plates, using (4) 3/8"-16 x 1-1/2" HHCS and (4) 3/8"-16 nyloc nut. The

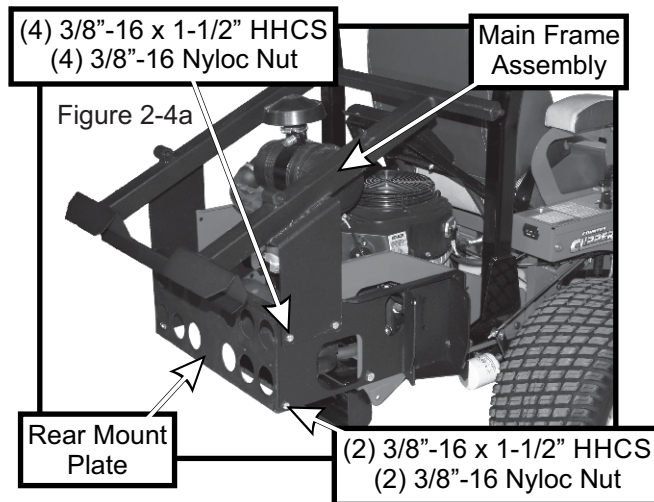

The Boss and Charger series have different mounting holes for the main frame assembly. Use Figure 2-4b to determine the correct mounting holes for your mower. The Boss series will use the top mounting holes for the main frame assembly. The Charger series will use the bottom mounting holes for the main frame assembly.

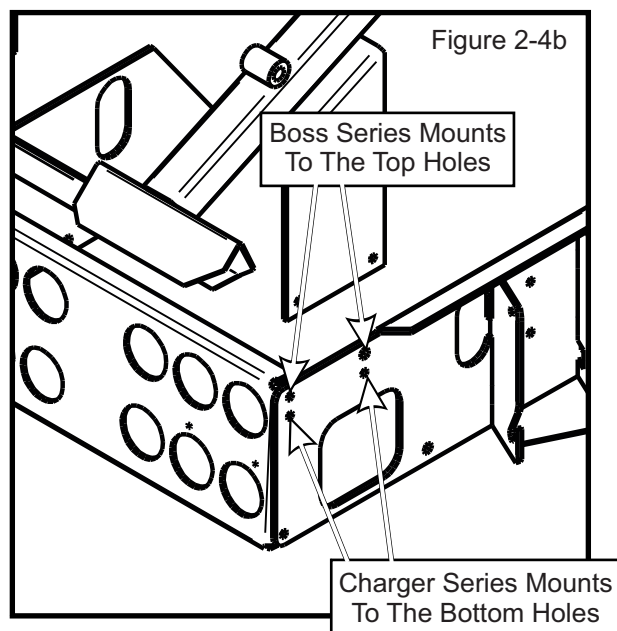



## 2-5 Universal PTO Installation

To mount the PTO assembly, insert the pivot rod on the PTO assembly P#(A0623) into the mounting slots located on the right PTO mount plate assembly P#(A1230). Tilt the PTO assembly upward and insert the PTO mount pin P#(B0274) through the hole in the top of the right PTO mount plate assembly. Secure the PTO mount pin using 1/8" x 2-3/8" hair pin clip P#(K0086) as shown in Figure 2-5.

Figure 2-5

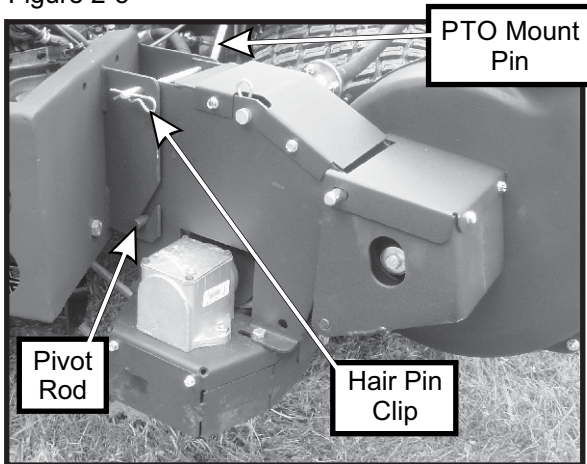

## 2-6 PTO Handle Assembly Installation

Mount the PTO handle assembly P#(A0603) to the universal PTO P#(A0623) using (3) 1/4"-20 x 3/4" HHCS P#(K1222) and (3) 1/4"-20 nyloc nuts P#(K1128). Before fastening, make sure that there is room for the handle to engage and disengage without the handle hitting the mower's fuel tank. Attach the handle grip P#(V1151) to the PTO handle assembly. See Figure 2-6 for reference.

Figure 2-6

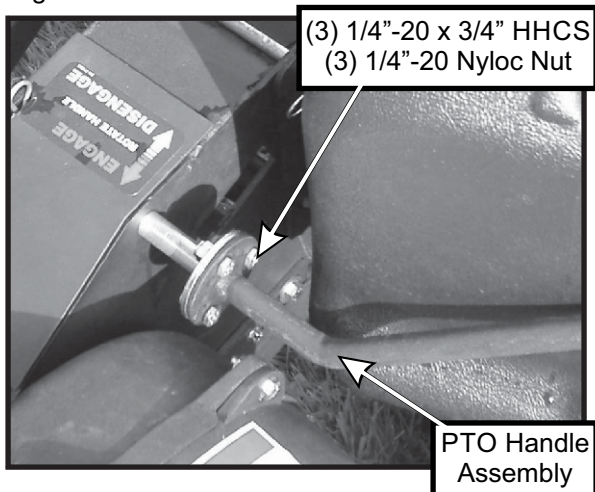

## 2-7 Belt Installation

Remove the belt guard. Loosen the (4) bolts P#(K1191), (2) on each side, that secure the gear box assembly to the PTO assembly P#(A0623) (Figure 2-7a and 2-7b). Loosen the adjustment bolt P#(K0348) until the gear box assembly is at its far left adjustment (the gear box is moved toward the mower's engine pulley). Connect the kevlar cord belt A50K P#(M0241) from the engine pulley to the lower gear box pulley (Figure 2-7c). To tension the drive belt, turn the adjustment bolt clockwise until there is 1" of deflection, with 10-11 lbs. of pressure, at the center of the belt between the engine pulley and the gear box pulley. Once the correct tension of the belt is achieved, tighten the (4) bolts that secure the gear box assembly. Replace the belt guard.

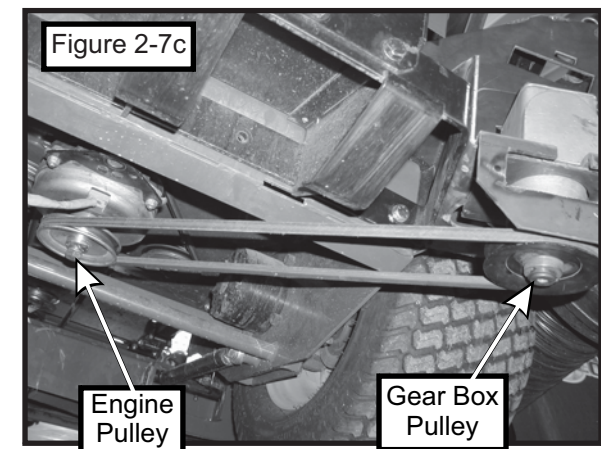
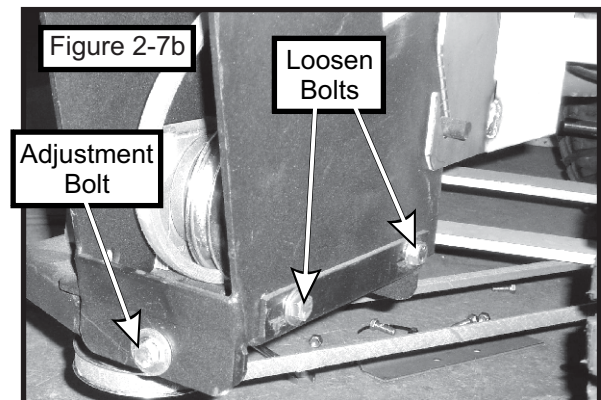
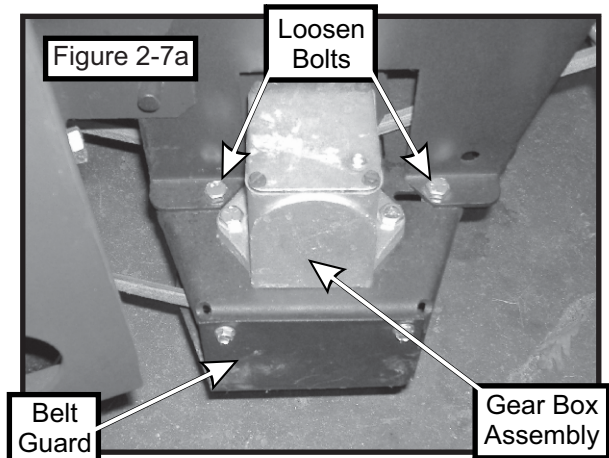

## 2-8 Lift Handle Installation

**NOTE:** Before continuing the lift handle installation, have someone assist you in turning the grass container upside down.

Insert (1) 3/8"-16 x 2" HHCS P#(K1208) into the lift handle P#(A0273), and secure with (1) 3/8"-16 flange nut P#(K1215). Thread the flange nut onto the bolt upside down, as shown in Figure 2-8a.

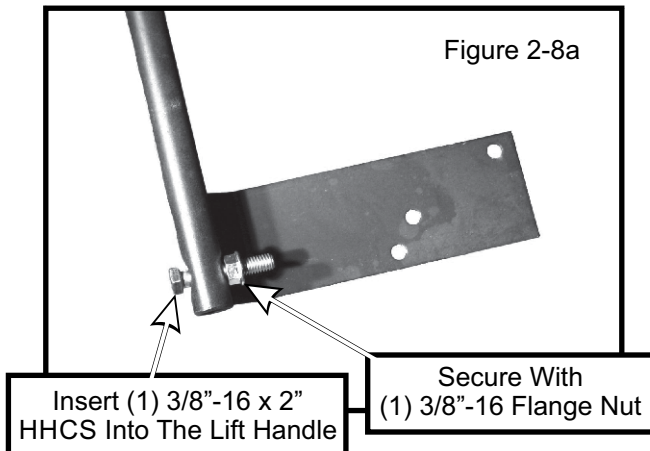

Slide the lift handle through the slot on the handle mount bracket. Insert the lift handle into the box frame as shown in Figure 2-8b, and secure using (1) 3/8"-16 flange nut P#(K1215) on the inside of the container as shown in Figure 2-8c.

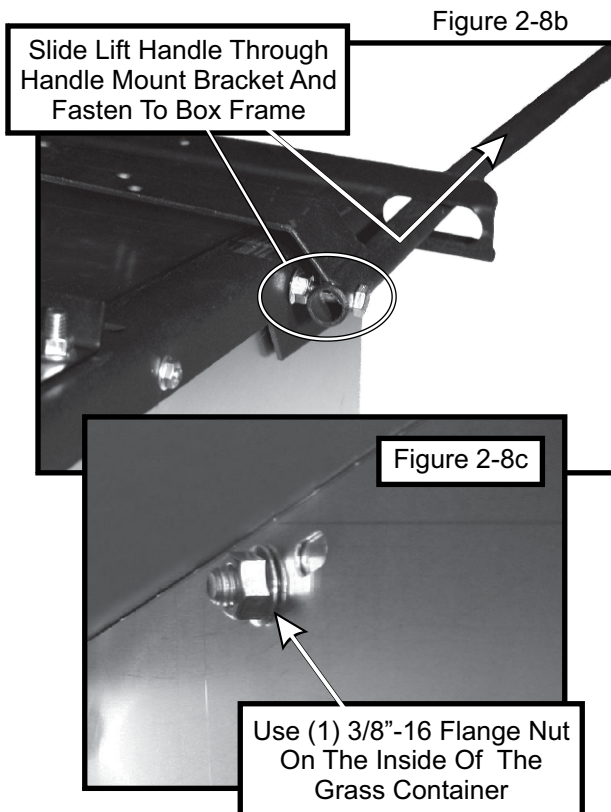

Fasten the ball joint P#(K1442) to the end of the latch rod P#(A0620). Tighten the ball joint to approximately half way down the threads on the latch rod. Attach the ball joint to the latch hook as shown in Figure 2-8d, using (1) 5/16"-24 hex nut P#(K1444) and (1) 5/16" lock washer P#(K0043).

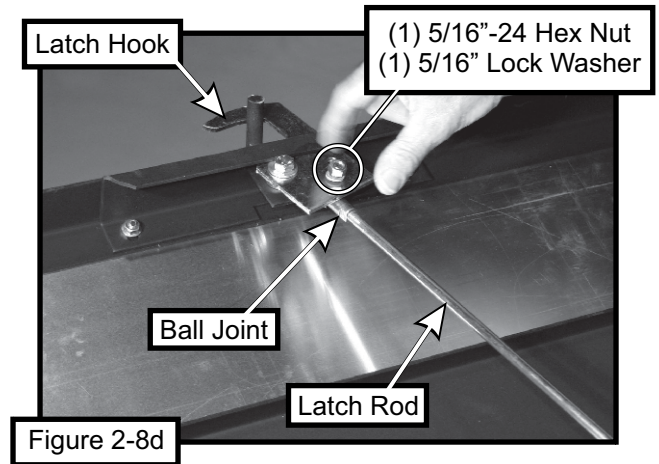

Attach the other end of the latch rod to the lift handle, as shown in Figure 2-8e. Attach one end of the spring P#(J0176) to the lift handle and the other end of the spring to the handle mount bracket as shown in Figure 2-8f. Adjust the ball joint up or down on the latch rod threads until the latch hook closes completely. After adjusting the latch hook, secure the latch rod to the lift handle using (1) cotter pin P#(K0094).

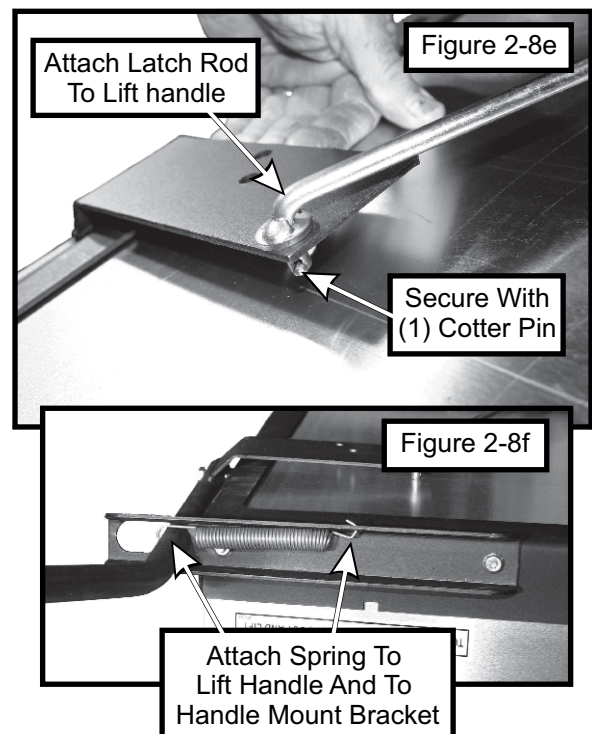



## 2-9 Exhaust Diverter Installation

In order to divert the engine exhaust away from the PTO assembly, an exhaust diverter must be installed. Remove any existing exhaust diverter. Insert the diverter through the hole on the right PTO mount plate assembly. Fasten the exhaust diverter P#(J0282) to the muffler using the exhaust clamp P#(X1064). See Figure 2-9. for reference.

**NOTE:** All engines that divert exhaust to the left will not require an exhaust diverter.

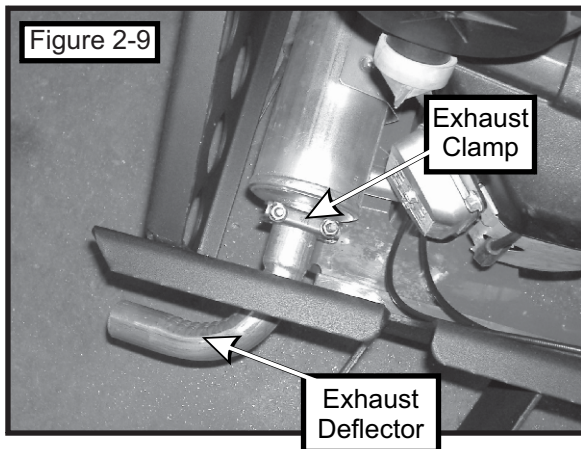

## 2-10 Cam Assembly Adjustment

The cam assembly P#(A0422), which controls the blower belt tension, comes from the factory pre-adjusted. If the belt is too tight or becomes too loose, remove the hair pin clip P#(K0130) from the belt tension rod P#(K0326) and pull the "L" end of the rod out of its hole in the cam assembly. The tension rod may then be screwed out to tighten the belt or screwed in to loosen the belt. Replace the "L" end into the top hole in the cam and replace the hair pin clip. Adjust the cam stop bolt P#(K1159) to allow the cam to rotate slightly over center when the blower is engaged (Figure 2-10).

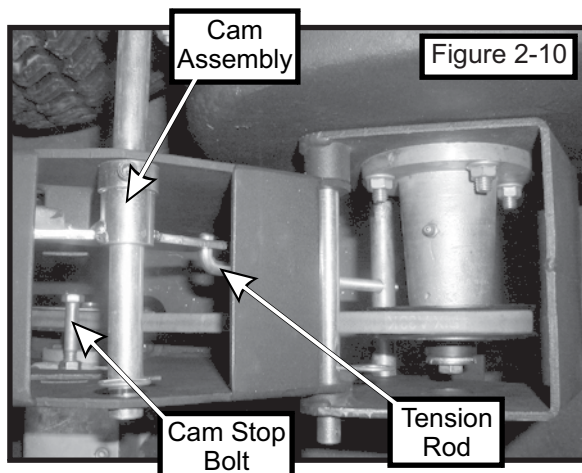

## 2-11 Aluminum Grass Container Installation

**NOTE:** It is recommended that (3) people assist in mounting the container. With three people available, two can lower the container onto the frame while the third person inserts the pivot pins P#(K0172) through the holes. Insert the pins from the outside to the inside. Secure with (1) 5/8" washer P#(K0058) and (1) 5/32" x 2-5/8" hair pin clip P#(K0088) per pivot pin (Figure 2-10). Reattach the bottom ends of the door opening linkages to the main frame by using (1) Rue-Ring cotter pin P#(K1437) per side. To test the functionality of the dump mechanism, pull the lift handle away from the unit, and lift upward (Page 1). The door of the container should open and the box should pivot clockwise towards the ground.

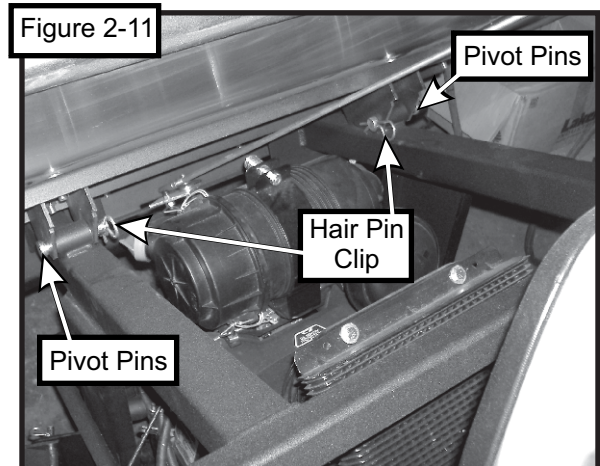

## 2-12 Dump Mechanism Adjustment

The linkage may be adjusted in two places, at the adjusting screw P#(K1435) and the latch assembly items. To change the door closure tightness, screw the adjusting screw (Figure 2-12) in or out. To adjust the latch, change the length of the latch rod by screwing the latch adjusting ball joint in or out. The latch hook pivot should be in the middle of the slot in the latch hook pivot plate. Slide the pivot back or forth and then re-tighten.

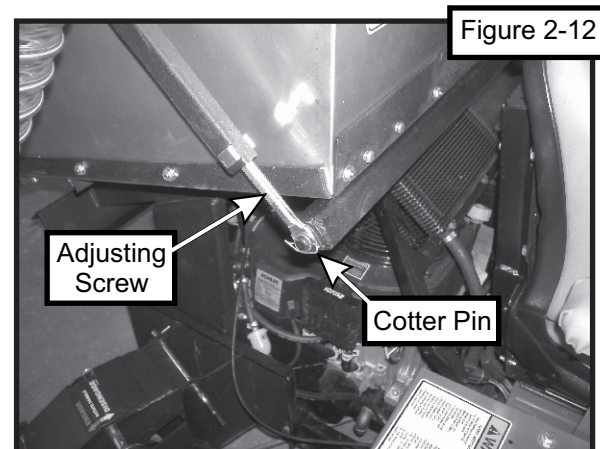

### Lift Handle Assembly

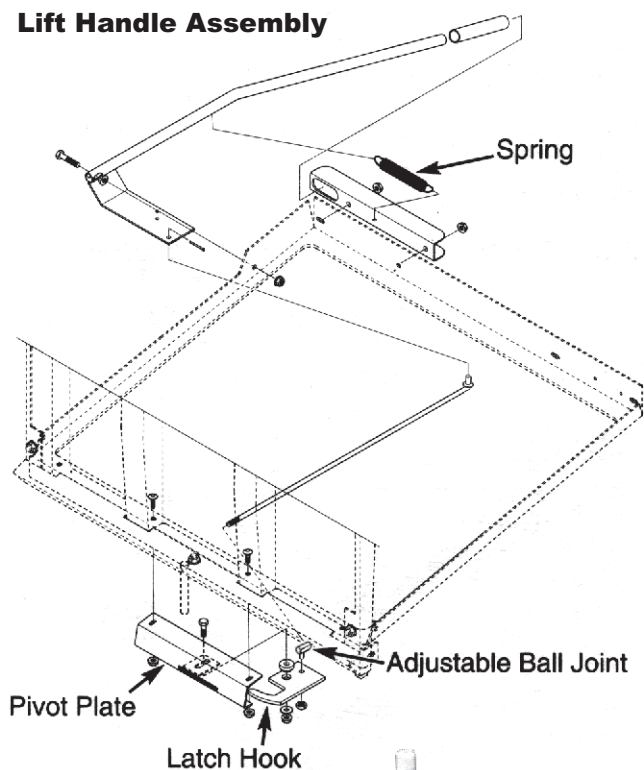

### Aluminum Grass Container With Handle Attached



### Latch Hook Mechanism Assembly

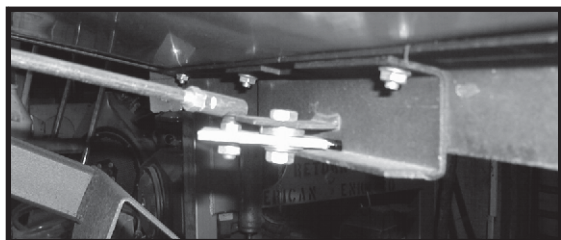

### Aluminum Grass Container Assembly

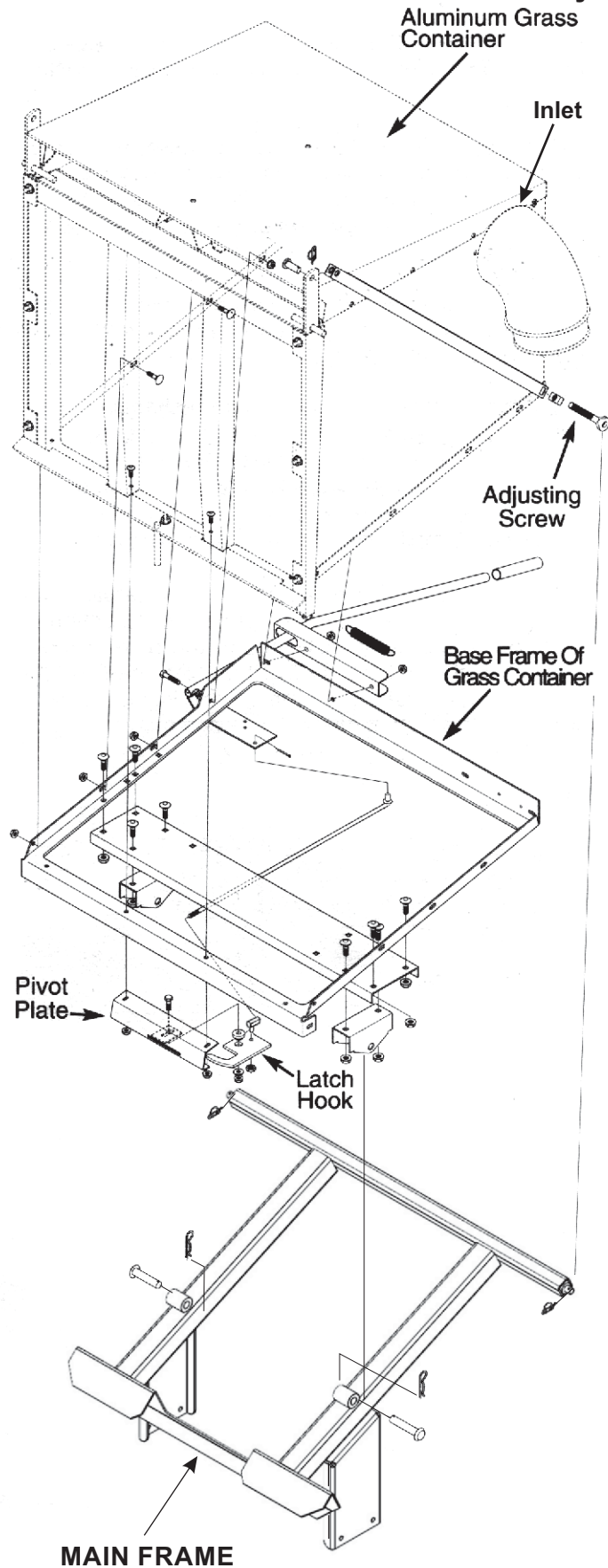



# ALUMINUM GRASS CONTAINER EXPLODED VIEW

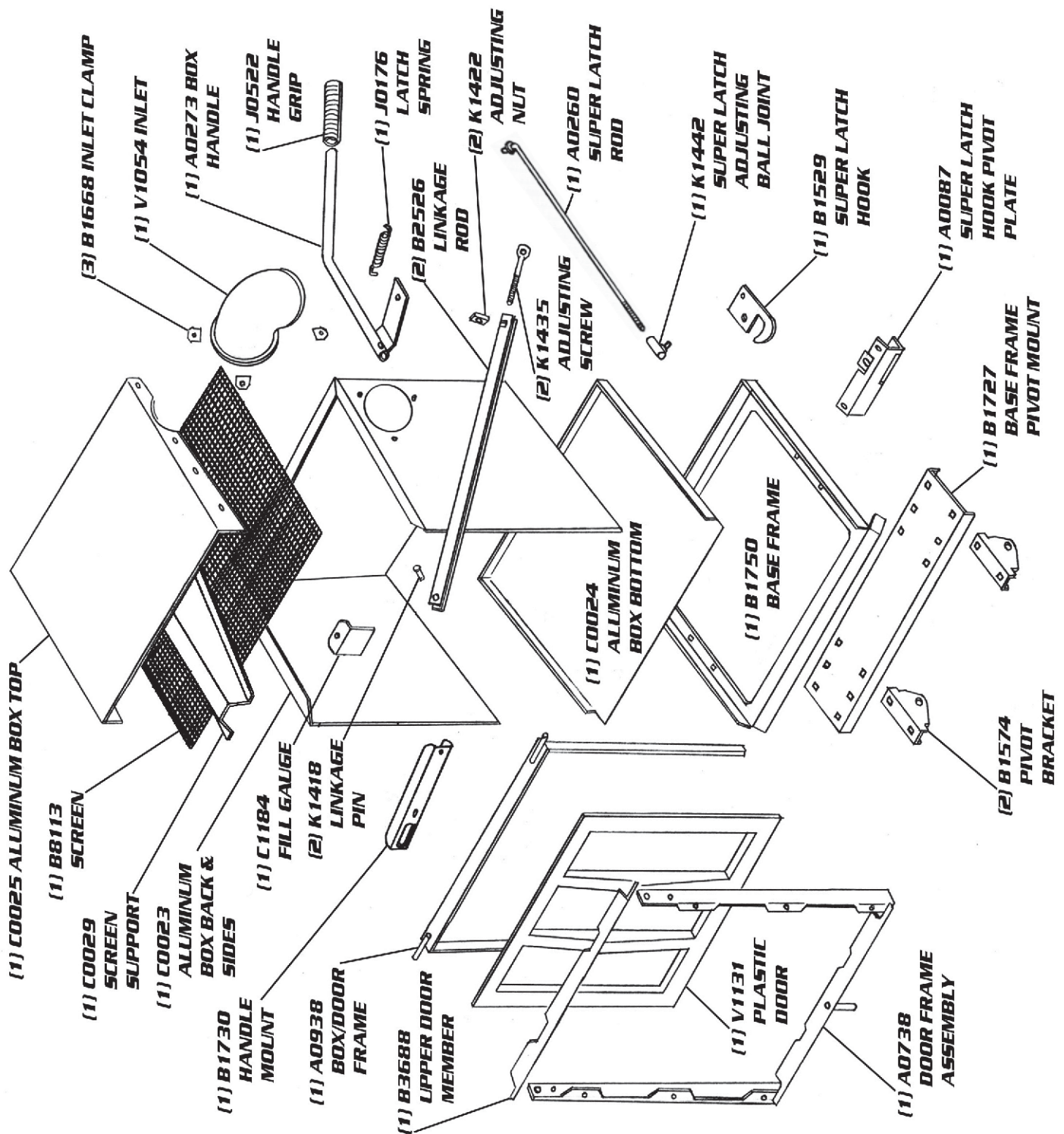

**MODEL#: 49621202**

**MOWER NAME: COUNTRY CLIPPER**

**MOWER MODEL: BOSS SR1220 & CHARGER SR1025**

**MOWER DECK SIZE: 52" & 60"**

**VAC NAME: PRO 12**

☐ **PTO DRIVEN**

☐ **SHIVERS PART#: 629FR-001A**

☐ **A1135 UNIT ASSEMBLY**

**EASY DUMP  
BAGGING  
SYSTEM**

**FOR YEAR: 2012-2011**

**REVISED: 2/8/12**

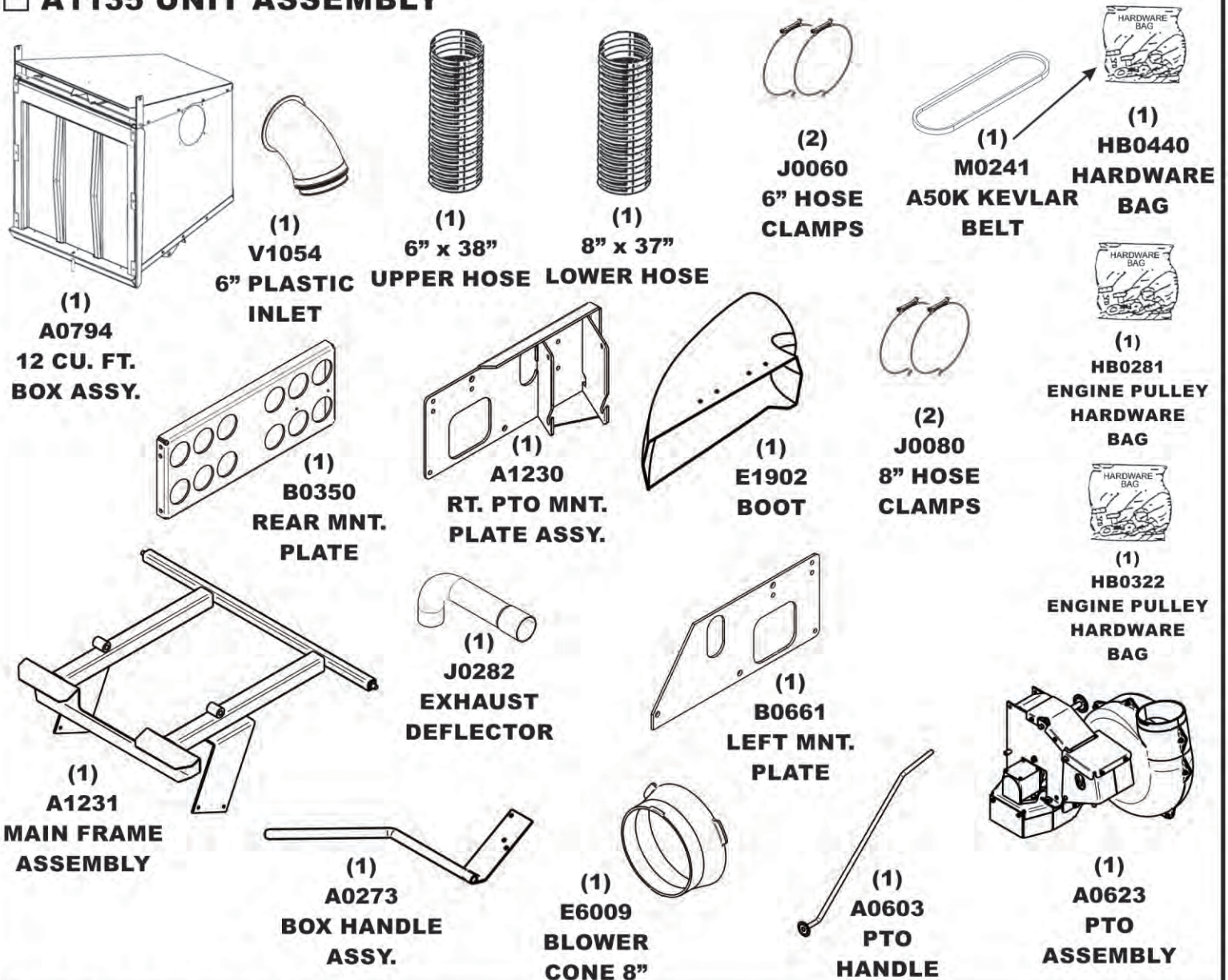

☐ **A0854 WEIGHT KIT**

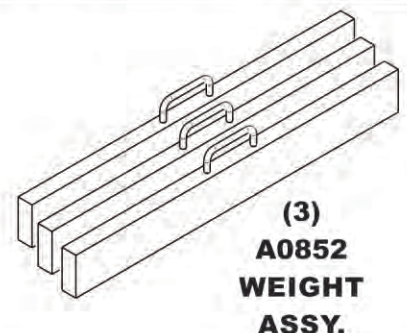
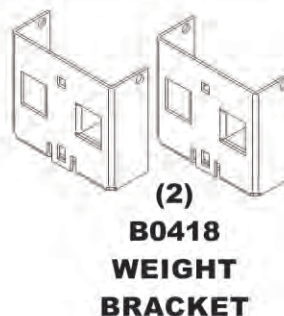
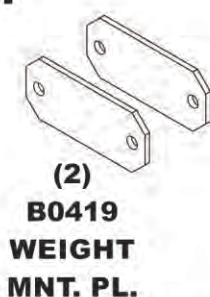



A1841\_01 PTO Arm Assembly

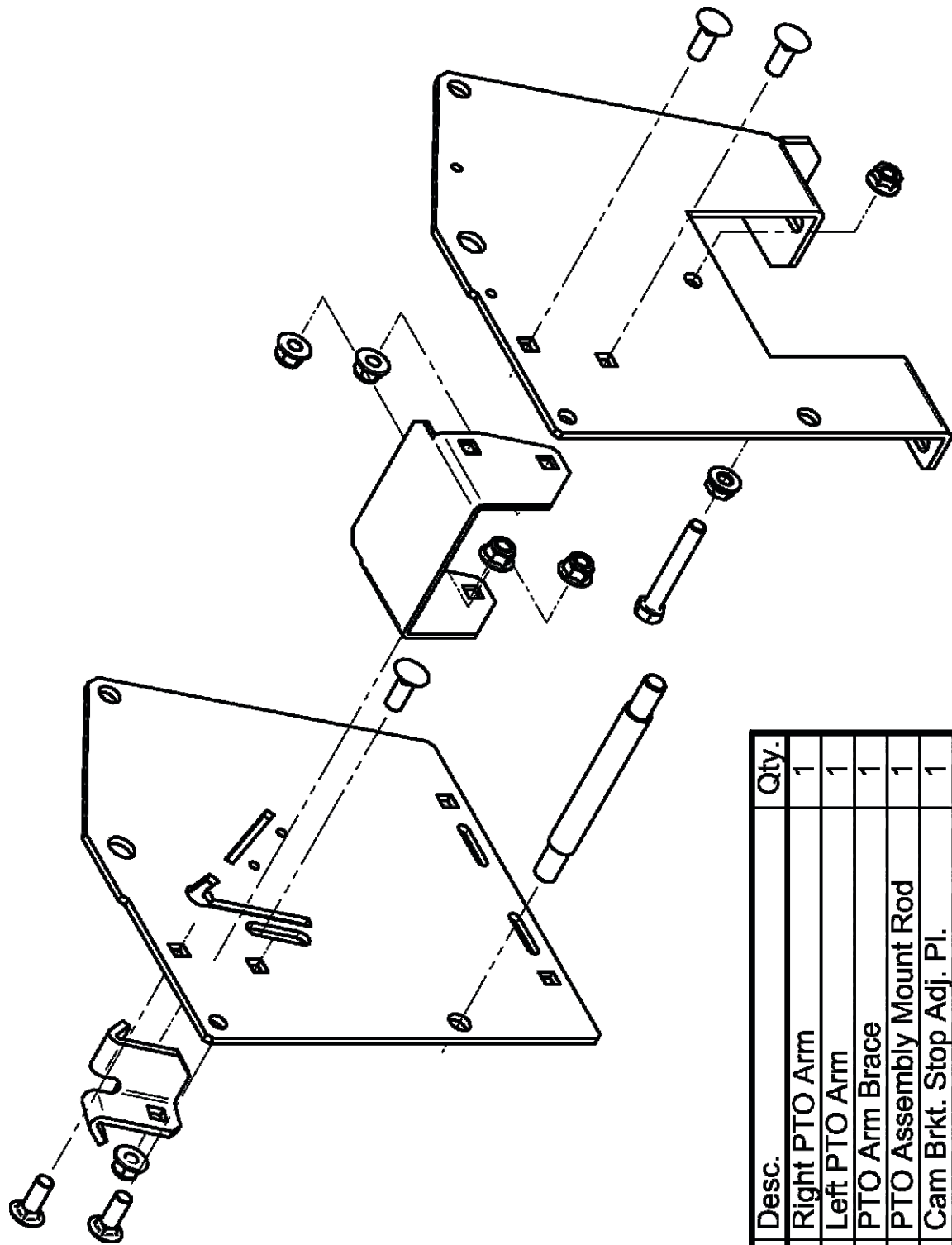

Item#	Part#	Desc.	Qty.
1	B0265 01	Right PTO Arm	1
2	B0266 01	Left PTO Arm	1
3	B0268 01	PTO Arm Brace	1
4	B0271 01	PTO Assembly Mount Rod	1
5	B0024 01	Cam Brkt. Stop Adj. Pl.	1
6	K1215	Flange Nut 3/8"-16	2
7	K1197	3/8"-16X2 1/2" HHCS	1
8	K1182	Carriage Bolt 3/8"-16x1"	5
9	K2038	Ny-Flange Lock Nut 3/8"-16	5

# A1941\_01 PTO Base Assembly Exploded Parts View

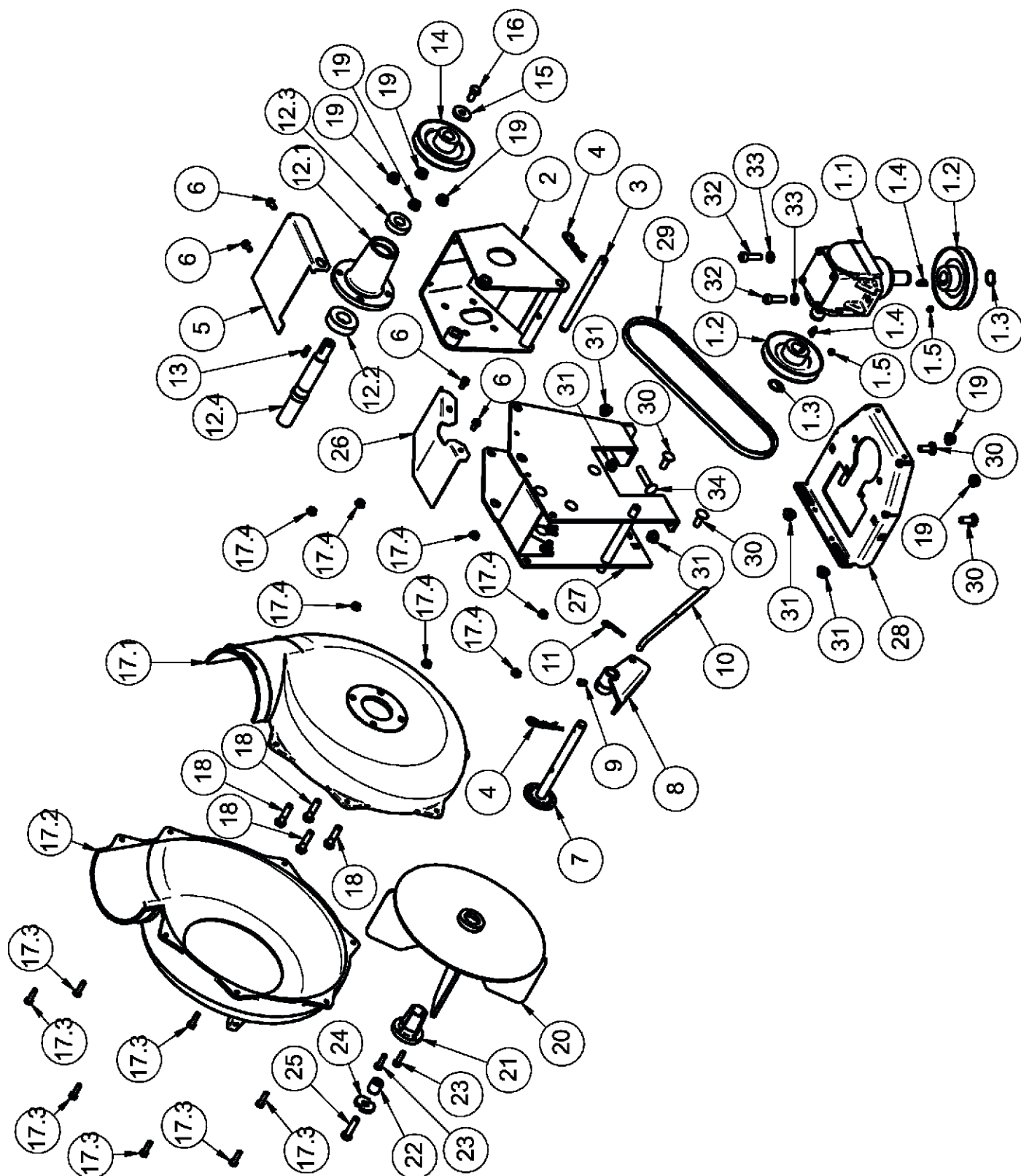

## A1941\_01 PTO Base Assembly Exploded Parts List

Item#	Part#	Desc.	Qty.
1	A0429	Gear Box Assy.	1
1.1	A0431	Gearbox	1
1.2	A0498	Pulley Assy. / GearBox	2
1.3	K0360	Snap Ring / 7/8"Shaft	2
1.4	J0272	Woodruff Key #9	2
1.5	K0035	Set Screw 5/16" -18x1/4" CupPoint	2
2	A0144	Blower Mnt. Brkt. Assy.	1
3	B1755	BLOWER PIVOT ROD	1
4	K0086	Hair Pin Clip.125ODx2.50	2
5	B0121	Blower Belt Guard	1
6	K0353	HWHTCS 1/4" -20x1/2"	4
7	A0604	PTO HANDLE MOUNT ASSY	1
8	A0422	CAM BRACKET ASSEMBLY	1
9	K0356	3/8"-16 TAPERED SET SCREW	1
10	K0326	BELT TENSION ROD 3/8"-16	1
11	K0130	.091ODx1.625L HAIR PIN CLIP	1
12	A0306	PTO Shaft Assy.	1
12.1	E0121	PTO Shaft Housing	1
12.2	N0147	Bearing (2.0472OD,0.9843ID,0.5906W)	1
12.3	N0148	Bearing (1.625OD,0.750ID,0.4375W)	1
12.4	B1758	PTO Shaft	1
13	J0254	Key / 3/16" x3/16" x3/4"	1
14	M0228	Pulley / Impeller Shaft	1
15	K1446	PTO Housing Washer	1
16	K1190	HHCS / 3/8"-16x3/4"	1
17	E4004A	BLOWER HSG. ASSY.	1
17.1	E4004B	BLOWER HSG. BACK	1
17.2	E4004F	BLOWER HSG. FRONT	1
17.3	K1125	HHCS 1/4" -20X1" GR2	7
17.4	K1126	Flange Nut 1/4" -20	7
18	K1193	HHCS 3/8" -16X1-1/2"GR5	4
19	K1215	Flange Nut 3/8"-16	6
20	A0645	4-Blade Impeller Assy	1
21	S4302	TAPER - LOCK BUSHING	1
22	S3242	Spacer Bushing / .750IDx.380IDx.830L	1
23	K1225	HHCS 1/4" -20X1" GR8	2
24	K0278	Double Indented Washer 7/16"1.375ODx.440IDx.179T	1
25	K1211	3/8"-16x1-1/2"HHCS GR8	1
26	B0270	PTO Arm Guard	1
27	A1804_01	PTO Arm Assembly	1
28	A0624_01	Base Plate Assembly	1
29	M0250	A30K KEVLAR BELT	1
30	K1182	Carriage Bolt 3/8"-16x1"	4
31	K2038	Ny-Flange Lock Nut 3/8"-16	5
32	K0309	3/8"-16x1-1/4"SHCS	2
33	K0048	Lock Washer 3/8"	2
34	K1184	Carriage Bolt 3/8"-16x2"	1

# **A0623 PTO Assembly w/ Small Pulley Guard Exploded Parts View**

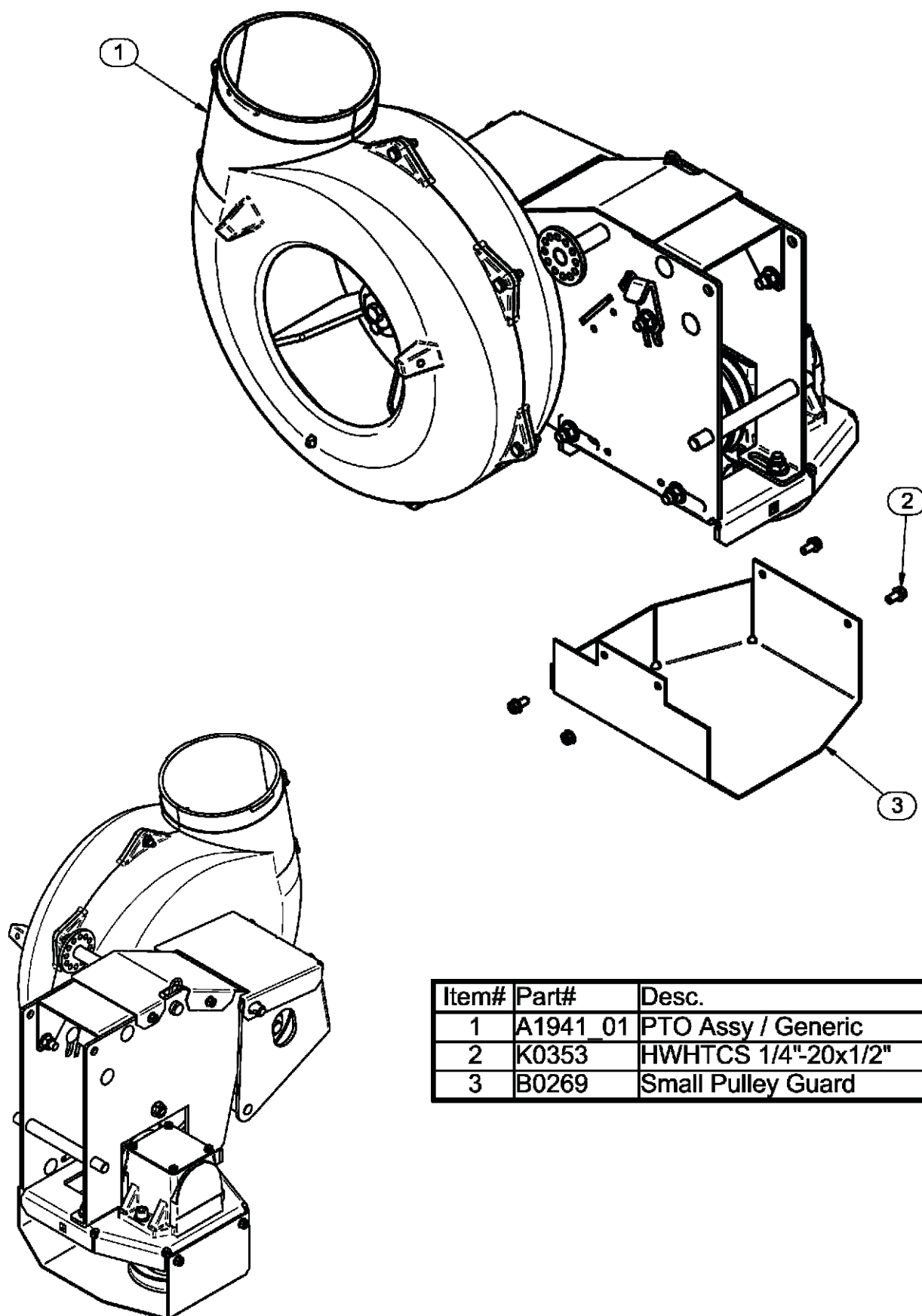



## 2-13 Blower Cone Installation

Thread (1) 5/16"-18 jam nut P#(K0120) onto each end of (2) 5/16"-18 x 2-1/2" HHCS P#(K0125). Now partially thread the bolts into each of the two tabs located on the blower housing. Place blower cone so the two tabs line up with the bolts then tighten completely. Refer to Figure 2-13 for reference.

Figure 2-13

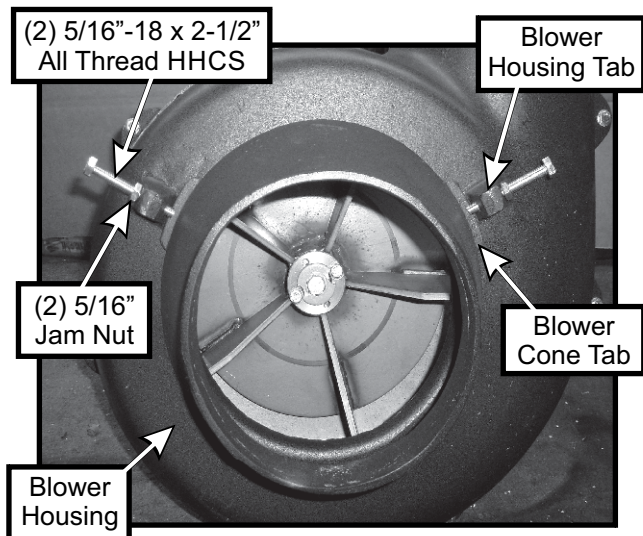

## 2-14 Impeller Blade Removal/Replacement

**To Remove:** First remove the 3/8"-16 x 1-1/2" HHCS P#(K1211) (#1), taper lock bushing washer P#(K0278) (#3) and spacer bushing P#(S3242) (#4) from the taper-lock bushing (#5). See Figure 2-14. Next remove the (2) 1/4"-20 x 1" HHCS (#2) and place them into the threaded holes of the taper-lock bushing P#(S4302) (#5). Gradually thread each bolt evenly into the taper-lock bushing, forcing the blade to break-away from the taper-lock bushing. If the impeller will not move, carefully hit the base of the impeller, between each vein, with a hammer, then try again.

**To Replace:** Place impeller blade over the engine shaft. Slide the taper-lock bushing (#5) on to the engine shaft and into the impeller blade, aligning the **non-threaded** holes of the taper-lock bushing to the threaded holes of the impeller blade. Fasten by using (2) 1/4"-20 x 1" HHCS (#2), (1) spacer bushing (#4) (1) taper lock bushing washer (#3), and (1) 3/8"-16 x 1-1/2" HHCS (#1). Torque to the proper specifications in the torque chart on the back of this manual. Next, rotate the impeller blade to ensure that the blade is clear of contact on all sides of the blower housing.

Figure 2-14



## 2-15 Boot To Mower Deck Installation

Remove the grass deflector and hardware from the mower deck. Refer to Figure 2-15a.

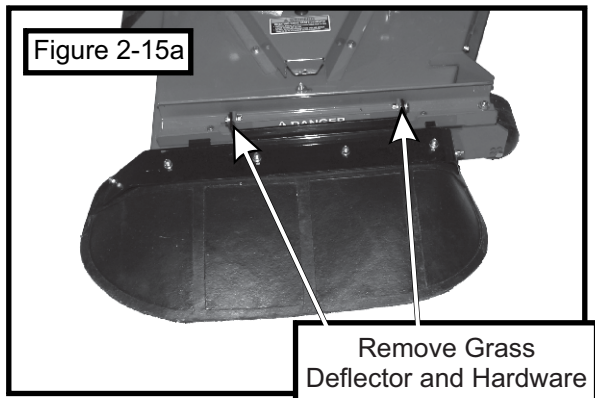

### 60" DECK INSTRUCTIONS

Attach the boot plate P#(B0628) to the boot P#(E1902) using (2) 3/8"-16 x 1" carriage bolt P#(K1182), (2) 3/8" flat washer P#(K0047) and (2) 3/8"-16 nylon flange lock nut P#(K2038). Secure the boot plate to the mower deck using (1) boot rod P#(B0348). Secure the boot rod with (1) hair pin clip P#(K0099). Refer to Figure 2-15b.

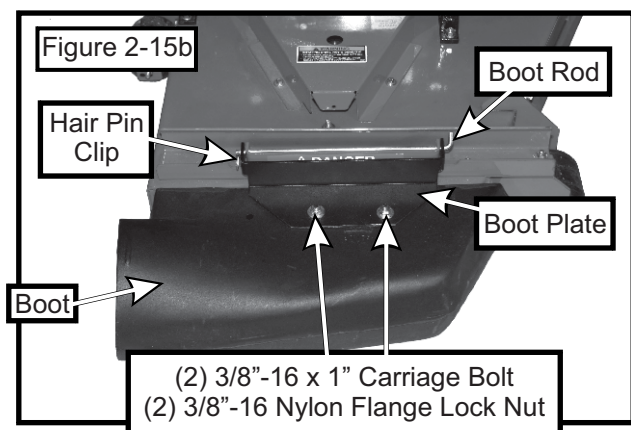

### 52" DECK INSTRUCTIONS

Attach the boot plate P#(B0628) to the boot P#(E1902) using (2) 3/8"-16 x 1" carriage bolt P#(K1182), (2) 3/8" flat washer P#(K0047) and (2) 3/8"-16 nylon flange lock nut P#(K2038). Secure the boot plate to the mower deck using (1) boot rod P#(B0348) and (2) spacers P#(B3143). Secure the boot rod with (1) hair pin clip P#(K0099). Refer to Figure 2-15c.

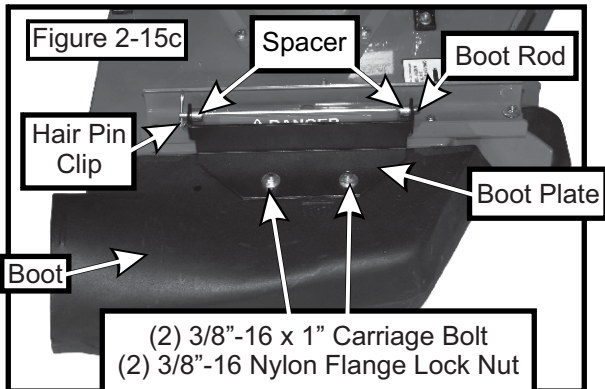

## 2-16 Length of Hose Adjustment

The hoses in steps 2-17 and 2-18 must be cut to fit your machine. Follow steps 2-17 and 2-18. Do not cut the hoses until you have tried to fit them on your machine. Remember that the hoses have to be long enough to adjust for the blower assembly's movement, as well as allow for enough clamping surface between the inlet, blower assembly, and the deck boot.

## 2-17 Upper Hose Installation

Slide (1) hose clamp P#(J0060) onto each end of the upper hose. Slide one end of the upper hose into the plastic inlet on the aluminum box. Make sure there is at least a two-inch overlap between the hose and the inlet. Proceed to slide the opposite end of the 6" hose onto the outlet of the blower assembly. Make sure both hoses are clearly attached to the inlet and blower assembly. Tighten the hose clamps. Refer to Figure 2-17.

## 2-18 Lower Hose To Blower Cone Installation

Slide (1) hose clamp P#(J0080) onto each end of the lower hose. Then Slide one end of the lower hose onto the blower cone. Make sure there is at least a two-inch overlap between the lower hose and the blower cone. Tighten the hose clamp. Refer to Figure 2-17.

## 2-19 Lower Hose To Boot Installation

Take the unattached end of the lower hose and slide it over the circular end of the boot. Use the hose clamp P#(J1000) to secure the hose to the boot. Make sure there is at least a two-inch overlap between the hose and the boot.

**TIP:** Before securing the clamp, rotate the hose counter clockwise (away from yourself) approximately 1" to add in retaining the boot to the mower deck.

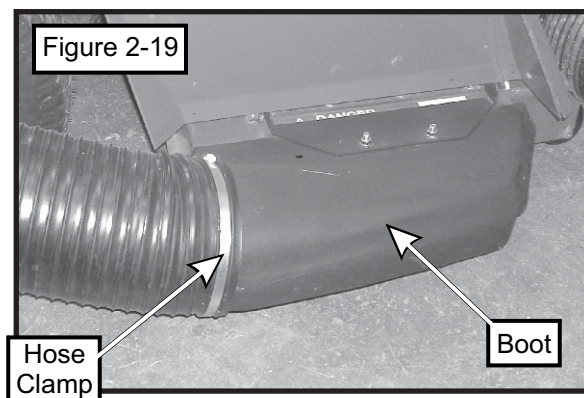



## 2-20 Front Weight Installation

Before installing the front weight, remove the deck step and hardware shown in Figure 2-20a.

Figure 2-20a

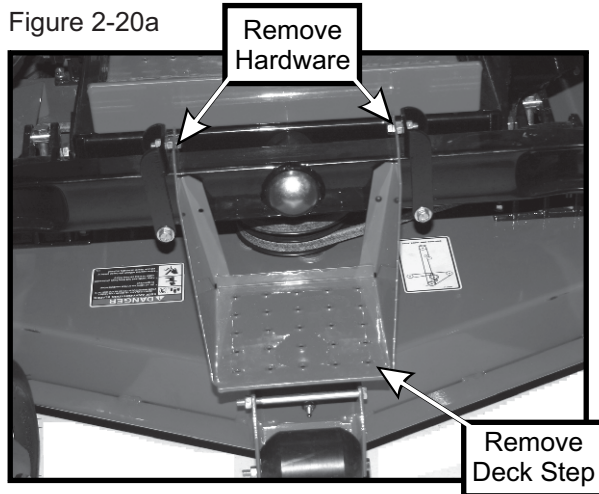

Fasten the weight brackets P#(B0418) and the weight mount plates P#(B0419) to the front casters using (4) 3/8"-16 x 3" carriage bolts P#(K1187) and (4) 3/8"-16 nyloc nuts P#(K1216). Tighten bolts only finger tight at this point. Insert (3) weight assemblies P#(A0852) into the weight mount brackets. Secure the weight assemblies using (2) 3/8" x 6-1/8" clevis pins P#(K1624) and (2) hair pin clips P#(K0086). See Figure 2-20b for reference.

Figure 2-20b

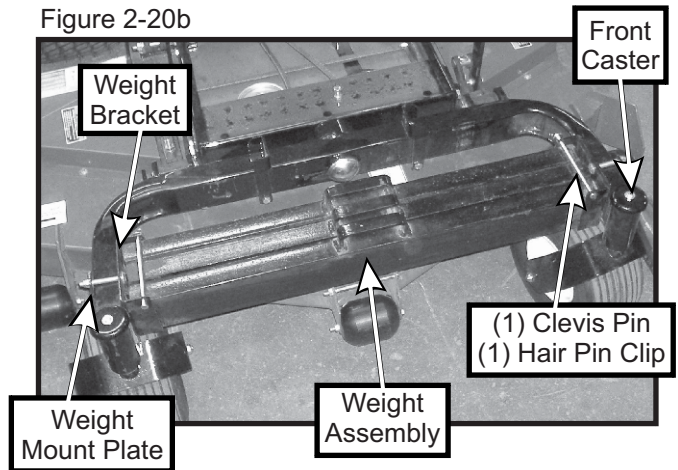
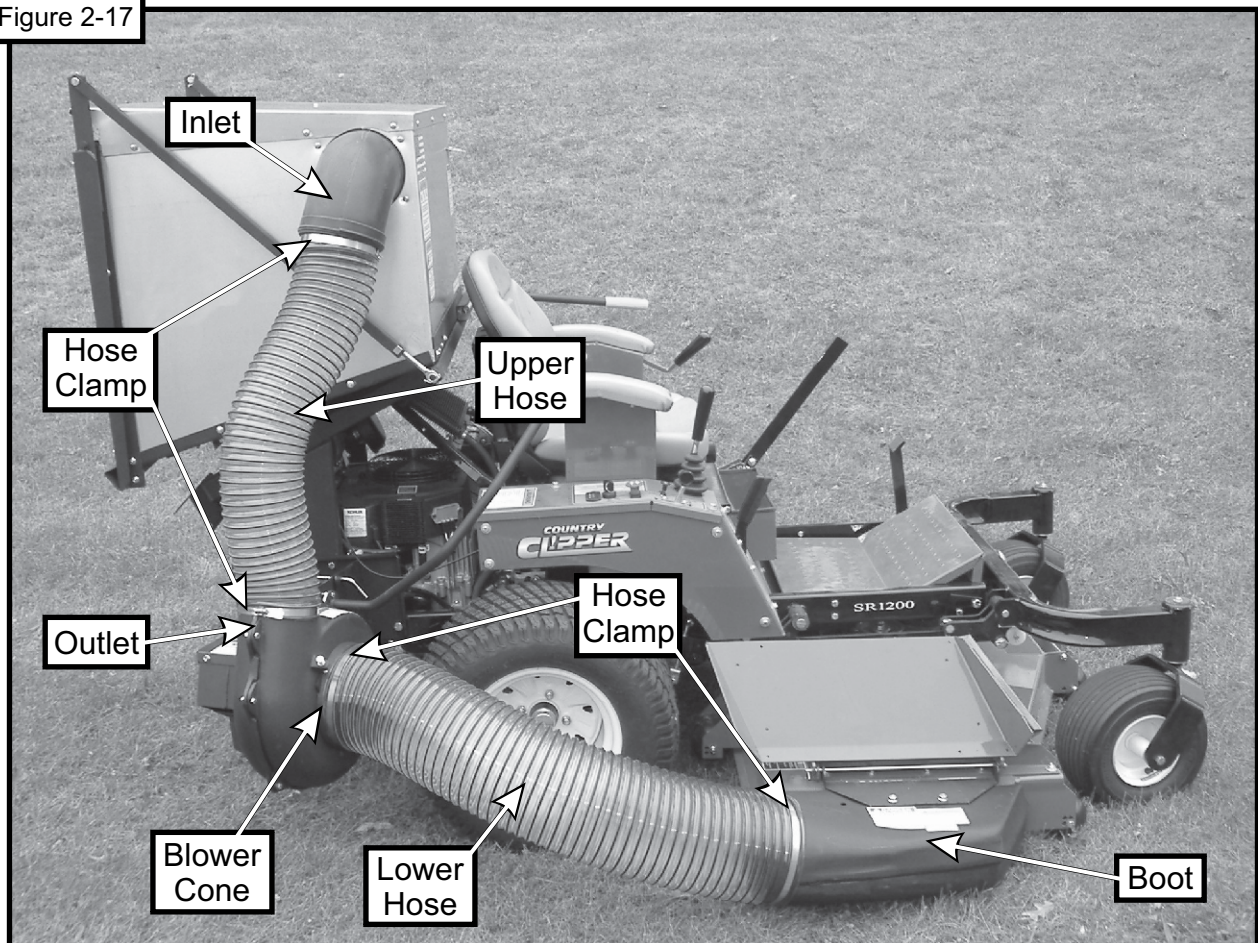

Figure 2-17



## SECTION III OPERATING INSTRUCTIONS

### General Safety

Only qualified people familiar with this operator's manual and the mower's operator's manual should operate this machine.

### Operation And Tips On Mowing

#### PTO MODELS

- A. Perform BEFORE EACH USE the maintenance list in the next section.
- B. Start mower.
- C. With the mower at high idle speed, engage the mower deck.
- D. While seated in the operator's seat, rotate the engagement handle of the collection system away from the mower. Continue to rotate the handle until it stops in an over-center position. With the blower engaged, you can proceed to operate the control levers of the mower.

#### ENGINE DRIVEN MODELS

- A. Perform BEFORE EACH USE the maintenance list in the next section.
- B. Start the engine/blower/blade assembly.
- B. Start mower.
- C. With the mower at high idle speed, engage the mower deck.
- D. Proceed to operate the control levers of the mower.

**NOTE:** If the collection system does not appear to be collecting the grass clippings, disengage the deck and PTO assembly, then, engage the parking brake and turn the mower off. Check upper and lower hoses for any clogs. To obtain the maximum effectiveness from your collection system, the tips listed below should be followed:

- \* Watch your speed- Normal conditions will allow a speed of up to approximately 4 mph, but thick, heavy damp conditions will require reduced ground speed.
- \* Mow with sharp blades- A sharp blade cuts cleaner.
- \* Wet grass and leaves will decrease effectiveness and will increase horsepower requirements.
- \* Mow at higher cutting heights- Remove and mulch no more than 2" of grass length with each mowing. (Experts recommend not cutting off more than 1/3 of the grass blade length at any given time.)
- \* Mow twice, at different height settings, (high, then low), if grass is extra tall.
- \* Remember that horsepower requirements will vary with the mowing conditions such as type and height of turf grass, moisture content, amount of leaves, whether the terrain is flat or hilly, etc.

## Disengagement Of The PTO Assembly

#### PTO MODELS

- A. To disengage the PTO assembly, move Bagger PTO switch to the off position.

**WARNING:** The PTO assembly blades will continue to spin. DO NOT TOUCH the PTO assembly, pulleys, or the belt until the tractor is turned off. DO NOT adjust the belt tension until the mower is turned off. Refer to the Belt Installation section of the manual.

#### ENGINE DRIVEN MODELS

- B. (Briggs & Stratton 900 Series) To stop the engine, throttle the engine to the stop position.
- C. (6.5HP Briggs & Stratton Vanguard) To stop the engine, move the fuel lever to the OFF position.

### Unloading The Collection System

**NOTE:** To determine when the collection bags are full, follow the following steps:

- A. Stop the forward movement of the mower.
- B. Disengage the mower deck.
- C. Disengage the PTO assembly.
- D. Engage the parking brake.
- E. Once the parking brake has been engaged, then and only then, walk behind the mower and check the collection bags by first unhooking the rubber strap with S-hook that secures the plastic top, then lift the plastic hood. Load in bags should not exceed the height of the installed bag.
- F. To remove the bags from the frame, slide bags out and turn bags over to deposit clippings.
- G. Slide empty bags back onto the frame and secure plastic top with the rubber strap with S-hook.

**NOTE:** Do not allow collection bags to become over-filled as potential damage may occur to your equipment. Also, be sure to clean the hood screen as needed.

## SECTION IV MAINTENANCE

### Maintenance Checklist

Before each use:

- 1. Check blades and spindles to be sure that no foreign objects, such as wire or steel strapping bands, are wrapped around them.
- 2. Inspect blades for wear. Replace if necessary. If it is necessary to sharpen the blades, remove the blades from the spindles before sharpening. DO NOT sharpen blades while still attached to the mower.

2017 (v1.0)



3. Make sure all shields are in place and in good condition. Repair or replace any missing or damaged shields.
4. Perform lubrication per instructions.
5. Listen for abnormal sounds, which might indicate loose parts, damaged bearings, or other damage. Correct any deficiency before continuing operation.
6. **PTO MODELS ONLY:** With the engine off, engage the blower assembly. Check the belt tension and inspect the pulley belt for cracks or tears.
7. Check for wear or deterioration of the upper or lower hoses. If there are any portions of the hose that have been torn or worn through, replace immediately.

**After Each Use:**

1. Clean all debris from machine especially from the container, underneath the belt shields, and safety decals. Replace any missing or illegible decals.
2. Inspect the unit for worn or damaged components. Repair or replace before the next use. Any replacement component installed during repair shall include the component's current safety decal specified by the manufacturers to be affixed to the component.
3. Under normal usage, the bag material is subject to deterioration and wear and should therefore be frequently checked for necessary replacement. Any replacement bag should be checked to ensure compliance with the original manufacturer's recommendations or specifications.
4. Check belt for proper tension.

## 4-2 Lubrication

**Gearbox:**

**NOTE:** The gearbox is filled with 6.0 oz. of Mobilube HD Plus 80W-90 oil and permanently sealed. There is no need for scheduled lubrication. The oil level should only be checked if a leak is observed or if a change in gearbox noise is noticed.

Operators are recommended to check for leaks weekly. If a leak is observed, both the gasket and the seals are recommended to be replaced.

Replace the oil using 5.5 oz. of the recommended Mobilube HD Plus 80W-90 oil. Be sure to not overfill.

**Blower Assembly:**

**NOTE:** The following is for older PTO models that contain a greaseable zirc fitting. Newer models contain maintenance-free bearings and are without a greasable fitting.

1. On initial use: Grease the fitting on the blower shaft.
2. Every 25 hours of use: Re-grease the grease fitting.

**NOTE:** Use only white lithium based grease for lubrication of the shaft on the blower assembly.

## SECTION V - PARTS & SERVICE

### 5-1 Parts And Service Information

Collection system owners should record the name and telephone number of their Service Center. Your Service Center will be happy to supply replacement parts, accessories, and do any service or repairs to your collection system. If for any reason your Service Center is unable to service your collection system or supply replacement parts, contact New PECO, Inc. and include the following information on the chart below.

### DOCUMENT THE FOLLOWING INFORMATION FOR FUTURE REFERENCE

**Unit Model Number:** \_\_\_\_\_

**Unit Engine Size:** \_\_\_\_\_

**Unit Serial Number:** \_\_\_\_\_

**Date of purchase:** \_\_\_\_/\_\_\_\_/\_\_\_\_

**Dealer/Distributor Name:** \_\_\_\_\_

**Address:** \_\_\_\_\_ **State:** \_\_\_\_\_ **Zip:** \_\_\_\_\_

**Phone Number:** \_\_\_\_\_

**New PECO, Inc.**

**10 Walden Dr | Arden, North Carolina 28704**

**Phone: 1-800-438-5823 | 828-684-1234**

**Fax: 828-684-0858**

**Email: [peco@lawnvac.com](mailto:peco@lawnvac.com)**

**Website: [www.lawnvac.com](http://www.lawnvac.com)**

## SAFETY DECALS

To promote safe operation, PECO supplies safety decals on all products manufactured. Damage can occur to safety decals either through shipment, use or reconditioning. Contact your local Service Center for replacement decals.



# R2008



# R2007



Part #: R1049  
Operation



Part #: R1069  
Warning - Turn Off Blower



Part #: R1053  
Caution - Keep Hands And Body Clear



Part #: R1055  
Dump Grass

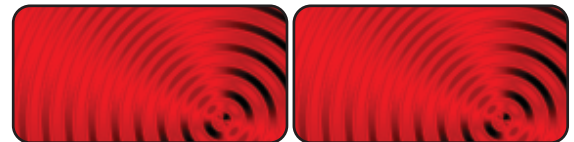

Part #: R1057  
Red Reflector Label

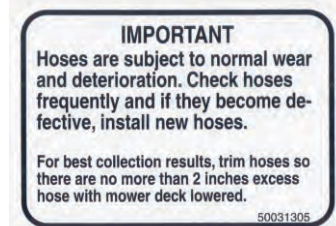

Part #: R1054  
Important - Hose Wear



Part # R0024  
Danger - Keep Hands Clear



Part# R0022  
Designed & Built In The USA



Part #: R4008  
Caution - Rotating Blades!



Part # R0025  
Danger - Rotating Blades



Part #: R1051  
Warning - Hearing Protection



Part #: R1083  
Engage/Disengage



Part #: R1070  
PECO Logo

# TORQUE SPECIFICATIONS

Proper torque for American fasteners used on equipment.  
Recommended Torque in Foot Pounds (Newton Meters).\*

## AMERICAN Bolt Head Markings

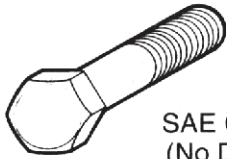

SAE Grade 2  
(No Dashes)

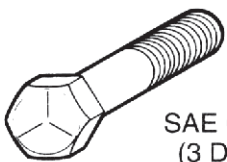

SAE Grade 5  
(3 Dashes)

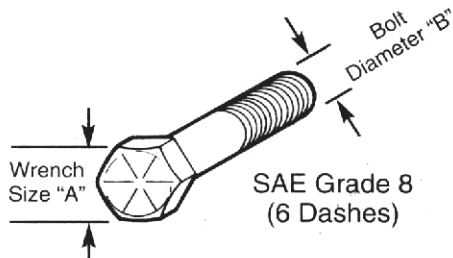

SAE Grade 8  
(6 Dashes)

WRENCH SIZE (IN.) "A"	BOLT DIAMETER (IN.) "B" AND THREAD SIZE	SAE GRADE 2	SAE GRADE 5	SAE GRADE 8
7/16	1/4 - 20 UNC	6 (7)	8 (11)	12 (16)
7/16	1/4 - 28 UNF	6 (8)	10 (13)	14 (18)
1/2	5/16 - 18 UNC	11 (15)	17 (23)	25 (33)
1/2	5/16 - 24 UNF	13 (17)	19 (26)	27 (37)
9/16	3/8 - 16 UNC	20 (27)	31 (42)	44 (60)
9/16	3/8 - 24 UNF	23 (31)	35 (47)	49 (66)
5/8	7/16 - 14 UNC	32 (43)	49 (66)	70 (95)
5/8	7/16 - 20 UNF	36 (49)	55 (75)	78 (106)
3/4	1/2 - 13 UNC	49 (66)	76 (103)	106 (144)
3/4	1/2 - 20 UNF	55 (75)	85 (115)	120 (163)
7/8	9/16 - 12 UNC	70 (95)	109 (148)	153 (207)
7/8	9/16 - 18 UNF	79 (107)	122 (165)	172 (233)
15/16	5/8 - 11 UNC	97 (131)	150 (203)	212 (287)
15/16	5/8 - 18 UNF	110 (149)	170 (230)	240 (325)
1-1/8	3/4 - 10 UNC	144 (195)	266 (360)	376 (509)
1-1/8	3/4 - 16 UNF	192 (260)	297 (402)	420 (569)
1-5/16	7/8 - 9 UNC	166 (225)	430 (583)	606 (821)
1-5/16	7/8 - 14 UNF	184 (249)	474 (642)	668 (905)
1-1/2	1 - 8 UNC	250 (339)	644 (873)	909 (1232)
1-1/2	1 - 12 UNF	274 (371)	705 (955)	995 (1348)
1-1/2	1 - 14 UNF	280 (379)	721 (977)	1019 (1381)
1-11/16	1-1/8 - 7 UNC	354 (480)	795 (1077)	1288 (1745)
1-11/16	1-1/8 - 12 UNF	397 (538)	890 (1206)	1444 (1957)
1-7/8	1-1/4 - 7 UNC	500 (678)	1120 (1518)	1817 (2462)
1-7/8	1-1/4 - 12 UNF	553 (749)	1241 (1682)	2013 (2728)
2-1/16	1-3/8 - 6 UNC	655 (887)	1470 (1992)	2382 (3228)
2-1/16	1-3/8 - 12 UNF	746 (1011)	1672 (2266)	2712 (3675)
2-1/4	1-1/2 - 6 UNC	870 (1179)	1950 (2642)	3161 (4283)
2-1/4	1-1/2 - 12 UNF	979 (1327)	2194 (2973)	3557 (4820)

## METRIC

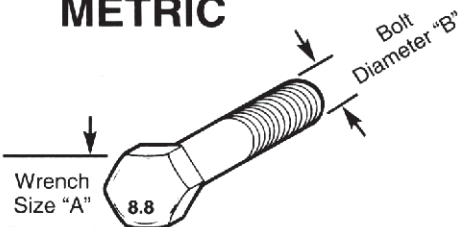

Numbers appearing on bolt heads  
indicate ASTM class.

Proper torque for metric fasteners used on equipment.  
Recommended torque in foot pounds (newton Meters).\*

WRENCH SIZE (mm) "A"	BOLT DIA. (mm) "B"	ASTM 4.6	ASTM 8.8	ASTM 9.8	ASTM 10.9
8	5	1.8 (2.4)		5.1 (6.9)	6.5 (8.8)
10	6	3 (4)		8.7 (12)	11.1 (15)
13	8	7.3 (10)		21.1 (29)	27 (37)
16	10	14.5 (20)		42 (57)	53 (72)
18	12	25 (34)	74 (100)	73 (99)	93 (126)
21	14	40 (54)	118 (160)	116 (157)	148 (201)
24	16	62 (84)	167 (226)	181 (245)	230 (312)
30	20	122 (165)	325 (440)		449 (608)
33	22		443 (600)		611 (828)
36	24	211 (286)	563 (763)		778 (1054)
41	27		821 (1112)		1138 (1542)
46	30	418 (566)	1119 (1516)		1547 (2096)

\*Use 75% of the specified torque value for plated  
fasteners. Use 85% of the specified torque  
values for lubricated fasteners.





**Country Clipper Division of Shivers Mfg. Inc**  
**613 W. English | Corydon, IA | 50060**  
**Phone: 1-800-344-8237 | 641-872-2544**  
**Fax: 641-872-1593**  
**E-Mail: [countryclipper@countryclipper.com](mailto:countryclipper@countryclipper.com)**