



PTO GRASS COLLECTION SYSTEM

DESIGNED FOR:

Classic & Xcaliber Series



XTREME

COLLECTION SYSTEM

2011 - 2014

MODEL #: 38621239 & 38621240

Classic 2750-2760 & 3372 & Xcaliber 3374 & 4074

OPERATOR'S MANUAL

ASSEMBLY • OPERATION • MAINTENANCE

MANUAL PART#: Q0464

XT GRASS COLLECTION SYSTEM

TABLE OF CONTENTS

SECTION	PAGE	SECTION	PAGE
Safety - - - - -	2	2-10 Length of Hose Adjustment - - - - -	15
Safety Alert Symbols - - - - -	3	2-11 Upper Hose Installation - - - - -	15
Warranty - - - - -	4	2-12 Lower Hose To Blower Cone Installation - - - - -	15
I INTRODUCTION AND DESCRIPTION - - - - -	5	2-13 Lower Hose To Boot Installation - - - - -	15
1-1 Introduction - - - - -	5	2-14 Impeller Blade Removal/Replacement - - - - -	16
1-2 Description - - - - -	5	2-15 Weight Kit Installation - - - - -	17
II INSTALLATION FOR USE - - - - -	6	Exploded Drawing Views and Parts Lists - - - - -	18-19
2-1 Outer Engine Mount Tube Installation - - - - -	6	III OPERATING INSTRUCTIONS - - - - -	20
2-2 Engine Mount Arm Assembly Installation - - - - -	7	3-1 General Safety - - - - -	20
2-3 Engine/Blower/Blade Assembly Installation - - - - -	7	3-2 Operation & Tips On Mowing - - - - -	20
2-4 Blower Cone Installation - - - - -	8	3-3 Disengagement Of The Blower - - - - -	20
2-5 Main Frame Assembly Installation - - - - -	9	3-4 Unloading The Collection System - - - - -	20
2-6 Aluminum Grass Container Installation - - - - -	10	IV MAINTENANCE - - - - -	20
2-7 Dump Mechanism Adjustment - - - - -	10	4-1 Maintenance Checklist - - - - -	20-21
Aluminum Grass Container Exploded View - - - - -	11	4-2 Lubrication - - - - -	21
2-8 Hose Clamp Preparation - - - - -	12	V PARTS AND SERVICE - - - - -	21
2-9 Boot To Mower Deck Installation - - - - -	13-14	5-1 Parts And Service Information - - - - -	21
		Safety Decals - - - - -	22
		Torque Specifications - - - - -	23

Safety

1. Read the operator's manual carefully and familiarize yourself with the proper use of your attachment. Do not allow anyone who is not acquainted with the Safety Instructions to use your attachment.
2. Know the controls and how to stop quickly. READ THE OPERATOR'S MANUAL!
3. Do not allow children to operate the vehicle. Do not allow adults to operate it without proper instruction.
4. Be especially watchful of children and pets darting into the area while operating.
5. Keep your eyes and mind on your unit while mowing or operating your attachment. Don't let others distract you.
6. Do not attempt to operate your unit or mower when not in the driver's seat.
7. Always stop unit when emptying the container.
8. Stop unit, shut off deck attachment, set parking brake, shut off mower engine and remove spark plug wire before removing clogs, removing or replacing hose, boot, blower cone, or performing any maintenance.
9. Mow across the face of slopes (not steeper than 10 degrees); never up and down the face.
10. It is recommended that the container be kept only half full when negotiating any slopes. Start mowing on slopes when the container is empty.
11. Inspect your lawn and remove any foreign objects before mowing. Never deliberately run the mower across any foreign object.
12. Wear ear protection if the noise level is offensive.
13. Wear eye protection to prevent debris from damaging your eyes.

SAFETY

WARNING! NEVER operate the mower unless the discharge guard and either the deflector assembly or the vacuum collector adapter are fastened securely in place.

WARNING! Do not work around the mower deck boot or the blower area until you are certain that the mower blades and the blower impeller have stopped rotating.

WARNING! To avoid serious injury, perform maintenance on the vacuum collector; **ONLY AFTER STOPPING THE MOWER'S ENGINE AND WAITING FOR ALL MOVING PARTS TO COME TO A COMPLETE STOP.** Set the parking brake. Always remove the ignition key before beginning maintenance.

WARNING! For your own personal safety, **ALWAYS** mow **ACROSS** the face of slopes and **NEVER UP and DOWN** the face. **NEVER** attempt to mow excessively steep slopes, and use caution when turning on any slope.

Safety Alert Symbol



This Safety Alert Symbol means: **“ATTENTION! BECOME ALERT! YOUR SAFETY IS INVOLVED!”**

This symbol is used to call attention to safety precautions that should be followed by the operator to avoid accidents. When you see this symbol, carefully read the message that follows and heed its advice. Failure to comply with safety precautions could result in death or serious bodily injury.

Safety Signs

The signal words **DANGER**, **WARNING**, and **CAUTION** are used on the equipment safety signs. These words are intended to alert the viewer to the existence and the degree of hazard seriousness.



White letters on **RED**

This signal word indicates a potentially hazardous situation which, if not avoided, will result in death or serious injury.



Black letters on **ORANGE**

This signal word indicates a potentially hazardous situation which, if not avoided, could result in death or serious injury.

It may also be used to alert against unsafe practices.



Black letters on **YELLOW**

This signal word indicates a potentially hazardous situation exist which, if not avoided, will result in minor or moderate injury.

It may also be used to alert against unsafe practices.

DIXIE CHOPPER LIMITED WARRANTY FOR NEW PRODUCTS

A. WHAT IS UNDER WARRANTY?

Dixie Chopper extends the following warranties to the original purchaser of each new Dixie Chopper consumer product subject to the following limitations.

- 1. PRODUCT WARRANTY:** Any part of any consumer product, which is defective in material or workmanship as delivered to the purchaser will be repaired or replaced, as Dixie Chopper elects, without charge for parts or labor, if the defect appears within 12 months from the date of delivery of the product to the original purchaser.
ALL DEFECTIVE PARTS MUST BE RETURNED TO DIXIE CHOPPER FOR INSPECTION TO DETERMINE VALIDITY OF WARRANTY CLAIMS. Freight and mailing will be borne by the customer.
- 2. PARTS REPLACED DURING WARRANTY:** Any new Dixie Chopper part which is furnished in performance of this warranty and is defective in material or workmanship as delivered to the purchaser will be repaired or replaced, as Dixie Chopper elects, without charge if the defect appears within 90 days from the date of installation of such part or before the expiration of the original warranty period, whichever is later.

B. SECURING WARRANTY ADJUSTMENTS.

All Warranty will be submitted by an Authorized Dixie Chopper Dealer directly to Dixie Chopper.

C. ITEMS NOT COVERED BY DIXIE CHOPPER WARRANTY.

Engines and batteries attached to Dixie Chopper products are covered under a separate warranty by the respective manufacturer.

D. UNAPPROVED ALTERATION OR MODIFICATION.

All obligations of Dixie Chopper under this warranty shall be terminated if products are altered or modified in ways not approved by Dixie Chopper.

E. ACCIDENTS AND NORMAL MAINTENANCE.

The warranty covers only defective material and workmanship. It does not cover depreciation or damage caused by normal wear, accident, improper use or abuse of products. The cost of normal maintenance and normal replacement of service items such as belts, cutting blades, hoses, etc., which are not defective shall be paid for by the purchaser.

F. NO REPRESENTATIONS ADDITIONAL WARRANTIES, DISCLAIMER.

Neither Dixie Chopper nor any company affiliated with it makes any warranties, representations or promises as to the quality of performance of its products other than those set forth herein. Except as described above, Dixie Chopper makes no other warranties **AND SPECIFICALLY DISCLAIMS ANY AND ALL IMPLIED WARRANTIES OF FITNESS AND MERCHANTABILITY.**

G. ANY MACHINE USED FOR RENTAL PURPOSES ARE GUARANTEED FOR 45 DAYS FROM DATE OF ORIGINAL SALE ONLY.

H. REMEDIED EXCLUSIVE.

The only remedies the purchaser has in connection with the breach or performance of any warranty on Dixie Chopper consumer products are set forth above. In no event will Dixie Chopper be liable for special incidental or consequential damages.

1. NO SERVICE CENTER WARRANTY.

The selling Service Center makes no warranty on his own on any item warranted by Dixie Chopper unless he delivers to purchaser a separate written warranty certificate specifically warranting the item. The dealer has no authority to make any representation or promise on behalf of Dixie Chopper or to modify the terms of this warranty in any way.

Section I - INTRODUCTION AND DESCRIPTION

1-1 Introduction

Your collection system has been designed to give you a low maintenance, simple, and effective way to collect the grass clippings from your mower. This manual is provided to give you the necessary instructions to properly mount and operate the collection system on your mower. Please read this manual thoroughly. Understand what each control is for and how to use it. Observe all safety decal precautions on the machine and noted throughout the manual.

NOTE: all references made to right, left, front, rear, top or bottom are as viewed from the normal operator's position on the mower.

1-2 Description

The grass collection system is designed for turf maintenance where there is a need to collect the grass clippings as the mower cuts the turf. It is also used for picking up leaves and in pre-season and post-season clean-up. The engine/blower/blade assembly is mounted on the right side of the unit. The blower draws grass clippings from the discharge area of the cutter deck back to the 12 cubic foot aluminum box at the rear portion of the mower frame. The operator can engage the blower by starting the external engine. Once the collection box is full with clippings, it can be released to make for easy dumping.

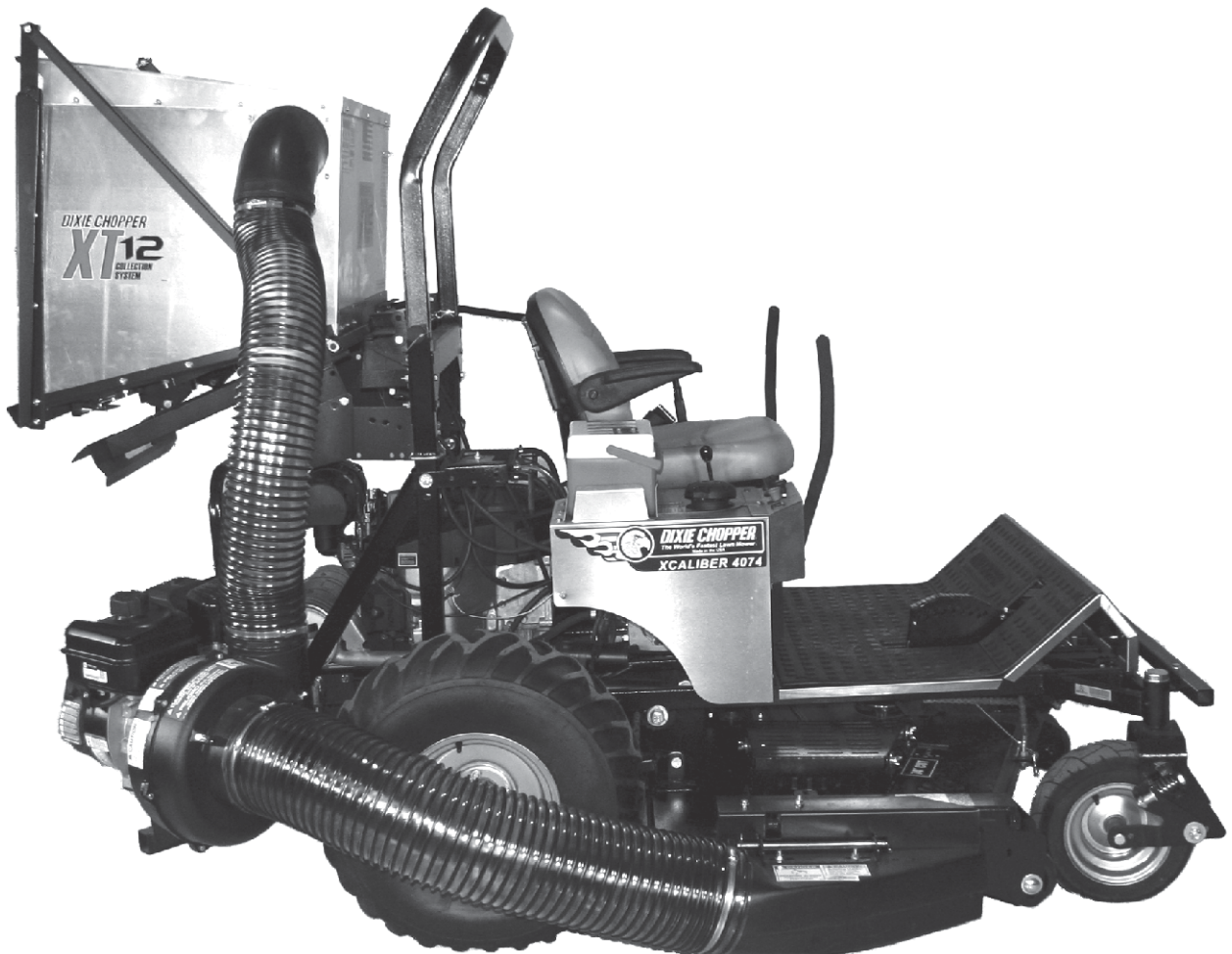

2-1 Outer Engine Mount Tube Installation

Attach (2) outer engine mount brackets P#(B0569) to the rear frame of the mower, in the position and orientation shown in Figure 2-1a and 2-1b, using (2) 3/8"-16 x u-bolts P#(K1436) and (4) 3/8"-16 nylon flange locknuts P#(K2038) PER BRACKET. Leave the hardware finger tight until the blower assembly has been installed and positioned correctly.

Figure 2-1a

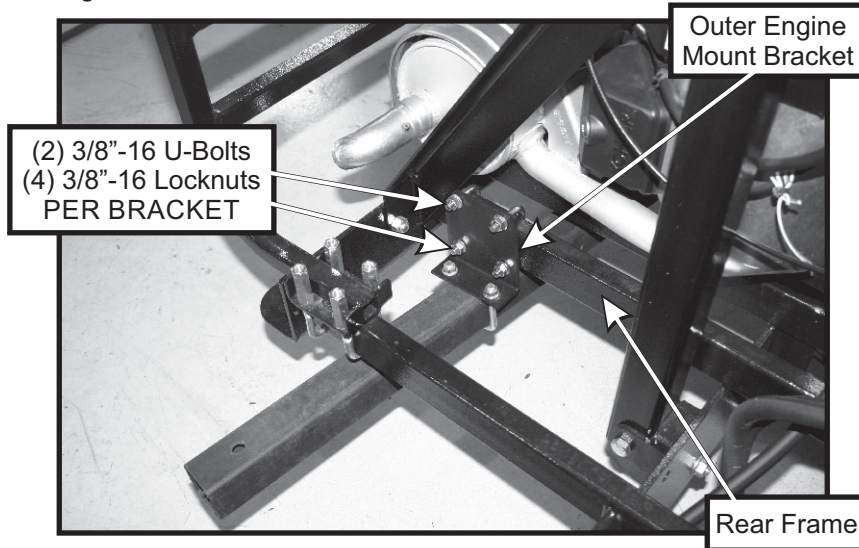

Secure the outer engine mount tube to the outer engine mount brackets using (2) 3/8"-16 u-bolts P#(K1119) and (4) 3/8"-16 nylon flange locknuts P#(K2038). Leave the hardware finger tight until the blower assembly has been installed. Refer to Figure 2-1b for reference.

Figure 2-1b

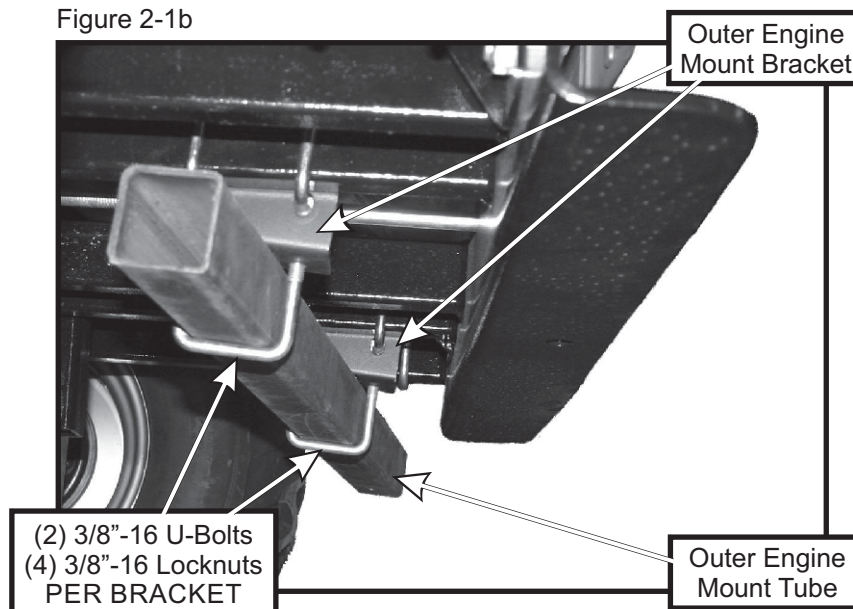

2-2 Engine Mount Arm Assembly Installation

Insert the engine mount arm assembly P#(A1916) into the outer engine mount tube and secure using (1) detent pin P#(J0248). Refer to Figure 2-2.

2-3 Engine/Blower/Blade/Assembly Installation

Position the engine/blower/blade assembly P#(A639) on top of the engine mount arm assembly as shown in Figure 2-2, and secure using (4) 5/16"-18 x 1-1/2" HHCS P#(K1157) and (4) 5/16"-18 nylon flange locknuts P#(K2516).

Figure 2-2

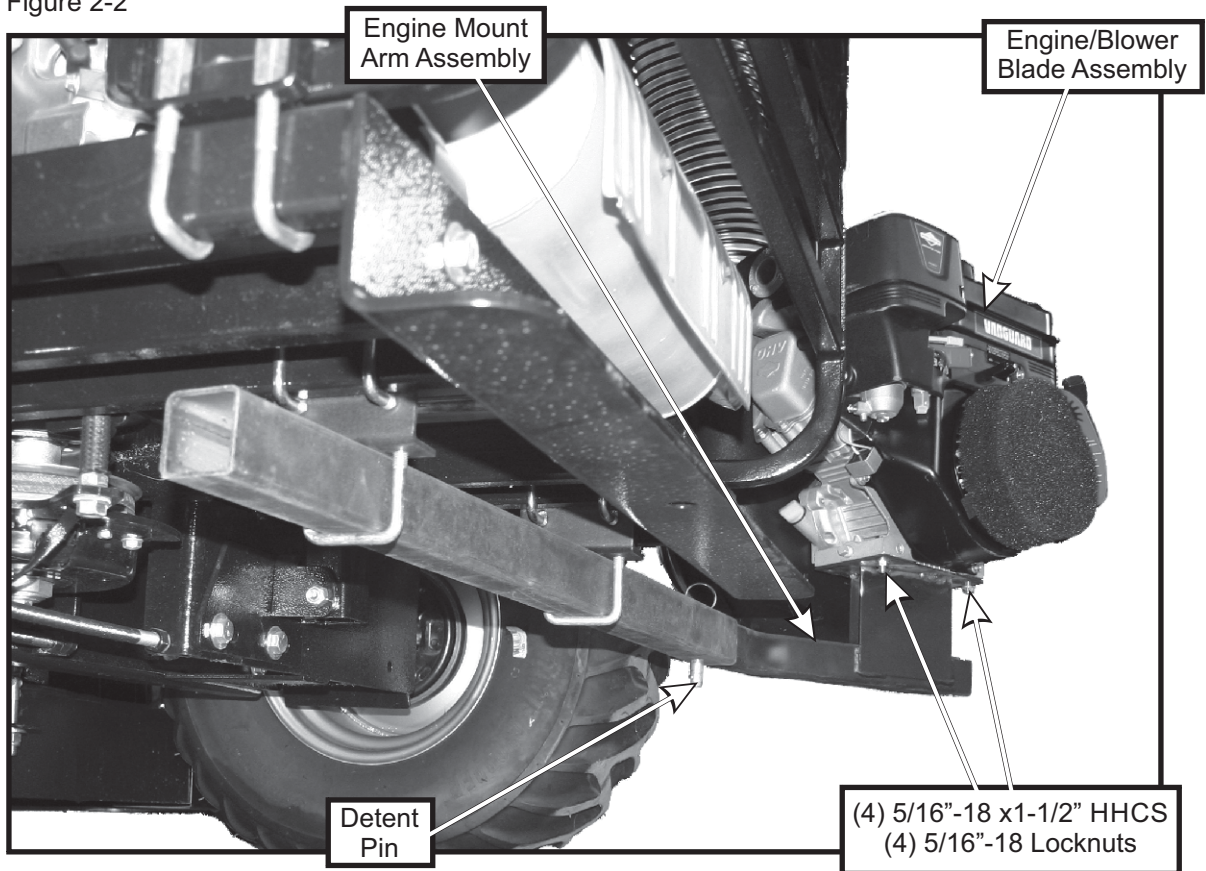

2-4 Blower Cone Installation

Thread (1) 5/16"-18 jam nut P#(K0120) onto each end of (2) 5/16"-18 x 2-1/2" HHCS P#(K0125). Now partially thread the bolts into each of the two tabs located on the blower housing. Place blower cone so the two tabs line up with the bolts then tighten completely. See Figure 2-4.

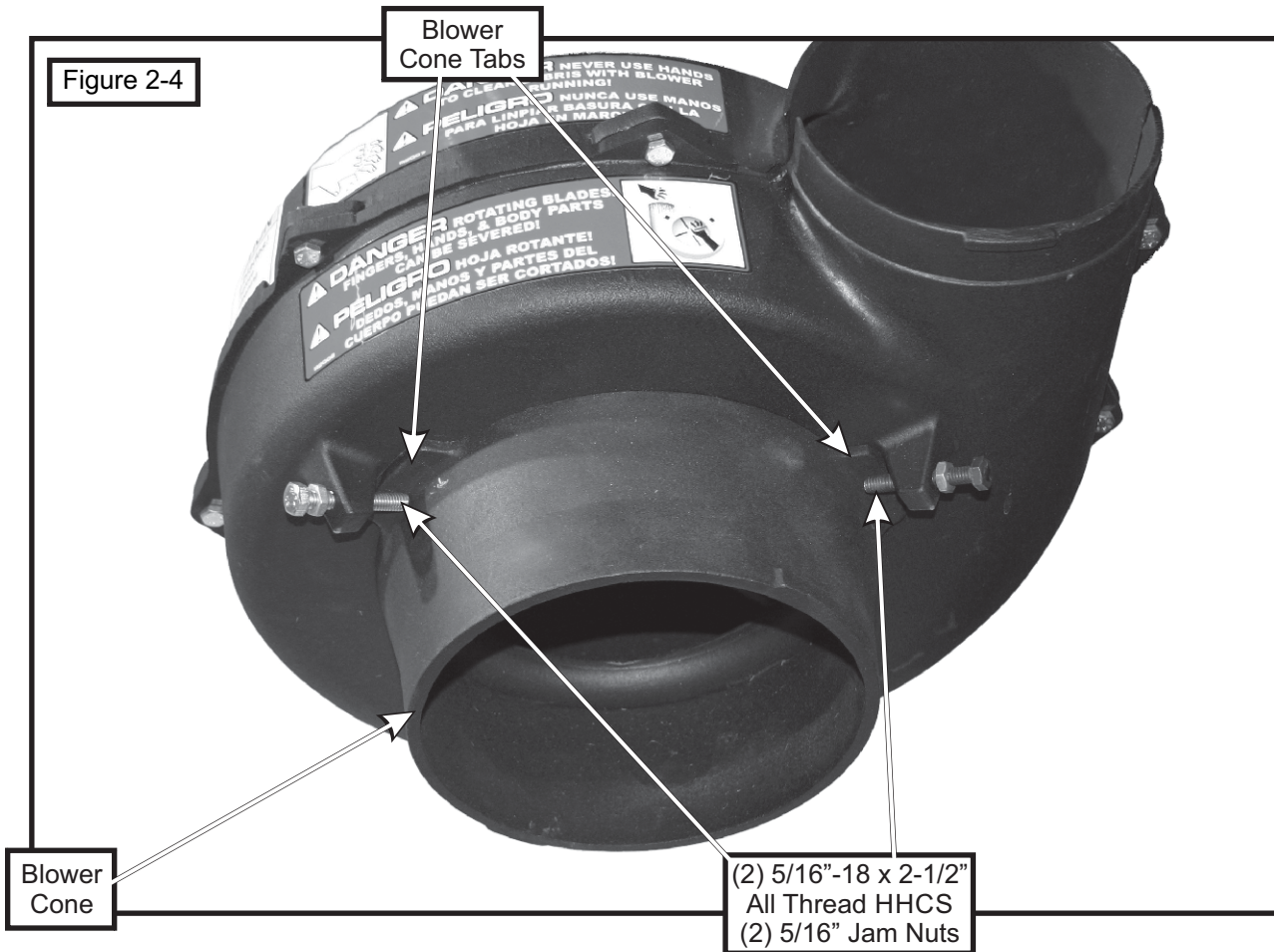

2-5 Main Frame Assembly Installation

Classic 3372

Attach the main frame assembly P#(A1097) to the lower main frame P#(B0567) using (4) 1/2"-13 x 1-1/4" HHCS P#(K1232) and (4) 1/2"-13 nylon flange locknut P#(K2012). Use the middle set of mounting holes on the main frame assembly and the rear set of mounting holes on the lower main frame. Refer to Figure 2-5a.

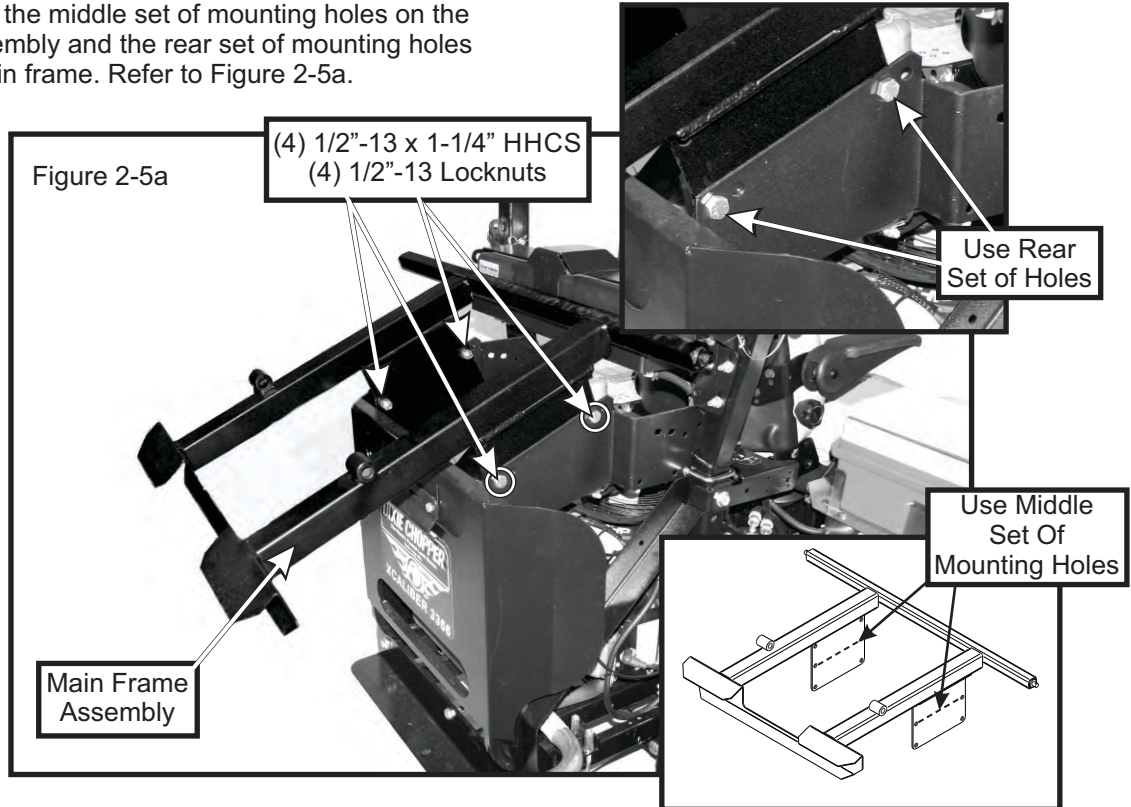

Xcaliber 4074

Attach the main frame assembly P#(A1097) to the lower main frame P#(B0567) using (4) 1/2"-13 x 1-1/4" HHCS P#(K1232) and (4) 1/2"-13 nylon flange locknut P#(K2012). Use the middle set of mounting holes on the main frame assembly and the front set of mounting holes on the lower main frame. Refer to Figure 2-5b.

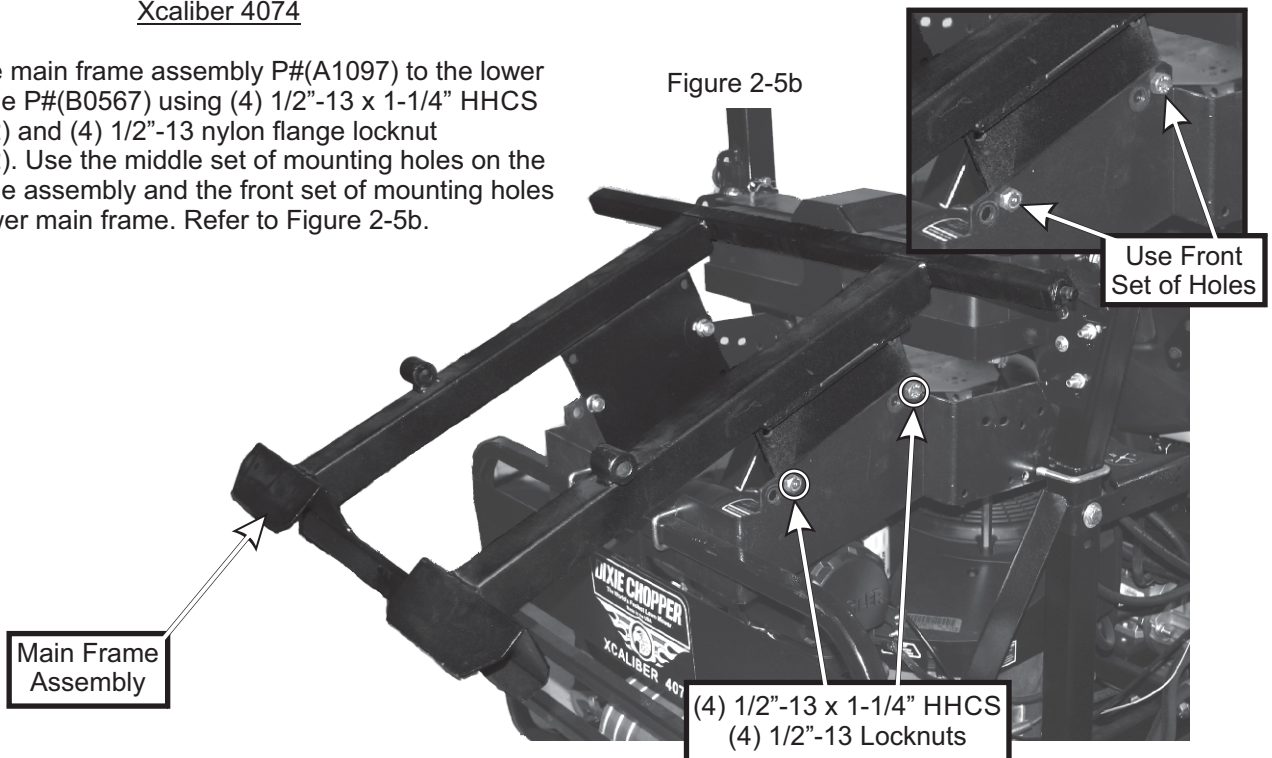

2-6 Aluminum Grass Container Installation

NOTE: It is recommended that (3) people assist in mounting the container. With three people available, two can lower the container onto the frame while the third person inserts the pivot pins P#(K0172) through the holes. Insert the pins from the outside to the inside. Secure with (1) 5/8" washer P#(K0058) and (1) 5/32" x 2-5/8" hair pin clip P#(K0088) per pivot pin (Figure 2-6). Reattach the bottom ends of the door opening linkages to the main frame by using (1) Rue-Ring cotter pin P#(K1437) per side. To test the functionality of the dump mechanism, pull the lift handle away from the unit, and lift upward. The door of the container should open and the box should pivot clockwise towards the ground.

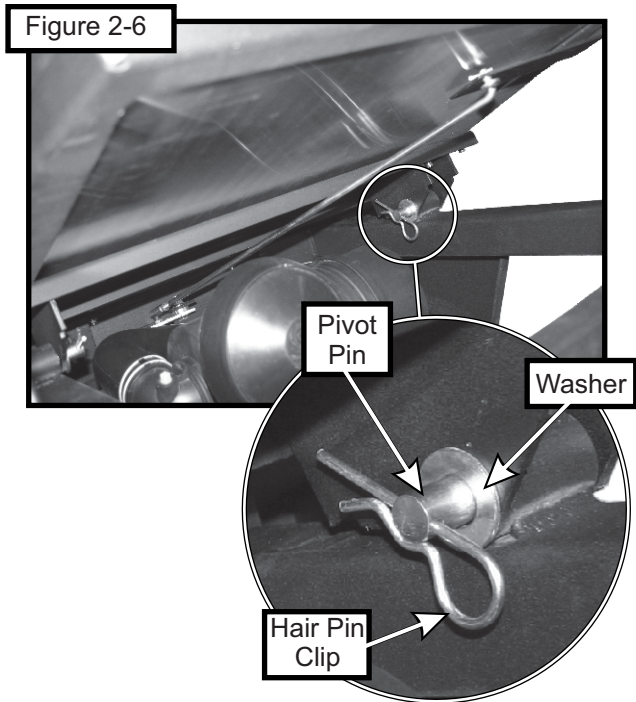

2-7 Dump Mechanism Adjustment

The linkage may be adjusted in two places, at the adjusting screw P#(K1435) and the latch assembly items. See page 14 for visual clarification. To change the door closure tightness, screw the adjusting screw (Figure 2-7) in or out. To adjust the latch, change the length of the latch rod by screwing the latch adjusting ball joint in or out. The latch hook pivot should be in the middle of the slot in the latch hook pivot plate. Slide the pivot back or forth and then re-tighten.

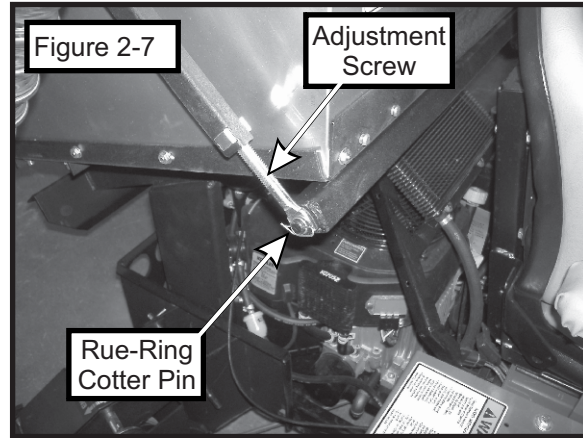

**A1189
ALUMINUM GRASS
CONTAINER
EXPLODED VIEW**

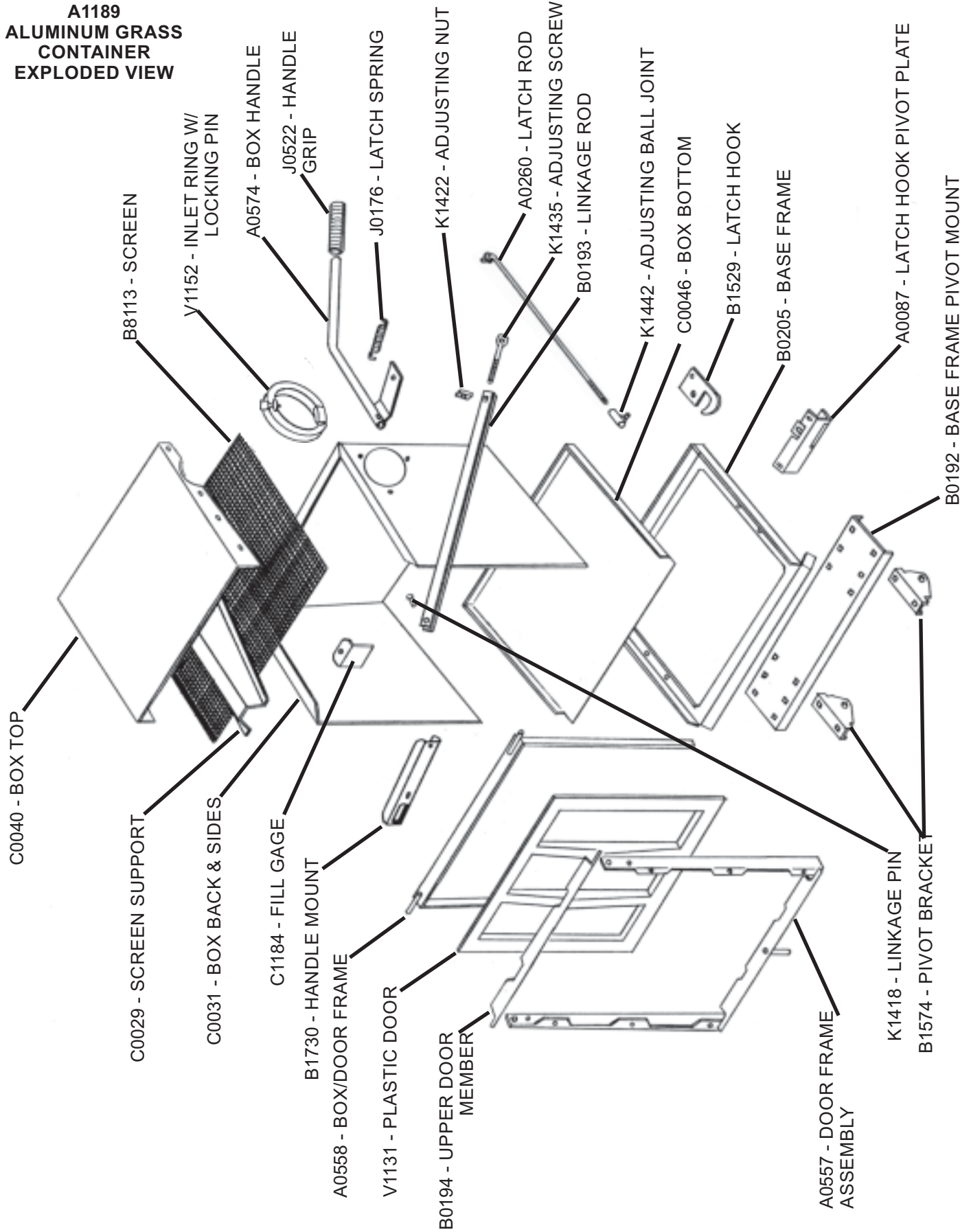

2-8 Boot To Mower Deck Installation

NOTE: Remove all grass deflector and/or mulching hardware from the mower deck before proceeding.

Classic 72" Models

Position the boot plate P#(B0775) onto the top of the aluminum boot P#(E0023) as shown in Figure 2-8a. Secure the boot plate to the boot using (2) 3/8"-16 x 1" carriage bolts P#(K1182) and (2) 3/8"-16 nylon flange locknuts P#(K2038). Insert the bolts from the inside of the boot so that the lock nuts are on top of the boot plate. This will prevent grass clipping from collecting on the bolt threads. Position the deck mount plate onto the top of the mower deck as shown in Figure 2-8a. Secure the deck mount plate to the mower deck using (2) 3/8"-16 x 1" carriage bolts P#(K1182) and (2) 3/8"-16 nylon flange locknuts P#(K2038). Insert the bolts from the underside of the mower deck.

NOTE: Do not tighten hardware until boot has been installed to mower deck.

Figure 2-8a

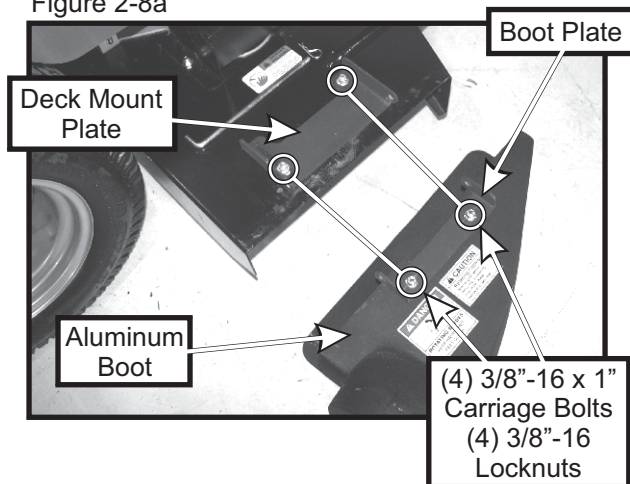

Classic Boot Plate Mounting Locations

Refer to Figure 2-8b for Classic boot plate mounting

Figure 2-8b

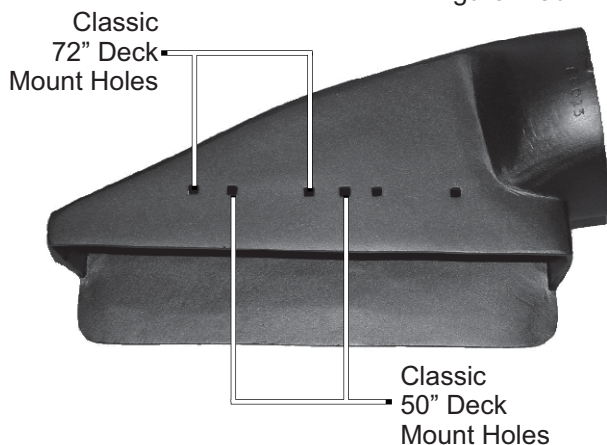

Classic Deck Plate Mounting Locations

Refer to Figure 2-8c for Classic deck plate mounting locations.

Figure 2-8c

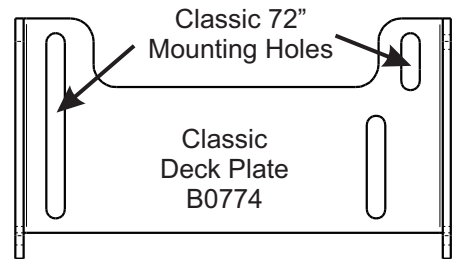

Align the holes in the boot plate with the holes in the deck mount plate. Insert the boot rod P#(B0333) into the mounting holes and secure with (1) hair pin clip P#(K0099). Refer to Figure 2-8d.

With all the carriage bolts still finger tight, use the slots in the deck mount plate and the boot plate to position the boot so that the front inside corner of the boot is flush to the front outside edge of the mower deck. Also check for clearance between the mowers blade and the bottom edge of the boot. Once the boot is positioned correctly, tighten all the hardware.

Figure 2-8d

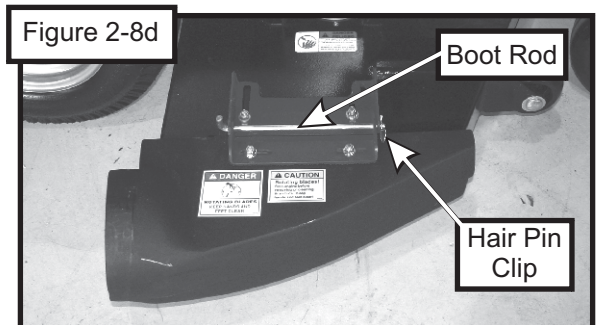

Position and secure the discharge mount plate P#(B0793) to the mower deck using (1) 3/8"-16 x 1" carriage bolt P#(K1182) and (1) 3/8"-16 nylon flange locknut P#(K2038) as shown in Figure 2-8e.

Figure 2-8e

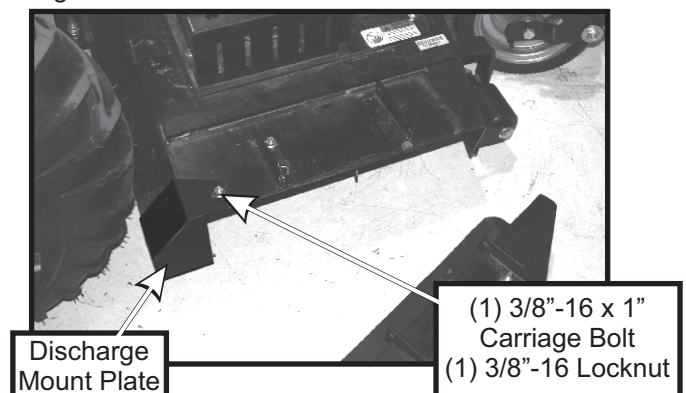

2-8 Boot To Mower Deck Installation Continued

NOTE: Remove all grass deflector and/or mulching hardware from the mower deck before proceeding.

Xcaliber 74" Models

Position the boot plate P#(B0783) onto the top of the aluminum boot P#(E0023) as shown in Figure 2-8f. Secure the boot plate to the boot using (2) 3/8"-16 x 1" carriage bolts P#(K1182) and (2) 3/8"-16 nylon flange locknuts P#(K2038). Insert the bolts from the inside of the boot so that the lock nuts are on top of the boot plate. This will prevent grass clipping from collecting on the bolt threads. Position the deck mount plate P#(B0776) onto the top of the mower deck as shown in Figure 2-9f. Secure the deck mount plate to the mower deck using (2) 3/8"-16 x 1" carriage bolts P#(K1182) and (2) 3/8"-16 nylon flange locknuts P#(K2038). Insert the bolts from the underside of the mower deck.

NOTE: Do not tighten hardware until boot has been installed to mower deck.

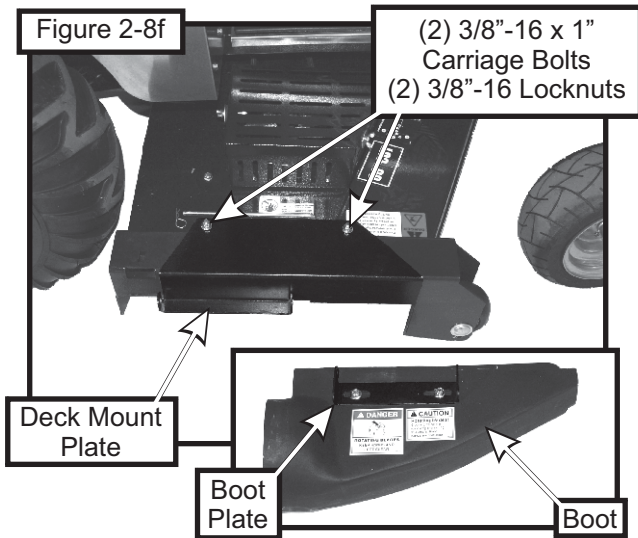

Align the holes in the boot plate with the holes in the deck mount plate. Insert the boot rod P#(B0333) into the mounting holes and secure with (1) hair pin clip P#(K0099). Refer to Figure 2-8h.

With all the carriage bolts still finger tight, use the slots in the deck mount plate and the boot plate to position the boot so that the front inside corner of the boot is flush to the front outside edge of the mower deck. Also check for clearance between the mowers blade and the bottom edge of the boot. Once the boot is positioned correctly, tighten all the hardware.

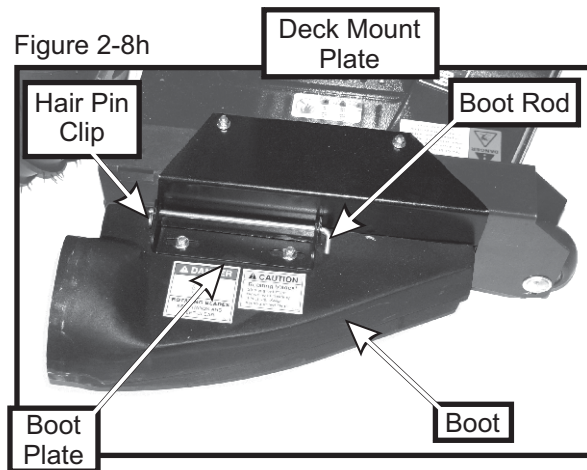

Position and secure the discharge mount plate P#(B0819) to the mower deck using (1) 3/8"-16 x 1" carriage bolt P#(K1182) and (1) 3/8"-16 nylon flange locknut P#(K2038) as shown in Figure 2-8e.

Xcaliber Boot Plate Mounting Locations

Refer to Figure 2-8g for Xcaliber boot plate mounting locations.

Figure 2-8g

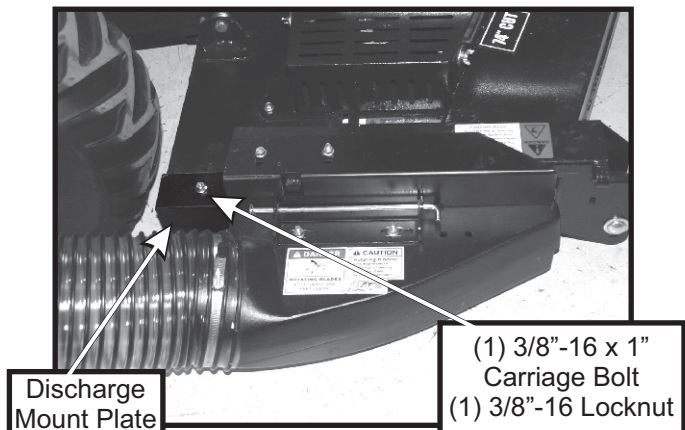
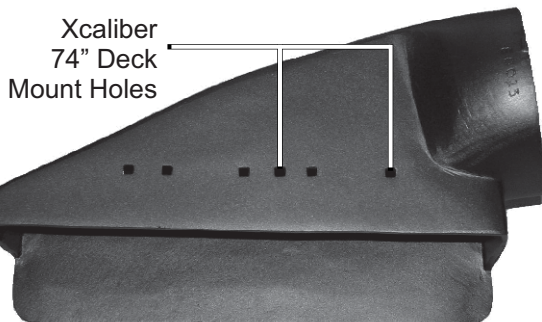

2-09 Length Of Hose Adjustment

The hoses in steps 2-10 and 2-11 must be cut to fit your machine. Follow steps 2-10 and 2-11. do not cut the hoses until you have tried to fit them on your machine. Remember that the hoses have to be long enough to adjust for the blower assembly's movement as well as allow for enough clamping surface between the inlet, blower assembly, and the deck boot.

2-10 Upper Hose Installation

Slide a pre-assembled hose clamp P#(J0060) onto both ends of the 6" upper hose (Figure 2-10). Then slide one end of the 6" hose onto the plastic inlet P#(V1054) on the right side of the aluminum box assembly. Make sure there is about a two-inch overlap between the hose end and plastic inlet. Secure the hose ring with the locking pin. Proceed to slide the opposite end of the 6" hose onto the outlet of the blower assembly. See (Figure 2-10) for details. Make sure both ends of the hose are clearly attached to the inlet and the blower assembly inlet. Tighten the hose clamps.

2-11 Lower Hose To Blower Cone Installation

Slide a pre-assembled hose clamp P#(J0080) over both ends of the lower hose. Then proceed to slide the lower hose onto the blower cone. Tighten the hose clamp. The assembly should look like Figure 2-10.

2-12 Lower Hose To Boot Installation

Take the unattached end of the lower hose and slide it over the circular end of the boot. Use the lower hose clamp to secure the hose to the boot (Figure 2-10). Tip: Before securing clamp rotate hose counter-clockwise (away from yourself) approximately 1" to aid in retaining boot to mower deck.

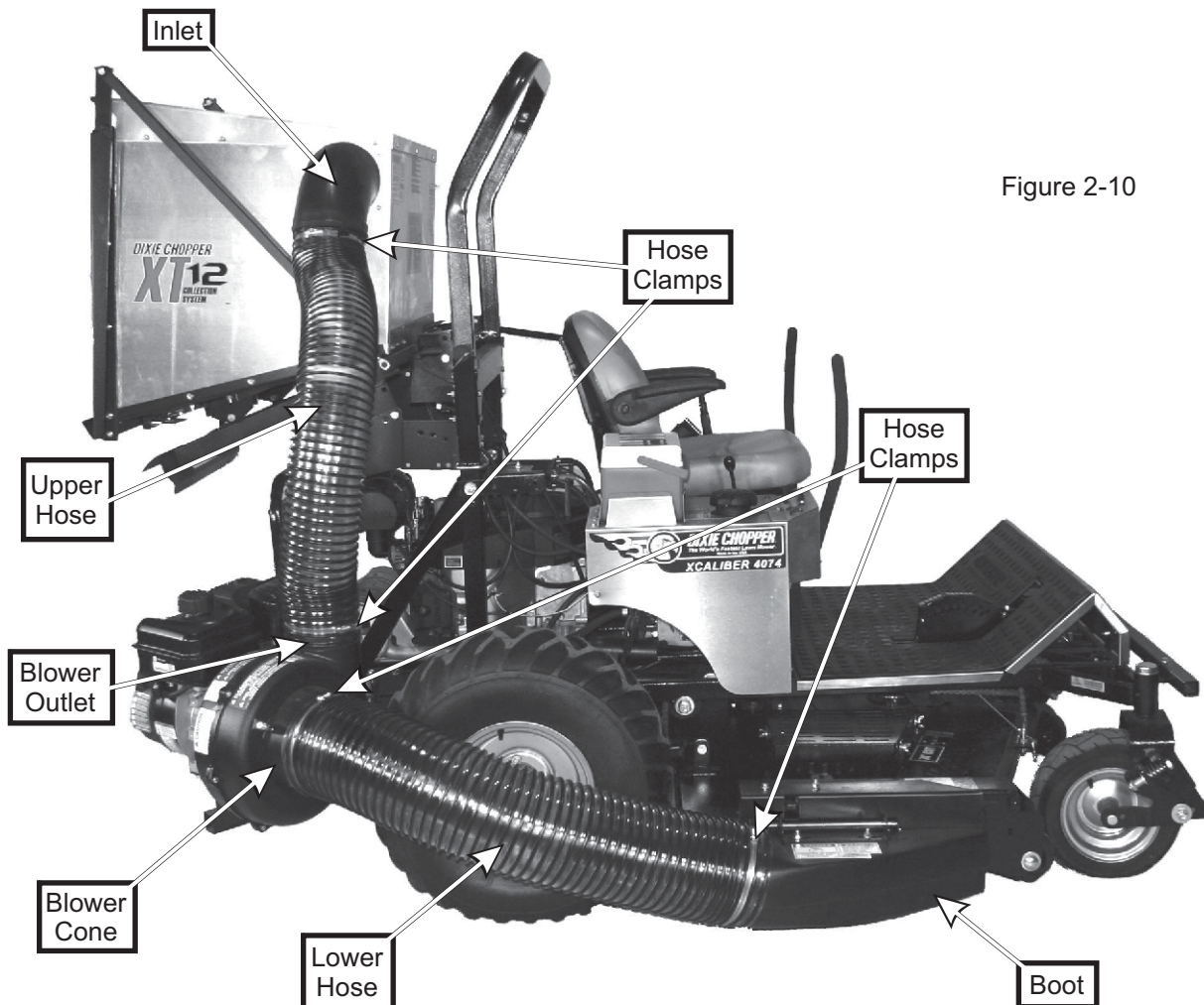

Figure 2-10

2-13 Impeller Blade Removal/Replacement

To gain impeller blade (#1) access, first remove the blower cone (#2) from the blower housing, located on the PTO assembly P#(A1821), by removing two blower cone bolts and nuts (#3). Next, remove the blower housing front (#4) by removing seven bolts and nuts (#5) around the outer housing edge. Refer to Figure 2-13.

To Remove: First, remove one 3/8"-16 x 1-1/2" HHCS P#(K1211) (#6), one taper-lock bushing washer P#(K0278) (#7) and one spacer bushing P#(S3242) (#8) from the taper-lock bushing (#9). See Figure 2-14. Next, remove two 1/4"-20 x 1" HHCS (#10) and place them into the threaded holes (#11) of the taper-lock bushing P#(S4302). Last, gradually thread each bolt evenly into the taper-lock bushing, forcing the blade to break-away from the taper-lock bushing.

Tips on removing impeller blade;

- 1 - Try carefully hitting the base of the impeller blade (#1), between each vein (#12), with a rubber mallet to loosen the taper-lock bushing hold.
- 2 - Spray break-free lubricant into the surrounding areas of the taper-lock bushing (#9) and repeat Tip 1.

To Replace: First, place the impeller blade (#1) over the drive shaft (#13). Next, slide the taper-lock bushing (#9) on to the drive shaft and into the impeller blade, aligning the **non-threaded** holes (#14) of the taper-lock bushing to the threaded holes of the impeller blade. Then, fasten by using two 1/4"-20 x 1" HHCS (#10), one spacer bushing (#8) one taper lock bushing washer (#7), and one 3/8"-16 x 1-1/2" HHCS (#6). Torque all bolts to the specifications located in the chart towards the back of this manual. Last, rotate the impeller blade to ensure that the blade is clear of contact on all sides of the blower housing.

Figure 2-13

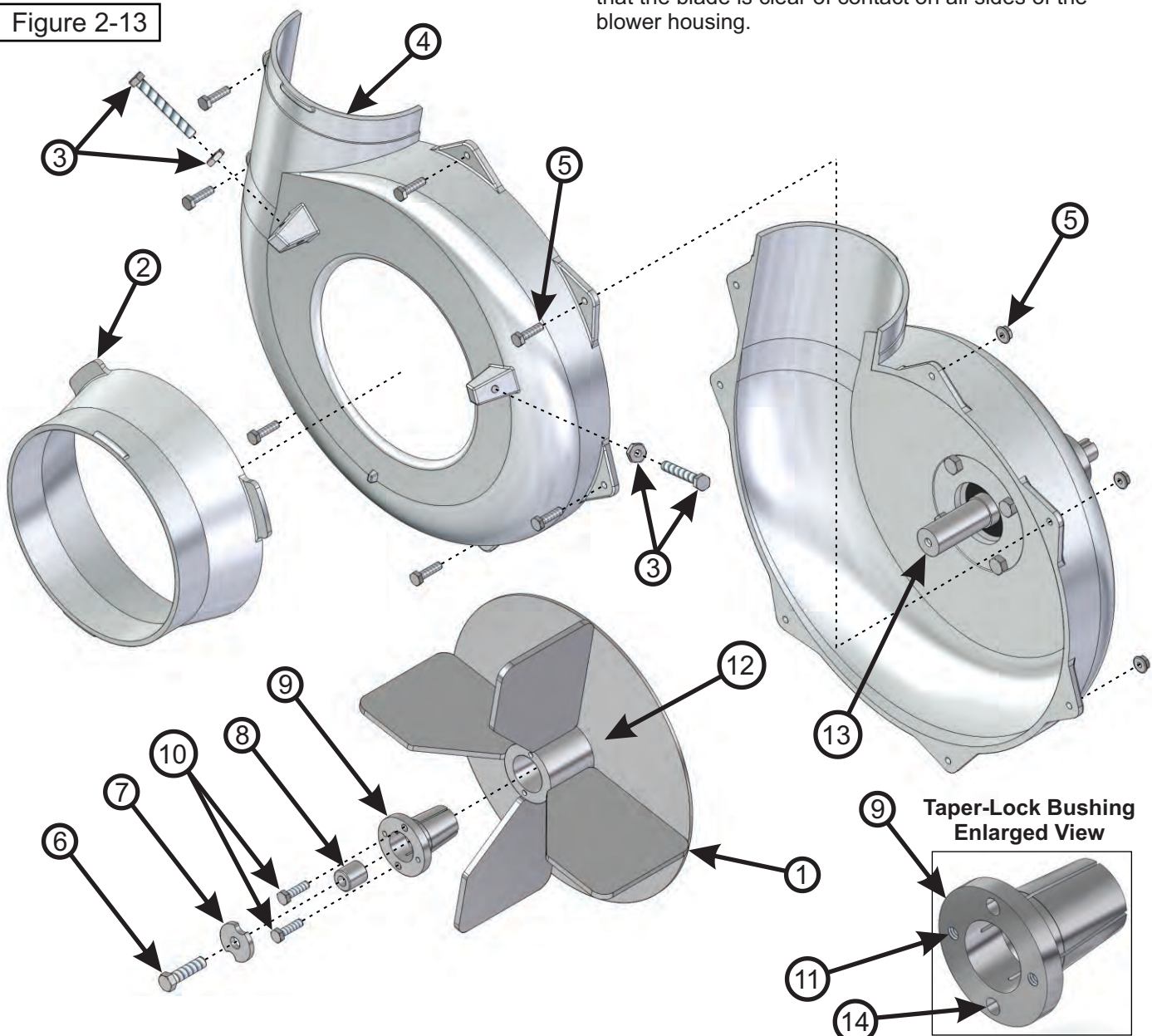

2-14 Weight Kit Installation

NOTE: It is recommended that someone assist you in the weight kit installation procedure.

Remove the front bumper and hardware from the mower frame. Attach the left weight bracket P#(B0383L) and right weight bracket P#(B0383R) to the front frame of the mower. Insert each weight bracket onto the frame tube. Secure each weight bracket using (2) 3/8"-16 x 3-1/2" HHCS P#(K1200), (1) 3/8" flat washers P#(K0047) and (2) 3/8"-16 nylon flange lock nuts P#(K2038). The (2) washers are used on the slotted holes on each weight bracket. Leave the hardware finger tight so the position of the weight brackets can be adjusted left or right if necessary. Refer to Figure 2-14a.

Using two people, lift the weight bar P#(B2220) into position. Secure the weight bar to the left and right weight brackets using (2) 1/2"-13 x 4-1/4" u-bolts P#(K0331) and (4) 1/2"-13 nylon flange locknuts P#(K0212). Use Figure 2-14b for reference. **NOTE:** Before tightening the u-bolts, make sure the weight bar is centered between the weight brackets.

Replace the front bumper, adding (2) 1.187 x .380 x .187 flat washers P#(K1446) as spacers to allow clearance for the left and right weight bracket. Tighten all weight kit hardware at this time. Refer to Figure 2-14b for reference.

Figure 2-14a

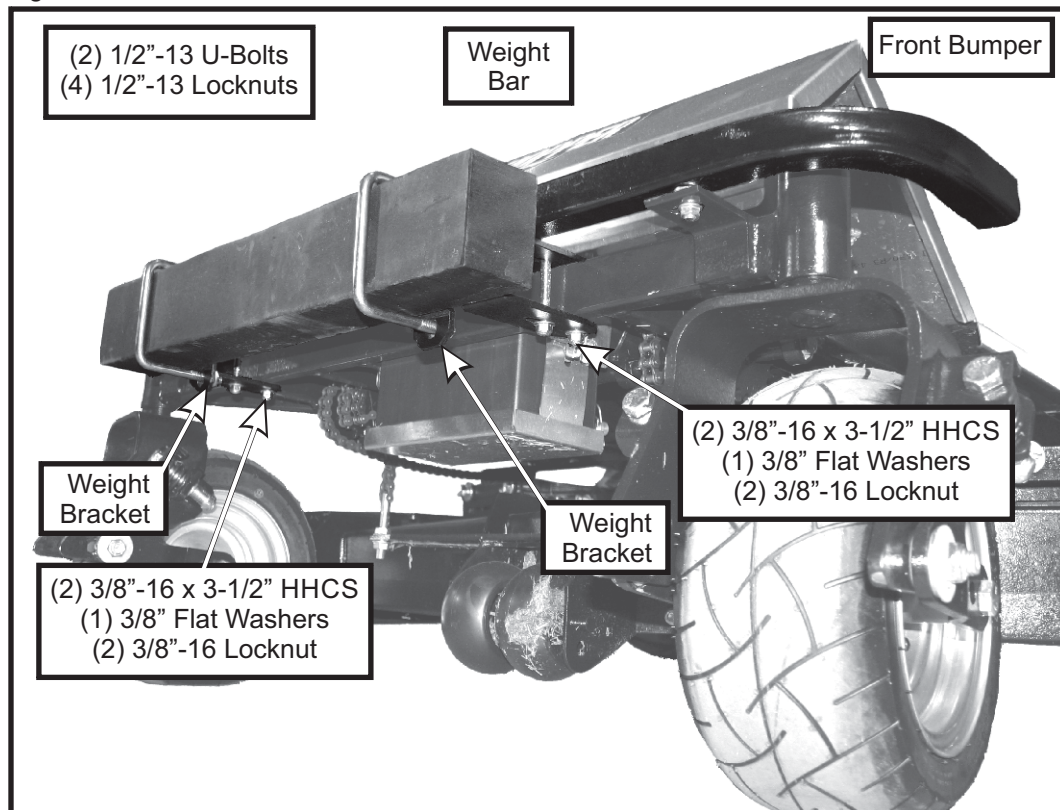
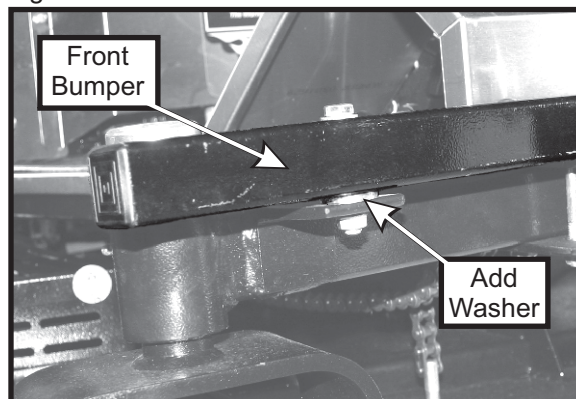

Figure 2-14b



DIXIE CHOPPER®

XT12

COLLECTION SYSTEM

Unit Model #: 38621239

Mower: Dixie Chopper	Owner's Manual: Q0464
Mower Type: Classic 2750, 2760 & 3372	Engine Type: KW 27HP & GEN 33HP
Deck Size: 50", 60" & 72"	Vac Type: 12 Cu. Ft. Pro 12 DFS
Deck Type:	Drive Type: Briggs & Stratton 6.5HP Vanguard
Revision #: Final Release	Fits Year(s): 2011-2014

A1922 Boot Kit

- (1) E0023 Boot
- (1) R4015 Label
- (1) R2007 Label
- (1) HB0492 Hardware Bag
- (1) B0793 Discharge Mount Plate
- (1) B0333 Boot Rod
- (1) B0774 Deck Plate
- (1) B0775 Boot Plate

A1879 Weight Kit

- (1) B2220 27" Weight Bar
- (1) HB0488 Hardware Bag
- (1) B0383R Rt. Weight Bracket
- (1) B0383L Lt. Weight Bracket

A1910 Mount Kit

- (1) F0080 8" x 36" LOWER HOSE
- (1) HB0557 Hardware Bag
- (2) J0080 Hose Clamps
- (1) A1916 Engine Mnt. Arm Assy.
- (1) E6009 8" BLOWER CONE
- (2) B0569 Outer Engine Mount Brackets
- (1) B3727 Outer Eng. Mnt. Tube

A0619 Throttle Kit

- (1) A0666 Throttle Mnt. Pl. Assy.
- (1) A0060 70" Throttle
- (1) HB0249 Hardware Bag
- (1) A639 Engine/Blower/Blade Assy.

A1927 Vac Kit

- (1) R2007 Label
- (1) V1054 Plastic Inlet
- (1) A1189 Box Assembly
- (1) HB0560 Hardware Bag
- (2) B2526 Door Linkage
- (1) B0302 Main Frame Clamp
- (1) A1097 Main Frame Assembly
- (1) B0777 Frame Mnt. Spacer
- (1) F0060 6" x 42" Upper Hose
- (2) J0060 Hose Clamps
- (1) A0273 Box Handle Assy.

Unit Model #: 38621240

Mower: Dixie Chopper

Owner's Manual: Q0464

Mower Type: Xcaliber 3374 & 4074

Engine Type: Generac 33HP Kohler 40HP

Deck Size: 74"

Vac Type: 12 Cu. Ft. Pro 12 DFS

Deck Type:

Drive Type: Briggs & Stratton 6.5HP Vanguard

Revision #: Final Release 3/18/2013

Fits Year(s): 2011-2014

A1926 Vac Kit

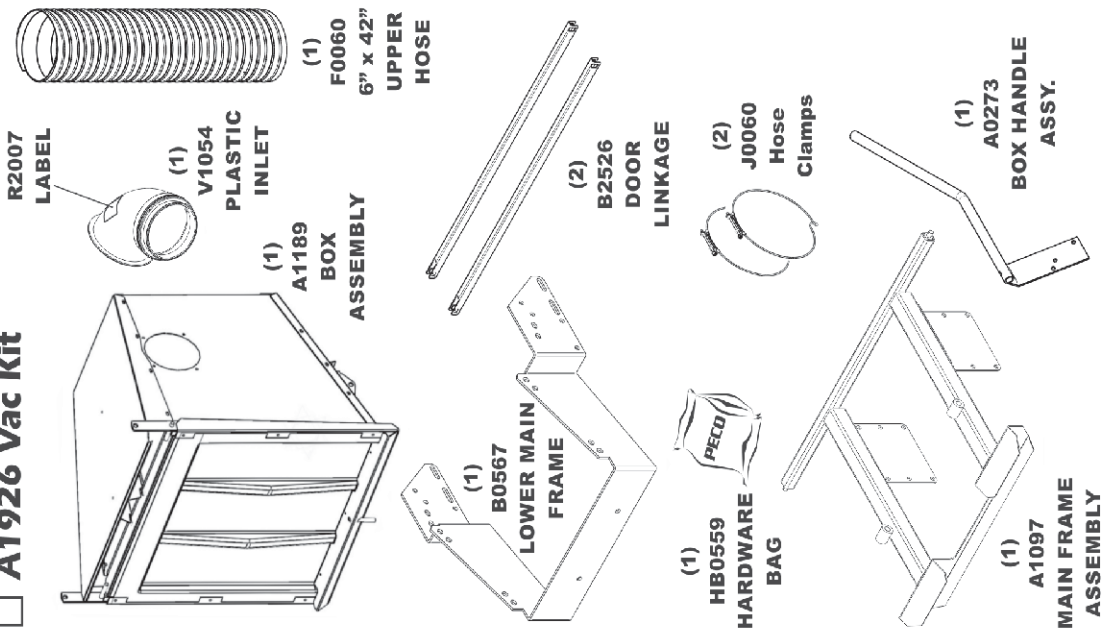

A1910 Mount Kit

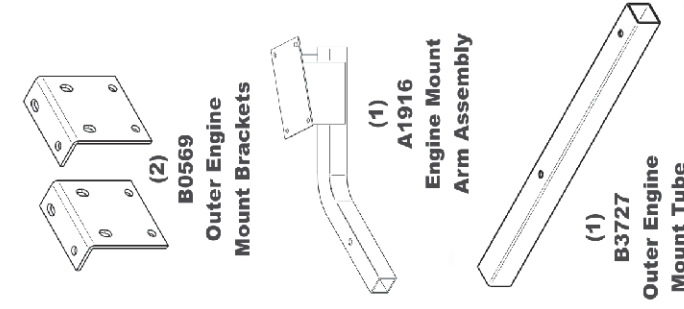
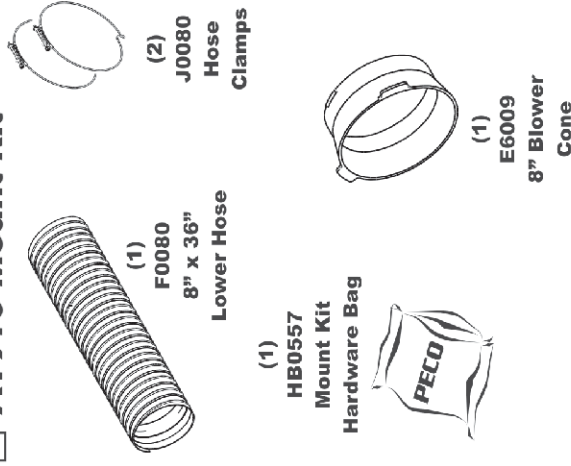

A1921 Boot Kit

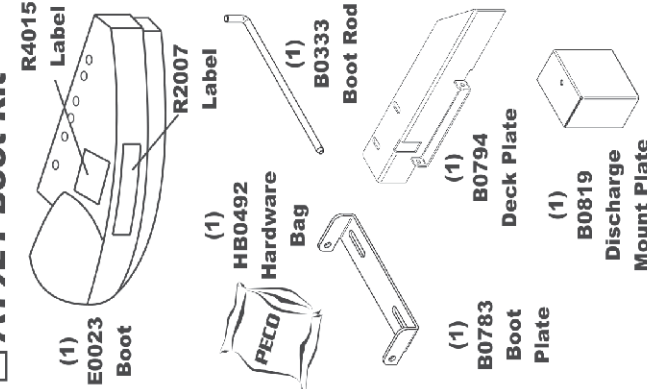

A1879 Weight Kit

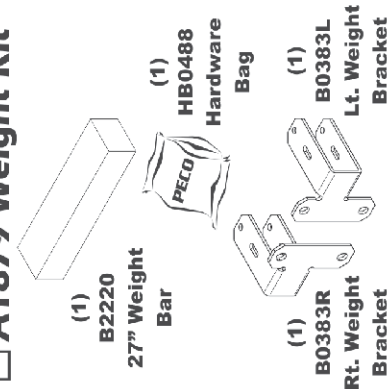

A0619 Throttle Kit

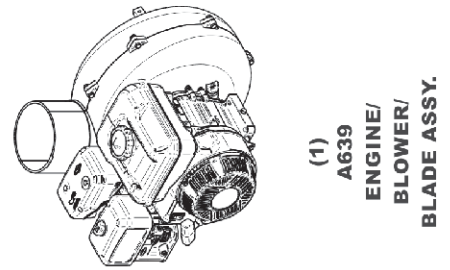
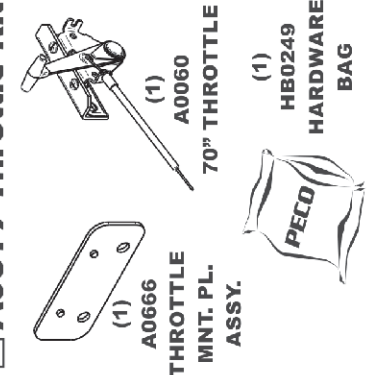

SECTION III OPERATING INSTRUCTIONS

3-1 General Safety

Only qualified people familiar with this operator's manual and the mower's operator's manual should operate this machine.

3-2 Operation And Tips On Mowing

- A. Perform BEFORE EACH USE the maintenance list in paragraph 4-1.
- B. Start the engine/blower/blade assembly.
- C. Start the mower.
- D. Engage the mower deck.

NOTE: If the collection system does not appear to be collecting the grass clippings; disengage the deck, engage the parking brake and turn the mower off, then turn off the engine/blower/blade assembly. Check the upper hose, lower hose, top screen and boot for clogs. To obtain the maximum effectiveness from your collection system the tips listed below should be followed:

- * Watch your speed- Normal conditions will allow a speed of up to approximately 5 mph, but thick, heavy damp conditions will require reduced ground speed.
- * Mow with sharp blades- A sharp blade cuts cleaner.
- * Wet grass and leaves will decrease effectiveness and will increase horsepower requirements.
- * Mow at higher cutting heights- Remove and mulch no more than 2" of grass length with each mowing. (Experts recommend not cutting off more than 1/3 of the grass blade length at any given time.)
- * Mow twice, at different height settings, (high, then low), if grass is extra tall.
- * Remember that horsepower requirements will vary with the mowing conditions such as type and height of turf grass, moisture content, amount of leaves, whether the terrain is flat or hilly, etc.

3-3 Disengagement Of The Blower

- A. Turn the engine/blower/blade assembly off.

WARNING: The blower will continue to spin. DO NOT TOUCH the blower until the blades have come to a complete stop.

3-4 Unloading The Collection System

NOTE: Press the tab, located behind the operator's left side, downward to feel if the collection system is full. If the container is full there will be resistance when depressing the tab.

- A. Stop the forward movement of the mower.
- B. Disengage the mower deck.
- C. Turn off the engine/blower/blade assembly.
- D. Verify that the dump area is clear.
- E. Push the dump handle, on the left of the operator, away from the unit. While holding the handle pushed away, move the handle upward. The container door will swing upward and the container will rotate downward. The container will release its contents.
- F. Once the contents of the container have fallen out, the container is ready to move back into its normal operating position. With the handle in the 'away' position, pull the handle downward until it stops. Move the handle towards the center of the mower. This motion will allow the latch to lock back into collection position.

NOTE: If you do not hold the handle away from the mower as you pull the handle downward, the latch will not lock and the container can unexpectedly release the contents collected.

SECTION IV MAINTENANCE

4-1 Maintenance Checklist

Before each use:

1. Check blades and spindles to be sure that no foreign objects, such as wire or steel strapping bands, are wrapped around them.
2. Inspect blades for wear. Replace if necessary. If it is necessary to sharpen the blades, remove the blades from the spindles before sharpening. DO NOT sharpen blades while still attached to the mower.

3. Make sure all shields are in place and in good condition. Repair or replace any missing or damaged shields.
4. Listen for abnormal sounds, which might indicate loose parts, damaged bearings, or other damage. Correct any deficiency before continuing operation.
5. Check for wear or deterioration of the upper or lower hoses. If there are any portions of the hose that have been torn or worn through, replace with genuine PECO parts.

After Each Use:

1. Clean all debris from machine especially from the container, underneath the belt shields, and safety decals. Replace any missing or illegible decals.
2. Inspect the unit for worn or damaged components. Repair or replace before the next use. Any replacement component installed during repair shall include the component's current safety decal specified by the manufacturers to be affixed to the component.

SECTION V PARTS AND SERVICE

5-1 Parts And Service Information

Collection system owners should record the name and telephone number of their Dixie Chopper dealer. Your Dixie Chopper dealer will be happy to supply replacement parts, accessories, and do any service or repairs to your collection system. If for any reason your Dixie Chopper dealer is unable to service your collection system or supply replacement parts, contact Dixie Chopper and include the following information on the chart below.

THE SERIAL NUMBER PLATE IS LOCATED ON THE ALUMINUM BOX ASSEMBLY



WRITE THE MODEL AND SERIAL NUMBER IN THE BOX ABOVE FOR FUTURE REFERENCE.

Unit Model Number: _____
Unit Engine Size: _____
Unit Serial Number: _____
Date of purchase: ____/____/____
Dealer/Distributor Name: _____
Address: _____ **State:** _____ **Zip:** _____
Phone Number: _____

SAFETY DECALS

To promote safe operation, Dixie Chopper supplies safety decals on all products manufactured. Damage can occur to safety decals either through shipment, use or reconditioning. Contact your local Service Center for replacement decals.



R2008



R2007

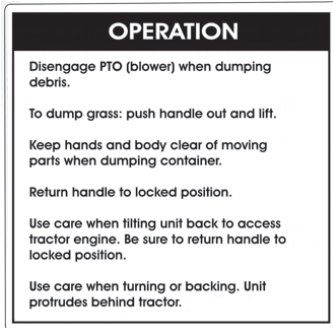

Part #: R1049



Part #: R1069



Part #: R1053



Part #: R1057



Part #: R1055



Part #: R4037



Part #: R1054



Part #: R4015



Part #: R1065



Part #: R1051



Part #: R0014



Part #: R4008



Part #: R0015

TORQUE SPECIFICATIONS

AMERICAN Bolt Head Markings

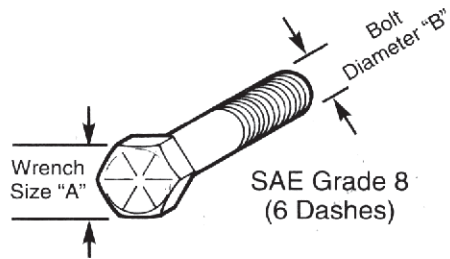

Recommended Torque in Foot Pounds (Newton Meters).*

WRENCH SIZE (IN.) "A"	BOLT DIAMETER (IN.) "B" AND THREAD SIZE	SAE GRADE 2	SAE GRADE 5	SAE GRADE 8
7/16	1/4 - 20 UNC	6 (7)	8 (11)	12 (16)
7/16	1/4 - 28 UNF	6 (8)	10 (13)	14 (18)
1/2	5/16 - 18 UNC	11 (15)	17 (23)	25 (33)
1/2	5/16 - 24 UNF	13 (17)	19 (26)	27 (37)
9/16	3/8 - 16 UNC	20 (27)	31 (42)	44 (60)
9/16	3/8 - 24 UNF	23 (31)	35 (47)	49 (66)
5/8	7/16 - 14 UNC	32 (43)	49 (66)	70 (95)
5/8	7/16 - 20 UNF	36 (49)	55 (75)	78 (106)
3/4	1/2 - 13 UNC	49 (66)	76 (103)	106 (144)
3/4	1/2 - 20 UNF	55 (75)	85 (115)	120 (163)
7/8	9/16 - 12 UNC	70 (95)	109 (148)	153 (207)
7/8	9/16 - 18 UNF	79 (107)	122 (165)	172 (233)
15/16	5/8 - 11 UNC	97 (131)	150 (203)	212 (287)
15/16	5/8 - 18 UNF	110 (149)	170 (230)	240 (325)
1-1/8	3/4 - 10 UNC	144 (195)	266 (360)	376 (509)
1-1/8	3/4 - 16 UNF	192 (260)	297 (402)	420 (569)
1-5/16	7/8 - 9 UNC	166 (225)	430 (583)	606 (821)
1-5/16	7/8 - 14 UNF	184 (249)	474 (642)	668 (905)
1-1/2	1 - 8 UNC	250 (339)	644 (873)	909 (1232)
1-1/2	1 - 12 UNF	274 (371)	705 (955)	995 (1348)
1-1/2	1 - 14 UNF	280 (379)	721 (977)	1019 (1381)
1-11/16	1-1/8 - 7 UNC	354 (480)	795 (1077)	1288(1745)
1-11/16	1-1/8 - 12 UNF	397 (538)	890 (1206)	1444 (1957)
1-7/8	1-1/4 - 7 UNC	500 (678)	1120 (1518)	1817 (2462)
1-7/8	1-1/4 - 12 UNF	553 (749)	1241 (1682)	2013 (2728)
2-1/16	1-3/8 - 6 UNC	655 (887)	1470 (1992)	2382 (3228)
2-1/16	1-3/8 - 12 UNF	746 (1011)	1672 (2266)	2712 (3675)
2-1/4	1-1/2 - 6 UNC	870 (1179)	1950 (2642)	3161 (4283)
2-1/4	1-1/2 - 12 UNF	979 (1327)	2194 (2973)	3557 (4820)

METRIC

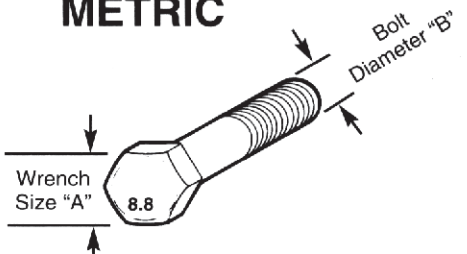

Numbers appearing on bolt heads indicate ASTM class.

Recommended torque in foot pounds (newton Meters).*

WRENCH SIZE (mm) "A"	BOLT DIA. (mm) "B"	ASTM 4.6	ASTM 8.8	ASTM 9.8	ASTM 10.9
8	5	1.8 (2.4)		5.1 (6.9)	6.5 (8.8)
10	6	3 (4)		8.7 (12)	11.1 (15)
13	8	7.3 (10)		21.1 (29)	27 (37)
16	10	14.5 (20)		42 (57)	53 (72)
18	12	25 (34)	74 (100)	73 (99)	93 (126)
21	14	40 (54)	118 (160)	116 (157)	148 (201)
24	16	62 (84)	167 (226)	181 (245)	230 (312)
30	20	122 (165)	325 (440)		449 (608)
33	22		443 (600)		611 (828)
36	24	211 (286)	563 (763)		778 (1054)
41	27		821 (1112)		1138 (1542)
46	30	418 (566)	1119 (1516)		1547 (2096)

*Use 75% of the specified torque value for plated fasteners. Use 85% of the specified torque values for lubricated fasteners.



**Contact: service@dixiechopper.com
765-246-6191 FAX 765-246-6017**