

# MODEL#: 21131205

**MOWER NAME: CUB CADET**

**MOWER MODEL: TANK W/ 23HP KW**

**MOWER DECK SIZE: 48", 54", & 60"**

**VAC NAME: 12 CUBIC FOOT PRO BAGGER**

**PTO DRIVEN**

**A1787 UNIT ASSEMBLY**



FOR YEAR: 2010

REVISED:

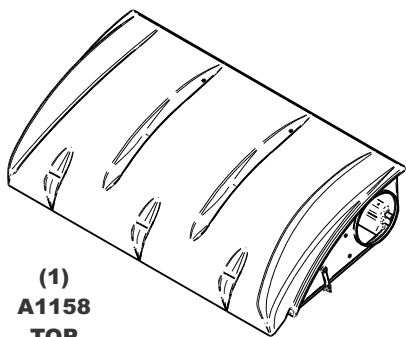

(1)  
**A1158  
TOP  
ASSY.**



(1)  
**V0025  
6" & 7"  
PLASTIC  
INLET**



(1)  
**F0004  
7" x 35"  
LOWER  
HOSE**



(1)  
**F0001  
6" x 21"  
UPPER  
HOSE**



(4)  
**J1000  
2" - 10"  
HOSE  
CLAMPS**

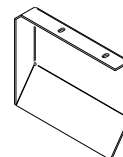

(1)  
**C0058  
EXHAUST  
DEFLECTOR**



(1)  
**HB0425  
HARDWARE  
BAG**

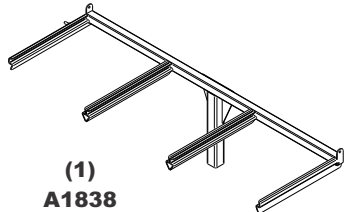

(1)  
**A1838  
UPPER FRAME  
ASSEMBLY**

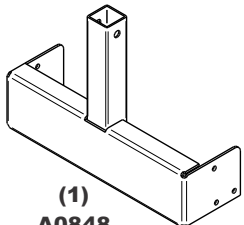

(1)  
**A0848  
LWR. MNT  
ASSY.**

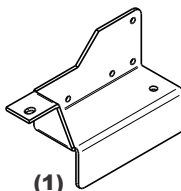

(1)  
**B0395  
LT. LWR.  
MOUNT PL.**

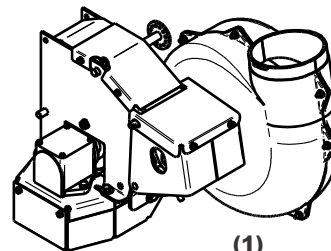

(1)  
**A0623  
PTO  
ASSEMBLY**



(1)  
**HB0426  
ENGINE  
PULLEY  
HARDWARE  
BAG**

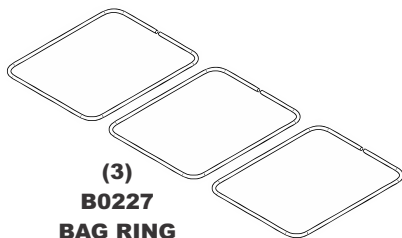

(3)  
**B0227  
BAG RING**

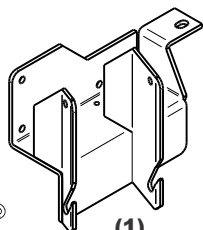

(1)  
**A0846  
PTO MOUNT  
PLATE ASSY.**

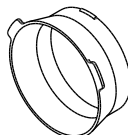

(1)  
**E6004  
7" BLOWER  
CONE**

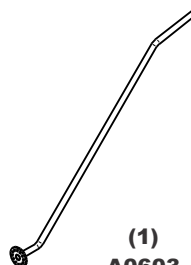

(1)  
**A0603  
PTO HANDLE  
ASSY.**

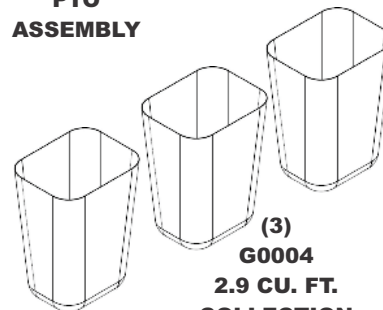

(3)  
**G0004  
2.9 CU. FT.  
COLLECTION  
BAGS**

**A1784 - WEIGHT KIT**

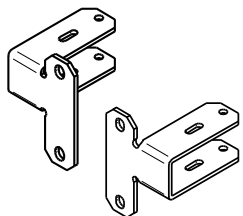

(1 LEFT)  
(1 RIGHT)  
**B0383  
WEIGHT  
BKRT.**



(1)  
**HB0421  
HARDWARE  
BAG**



(1)  
**B2220  
WEIGHT BAR**

**A0690 - BOOT KIT**



(1)  
**HB0078  
HARDWARE  
BAG**

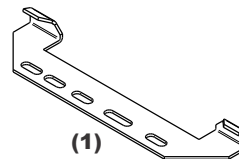

(1)  
**B2555  
BOOT  
PLATE**

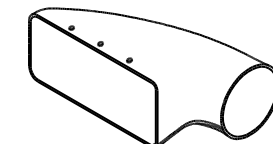

(1)  
**E1031  
BOOT**

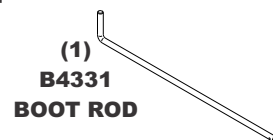

(1)  
**B4331  
BOOT ROD**