

# MODEL#: 47131501 (GC-350)

MOWER NAME: BUSH HOG

MOWER MODEL: COMMERCIAL Z & PRO Z SERIES

MOWER DECK SIZE: 49", 55" & 61" DECK

VAC NAME: 15 CUBIC FOOT PRO BAGGER

PTO DRIVEN

BILL OF MATERIALS: BOM0266



FOR YEAR: 2011-2006

REVISED: 6/21/2011

## A0637 UNIT ASSEMBLY

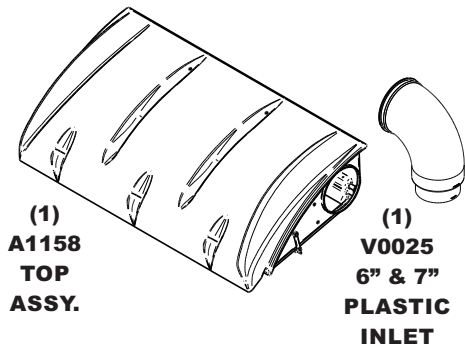

(1)  
A1158  
TOP  
ASSY.

(1)  
V0025  
6" & 7"  
PLASTIC  
INLET

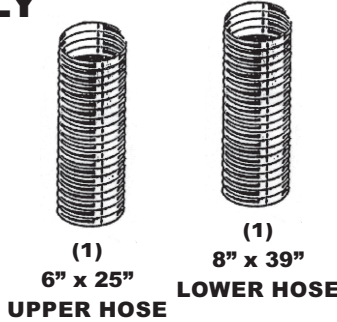

(1)  
6" x 25"  
UPPER HOSE

(1)  
8" x 39"  
LOWER HOSE

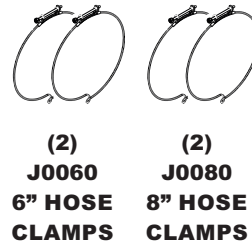

(2)  
J0060  
6" HOSE  
CLAMPS

(2)  
J0080  
8" HOSE  
CLAMPS

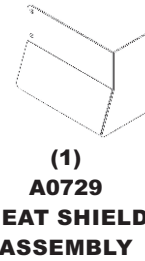

(1)  
A0729  
HEAT SHIELD  
ASSEMBLY



(1)  
HB0341  
HARDWARE  
BAG

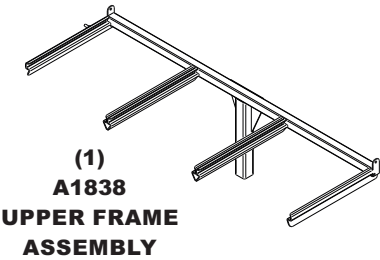

(1)  
A1838  
UPPER FRAME  
ASSEMBLY

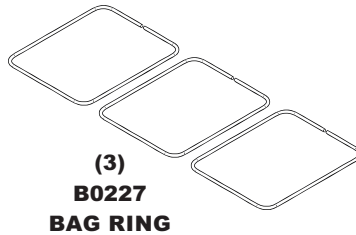

(3)  
B0227  
BAG RING

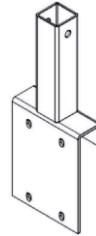

(1)  
A0621  
LWR. MOUNT  
ASSEMBLY

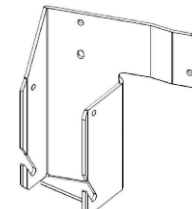

(1)  
B0272  
PTO ASSY.  
MOUNT PLATE

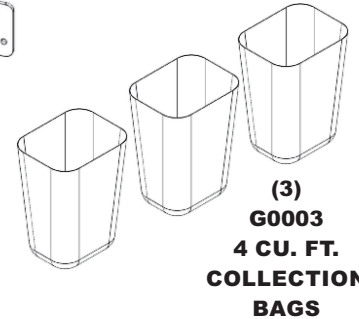

(3)  
G0003  
4 CU. FT.  
COLLECTION  
BAGS

## A0997 BLOWER, BOOT AND WEIGHT KIT

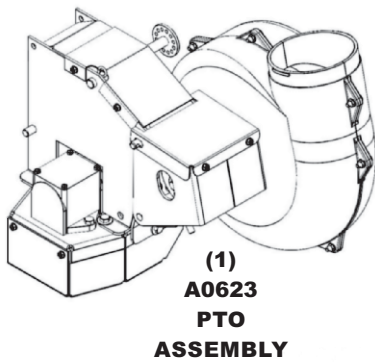

(1)  
A0623  
PTO  
ASSEMBLY



(1)  
E6009  
BLOWER  
CONE 8"

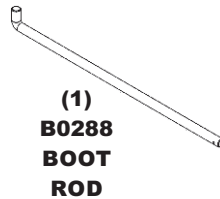

(1)  
B0288  
BOOT  
ROD



(1)  
HB0340  
BLOWER AND  
BOOT KIT  
H.W. BAG  
CONTAINING:

NOTE: WEIGHT BAR  
MUST BE 3" OR LESS  
ON THE SHORT  
WIDTH.

(1)  
B2220  
WEIGHT  
BAR

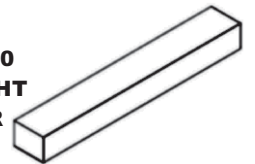

(1)  
HB0239  
BOOT KIT  
H.W. BAG

(1)  
HB0240  
WEIGHT KIT  
H.W. BAG

(1)  
HB0243  
ENGINE PULLEY  
H.W. BAG

(1)  
A0626  
PTO  
HANDLE  
ASSEMBLY



(1)  
E1125  
BOOT

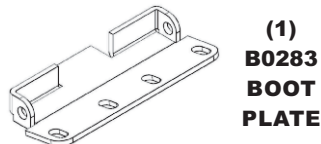

(1)  
B0283  
BOOT  
PLATE

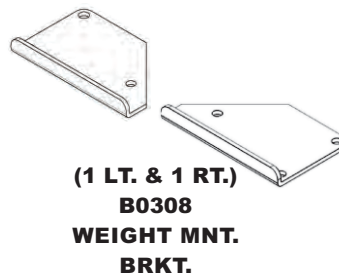

(1 LT. & 1 RT.)  
B0308  
WEIGHT MNT.  
BRKT.

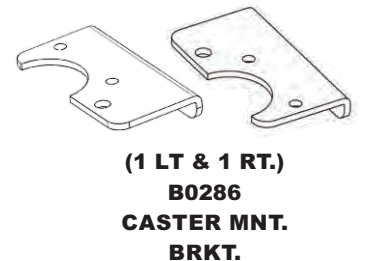

(1 LT & 1 RT.)  
B0286  
CASTER MNT.  
BRKT.