

MODEL#: 06131508

MOWER NAME: JOHN DEERE

MOWER MODEL: Z900 SERIES

MOWER DECK SIZE: 60" 7-IRON

VAC NAME: 15 CUBIC FOOT PRO BAGGER

6.5 BRIGGS AND STRATTON VANGUARD

MANUAL: Q0404



FOR YEAR: 2009 - 2011

REVISED: 7/31/2014

A1777 UNIT ASSEMBLY

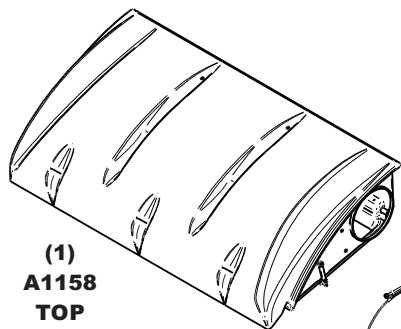

(1)
A1158
TOP
ASSY.

(1)
V0025
6" & 7"
PLASTIC
INLET



(1)
F0011
9" x 38"
LOWER
HOSE



(1)
F0001
6" x 30"
UPPER
HOSE



(2)
J0060
6" HOSE
CLAMPS



(2)
J0090
9" HOSE
CLAMPS



(1)
E6020
9" BLOWER
CONE

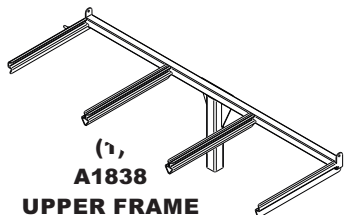

(1)
A1838
UPPER FRAME
ASSEMBLY

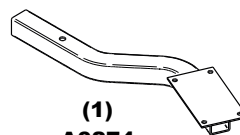

(1)
A0274
ENGINE MNT.
ARM ASSY.



(1)
HB0414
HARDWARE
BAG

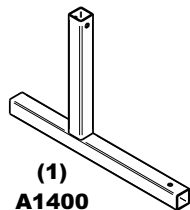

(1)
A1400
LWR. MNT.
TUBE ASSY.

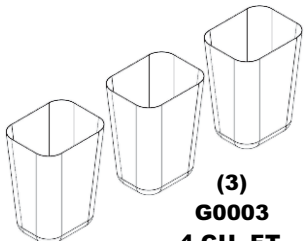

(3)
G0003
4 CU. FT.
COLLECTION
BAGS



(1)
B0597
LT. LWR.
MAIN FRAME
LEG

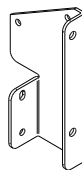

(1)
B0598
RT. LWR.
MAIN FRAME
LEG

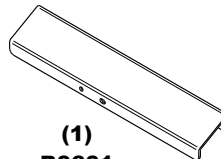

(1)
B0601
MNT. TUBE
SUPPORT BRKT.

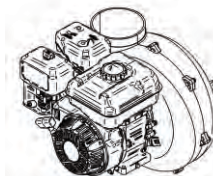

(1)
A639
ENGINE/
BLOWER/
BLADE ASSY.

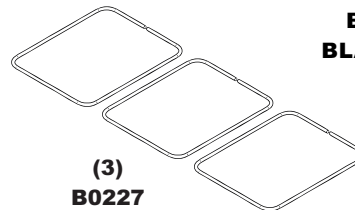

(3)
B0227
BAG RING

A1768 - WEIGHT KIT



(1)
HB0413
HARDWARE
BAG

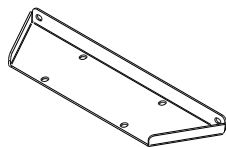

(1)
B0600
WEIGHT
BRACKET

(1)
B0035
WEIGHT

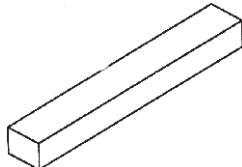

A1767 - 60" BOOT KIT



(1)
HB0412
HARDWARE
BAG

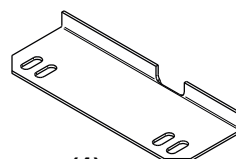

(1)
B1815
BOOT
PLATE

(1)
E1126
BOOT

