

MODEL#: 21621211

MOWER NAME: CUB CADET

MOWER MODEL: TANK W/ 23HP KW

MOWER DECK SIZE: 48", 54", & 60"

VAC NAME: 12 CUBIC FOOT PRO 12

PTO DRIVEN

A1786 UNIT ASSEMBLY



FOR YEAR: 2010

REVISED:

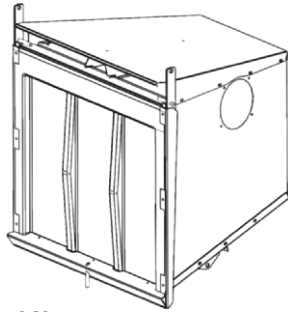

(1)
A0794
12 CU. FT.
BOX ASSY.



(1)
V1054
6" PLASTIC
INLET

(1)
F0001
6" x 34"
UPPER HOSE



(1)
F0002
7" x 35"
LOWER HOSE



(2)
J0060
6" HOSE
CLAMPS



(2)
J0070
7" HOSE
CLAMPS



(1)
HB0427
HARDWARE
BAG

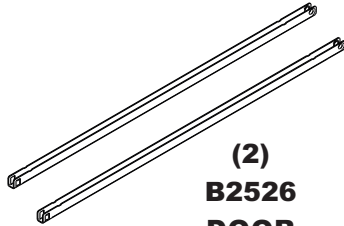

(2)
B2526
DOOR
LINKAGE

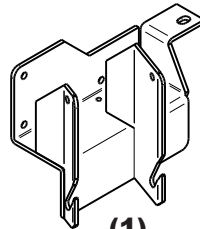

(1)
A0846
PTO MOUNT
PLATE ASSY.

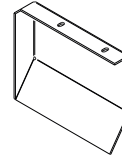

(1)
C0058
EXHAUST
DEFLECTOR

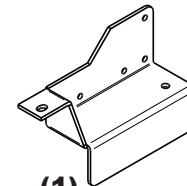

(1)
B0395
LT. LWR.
MOUNT PL.



(1)
HB0426
ENGINE
PULLEY
HARDWARE
BAG

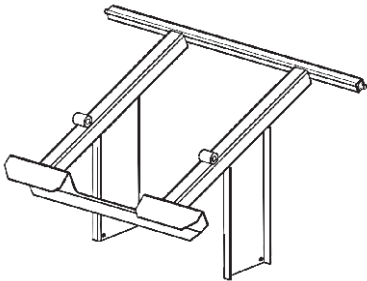

(1)
A0845
MAIN FRAME
ASSEMBLY

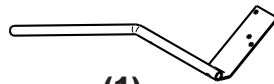

(1)
A0273
BOX HANDLE
ASSY.

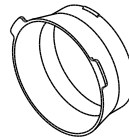

(1)
E6004
BLOWER
CONE 7"



(1)
A0603
PTO HANDLE
ASSY.

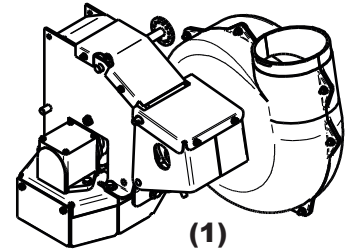

(1)
A0623
PTO
ASSEMBLY

A1784 - WEIGHT KIT

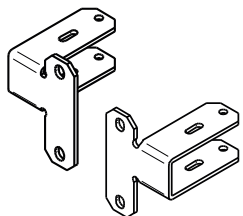

(1 LEFT)
(1 RIGHT)
B0383
WEIGHT
BKRT.



(1)
HB0421
HARDWARE
BAG

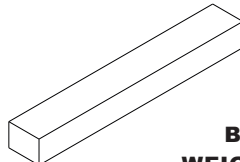

(1)
B2220
WEIGHT BAR

A0690 - BOOT KIT



(1)
HB0078
HARDWARE
BAG

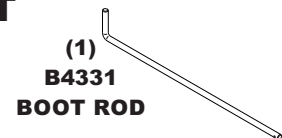

(1)
B4331
BOOT ROD

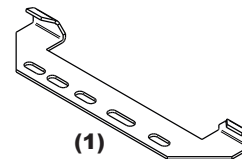

(1)
B2555
BOOT
PLATE

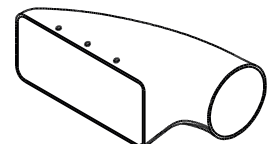

(1)
E1031
BOOT