

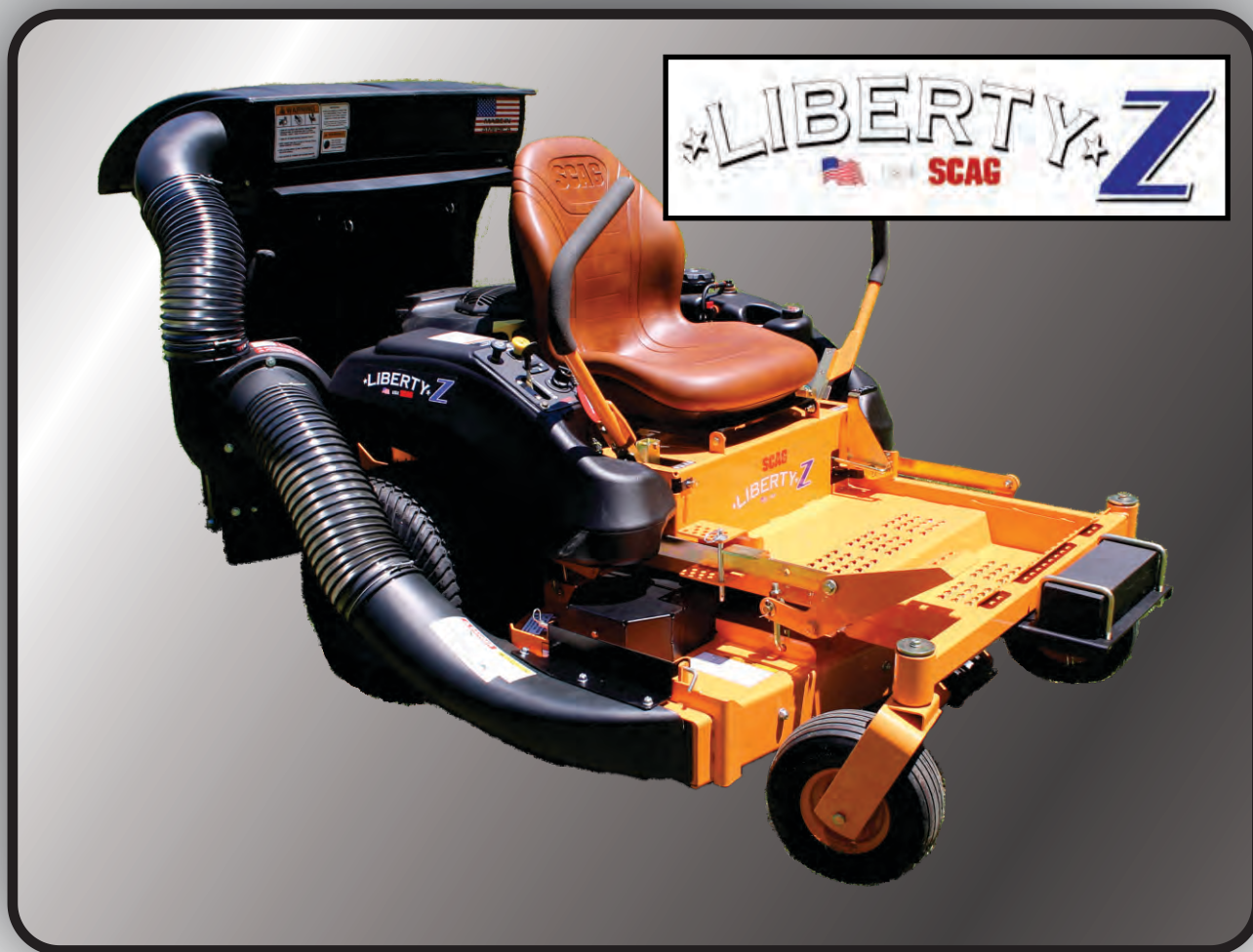

PRO 2 BAGGER+ **GRASS COLLECTION** **SYSTEM**

PECO MODEL#:
37120903 & 37120904

SCAG LIBERTY Z



OPERATOR'S MANUAL

ASSEMBLY ● OPERATION ● MAINTENANCE

RESIDENTIAL BAGGING SYSTEM

TABLE OF CONTENTS

SECTION	PAGE	SECTION	PAGE
Safety -----	2	Impeller Blade Removal and Replacement -----	11
Safety Alert Symbols-----	3	Boot To Mower Deck Installation-----	12
Warranty -----	4	Length of Hose Adjustment -----	13
I INTRODUCTION AND DESCRIPTION -----	5	Upper Hose Installation -----	13
Introduction -----	5	Lower Hose To Blower Cone Installation-----	13
Description-----	5	Lower Hose To Boot Installation -----	13
II INSTALLATION FOR USE-----	5	Weight Kit Installation-----	13
Preparation Of Mower -----	5	Installation and Removal of Collection Bags -----	14
Muffler Guard and Back Frame Plate Installation ----	6	III OPERATING INSTRUCTIONS -----	15
Right & Left Lower Frame Plate Installation-----	6	General Safety -----	15
Left PTO Mount Plate Installation -----	6	Operation & Tips On Mowing -----	15
Lower Mount Tube Installation -----	6	Disengagement Of The PTO Assembly -----	15
PTO Stop Plate Installation -----	7	Unloading The Collection System -----	15
Upper Frame Assembly Installation -----	7	IV MAINTENANCE -----	15
Top Assy. To Upper Frame Assy. Installation -----	7	Maintenance Checklist -----	15
PTO Assembly Installation -----	8	Lubrication -----	16
Hinge Kit Installation -----	8	V PARTS AND SERVICE-----	16
Belt Removal and Adjustment -----	9-10	Parts And Service Information -----	16
Blower Cone Installation -----	11	Pack Drawings-----	17-18
		Exploded Views And Parts List -----	19-21
		Safety Decals -----	22
		Torque Specifications -----	23
		Notes -----	24-25

SAFETY

1. Read the operator's manual carefully and familiarize yourself with the proper use of your attachment. Do not allow anyone who is not acquainted with the Safety Instructions to use your attachment.
2. Know the controls and how to stop quickly. **READ THE OPERATOR'S MANUAL!**
3. Do not allow children to operate the mower. Do not allow adults to operate the mower or grass collection system without proper instruction.
4. Be especially watchful of children and pets darting into the area while operating.
5. Keep your eyes and mind on your unit while mowing or operating your attachment. Don't let others distract you.
6. Do not attempt to operate your unit or mower when not in the driver's seat.
7. Always stop unit when emptying the container.
8. Stop unit, shut off deck attachment, set parking brake, shut off mower engine and remove spark plug wire before removing clogs, removing or replacing hose, boot, blower cone, or performing any maintenance.
9. If a slope must be ascended, back up the slope; drive forward when descending.
10. It is recommended that the container be kept only half full when negotiating any slopes. Start mowing on slopes when the container is empty and never mow slopes greater than 15 degrees.
11. Inspect your lawn and remove any foreign objects before mowing. Never deliberately run the mower across any foreign object.
12. Wear ear protection if the noise level is offensive.
13. Wear eye protection to prevent debris from damaging your eyes.

SAFETY

WARNING! **NEVER** operate the mower unless the discharge guard and either the deflector assembly or the vacuum collector adapter are fastened securely in place.

WARNING! Do not work around the mower deck boot or the blower area until you are certain that the mower blades and the blower impeller have stopped rotating.

WARNING! To avoid serious injury, perform maintenance on the vacuum collector; **ONLY AFTER STOPPING THE MOWER'S ENGINE AND WAITING FOR ALL MOVING PARTS TO COME TO A COMPLETE STOP.** Set the parking brake. Always remove the ignition key before beginning maintenance.

WARNING! For your own personal safety, **ALWAYS** back up the face of slopes. **NEVER** attempt to mow excessively steep slopes, and use caution when turning on any slope.

Safety Alert Symbol



This Safety Alert Symbol means: **“ATTENTION! BECOME ALERT! YOUR SAFETY IS INVOLVED!”**

This symbol is used to call attention to safety precautions that should be followed by the operator to avoid accidents. When you see this symbol, carefully read the message that follows and heed its advice. Failure to comply with safety precautions could result in death or serious bodily injury.

Safety Signs

The signal words **DANGER**, **WARNING**, and **CAUTION** are used on the equipment safety signs. These words are intended to alert the viewer to the existence and the degree of hazard seriousness.



White letters on **RED**

This signal word indicates a potentially hazardous situation which, if not avoided, will result in death or serious injury.



Black letters on **ORANGE**

This signal word indicates a potentially hazardous situation which, if not avoided, could result in death or serious injury.

It may also be used to alert against unsafe practices.



Black letters on **YELLOW**

This signal word indicates a potentially hazardous situation exist which, if not avoided, will result in minor or moderate injury.

It may also be used to alert against unsafe practices.

PECO LIMITED WARRANTY FOR NEW PRODUCTS

A. WHAT IS UNDER WARRANTY?

PECO extends the following warranties to the original purchaser of each new PECO consumer product subject to the following limitations.

1. PRODUCT WARRANTY: Any part of any consumer product, which is defective in material or workmanship as delivered to the purchaser will be repaired or replaced, as PECO elects, without charge for parts or labor, if the defect appears within 12 months from the date of delivery of the product to the original purchaser.

ALL DEFECTIVE PARTS MUST BE RETURNED TO PECO FOR INSPECTION TO DETERMINE VALIDITY OF WARRANTY CLAIMS. Freight and mailing will be borne by the customer.

2. PARTS REPLACED DURING WARRANTY: Any new PECO part which is furnished in performance of this warranty and is defective in material or workmanship as delivered to the purchaser will be repaired or replaced, as PECO elects, without charge if the defect appears within 90 days from the date of installation of such part or before the expiration of the original warranty period, whichever is later.

B. SECURING WARRANTY ADJUSTMENTS.

Call PECO for Return Authorization. Damaged or broken parts other than engines or batteries, must be returned to New PECO, Inc. 100 Airport Road, Arden, NC 28704 before any warranty adjustment can be authorized. At the time of requesting warranty adjustment, the purchaser must present evidence of the date of delivery of the product. The purchaser shall pay any charge for the product to and from Arden, NC.

C. ITEMS NOT COVERED BY PECO WARRANTY.

Engines and batteries attached to PECO products are covered under a separate warranty by the respective manufacturer.

D. UNAPPROVED ALTERATION OR MODIFICATION.

All obligations of New PECO, Inc. under this warranty shall be terminated if products are altered or modified in ways not approved by New PECO, Inc.

E. ACCIDENTS AND NORMAL MAINTENANCE.

The warranty covers only defective material and workmanship. It does not cover depreciation or damage caused by normal wear, accident, improper use or abuse of products. The cost of normal maintenance and normal replacement of service items such as belts, cutting blades, hoses, etc., which are not defective shall be paid for by the purchaser.

F. NO REPRESENTATIONS ADDITIONAL WARRANTIES, DISCLAIMER.

Neither New PECO, Inc. nor any company affiliated with it makes any warranties, representations or promises as to the quality of performance of its products other than those set forth herein. Except as described above, New PECO, Inc. makes no other warranties **AND SPECIFICALLY DISCLAIMS ANY AND ALL IMPLIED WARRANTIES OF FITNESS AND MERCHANTABILITY.**

G. ANY MACHINE USED FOR RENTAL PURPOSES ARE GUARANTEED FOR 45 DAYS FROM DATE OF ORIGINAL SALE ONLY.

H. REMEDIED EXCLUSIVE.

The only remedies the purchaser has in connection with the breach or performance of any warranty on New PECO, Inc. consumer products are set forth above. In no event will PECO be liable for special incidental or consequential damages.

1. NO SERVICE CENTER WARRANTY.

The selling Service Center makes no warranty on his own on any item warranted by New PECO, Inc. unless he delivers to purchaser a separate written warranty certificate specifically warranting the item. The dealer has no authority to make any representation or promise on behalf of PECO or to modify the terms of this warranty in any way.

Section I INTRODUCTION & DESCRIPTION

Introduction

Your grass collection system has been designed to give you a low maintenance, simple, and effective way to collect the grass clippings from your mower. This manual is provided to give you the necessary instructions to properly mount and operate the collection system on your mower. Please read this manual thoroughly. Understand what each control is for and how to use it. Observe all safety decal precautions on the machine and noted throughout the manual.

NOTE: all references made to right, left, front, rear, top or bottom are as viewed from the normal operator's position on the mower.

Description

The grass collection system is designed for turf maintenance where there is a need to collect the grass clippings as the mower cuts the turf. It is also used for picking up leaves in pre-season and post-season clean-up. The blower, mounted on the right side of the unit, uses a belt and gearbox system from the engine PTO shaft. Drive train protection comes through belt slippage. The blower draws grass clippings from the discharge area of the cutting deck back to the (2) - 3.3 cubic foot collection bags P#(G0002) at the rear portion of the mower frame. The operator can engage the blower with a spring-lock engagement handle on the right side of the unit. Once the bags are full with clippings, they can be easily released for dumping.

Section II INSTALLATION FOR USE

Preparation Of Mower

Remove the muffler guard (see Figure A) located underneath the back portion of the mower. Keep the (2) 3/8"-16 x 3/4" carriage bolts and (2) 3/8"-16 flange nuts for attaching the modified muffler guard provided at a later time.

Figure A

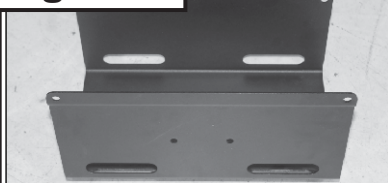

Next, remove grass deflector and hardware from the mower deck as shown in Figure B.

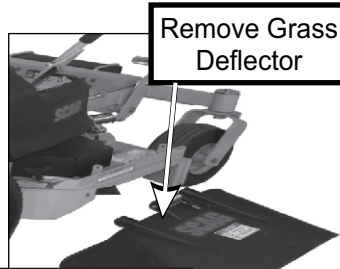
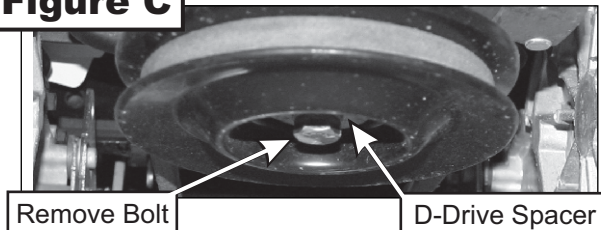

Figure B

Figure C



Preparation Of Mower

From the underside of the engine, disconnect the wiring harness attached to the electric clutch. Remove the bolt and electric clutch from the mower. Refer to Figure C. Remove the D-drive spacer using an arbor press or equivalent. On removal, adjacent bearing OUTER race must be supported or bearing damage may occur. Refer to Figure D.

Figure D

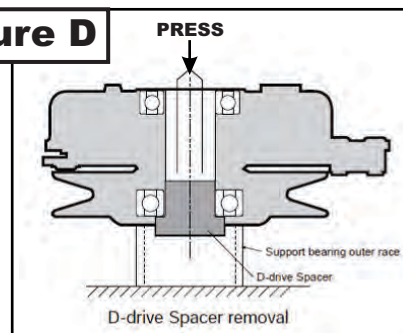

The engine pulley assembly must be installed using an arbor press or equivalent. Upon Installation, opposite bearing inner race must be supported or bearing damage may occur. Refer to Figure E.

Figure E

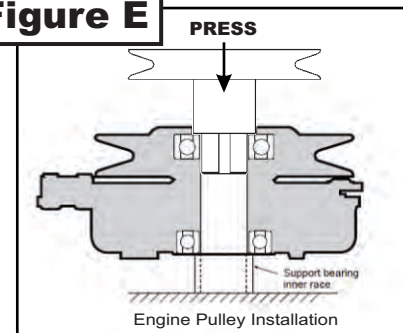
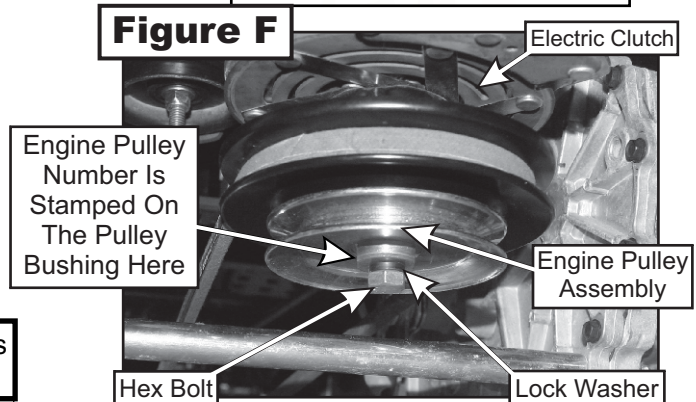

Figure F



Use engine pulley assembly #19 P#(A1792). Fasten the engine pulley to the electric clutch assembly using (1) 7/16" hi-collar lock washer P#(K0140) and (1) 7/16"-20 x 3-3/4" HHCS P#(K0350) as shown in Figure F. The added pulley will power the collection system. Torque the bolt to 55 ft./lbs. Re-connect the wiring harness to the electric clutch.

Muffler Guard and Rear Mount Plate Installation

Fasten the rear mount plate P#(B0914) and the muffler guard to the rear frame of the mower using (4) 3/8"-16 x 1" carriage bolts P#(K1182) and (4) 3/8"-16 nylon flange locknuts P#(K2038). Leave the hardware slightly loose until the heat guard has been fastened using the (2) existing 3/8"-16 x 3/4" carriage bolts and 3/8"-16 flange nuts from the removal of original muffler guard. Refer to Figure A.

Figure A

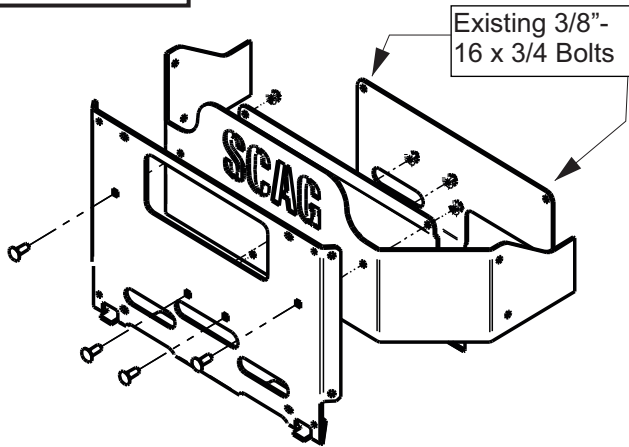

Mount Plate Stiffener Installation

Fasten the mount plate stiffener P#(B0923) to the rear frame of the mower using (4) 3/8"-16 x 1" carriage bolts P#(K1182) and (4) 3/8"-16 nylon flange locknuts P#(K2038). See Figure B.

Figure B

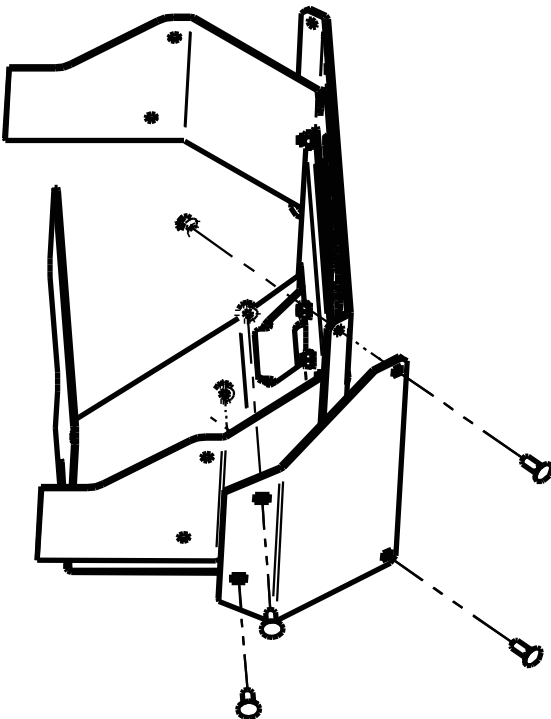

Right PTO Mount Plate and Left PTO Mount Plate Installation

Fasten the right PTO mount plate P#(B0916) to the rear mount plate using (4) 3/8"-16 x 1" carriage bolts P#(K1182) and (4) 3/8"-16 nylon flange locknuts P#(K2038). Next, fasten the left PTO mount plate P#(B0917) to the right PTO mount plate using (2) 3/8"-16 x 1" carriage bolts P#(K1182) and (2) 3/8"-16 nylon flange locknuts P#(K2038). See Figure C.

Figure C

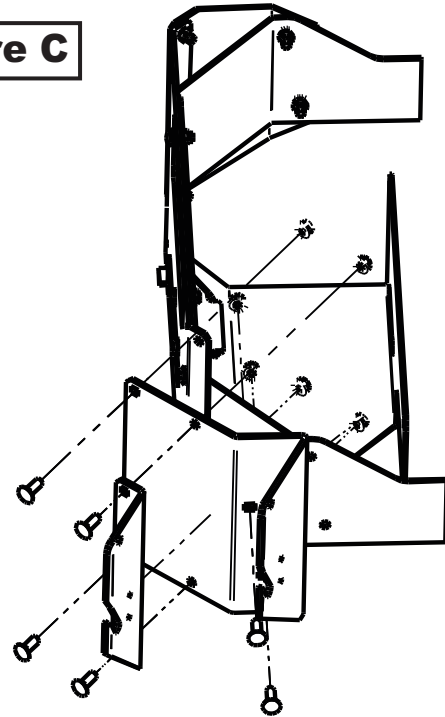

Lower Frame Tube Installation

Secure the (2) lower frame tubes P#(B0640) to the rear mount plate using (4) 5/16"-18 u-bolts P#(K1098) and (8) 5/16"-18 nylon flange locknuts P#(K2516) with the (4) spacer plates P#(B0915) between the tubes and back plate. See Figure D.

Figure D

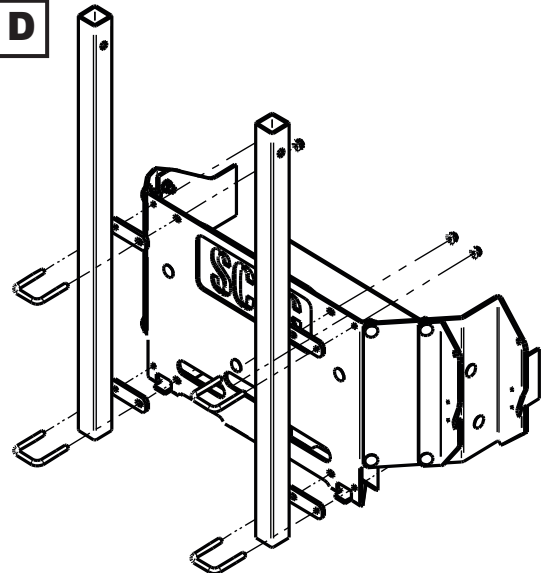

PTO Stop Plate Installation

Secure the PTO stop plate P#(B0733) to the left PTO mount plate and right PTO mount plate using (4) 1/4"-20 x 3/4" HHCS P#(K1222) and (4) 1/4"-20 nylon flange locknuts P#(K2014). With the stop plate secured, tighten all PTO mount plate component hardware at this time. Refer to Figure A.

Figure A

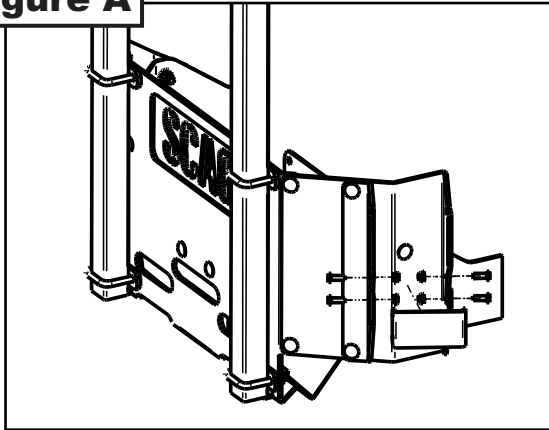

Upper Frame Assembly Installation

Position the upper frame assembly P#(A1114) above the lower frame tubes as shown in Figure B. Slide the upper frame assembly down onto the lower frame tubes and secure using (2) clevis pins P#(K0133) and (2) hair pin clips P#(K0088). See Figure B.

Figure B

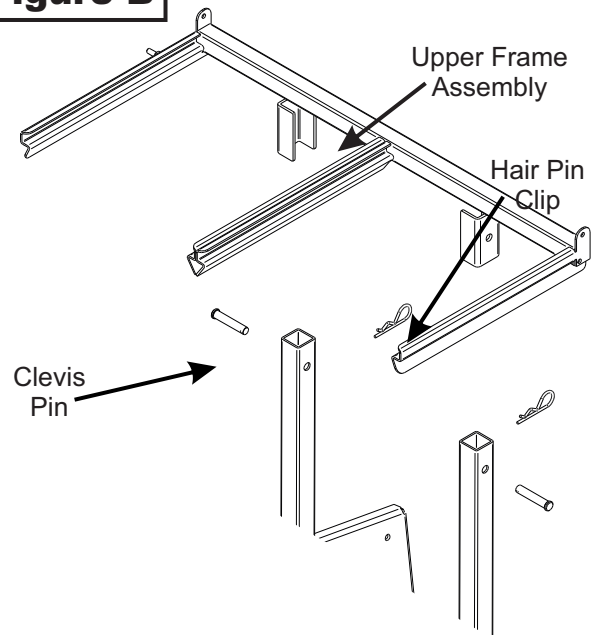

Top Assembly To Upper Frame Assembly Installation

Position the top assembly P#(A1028) above the upper frame assembly as shown in Figure C. Fasten the top assembly to the upper frame assembly using (2) 5/16"-18 x 2-1/2" HHCS P#(K0125) and (2) 5/16"-18 nylon flange locknuts P#(K2516). Leave the locknuts slightly loose, to allow the top assembly to open and close easily. Refer to Figure C for hardware location.

Inlet Installation

Insert the Inlet P#(V0019) into the hole on the top assembly from the inside and then snap the inlet into place. The inlet should pivot freely about the hole.

Figure C

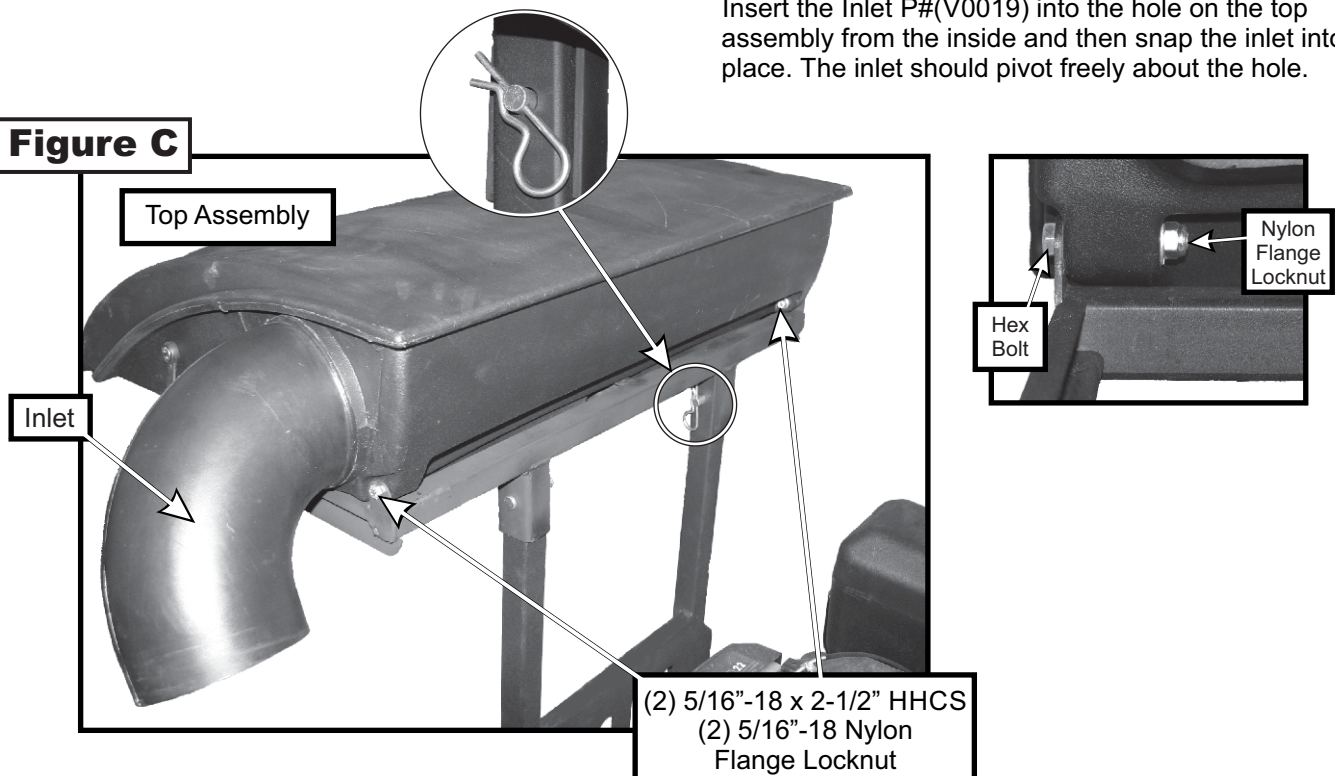

PTO Assembly Installation

First, remove the pulley guard for belt installation preparation. Next, insert the PTO assembly P#(A2028) into the lower PTO mount assembly as shown in Figure A.

Figure A

Insert The PTO Mount Assembly Into The Lower Mount

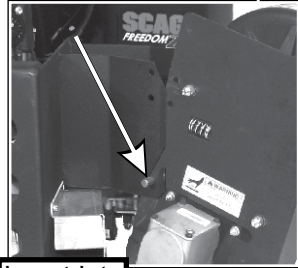
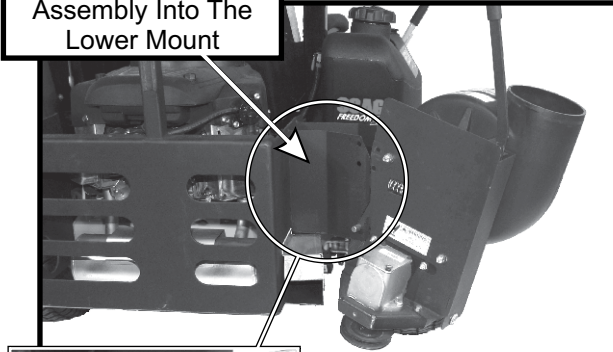

Insert Into Slot

Remove The Pulley Guard Cover

Hinge Kit Assembly Installation

Assemble the hinge kit as shown in Figure B, using (2) 5/16"-18 x 1" HHCS P#(K1154), (3) 5/16"-18 nylon flange locknuts P#(K2516), (5) 1/4" flat washers P#(K0037) and (2) swing arm brackets P#(ZT-0004). Place (1) vinyl cap P#(J0289) on the end of the hex bolts as shown in Figure B. Leave the nuts loose enough to allow fluid movement of the top when opening and closing. When opened, the top should rest on the middle joint of the hinge allowing it to remain up.

Figure B

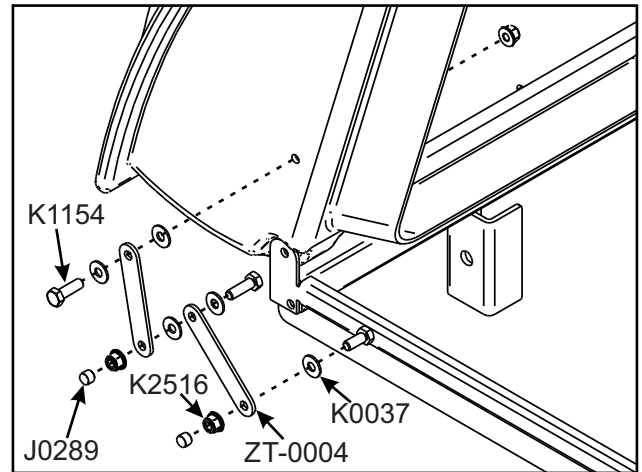

Belt Installation/Removal and Adjustment

Installation/Removal:

(Step 1) Loosen the (4) 5/16"-18 x 3/4" HHCS P#(K1153) that secure the gear box to the PTO assembly. There are (2) 5/16"-18 x 3/4" HHCS on the rear side of the PTO assembly where the gearbox is located (Figure A), and there are (2) 5-16"-18 x 3/4" HHCS on the front side of the PTO assembly underneath the blower housing. See Figure B.

(Step 2) Loosen the adjustment bolt (1) 3/8"-16 x 2" hex bolt P#(K0348) located on the side of the PTO assembly. See Figure B.

(Step 3) Slide the gearbox towards the mower until there is enough clearance for the kevlar belt A57K P#(M0256) to slide over both the engine and gearbox pulleys. See Figure C.

Figure C

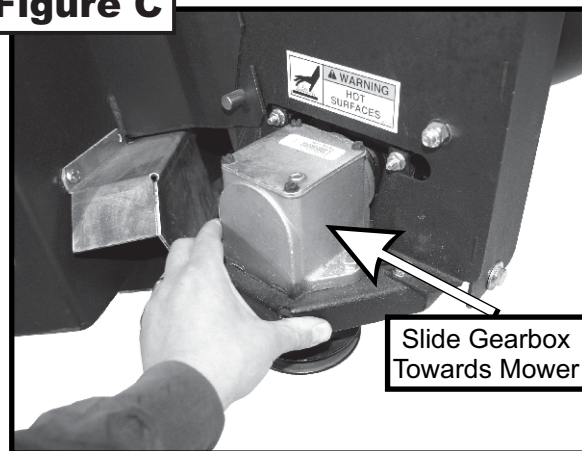

(Step 4) Wrap the kevlar belt around both pulleys.

Figure D

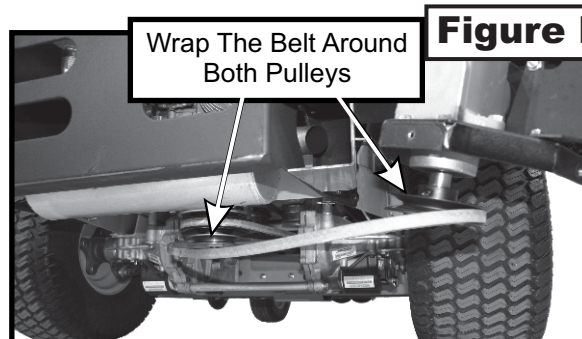

(Step 5) Secure the PTO assembly to the lower PTO mount assembly using (1) PTO assembly mount pin P#(B0274) and (1) hair pin clip P#(K0086). See Figure E.

Figure A

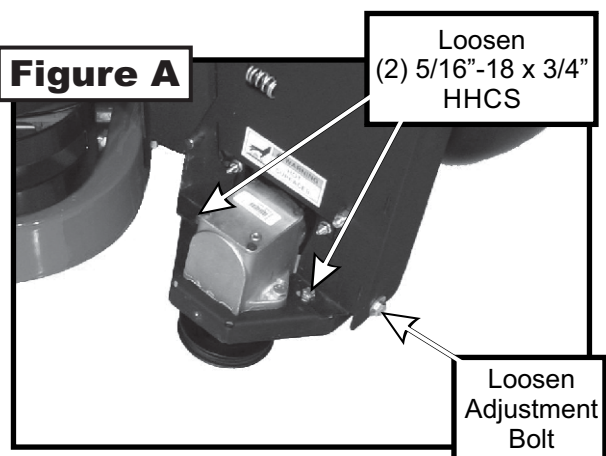

Figure B

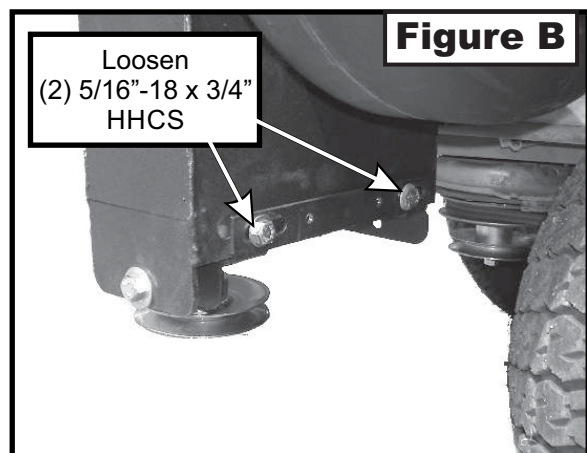
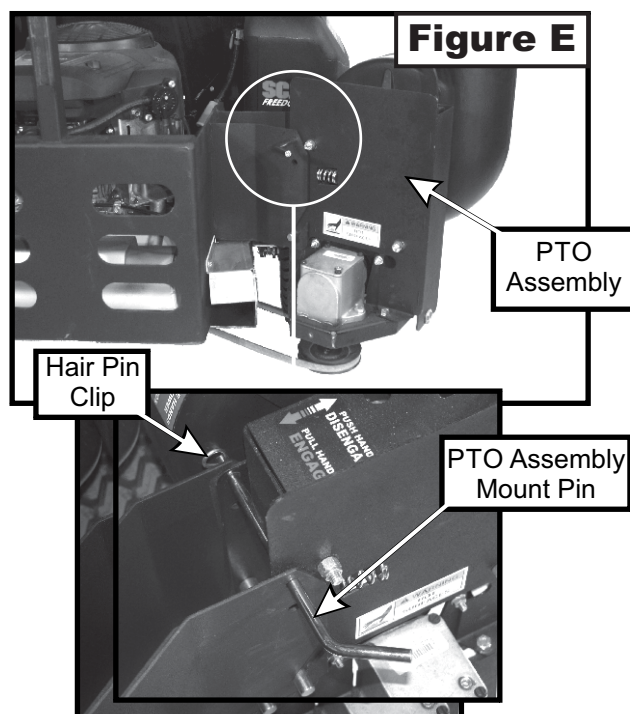
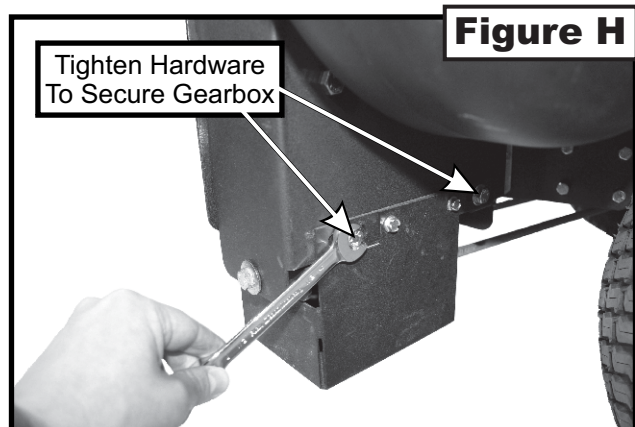
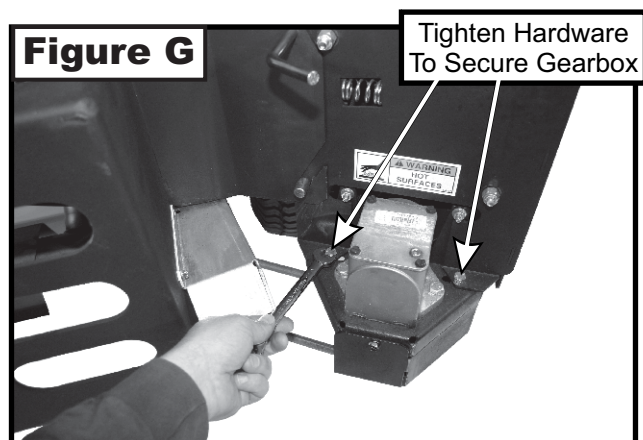
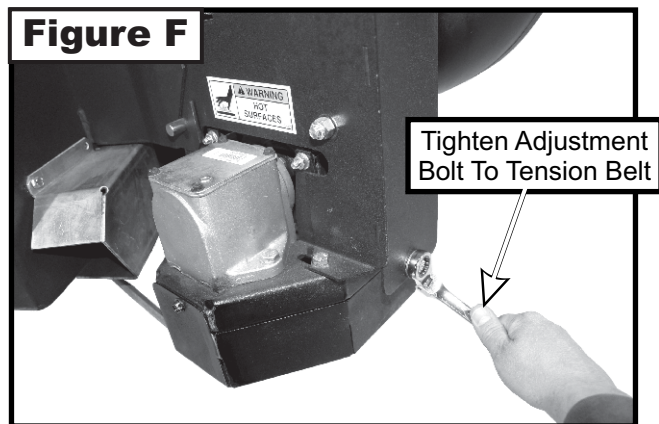

Figure E



Belt Installation/Removal/Adjustment Cont.

Adjustment: To adjust the belt tension, turn the adjustment bolt clockwise until there is 1" of deflection, with 10-11lbs of pressure applied to the center of the belt. When the belt has the proper tension, tighten the (4) 5/16"-18 x 3/4" HHCS that secure the gear box to the PTO assembly. Replace the belt guard and (3) 1/4"-20 x 1/2" HHSTS. Refer to the Figures below.



2-10 Blower Cone

Installation/Removal

Fasten the blower cone P#(V0016) to the blower housing located on the PTO assembly. Use (3) 1/4"-20 x 3/4" HHCS P#(K1222), (3) 1/4" lock washers P#(K0039), and (3) 1/4" flat washers P#(K0037) to secure the blower cone to the blower housing. Refer to Figure A for reference.

Figure A

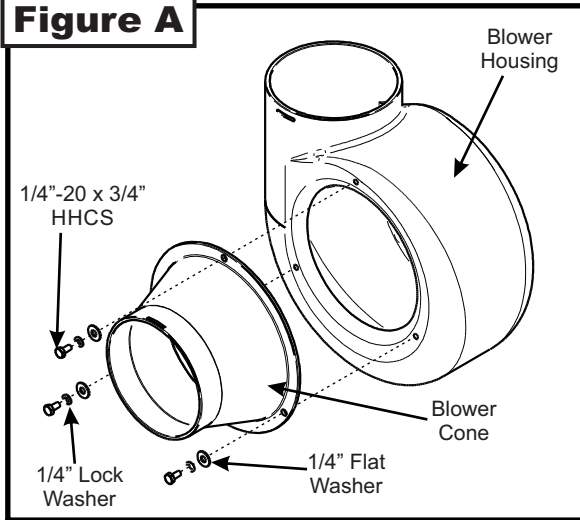

Impeller Blade Removal/Replacement

To Remove: To access the impeller blade, remove the blower cone P#(V0016) and blower cone hardware from the blower housing. Remove the 5/16"-24 x 7/8" left hand thread hex bolt P#(K1171) and washer P#(K1446). Insert (1) 1/2"-13 x 1" hex bolt into the threads on the impeller blade. Tighten the hex bolt until the impeller blade breaks free from the PTO shaft. Remove the impeller blade assembly P#(A1839) from the PTO shaft. Remove the key P#(J0254) from the PTO shaft.

To Replace: Insert the key P#(J0254) into the keyway slot on the PTO shaft. Align the keyway slot on the bushing of the impeller blade assembly with the key on the PTO shaft and insert the impeller blade onto the PTO shaft. Secure the impeller blade with (1) 5/16"-24 x 7/8" left hand thread hex bolt P#(K1171) and (1) washer P#(K1446). Replace the blower cone P#(V0016) and blower cone hardware. Refer to Figure B for reference.

Figure B

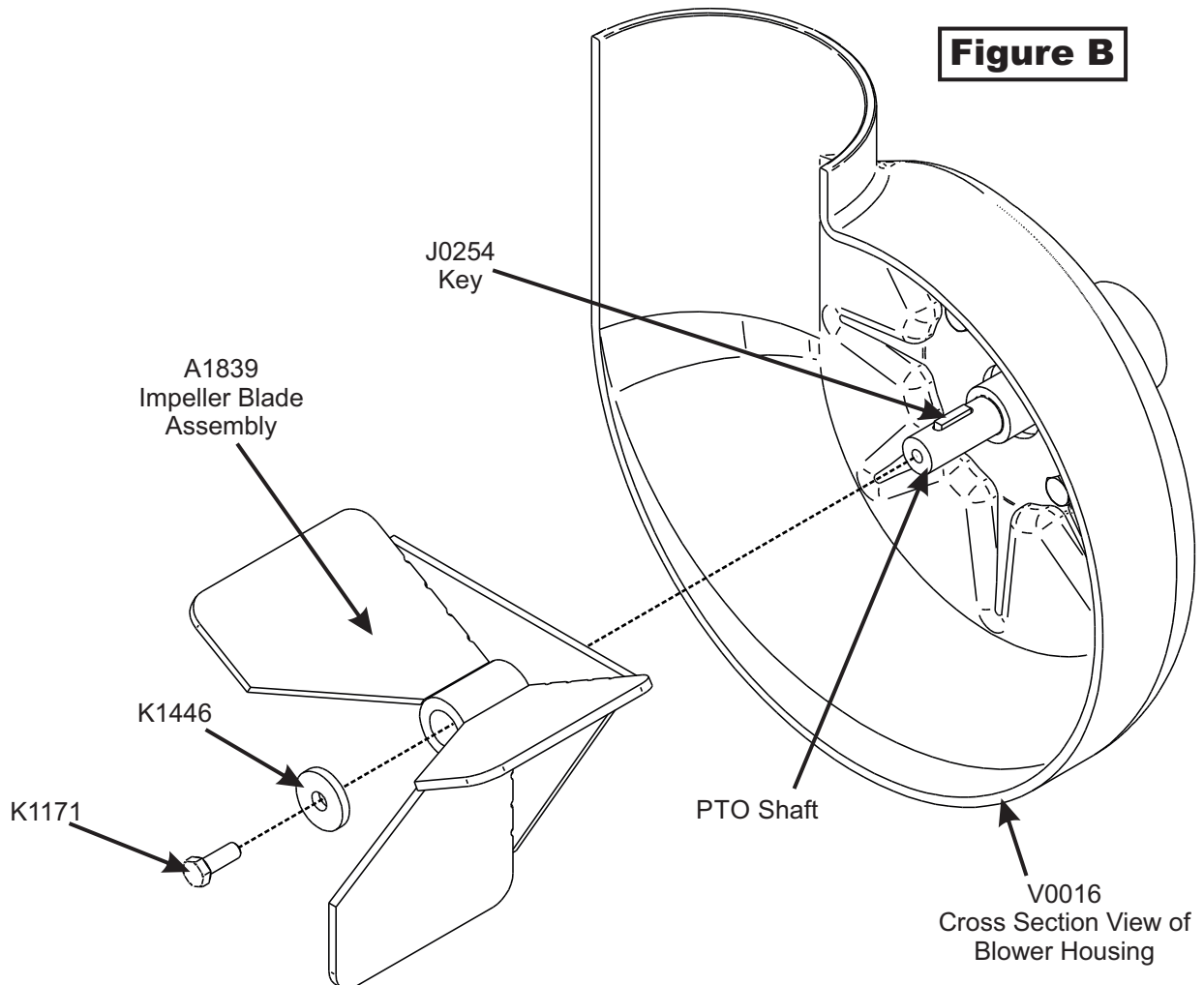

Boot To Mower Deck Installation

Fasten the boot plate P#(B0918) and boot plate fastener P#(B0919) to the boot P#(V0027) for 48" decks or P#(V0028) for 52" decks, using (3) 5/16"-18 x 1" carriage bolts P#(K1144), (3) 5/16"-18 nylon flange locknuts P#(K2516). Insert the carriage bolts from inside the boot, so the threads are on the outside. This will prevent grass clippings from collecting on the threads. Refer to Figure A.

Secure the boot plate to the mower deck using (1) boot rod P#(B4331) and (1) hair pin clip P#(K0099). See Figure B.

Figure A

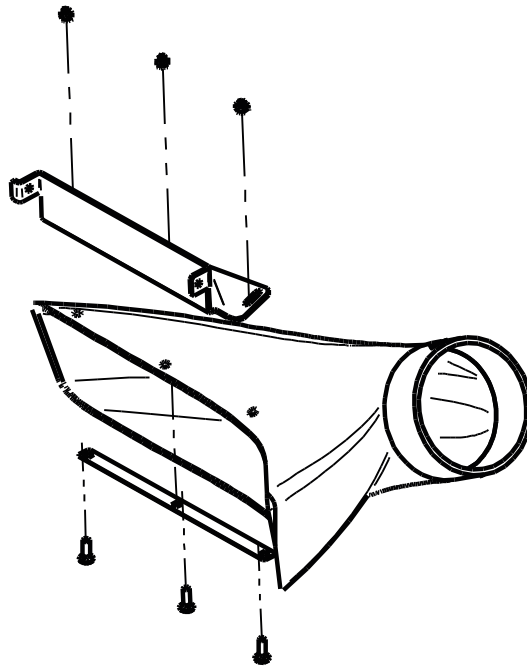
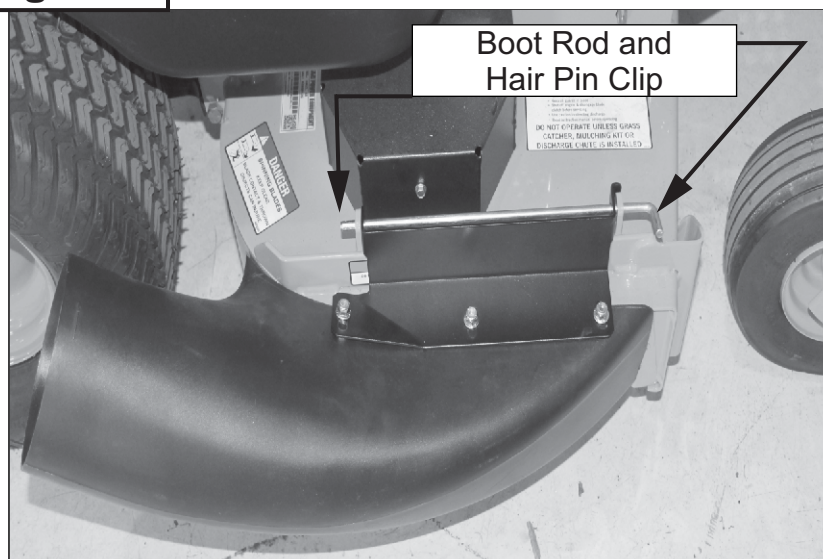

Figure B



Length Of Hose Adjustment

The hoses in Figure A must be cut to fit your machine. Do not cut the hoses until you have tried to fit them on your machine. Remember that the hoses have to be long enough to adjust for the blower assembly's movement as well as allow for enough clamping surface between the inlet, blower assembly and the deck boot.

Upper Hose Installation

Slide a hose clamp P#(J0060) over both ends of the upper hose. Then slide one end of the upper hose onto the inlet. Make sure there is about a two-inch overlap between the hose end and the container inlet. Proceed to slide the opposite end of the upper hose onto the outlet of the blower assembly. See Figure A for details. Tighten the hose clamps.

Lower Hose To Blower Cone Installation

Slide a hose clamp P#(J0060) over one end of the 6" lower hose. Then proceed to slide the lower hose onto the blower cone. Tighten the hose clamp. See Figure A for details.

Lower Hose To Boot Installation

Take the unattached end of the lower hose and slide it over the circular end of the boot. Use the hose clamp P#(J0060) to secure the hose to the boot.

NOTE: Before tightening the hose clamp, rotate the lower hose counter clockwise (see Figure A) approximately 1" and then tighten the clamp. This will hold the bottom edge of the boot tight to the mower deck.

Weight Kit Installation

Secure the weight bracket P#(B0576) to the front frame of the mower using (2) 1/2"-13 x 1" HHCS P#(K1231) and (2) 1/2"-13 nyloc nuts P#(K1247). Secure the weight to the weight bracket using (2) 1/2"-13 U-Bolts P#(K0331) and (4) 1/2"-13 nyloc nuts P#(K1247). See Figure B.

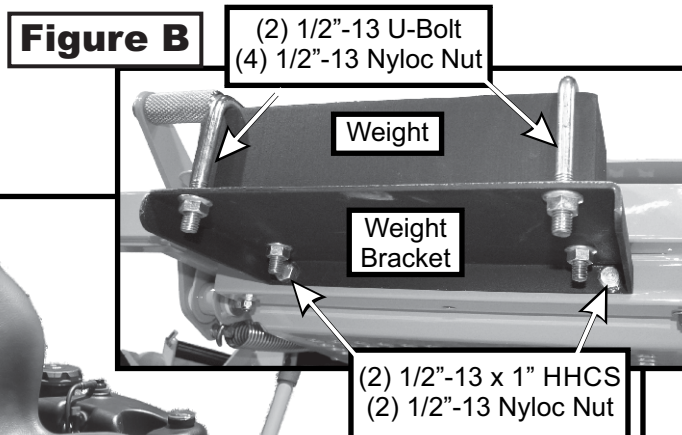
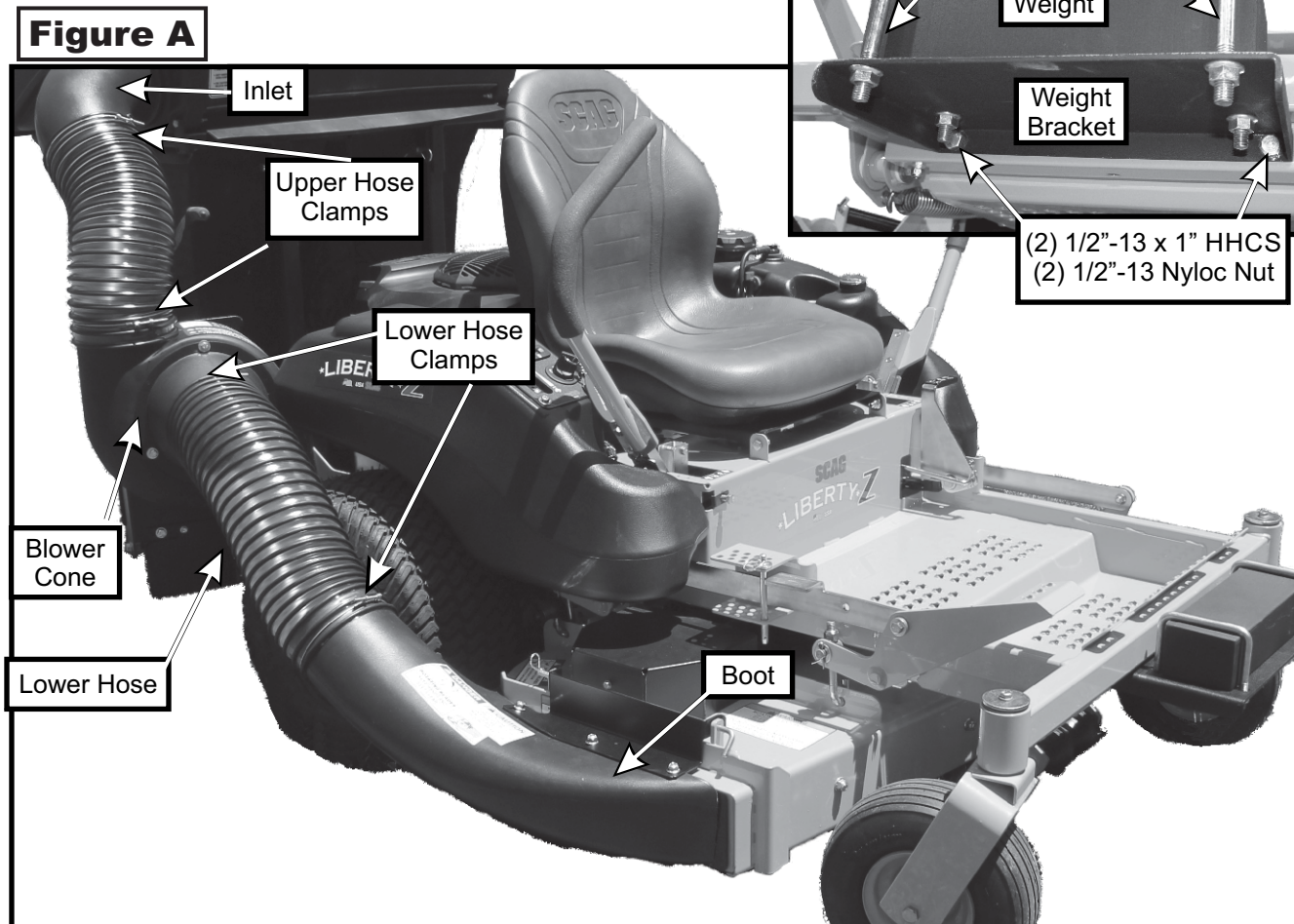

Installation/Removal Of Collection Bags

To install the bag P#(G0002) onto the bag ring P#(B0227), first make sure the bag ring end caps P#(J0274) are fastened to the bag ring. Place the seam openings of the bag onto the bag ring openings and turn the bag until the slot bracket in the bag ring is protruding from the opening in the bag (Figure A). Do this for both bags.

Install the completed assemblies onto the support frame and close the plastic top. To secure the plastic top while in use, fasten the rubber strap with S hook to the right pivot side rail as shown in Figure B.

To empty the bag, remove the bag and bag ring by sliding the bag rearward. Grasp the loop on the bottom of the bag, turn it upside down and empty the collected debris (Figure C). Repeat for the other bag. Reinstall both bags, line with plastic bags if desired, close the plastic top and reattach the rubber strap with 'S' hook.

Plastic lawn and leaf bags, 33 gallon size, may be used inside the cloth bags. Be sure to leave enough plastic bag hanging over the frame so the plastic bags can be twist tied before emptying (Figure D).

Figure B

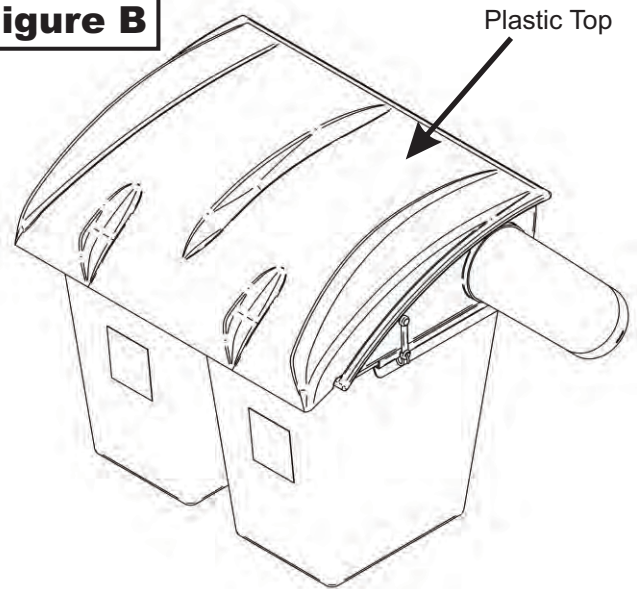

Figure C

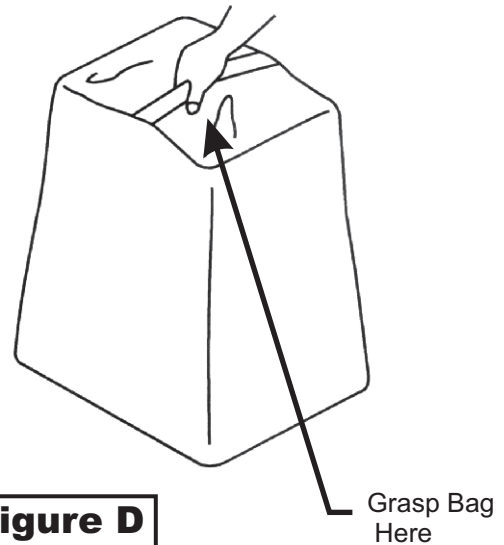

Figure D

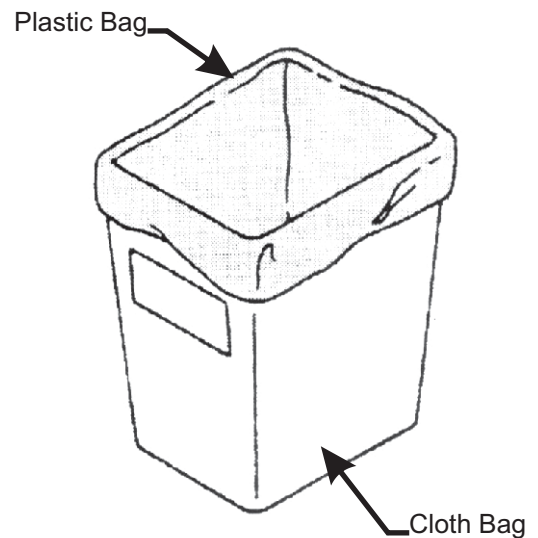
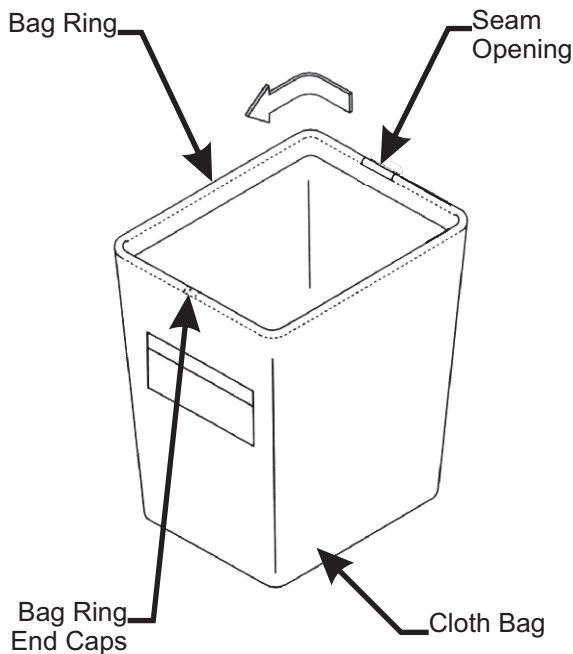

Figure A



SECTION III - P3B

OPERATING INSTRUCTIONS

General Safety

Only qualified people familiar with this operator's manual and the mower's operator's manual should operate this machine.

Operation And Tips On Mowing

- A. Perform BEFORE EACH USE in the maintenance checklist under Section IV Maintenance.
- B. Start mower.
- C. With the mower at high idle speed, engage the mower deck.
- D. While seated in the operator's seat, rotate the engagement handle of the collection system away from the mower. Continue to rotate the handle until it stops in an over center position. With the PTO assembly engaged, you can proceed to operate the control levers of the mower.

NOTE: If the collection system does not appear to be collecting the grass clippings, disengage the deck and PTO assembly, then, engage the parking brake and turn the mower off. Proceed to next section, and review the sections regarding PTO assembly Installation and belt installation/removal and adjustment. Check upper and lower hoses for any clogs.

To obtain the maximum effectiveness from your collection system the tips listed below should be followed:

- * Watch your speed- Normal conditions will allow a speed of up to approximately 5 mph, but thick, heavy damp conditions will require reduced ground speed.
- * Mow with sharp blades- A sharp blade cuts cleaner.
- * Wet grass and leaves will decrease effectiveness and will increase horsepower requirements.
- * Mow at higher cutting heights- Remove and mulch no more than 2" of grass length with each mowing. (Experts recommend not cutting off more than 1/3 of the grass blade length at any given time.)
- * Mow twice, at different height settings, (high, then low), if grass is extra tall.
- * Remember that horsepower requirements will vary with the mowing conditions such as type and height of turf grass, moisture content, amount of leaves, whether the terrain is flat or hilly, etc.

Disengagement Of The PTO Assy.

- A. To disengage the PTO assembly, rotate the engagement handle towards the mower.

WARNING: The PTO assembly blades will continue to spin. DO NOT TOUCH the PTO assembly, pulleys, or the belt until the tractor is turned off. DO NOT adjust the belt tension until the mower is turned off. Refer to the belt adjustment section of the manual.

Unloading The Collection System

NOTE: To determine when the collection bags are full, follow the following steps:

- A. Stop the forward movement of the mower.
- B. Disengage the mower deck.
- C. Disengage the blower.
- D. Engage the parking brake.
- E. Once the parking brake has been engaged, then and only then, walk behind the mower and check the collection bags by first unhooking the rubber strap with S-hook that secures the plastic top, then lift the plastic hood. Load in bags should not exceed the height of the installed bag.
- F. To remove the bags from the frame slide bags out and turn bags over to deposit clippings.
- G. Slide empty bags back onto the frame and secure plastic top with the rubber strap with S-hook.

NOTE: Do not allow collection bags to become over-filled as potential damage may occur to your equipment. Also, be sure to clean the hood screen as needed.

SECTION I - MAINTENANCE

Maintenance Checklist

NOTE: REMOVE PTO ASSEMBLY BEFORE RAISING DECK FOR MAINTENANCE.

Before each use:

1. Check blades and spindles to be sure that no foreign objects, such as wire or steel strapping bands, are wrapped around them.
2. Inspect blades for wear. Replace if necessary. If it is necessary to sharpen the blades, remove the blades from the spindles before sharpening. DO NOT sharpen blades while still attached to the mower.

3. Make sure all shields are in place and in good condition. Repair or replace any missing or damaged shields.
4. Perform lubrication per instructions.
5. Listen for abnormal sounds, which might indicate loose parts, damaged bearings, or other damage. Correct any deficiency before continuing operation.
6. With the engine off, engage the blower assembly. Check the belt tension and inspect the pulley belt for cracks or tears.
7. Check for wear or deterioration of the upper or lower hoses. If there are any portions of the hose that have been torn or worn through, replace immediately.

After Each Use:

1. Clean all debris from machine especially from the container, underneath the belt shields, and safety decals. Replace any missing or illegible decals.
2. Inspect the unit for worn or damaged components. Repair or replace before the next use. Any replacement component installed during repair shall include the component's current safety decal specified by the manufacturers to be affixed to the component.
3. Under normal usage, the bag material is subject to deterioration and wear and should therefore be frequently checked for necessary replacement. Any replacement bag should be checked to ensure compliance with the original manufacturer's recommendations or specifications.
4. Check belt for proper tension.

Lubrication

Gearbox:

1. Every 20 hours of use: Check oil levels in gearbox.
2. First 60 hours of use: Change oil.
3. Every 100 hours of use: Change oil.

NOTE: Oil in gearbox should cover the gears. If not, drain the gearbox and fill using an 80W-90 gear oil. The gearbox ships with 6.0 oz. of oil, but we recommend replacing with a measured 5.5 oz. to fill the gearbox. **DO NOT OVERFILL!**

Blower Assembly:

NOTE: The following is for older PTO models that contain a greaseable zirc fitting. Newer models contain maintenance-free bearings and are without a greasable fitting.

1. On initial use: Grease the fitting on the blower shaft.
2. Every 25 hours of use: Re-grease the grease fitting.

NOTE: Use only white lithium based grease for lubrication of the shaft on the blower assembly.

SECTION V - PARTS & SERVICE

Parts And Service Information

Collection system owners should record the name and telephone number of their Service Center. Your Service Center will be happy to supply replacement parts, accessories, and do any service or repairs to your collection system. If for any reason your Service Center is unable to service your collection system or supply replacement parts, contact Country Clipper and include the following information on the chart below.

DOCUMENT THE FOLLOWING INFORMATION FOR FUTURE REFERENCE

Unit Model Number: _____

Unit Engine Size: _____

Unit Serial Number: _____

Date of purchase: ____ / ____ / ____

Dealer/Distributor Name: _____

Address: _____ **State:** _____ **Zip:** _____

Phone Number: _____

New PECO, Inc.
100 Airport Road | Arden, North Carolina 28704
Phone: 1-800-438-5823 | 828-684-1234
Fax: 828-684-0858
Email: peco@lawnvac.com
Website: www.lawnvac.com



Unit Model #: 37120903

Mower: Scag	Owner's Manual: Q0497
Mower Type: Liberty-Z	Engine Type: Kohler 7000 Series 22 HP
Deck Size: 48"	Vac Type: 9 Cu. Ft. Pro 2+ Bagger
Deck Type:	Drive Type: Rear PTO Drive (3-Blade)
Revision:	Fits Year(s): 2015

A1997 Vac Kit

- (1) A1028 TOP ASSEMBLY
- (1) V0019 INLET
- (1) A1114 UPPER FRAME ASSY
- (1) HB0622 HARDWARE BAG
- (2) B0227 BAG RING

A1153 48" BAFFLE KIT

- (1) HB0476 HARDWARE BAG
- (1) B0709 48" LEFT HAND BAFFLE
- (1) A1154 48" RIGHT HAND BAFFLE ASSEMBLY
- (1) PECO HARDWARE BAG

A2029 Mount Kit

- (1) B0923 MOUNT PLATE STIFFENER
- (1) F0060 6" x 18" UPPER HOSE
- (1) F0060 6" x 21" LOWER HOSE
- (4) J0060 6" HOSE CLAMPS
- (1) HB0651 ENGINE PULLEY HARDWARE BAG
- (4) B0915 SPACER PLATE
- (1) HB0652 HARDWARE BAG
- (1) B0733 PTO STOP PLATE
- (1) B0913 MUFFLER GUARD
- (1) B0916 RIGHT PTO MOUNT PLATE
- (2) G0002 3.3 CU. FT. COLLECTION BAGS
- (1) A2028 3 BLADE PTO ASSY.
- (1) B0914 REAR MOUNT PLATE
- (1) B0917 LT. PTO MNT. PL.

A1790 Boot Kit

- (1) V0027 BOOT
- (1) B0918 BOOT PLATE
- (1) B0919 BOOT PLATE FASTENER
- (1) B4331 BOOT ROD
- (1) HB0432 HARDWARE BAG
- (1) HB0431 HARDWARE BAG
- (1) B0034 12" WEIGHT BAR

A1791 Weight Kit

- (1) HB0431 HARDWARE BAG
- (1) B0576 WEIGHT BRACKET
- (1) B0034 12" WEIGHT BAR



Unit Model #: 37120904

Mower: Scag

Owner's Manual: Q0497

Mower Type: Liberty-Z

Engine Type: Kohler 7000 Series 24 HP

Deck Size: 52"

Vac Type: 9 Cu. Ft. Pro 2 + Bagger

Deck Type:

Drive Type: Rear PTO Drive (3-Blade)

Revision:

Fits Year(s): 2015

A1997 Vac Kit

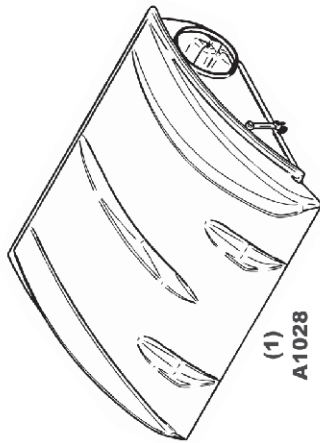

(1)
A1028
TOP ASSEMBLY



(1)
V0019
INLET

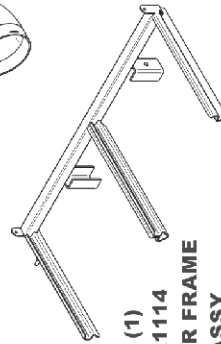

(1)
A1114
UPPER FRAME
ASSY



(1)
HB0622
HARDWARE
BAG

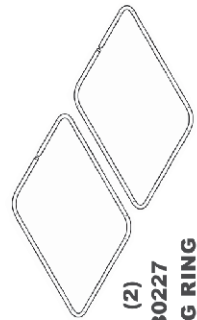

(2)
B0227
BAG RING

A1151 52" BAFFLE KIT



(1)
HB0476
HARDWARE
BAG



(1)
B0705
52" LEFT HAND
BAFFLE



(1)
A1152
52" RIGHT HAND
BAFFLE
ASSEMBLY

A2029 Mount Kit

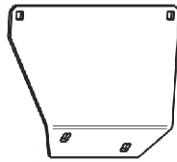

(1)
B0923
MOUNT PLATE
STIFFENER

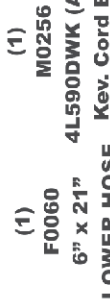

(1)
F0060
6" x 18"
UPPER
HOSE



(4)
J0060
HOSE
CLAMPS



(1)
F0060
6" x 21"
LOWER HOSE



(1)
M0256
4L590DWK (A57K)
Kev. Cord Belt



(1)
HB0651
ENGINE PULLEY
HARDWARE BAG

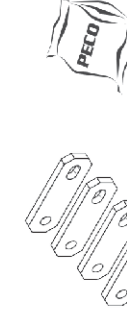

(4)
B0915
SPACER
PLATE



(1)
V0016
BLOWER
CONE 6"



(1)
HB0652
HARDWARE
BAG

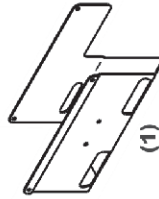

(1)
B0913
MUFFLER
GUARD

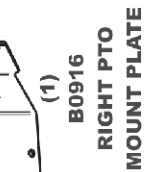

(1)
B0916
RIGHT PTO
MOUNT PLATE

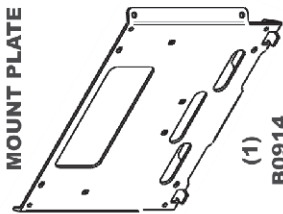

(1)
B0914
REAR
MOUNT
PLATE

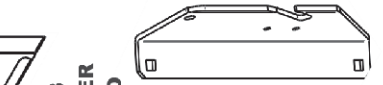

(1)
B0917
LT. PTO
MNT. PL.

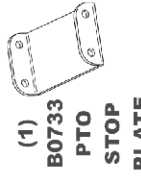

(1)
B0733
PTO
STOP
PLATE



(2)
B0640
LWR.
FRAME
TUBE

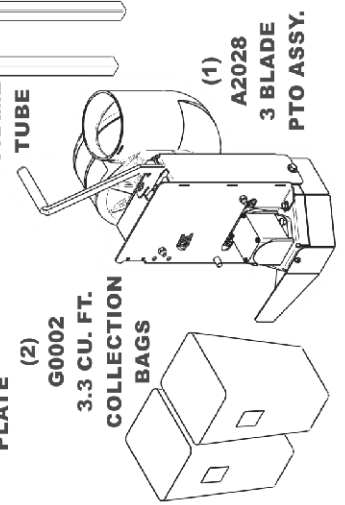

(2)
G0002
3.3 CU. FT.
COLLECTION
BAGS



(1)
A2028
3 BLADE
PTO ASSY.

A1796 Boot Kit

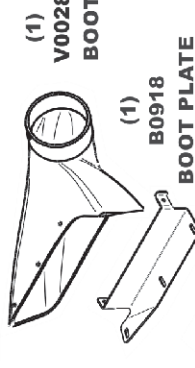

(1)
V0028
BOOT



(1)
B0918
BOOT PLATE



(1)
B0919
BOOT PLATE
FASTENER



(1)
B4331
BOOT ROD



(1)
HB0432
HARDWARE
BAG

A1791 Weight Kit



(1)
HB0431
HARDWARE
BAG



(1)
B0034
12" WEIGHT
BAR

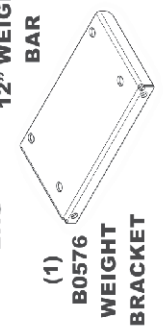

(1)
B0576
WEIGHT
BRACKET

**A1028 TOP ASSEMBLY
A1114 UPPER FRAME ASSEMBLY
EXPLODED PARTS VIEW**

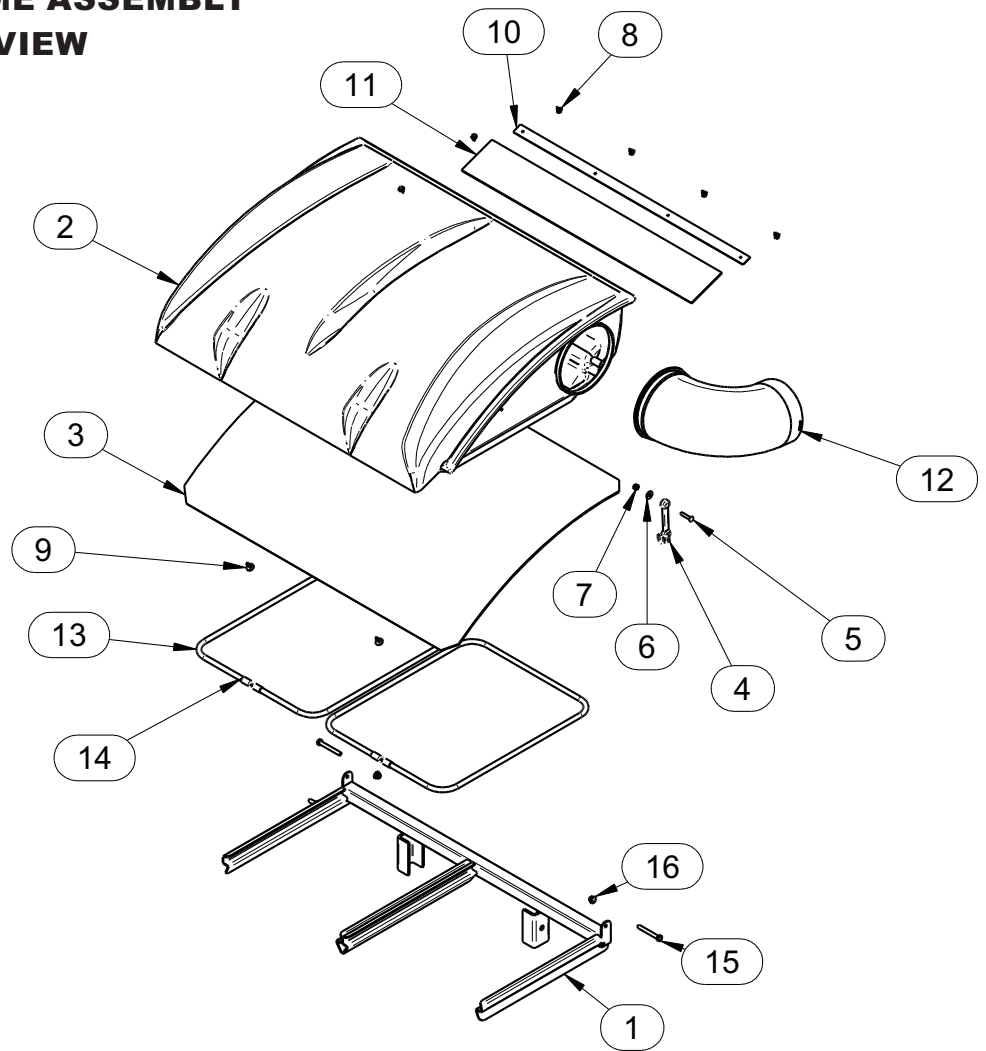

Item #	Part #	Desc.	Qty.
1	A1114	2 BAG FRAME ASSY	1
2	V0017	PRO 2 BAGGER TOP	1
3	V0018	Black Plastic Screen	1
4	J4009	SHORT RUBBER STRAP W/ S HOOK	1
5	K1030	1/4"-20 x 1-1/4" CARRIAGE BOLT	1
6	K0037	1/4" FLAT WASHER .75 OD x .314 ID x .060 T	1
7	k1128	1/4"-20 NYLOC NUT	1
8	K0114	BLACK PLASTIC RIVET	6
9	K1265	BLACK PANEL RETAINER	2
10	C0067	DUST GUARD BRACE	1
11	V1117	DUST GUARD	1
12	V0019	INLET	1
13	b0227	BAG RING	2
14	j0274	BAG RING END CAP	4
15	K0125	5/16"-18 x 2-1/2" ALL THREAD HHCS	2
16	K2516	5/16"-18 Nylon Flange Locknut	2

A2028 PTO ASSEMBLY

EXPLODED PARTS VIEW DESCRIPTION

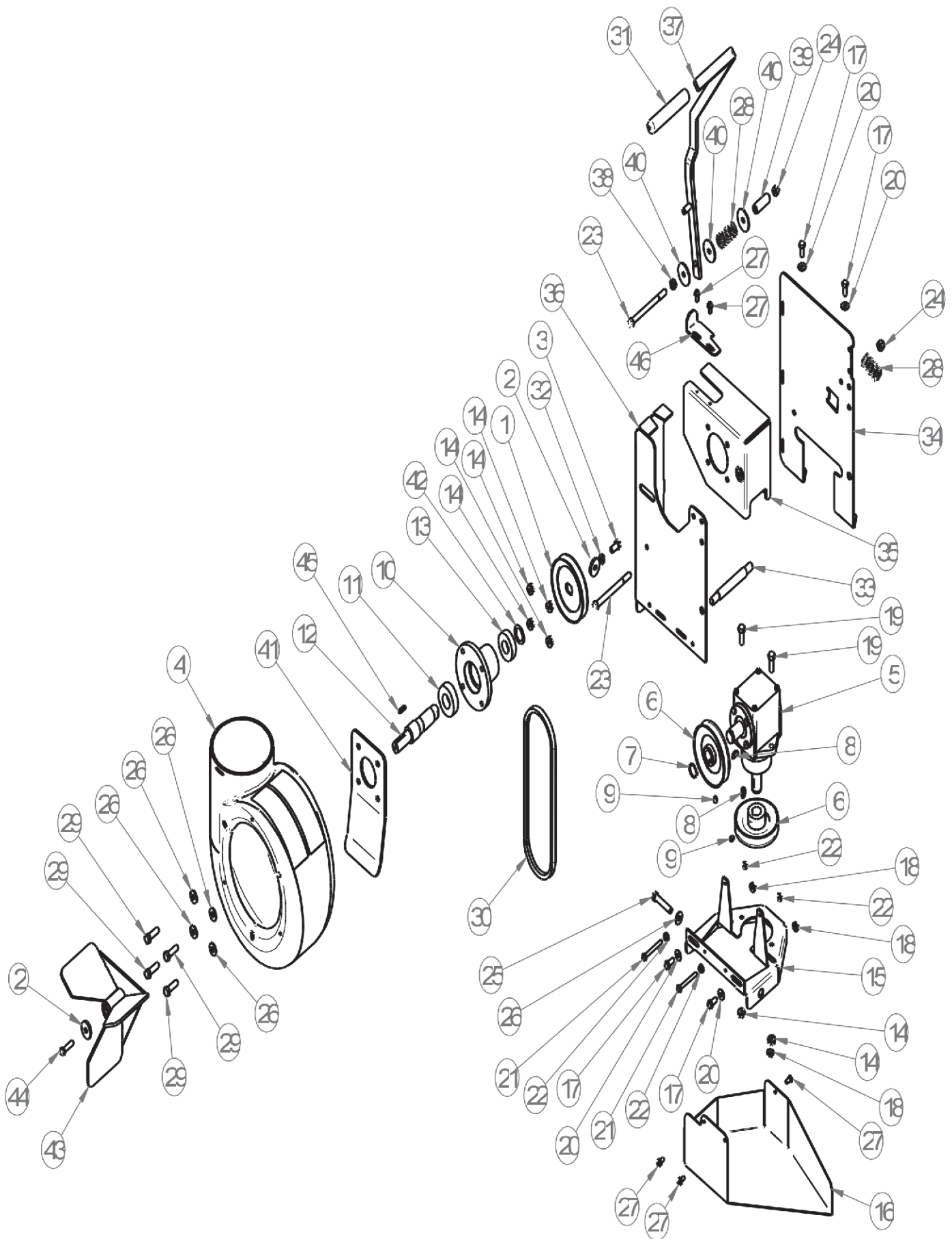

**A2028 PTO ASSEMBLY
EXPLODED PARTS VIEW**

Item #	Doc #	Title	Qty
1	M0266	A-Section Pulley / 4.25 OD	1
2*	K1446	PTO Housing Washer	2
3	k1190	HHCS / 3/8"-16 x 3/4"	1
4	V0015	Blower Hsg.	1
5	A0431	Gear Box	1
6	A0498	Pulley Assy. / Gear Box	2
7	K0360	Snap Ring / 7/8" Shaft	2
8	J0272	Woodruff Key / #9	2
9	K0035	Set Screw / 5/16"-18	2
10	E0015	Housing / PTO Shaft	1
11	n0147	Bearing (2.0472 OD, 0.9843 ID, 0.5906 W)	1
12	B0460	PTO Shaft	1
13	N0165	Bearing	1
14	K1215	Flange Nut / 3/8"-16	7
15	B0466	PTO Base Plate	1
16	B0681	Pulley Guard / Gear Box Assy.	1
17	K1153	HHCS / 5/16"-18 x 3/4"	4
18	K1178	Flange Nut / 5/16"-18	4
19	k1191	HHCS / 3/8"-16 x 1" / G5	2
20	K0037	Flat Washer / 1/4" (.75 OD x .312 ID x .060 T)	4
21	k1150	HHCS / 1/4"-20 x 2-1/4"	2
22	K1126	Flange Nut / 1/4"-20	4
23	K1202	HHCS / 3/8"-16 x 4-1/2" / G5	2
24	k1216	Nyloc Nut / 3/8"-16	2
25	K0348	HHCS / 3/8"-16 x 2" All Thread	1
26	k0042	Flat Washer / 5/16" (.875 OD x .380 ID x .075 T)	5
27	K0353	HHSTS / 1/4"-20 x 1/2"	5
28	J0303	Spring	2
29	K1192	HHCS / 3/8"-16 x 1-1/4"	4
30	M0267	Kevlar Belt / A28K	1
31	V1151	Black Handle Grip (5/8" ID x 4-3/4" L)	1
32	K0048	Lock Washer / 3/8"	1
33	B0505	Mount Rod / PTO Arm	1
34	B0506	Lt. PTO Arm	1
35	B0642	Mount Bracket / Blower Hsg.	1
36	B0643	Rt. PTO Arm	1
37	A1138	PTO HANDLE ASSY	1
38	B0510	Spacer Bushing / Small	1
39	B0511	Spacer Bushing / Large	1
40	K0403	Flat Washer (1-1/2" OD x 3/8" ID x .092 T)	3
41	B0739	Stiffener Plate / Blower Hsg.	1
42	K0070	Flat Washer (1.295 OD x .881 ID x .020 T)	1
43	A1839	3-Blade Impeller Assy.	1
44	K1171	HHCS / 5/16"-24 LH x 1-1/4" / G5 w/ Patch Coating	1
45	J0254	Key / 3/16" x 3/16" x 3/4"	1
46	B0887	Belt Tension Adjust Bracket	1

SAFETY DECALS

To promote safe operation, PECO Inc. supplies safety decals on all products manufactured. Damage can occur to safety decals either through shipment, use or reconditioning. Contact your local Service Center for replacement decals.



Part #: R1070
PECO Label



Part #: R2007
Never Use Hands Label

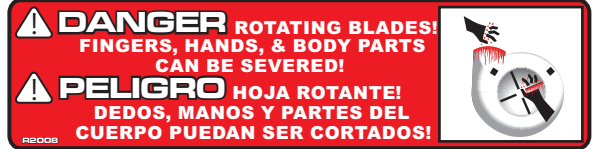

Part #: R2008
Rotating Blades Label



Part #: R1100
Engage-Disengage Label



Part #: R4037
Warning: Hot Surface Label



Part #: R1052
Small Warning: Turn Off Blower Label



Part #: R1065
Made In America Label



Part #: R1069
Warning: Turn Off Blower Label

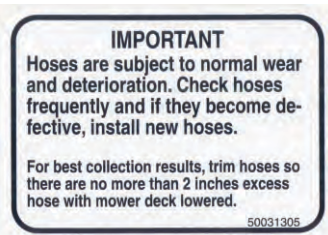

Part #: R1054
Important Label



Part #: R1051
Warning: Hearing Protection Label



Part #: R4015
Danger: Rotating Blades Label



Part #: R4008
Caution: Rotating Blades Label

TORQUE SPECIFICATIONS

AMERICAN Bolt Head Markings

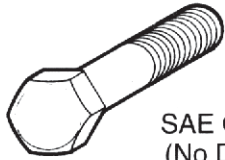

SAE Grade 2
(No Dashes)

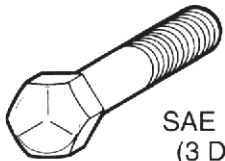

SAE Grade 5
(3 Dashes)

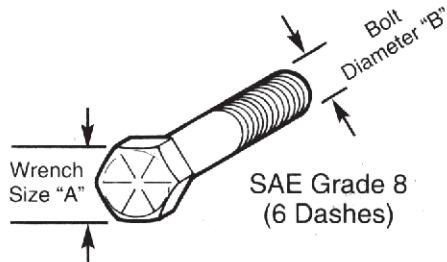

SAE Grade 8
(6 Dashes)

Recommended Torque in Foot Pounds (Newton Meters).*

WRENCH SIZE (IN.) "A"	BOLT DIAMETER (IN.) "B" AND THREAD SIZE	SAE GRADE 2	SAE GRADE 5	SAE GRADE 8
7/16	1/4 - 20 UNC	6 (7)	8 (11)	12 (16)
7/16	1/4 - 28 UNF	6 (8)	10 (13)	14 (18)
1/2	5/16 - 18 UNC	11 (15)	17 (23)	25 (33)
1/2	5/16 - 24 UNF	13 (17)	19 (26)	27 (37)
9/16	3/8 - 16 UNC	20 (27)	31 (42)	44 (60)
9/16	3/8 - 24 UNF	23 (31)	35 (47)	49 (66)
5/8	7/16 - 14 UNC	32 (43)	49 (66)	70 (95)
5/8	7/16 - 20 UNF	36 (49)	55 (75)	78 (106)
3/4	1/2 - 13 UNC	49 (66)	76 (103)	106 (144)
3/4	1/2 - 20 UNF	55 (75)	85 (115)	120 (163)
7/8	9/16 - 12 UNC	70 (95)	109 (148)	153 (207)
7/8	9/16 - 18 UNF	79 (107)	122 (165)	172 (233)
15/16	5/8 - 11 UNC	97 (131)	150 (203)	212 (287)
15/16	5/8 - 18 UNF	110 (149)	170 (230)	240 (325)
1-1/8	3/4 - 10 UNC	144 (195)	266 (360)	376 (509)
1-1/8	3/4 - 16 UNF	192 (260)	297 (402)	420 (569)
1-5/16	7/8 - 9 UNC	166 (225)	430 (583)	606 (821)
1-5/16	7/8 - 14 UNF	184 (249)	474 (642)	668 (905)
1-1/2	1 - 8 UNC	250 (339)	644 (873)	909 (1232)
1-1/2	1 - 12 UNF	274 (371)	705 (955)	995 (1348)
1-1/2	1 - 14 UNF	280 (379)	721 (977)	1019 (1381)
1-11/16	1-1/8 - 7 UNC	354 (480)	795 (1077)	1288 (1745)
1-11/16	1-1/8 - 12 UNF	397 (538)	890 (1206)	1444 (1957)
1-7/8	1-1/4 - 7 UNC	500 (678)	1120 (1518)	1817 (2462)
1-7/8	1-1/4 - 12 UNF	553 (749)	1241 (1682)	2013 (2728)
2-1/16	1-3/8 - 6 UNC	655 (887)	1470 (1992)	2382 (3228)
2-1/16	1-3/8 - 12 UNF	746 (1011)	1672 (2266)	2712 (3675)
2-1/4	1-1/2 - 6 UNC	870 (1179)	1950 (2642)	3161 (4283)
2-1/4	1-1/2 - 12 UNF	979 (1327)	2194 (2973)	3557 (4820)

METRIC

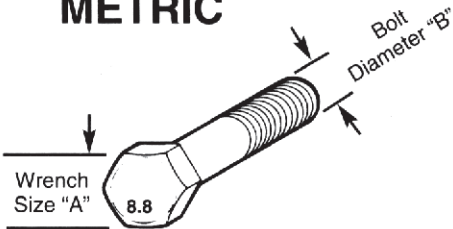

Numbers appearing on bolt heads indicate ASTM class.

Recommended torque in foot pounds (newton Meters).*

WRENCH SIZE (mm) "A"	BOLT DIA. (mm) "B"	ASTM 4.6	ASTM 8.8	ASTM 9.8	ASTM 10.9
8	5	1.8 (2.4)		5.1 (6.9)	6.5 (8.8)
10	6	3 (4)		8.7 (12)	11.1 (15)
13	8	7.3 (10)		21.1 (29)	27 (37)
16	10	14.5 (20)		42 (57)	53 (72)
18	12	25 (34)	74 (100)	73 (99)	93 (126)
21	14	40 (54)	118 (160)	116 (157)	148 (201)
24	16	62 (84)	167 (226)	181 (245)	230 (312)
30	20	122 (165)	325 (440)		449 (608)
33	22		443 (600)		611 (828)
36	24	211 (286)	563 (763)		778 (1054)
41	27		821 (1112)		1138 (1542)
46	30	418 (566)	1119 (1516)		1547 (2096)

*Use 75% of the specified torque value for plated fasteners. Use 85% of the specified torque values for lubricated fasteners.

Notes

Notes



**100 AIRPORT ROAD
ARDEN, NORTH CAROLINA 28704
(800) 438-5823 OR (828) 684-1234 FAX: (828) 684-0858
EMAIL: peco@lawnvac.com
WEBSITE: www.lawnvac.com**